



STATE OF NEW MEXICO
ENERGY AND MINERALS DEPARTMENT
OIL CONSERVATION DIVISION

November 17, 1980

BRUCE KING
GOVERNOR
LARRY KEHOE
SECRETARY

POST OFFICE BOX 2088
STATE LAND OFFICE BUILDING
SANTA FE, NEW MEXICO 87501
(505) 827-2434

6-4

El Paso Exploration Company
P. O. Box 289
Farmington, New Mexico 87401

Attention: Mr. L. A. Aimes

Administrative Order NSL-1286

Gentlemen:

Reference is made to your application for a non-standard location for the El Paso Natural Gas Company's San Juan 29-7 Unit Well No. 117 to be located 2190 feet from the South line and 550 feet from the West line of Section 19, Township 29 North, Range 7 West, NMPM, Basin Dakota Pool, Rio Arriba County, New Mexico.

By authority granted me under the provisions of Rule 3 of Order No. R-1670, the above-described unorthodox location is hereby approved.

Sincerely,

JOE D. RAMEY,
Director

JDR/RLS/dr

cc: Oil Conservation Division - Aztec
Oil & Gas Engineering Committee - Hobbs
U. S. Geological Survey - Farmington

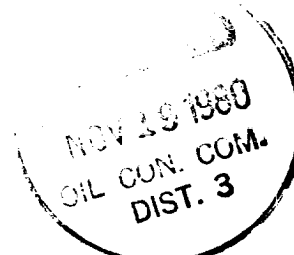

OIL CONSERVATION COMMISSION
Alfred DISTRICT

OIL CONSERVATION COMMISSION
BOX 2088
SANTA FE, NEW MEXICO

DATE November 10, 1980

RE: Proposed MC _____
Proposed DHC _____
Proposed NSL 2 _____
Proposed SWD _____
Proposed WFX _____
Proposed PMX _____

Gentlemen:

I have examined the application dated November 7, 1980
for the E.V.M.B.C. Sf. 29-7 Unit #117 L-19-29N-7W
Operator Lease and Well No. Unit, S-T-R

and my recommendations are as follows:

Approve with township error on letter

Yours very truly,

Frank S. Chung

El Paso EXPLORATION
COMPANY

P. O. BOX 289
FARMINGTON, NEW MEXICO 87401
PHONE: 505-325-2841

November 5, 1980

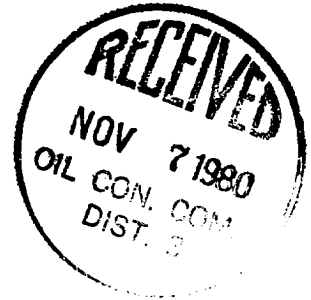

Mr. Joe Ramey
New Mexico Oil Conservation Division
Post Office Box 2088
Santa Fe, New Mexico 87501

Dear Mr. Ramey:

This is a request for administrative approval for an unorthodox gas well location in the Basin Dakota pool.

It is intended to locate the El Paso Natural Gas Company's San Juan 29-7 Unit #117 at 2190' from the South line and 550' from the West line of Section 19, T-~~27~~²⁹-N, R-7-W, Rio Arriba County, New Mexico.

Extremely rough terrain with cliffs and ledges in the southwest corner of this section makes it impossible to build an orthodox gas well location.

El Paso is the operator of all offsetting units.

Plats showing the proposed well location and the terrain of Section 19, along with an ownership plat, are attached.

Yours truly,

L. A. Aimes

L. A. Aimes
Project Drilling Engineer

LAA:pb

EL PASO NATURAL GAS COMPANY

Well Name SAN JUAN 29-7 UNIT #117, BASIN DAKOTA

Footage----- 2190' FSL, 550' FWL

APPLICATION FOR NON-STANDARD LOCATION

County Rio Arriba

State New Mexico

Section 19

Township

29N

Range 7W

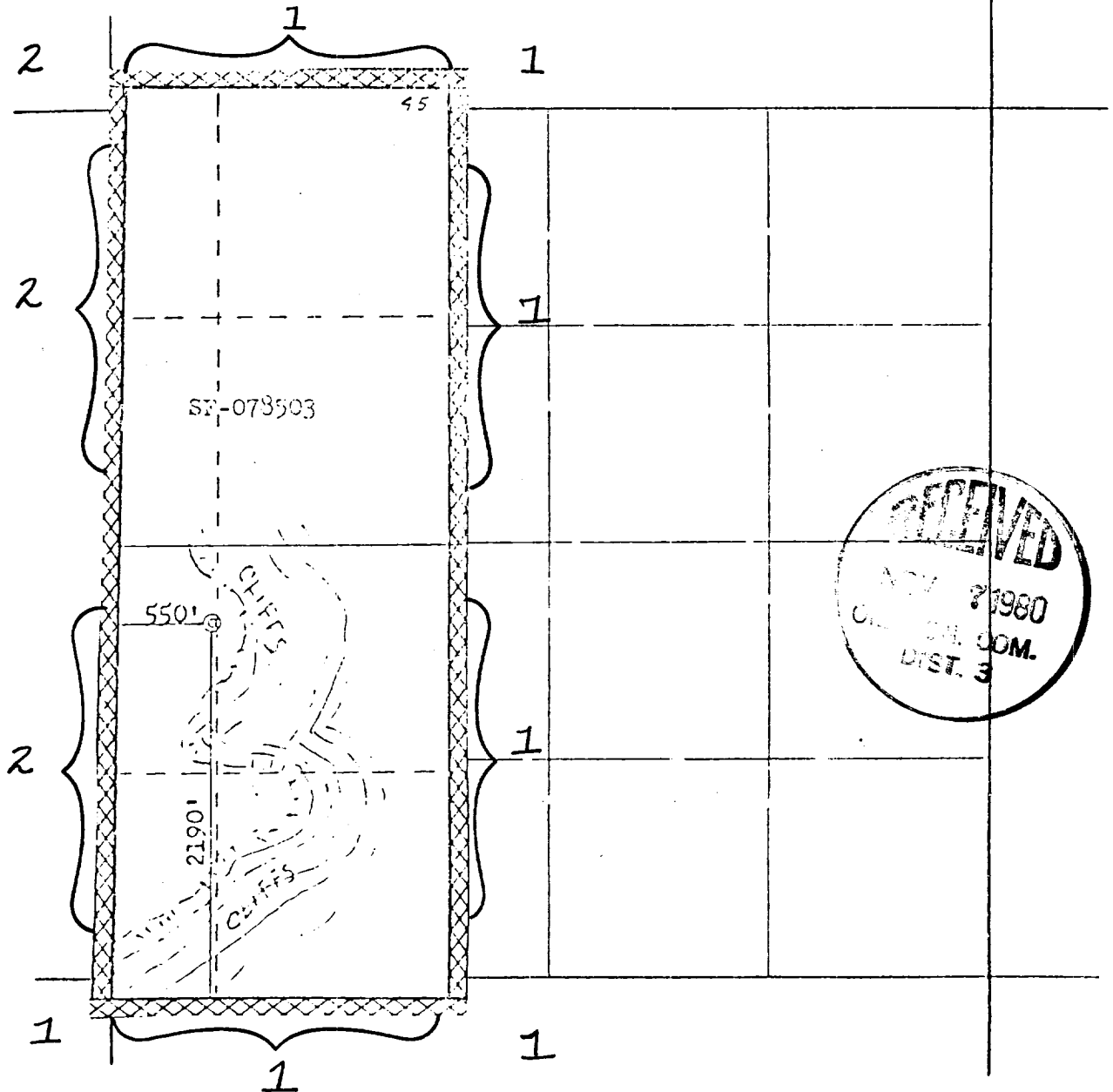

REMARKS:

- (1) SAN JUAN 29-7 UNIT, El Paso Natural Gas Company-Operator
- (2) El Paso Natural Gas Company

(1d)

OIL CONSERVATION DIVISION

STATE OF NEW MEXICO
ENERGY AND MINERALS DEPARTMENT

P. O. BOX 2088

SANTA FE, NEW MEXICO 87501

Form C-107
Revised 10-

All distances must be from the outer boundaries of the Section.

Operator EL PASO NATURAL GAS COMPANY			Lease SAN JUAN 29-7 UNIT (SF-078503)		Well No. 117
Unit Letter L	Section 19	Township 29N	Range 7W	County Rio Arriba	
Actual Footage Location of Wells 2190 feet from the South line and 550 feet from the West line					
Ground Level Elev: 6712	Producing Formation DAKOTA		Pool BASIN DAKOTA		Dedicated Acreage: 198.12 Acres

1. Outline the acreage dedicated to the subject well by colored pencil or hatchure marks on the plat below.
2. If more than one lease is dedicated to the well, outline each and identify the ownership thereof (both as to working interest and royalty).
3. If more than one lease of different ownership is dedicated to the well, have the interests of all owners been consolidated by communitization, unitization, force-pooling, etc?

☒ Yes ☐ No If answer is "yes," type of consolidation Unitization

If answer is "no," list the owners and tract descriptions which have actually been consolidated. (Use reverse side of this form if necessary.)

No allowable will be assigned to the well until all interests have been consolidated (by communitization, unitization, forced-pooling, or otherwise) or until a non-standard unit, eliminating such interests, has been approved by the Commission.

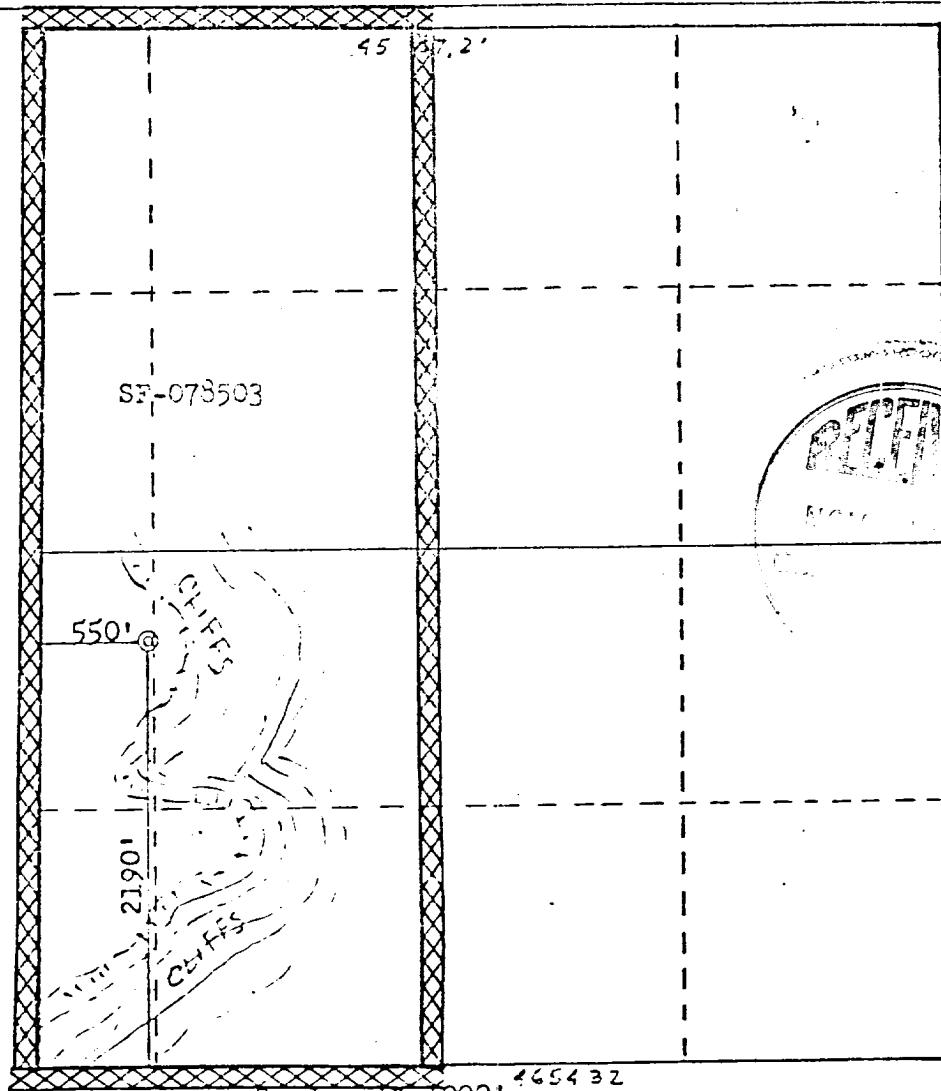

Scale: 1"=1000'

CERTIFICATION

I hereby certify that the information contained herein is true and complete to the best of my knowledge and belief.

A. J. Guico

Name
Drilling Clerk

Position
El Paso Natural Gas Co.

Company
November 5, 1980

Date

I hereby certify that the well location shown on this plat was plotted from field notes of actual surveys made by me or under my supervision, and that the same is true and correct to the best of my knowledge and belief.

Date Surveyed

September 2, 1980

Registered Professional Engineer
and Land Surveyor

Fred B. Kerr, Jr.

Certificate No. B. KERR, JR.

3950