

UNITED STATES  
DEPARTMENT OF THE INTERIOR  
BUREAU OF LAND MANAGEMENT

APPLICATION FOR PERMIT TO DRILL, DEEPEN, OR PLUG BACK

5. LEASE DESIGNATION AND SERIAL NO.  
SF 078425

6. IF INDIAN, ALLOTTEE OR TRIBE NAME

7. UNIT AGREEMENT NAME  
San Juan 29-7 Unit

8. FARM OR LEASE NAME  
San Juan 29-7 Unit

9. WELL NO.  
138

10. FIELD AND POOL, OR WILDCAT  
Basin Dakota

11. SEC., T., R., M., OR BLK.  
AND SURVEY OR AREA  
Sec. 25, T-29-N, R-7-W  
NMPM E

12. COUNTY OR PARISH  
Rio Arriba

13. STATE  
NM

1a. TYPE OF WORK  
DRILL ☒ DEEPEN ☐ PLUG BACK ☐

b. TYPE OF WELL  
OIL WELL ☐ GAS WELL ☒ - OTHER ☐ SINGLE ZONE ☒ MULTIPLE ZONE ☐

2. NAME OF OPERATOR  
MERIDIAN OIL INC.  
El Paso Natural Gas Company

3. ADDRESS OF OPERATOR  
PO Box 4289, Farmington, NM 87499

4. LOCATION OF WELL (Report location clearly and in accordance with any State requirements.)\*  
At surface  
1605'N, 1040'W  
At proposed prod. zone

14. DISTANCE IN MILES AND DIRECTION FROM NEAREST TOWN OR POST OFFICE\*  
6 miles SE of Navajo City, NM

15. DISTANCE FROM PROPOSED\*  
LOCATION TO NEAREST  
PROPERTY OR LEASE LINE, FT.  
(Also to nearest drig. unit line, if any)  
1040'

16. NO. OF ACRES IN LEASE  
Unit 2080

18. DISTANCE FROM PROPOSED LOCATION\*  
TO NEAREST WELL, DRILLING, COMPLETED,  
OR APPLIED FOR, ON THIS LEASE, FT.  
2640'

19. PROPOSED DEPTH  
8050'

17. NO. OF ACRES ASSIGNED  
TO THIS WELL  
320.00

20. ROTARY OR CABLE TOOLS  
Rotary

21. ELEVATIONS (Show whether DF, RT, GR, etc.)  
6729 6739' GL

22. APPROX. DATE WORK WILL START\*

23. This action is subject to technical and  
procedural review pursuant to 43 CFR 31.23  
and appeal pursuant to 43 CFR 316.5.

DRILLING OPERATIONS AUTHORIZED ARE  
SUBJECT TO COMPLIANCE WITH ATTACHED  
"GENERAL REQUIREMENTS"  
130 cf circulated  
450 cf cover Ojo Alamo  
631 cf fill to inter.

SIZE OF HOLE	SIZE OF CASING	WEIGHT PER FOOT	SETTING DEPTH
12 1/4"	9 5/8"	32.3#	200'
8 3/4"	7"	20.0#	3950'
6 1/4"	4 1/2"	10.5&11.6#	8050'

Selectively perforate and sand water fracture the Dakota formation.

A 3000 psi WP and 6000 psi test double gate preventer equipped with blind and pipe rams will be used for blow out prevention on this well.

This gas is dedicated.

The W/2 of Section 25 is dedicated to this well.

IN ABOVE SPACE DESCRIBE PROPOSED PROGRAM: If proposal is to deepen or plug back, give data on present productive zone and proposed new productive zone. If proposal is to drill or deepen directionally, give pertinent data on subsurface locations and measured and true vertical depths. Give blowout preventer program, if any.

24.  Drilling Clerk 7-22-87

(This space for Federal or State office use)

PERMIT NO. APPROVAL DATE

APPROVED BY TITLE DATE

CONDITIONS OF APPROVAL, IF ANY:

APPROVED  
AS AMENDED  
AUG 03 1987  
AREA MANAGER

\*See Instructions On Reverse Side

NEW MEXICO OIL CONSERVATION COMMISSION  
WELL LOCATION AND ACREAGE DEDICATION PLAT

Form C-102  
Supersedes C-128  
Effective 1-1-65

All distances must be from the outer boundaries of the Section.

Operator <u>MERIDIAN OIL INC.</u> <u>EL PASO NATURAL GAS CO.</u>		Lease <u>SAN JUAN 29-7 UNIT (SP 078425)</u>		Well No. <u>138</u>
Unit Letter <u>E</u>	Section <u>25</u>	Township <u>29 N</u>	Range <u>7 W</u>	County <u>Rio Arriba</u>
Actual Footage Location of Wells <u>1605</u> feet from the <u>North</u> line and <u>1040</u> feet from the <u>West</u> line				
Ground Level Elev: <u>6729</u>	Producing Formation <u>Dakota</u>	Pool <u>Basin</u>	Dedicated Acreage: <u>320</u> Acres	

1. Outline the acreage dedicated to the subject well by colored pencil or hachure marks on the plat below.
2. If more than one lease is dedicated to the well, outline each and identify the ownership thereof (both as to working interest and royalty).
3. If more than one lease of different ownership is dedicated to the well, have the interests of all owners been consolidated by communitization, unitization, force-pooling, etc?

☒ Yes ☐ No If answer is "yes," type of consolidation Unitization

If answer is "no," list the owners and tract descriptions which have actually been consolidated. (Use reverse side of this form if necessary.)

No allowable will be assigned to the well until all interests have been consolidated (by communitization, unitization, forced-pooling, or otherwise) or until a non-standard unit, eliminating such interests, has been approved by the Commission.

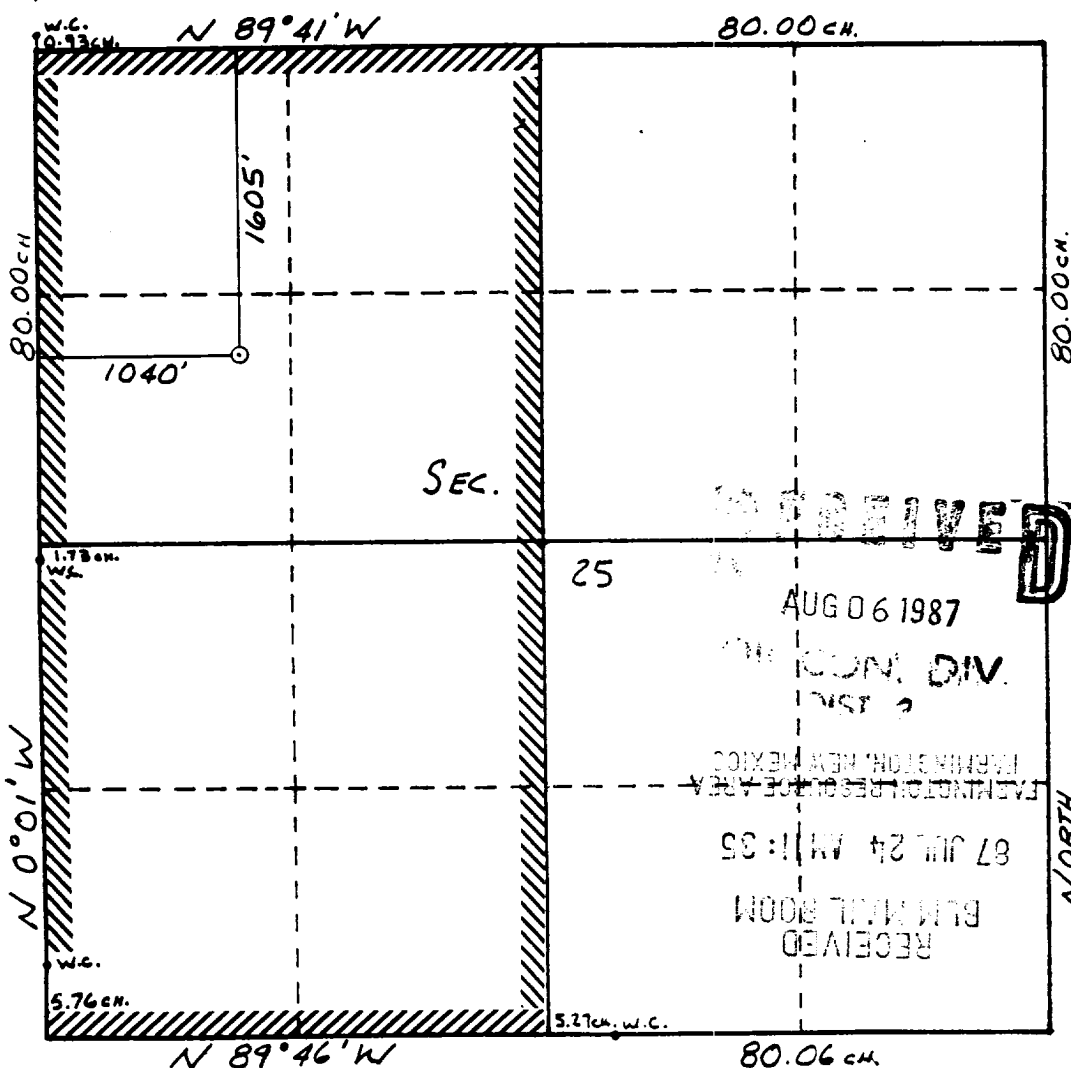

CERTIFICATION

I hereby certify that the information contained herein is true and complete to the best of my knowledge and belief.

Name

Position

Drilling Clerk

Company

El Paso Natural Gas

Date

7-25

I hereby certify that the well location shown on this plat was plotted from field notes of actual surveys made by me or under my supervision, and that the same is true and correct to the best of my knowledge and belief.

6-23-87

Date Surveyed

William E. Mahan II

Registered Professional Engineer and Land Surveyor

Certification No.

8466

Topographic map of the Gobernador Canyon area. The map shows contour lines and elevation points. Key features include:

- Gobernador Canyon**: Labeled across the center of the map.
- PIPELINE**: Indicated by a dashed line running diagonally across the canyon.
- Elevation Points**: Numerous points are marked with elevations, including 6715, 6236, 6207, 6739, 6783, 6785, 6661, 6658, 6652, and 6650.
- Grid System**: A coordinate grid is overlaid on the map, with letters A through J along the top and numbers 1 through 12 along the right side.
- Scale Bar**: Located at the bottom right, showing a distance of 0 to 1 mile.
- Orientation**: The map is oriented with North at the top.

## LEGEND OF RIGHT-OF-WAYS

## EXISTING PIPELINES

EXISTING ROAD & PIPELINE

## PROPOSED ROADS

## PROPOSED PIPELINES

## PROPOSED ROAD & PIPELINE