

NO. OF COPIES RECEIVED		
DISTRIBUTION		
SANTA FE		
FILE		
U.S.G.S.		
LAND OFFICE		
OPERATOR		

Form C-101
Revised 1-4-65

5A. Indicate Type of Lease

STATE	<input checked="" type="checkbox"/>	FEE	<input type="checkbox"/>
-------	-------------------------------------	-----	--------------------------

5. State Oil & Gas Lease No.

E-5111-4

1a. Type of Work		7. Unit Agreement Name	
b. Type of Well OIL WELL <input type="checkbox"/> GAS WELL <input checked="" type="checkbox"/> OTHER <input type="checkbox"/>		San Juan 29-7 Unit	
DRILL <input checked="" type="checkbox"/> DEEPEN <input type="checkbox"/> PLUG BACK <input type="checkbox"/>		8. Farm or Lease Name	
SINGLE ZONE <input checked="" type="checkbox"/> MULTIPLE ZONE <input type="checkbox"/>		San Juan 29-7 Unit	
2. Name of Operator Meridian Oil Inc.		9. Well No. 516	
3. Address of Operator PO Box 4289, Farmington, NM 87499		10. Field and Pool, or Wildcat Undes. Fruitland Coal	
4. Location of Well UNIT LETTER <u>K</u> LOCATED <u>1720</u> FEET FROM THE <u>South</u> LINE AND <u>1540</u> FEET FROM THE <u>West</u> LINE OF SEC. <u>36</u> TWP. <u>29N</u> RGE. <u>7W</u> NMPM		12. County Rio Arriba	
21. Elevations (Show whether DP, RT, etc.) 6816' GL		19. Proposed Depth 3608	19A. Formation Fruitland
21A. Kind & Status Plug. Bond statewide	21B. Drilling Contractor	20. Rotary or C.T. Rotary	
		22. Approx. Date Work will start	

PROPOSED CASING AND CEMENT PROGRAM

SIZE OF HOLE	SIZE OF CASING	WEIGHT PER FOOT	SETTING DEPTH	SACKS OF CEMENT	EST. TOP
12 1/4"	9 5/8"	36.0#	200'	130 cu.ft.	circ. surface
8 3/4"	7"	20.0#	3390'	201 cu.ft.	cover Ojo Alamo
6 1/4"	5 1/2"	23.0#	3608'	do not cement	

The SW/4 of Section 36 is dedicated to this well.

SEP 2 1966
OIL C. DIV.
DIST. 3

IN ABOVE SPACE DESCRIBE PROPOSED PROGRAM: IF PROPOSAL IS TO DEEPEN OR PLUG BACK, GIVE DATA ON PRESENT PRODUCTIVE ZONE AND PROPOSED NEW PRODUCTIVE ZONE. GIVE BLOWOUT PREVENTER PROGRAM, IF ANY.

I hereby certify that the information above is true and complete to the best of my knowledge and belief.

Signed James Bradford Title Drilling Clerk Date 9-14-88

(This space for State Use)

APPROVED BY Ernie Buech TITLE _____ DATE _____
CONDITIONS OF APPROVAL, IF ANY:

All distances must be from the outer boundaries of the Section.

Operator Meridian Oil Inc.			Lease San Juan 29-7 Unit (E-5111-4) 516		Well No. 516
Unit Letter K	Section 36	Township 29 North	Range 7 West	County Rio Arriba	
Actual Footage Location of Wells 1720 feet from the South line and 1540 feet from the West line					
Ground Level Elev. 6810	Producing Formation Fruitland Coal		Pool Undesignated	Dedicated Acreage: 160 Acres	

1. Outline the acreage dedicated to the subject well by colored pencil or hachure marks on the plat below.
2. If more than one lease is dedicated to the well, outline each and identify the ownership thereof (both as to working interest and royalty).
3. If more than one lease of different ownership is dedicated to the well, have the interests of all owners been consolidated by communitization, unitization, force-pooling, etc?

☒ Yes ☐ No If answer is "yes," type of consolidation unitization

If answer is "no," list the owners and tract descriptions which have actually been consolidated. (Use reverse side of this form if necessary.)

No allowable will be assigned to the well until all interests have been consolidated (by communitization, unitization, forced-pooling, or otherwise) or until a non-standard unit, eliminating such interests, has been approved by the Division

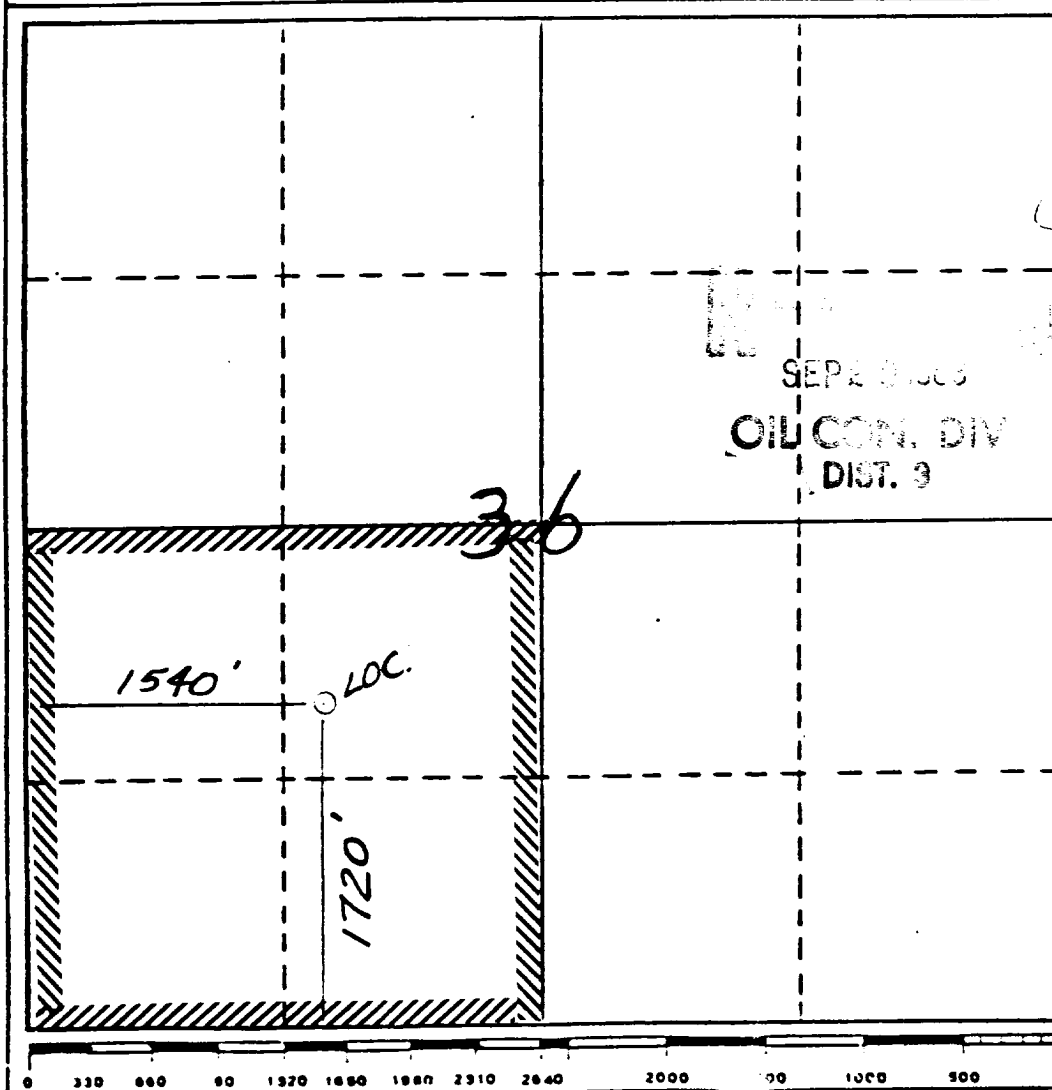

CERTIFICATION

I hereby certify that the information contained herein is true and complete to the best of my knowledge and belief.

Name
Regulatory Affairs

Position
Meridian Oil Inc.

Company

Date

I hereby certify that the well location shown on this plat was plotted from field notes of actual surveys made by me or under my supervision, and that the same is true and correct to the best of my knowledge and belief.

Date Surveyed
7-26-83

Registered Professional Engineer
and/or Land Surveyor

Heale C. Edwards

Certificate No.

6857