

UNITED STATES  
DEPARTMENT OF THE INTERIOR  
BUREAU OF LAND MANAGEMENT

SUBMIT IN TRIPlicate  
(Other instructions on re-  
verse side)

Budget Bureau No. 1004-0135  
Expires August 31, 1985

SUNDRY NOTICES AND REPORTS ON WELLS

(Do not use this form for proposals to drill or to deepen or plug back to a different reservoir.  
Use "APPLICATION FOR PERMIT—" for such proposals.)

1. <input type="checkbox"/> OIL WELL <input type="checkbox"/> GAS WELL <input checked="" type="checkbox"/> OTHER	7. UNIT AGREEMENT NAME San Juan 29-7 Unit
2. NAME OF OPERATOR El Paso Natural Gas Company <i>Meridian Oil</i>	8. FARM OR LEASE NAME San Juan 29-7 Unit
3. ADDRESS OF OPERATOR P.O. Box 4289, Farmington, NM 87499	9. WELL NO. 513
4. LOCATION OF WELL (Report location clearly and in accordance with any State requirements. See also space 17 below.) At surface 790'N, 1450'W	10. FIELD AND POOL, OR WILDCAT Basin Fruitland Coal
14. PERMIT NO.	11. SEC. T. R. M. OR S.E. AND COURSE OR AREA Sec.30, T29N, R7W NMPM
15. ELEVATIONS (Show whether OF, TO, OR, etc.) 6339'GL	12. COUNTY OR PARISH San Juan
	13. STATE NM

16. Check Appropriate Box To Indicate Nature of Notice, Report, or Other Data

NOTICE OF INTENTION TO:		SUBSEQUENT REPORT OF:	
TEST WATER SHUT-OFF <input type="checkbox"/>	PULL OR ALTER CASING <input type="checkbox"/>	WATER SHUT-OFF <input type="checkbox"/>	REPAIRING WELL <input type="checkbox"/>
FRACURE TREAT <input type="checkbox"/>	MULTIPLE COMPLETE <input type="checkbox"/>	FRACURE TREATMENT <input type="checkbox"/>	ALTERING CASING <input type="checkbox"/>
SHOOT OR ACIDIZE <input type="checkbox"/>	ABANDON* <input type="checkbox"/>	SHOOTING OR ACIDIZING <input type="checkbox"/>	ABANDONMENT* <input type="checkbox"/>
REPAIR WELL <input type="checkbox"/>	CHANGE PLANS <input type="checkbox"/>	(Other) <input type="checkbox"/>	(Other) <input type="checkbox"/>
(Other) Revision <input checked="" type="checkbox"/>		(Note: Report results of multiple completion or well Completion or Recompletion Report and Log form.)	

17. DESCRIBE PROPOSED OR COMPLETED OPERATIONS (Clearly state all pertinent details, and give pertinent dates, including estimated date of starting any proposed work. If well is directionally drilled, give subsurface locations and measured and true vertical depths for all markers and zones pertinent to this work.) \*

Attached is a copy of the C102 showing the revised pool & dedication.

RECEIVED

DEC 23 1988

BUREAU OF LAND MANAGEMENT  
FARMINGTON, NEW MEXICO

18. I hereby certify that the foregoing is true and correct

SIGNED

TITLE Regulatory Affairs **ACCEPTED FOR RECORD** 22-88

(This space for Federal or State office use)

APPROVED BY \_\_\_\_\_  
CONDITIONS OF APPROVAL, IF ANY:

TITLE \_\_\_\_\_ DATE JAN 12 1989

FARMINGTON RESOURCE AREA

BY SMW

\*See Instructions on Reverse Side

Title 18 U.S.C. Section 1001, makes it a crime for any person knowingly and willfully to make to any department or agency of the United States any false, fictitious or fraudulent statements or representations as to any matter within its jurisdiction.

NMOCC

All distances must be from the outer boundaries of the Section.

Operator <u>El Paso Natural Gas Meridian Oil</u>		Lease <u>San Juan 29-7 Unit</u>		Well No. <u>513</u>
Unit Letter <u>C</u>	Section <u>30</u>	Township <u>29 North</u>	Range <u>7 West</u>	County <u>Rio Arriba</u>
Actual Footage Location of Wells <u>790</u> feet from the <u>North</u> line and <u>1450</u> feet from the <u>West</u> line				
Ground Level Elev. <u>6339'</u>	Producing Formation <u>Fruitland Coal</u>	Pool <u>Basin</u>	Dedicated Acreage: <u>320</u> Acres	

1. Outline the acreage dedicated to the subject well by colored pencil or hachure marks on the plat below.
2. If more than one lease is dedicated to the well, outline each and identify the ownership thereof (both as to working interest and royalty).
3. If more than one lease of different ownership is dedicated to the well, have the interests of all owners been consolidated by communitization, unitization, force-pooling, etc?

☒ Yes ☐ No If answer is "yes," type of consolidation unitization

If answer is "no," list the owners and tract descriptions which have actually been consolidated. (Use reverse side of this form if necessary.)

No allowable will be assigned to the well until all interests have been consolidated (by communitization, unitization, forced-pooling, or otherwise) or until a non-standard unit, eliminating such interests, has been approved by the Division.

\* Note: Non-standard location- due to terrain & short section.

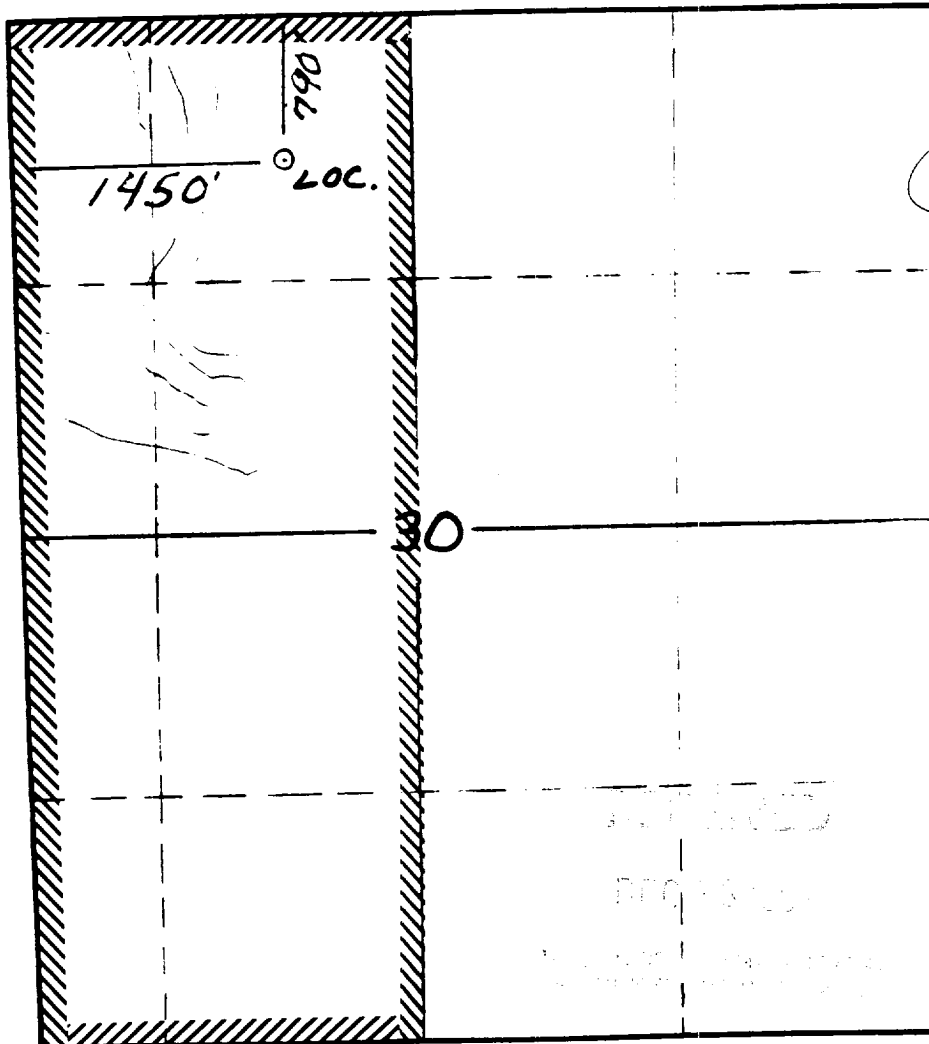

#### CERTIFICATION

I hereby certify that the information contained herein is true and complete to the best of my knowledge and belief.

Name  
Regulatory Affairs  
Position Meridian Oil  
El Paso Natural Gas Co.  
Company 12-22-88

Date

I hereby certify that the well location shown on this plat was plotted from field notes of actual surveys made by me or under my supervision, and that the same is true and correct to the best of my knowledge and belief.

Date Surveyed 7-5-98

Registered Professional Engineer and/or Land Surveyor

Neale C. Edwards

Certificate No. 6857