

UNITED STATES
DEPARTMENT OF THE INTERIOR
BUREAU OF LAND MANAGEMENT

APPLICATION FOR PERMIT TO DRILL, DEEPEN, OR PLUG BACK

1a. TYPE OF WORK DRILL	5. LEASE NUMBER SF-078424-B
1b. TYPE OF WELL GAS	6. IF INDIAN, ALL. OR TRIBE NAME
2. OPERATOR EL PASO NATURAL GAS CO.	7. UNIT AGREEMENT NAME SAN JUAN 29-7 UNIT
3. ADDRESS & PHONE NO. OF OPERATOR P O BOX 4289 FARMINGTON, NM 87499	8. FARM OR LEASE NAME SAN JUAN 29-7 UNIT
4. LOCATION OF WELL 845' FSL 1700' FWL	9. WELL NO. 559
10. FIELD, POOL, OR WILDCAT BASIN FRUITLAND COAL	11. SEC. T. R. M OR BLK. N SEC. 22 T29N R07W NMPM
12. COUNTY RIO ARRIBA	13. STATE NM
14. DISTANCE IN MILES FROM NEAREST TOWN 5 MILES FROM NAVAJO CITY	15. DISTANCE FROM PROPOSED LOCATION TO NEAREST PROPERTY OR LEASE LINE. 845'
16. ACRES IN LEASE 160	17. ACRES ASSIGNED TO WELL w/ 320.00 This action is subject to technical and procedural review pursuant to 43 CFR 3166.2 and appeal pursuant to 43 CFR 3166.4.
18. DISTANCE FROM PROPOSED LOCATION TO NEAREST WELL DR. COMPL., OR APPLIED FOR ON THIS LEASE. 300'	19. PROPOSED DEPTH 3549'
20. ROTARY OR CABLE TOOLS ROTARY	DRILLING OPERATIONS AUTHORIZED ARE SUBJECT TO COMPLIANCE WITH ATTACHED "GENERAL REQUIREMENTS".
21. ELEVATIONS (DF, FT, GR, ETC.) 6751' GL	22. APPROX. DATE WORK WILL START
23. PROPOSED CASING AND CEMENTING PROGRAM	
*SEE OPERATIONS PLAN	
24. AUTHORIZED BY: REG. DRILLING ENGR.	RECEIVED SEP 13 1990 OIL CON. DIV. DIST. 3 DATE 8/13/90

PERMIT NO. _____ APPROVAL DATE _____
APPROVED BY _____ TITLE _____ DATE _____
AS AMENDMENT

NOTE: THIS FORMAT IS ISSUED IN LIEU OF US BLM FORM 3160-3.

SEP 07 1990
AREA MANAGER

Submit to Appropriate
District Office
State Lease - 4 copies
Fee Lease - 3 copies

State of New Mexico
Energy, Minerals and Natural Resources Department

Form C-102
Revised 1-1-89

OIL CONSERVATION DIVISION

P.O. Box 2088
Santa Fe, New Mexico 87504-2088

DISTRICT I
P.O. Box 1980, Hobbs, NM 88240

DISTRICT II
P.O. Drawer DD, Artesia, NM 88210

DISTRICT III
1000 Rio Brazos Rd., Aztec, NM 87410

WELL LOCATION AND ACREAGE DEDICATION PLAT

All Distances must be from the outer boundaries of the section

Operator <i>El Paso Natural Gas</i>		Lease (SF-078424B) San Juan 29-7 Unit		Well No. 559
Unit Letter N	Section 22	Township 29 North	Range 7 West	County NMPM Rio Arriba
Actual Footage Location of Well: 845 feet from the South line and 1700 feet from the West line				
Ground level Elev. 6751'	Producing Formation Fruitland Coal		Pool Basin	Dedicated Acreage: 320 Acres

- Outline the acreage dedicated to the subject well by colored pencil or hatchure marks on the plat below.
- If more than one lease is dedicated to the well, outline each and identify the ownership thereof (both as to working interest and royalty).
- If more than one lease of different ownership is dedicated to the well, have the interest of all owners been consolidated by communitization, unitization, force-pooling, etc.?
☒ Yes ☐ No If answer is "yes" type of consolidation unitization
If answer is "no" list the owners and tract descriptions which have actually been consolidated. (Use reverse side of this form if necessary.)
No allowable will be assigned to the well until all interests have been consolidated (by communitization, unitization, forced-pooling, or otherwise) or until a non-standard unit, eliminating such interest, has been approved by the Division.

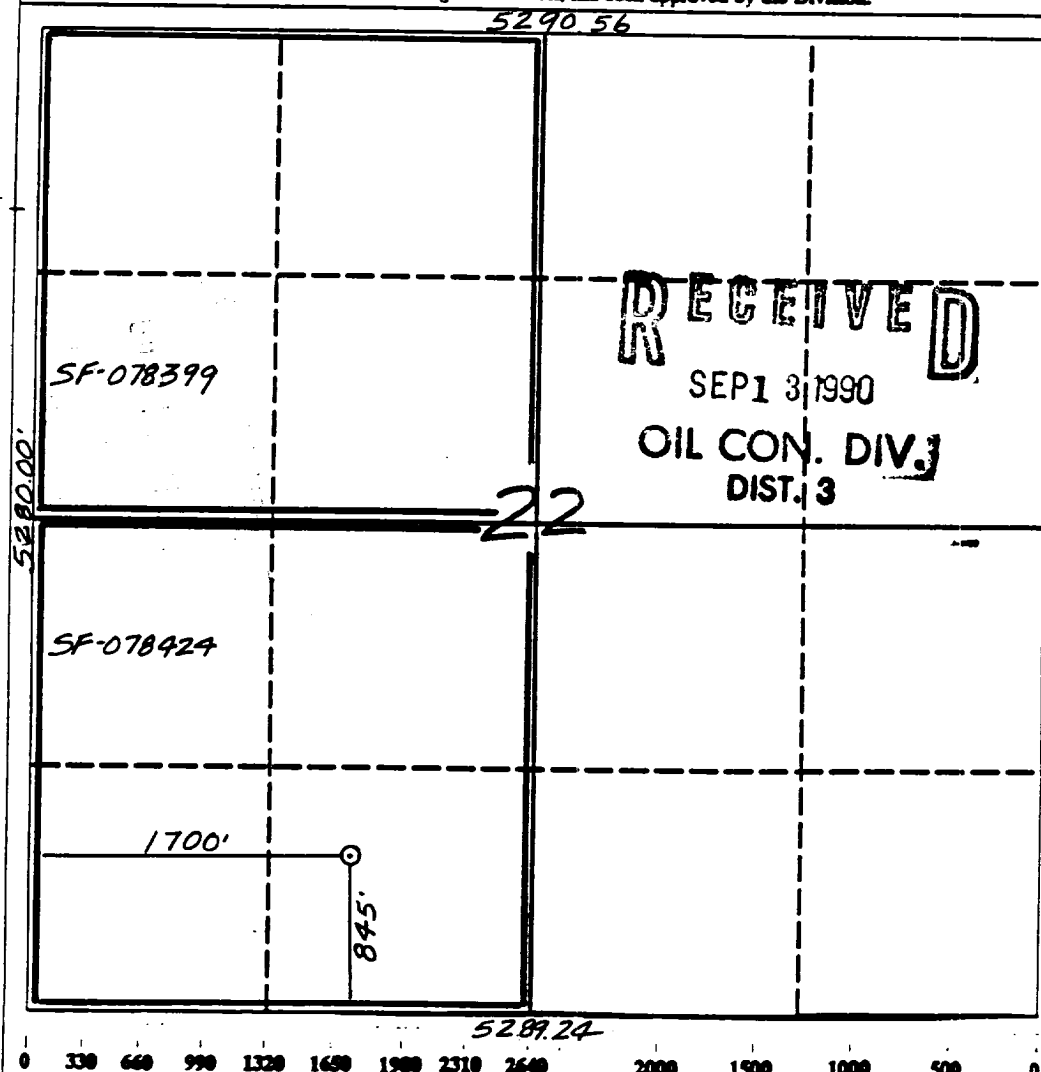

OPERATOR CERTIFICATION

I hereby certify that the information contained herein is true and complete to the best of my knowledge and belief.

Signature
Peggy Bradfield

Printed Name
Peggy Bradfield

Position
Regulatory Affairs

Company
El Paso Natural Gas

Date
8-13-90

SURVEYOR CERTIFICATION

I hereby certify that the well location shown on this plat was plotted from field notes of actual surveys made by me or under my supervision, and that the same is true and correct to the best of my knowledge and belief.

7-16-90

Date Surveyed

Signature
Neale C. Edwards

Professional Surveyor

NEW MEXICO

6857

6857

Certificate

Neale C. Edwards

Well Name: 559 SAN JUAN 29-7 UNIT
 Sec. 22 T29N R07W
 BASIN FRUITLAND COAL

845'FSL 1700'FWL
 RIO ARRIBA NEW MEXICO
 Elevation 6751'GL

Formation tops: Surface- SAN JOSE
 Ojo Alamo- 2590
 Kirtland- 2760
 Fruitland- 3260
 Fruitland Coal Top- 3415
 Fruitland Coal Base- 3547
 Pictured Cliffs- 3551

Total Depth- 3549

Logging Program: Mud logs from 3260 to total depth.

Mud Program:	Interval	Type	Weight	Visc.	Fl. Loss
	0 - 200	Spud	8.4 - 8.9	40-50	no control
	200 - 3549	Non-dispersed	8.4 - 9.5	30-60	no control

Casing Program:	Hole Size	Depth Interval	Csg. Size	Weight	Grade
	12 1/4"	0 - 200	8 5/8"	24.0#	K-40
	7 7/8"	0 - 3549	5 1/2"	15.5#	K-55
Tubing Program:		0 - 3549	2 3/8"	4.7#	J-55

Float Equipment: 8 5/8" surface casing - saw tooth guide shoe. Centralizers will be run in accordance with Onshore Order #2.

5 1/2" production casing - float shoe on bottom. Three centralizers run every other joint above shoe. Two turbolizing type centralizers - one below and one into the base of the Ojo Alamo @ 2760'. Standard centralizers thereafter every fourth joint up to the base of the surface pipe.

Wellhead Equipment: 8 5/8" x 5 1/2" x 2 3/8" x 11" 3000 psi xmas tree assembly

Cementing:

8 5/8" surface casing - cement with 211 sacks of class "B" cement with 1/4# flocele/sack and 3% calcium chloride (248 cu ft. of slurry, 200% excess to circulate to surface). WOC 12 hours. Test casing to 600 psi for 30 minutes.

5 1/2" production casing - lead with 580 sacks of 65/35 class "B" poz with 6% gel, 2% calcium chloride and 1/2 cu.ft. Perlite/sack (10.3 gallons of water/sack) tail with 100 sacks of class "B" with 2% calcium chloride. 1237 cu ft. of slurry, 100% excess to circulate to surface. If hole conditions permit, a 600 ft spacer will be run ahead of the cement slurry to avoid mud contamination of the cement. WOC 12 hours. If cement does not circulate to surface, a temperature log will be run after 8 hours to determine TOC.