

Submit to Appropriate District Office  
 State Leases - 4 copies  
 Fee Leases - 3 copies

State of New Mexico  
 Energy, Minerals and Natural Resources Department

Form C-102  
 Revised 1-1-89

**OIL CONSERVATION DIVISION**

RECEIVED  
 BLM

94 AUG 11 AM 10:17

DISTRICT I  
 P.O. Box 1980, Hobbs, NM 88240

P.O. Box 2088

Santa Fe, New Mexico 87504-2088

070 FARMINGTON, NM

DISTRICT II  
 P.O. Drawer DD, Artesia, NM 88210

DISTRICT III  
 1000 Rio Santos Rd., Aztec, NM 87410

**WELL LOCATION AND ACREAGE DEDICATION PLAT**

All Distances must be from the outer boundaries of the section

Operator Meridian Oil Inc.			Lease San Juan 29-7 Unit		Well No. 583
U.S. Letter K	Section 6	Township 29 North	Range 7 West	County Rio Arriba	
Actual Footage Location of Well: 1850 feet from the South line and 790 feet from the West line					
Ground level Elev. 6269'	Producing Formation Fruitland Coal/Pic. Cliffs		Pool Basin/Blanco Ext	Dedicated Acreage 215.22/110.66 Acres	

- Outline the acreage dedicated to the subject well by colored pencil or redline marks on the plat below.
  - If more than one lease is dedicated to the well, outline each and identify the ownership thereof (both as to working interest and royalty).
  - If more than one lease of different ownership is dedicated to the well, have the interest of all owners been consolidated by commutation, unmineral, force-pooling, etc.?
    - Yes  No If answer is "yes" type of consolidation \_\_\_\_\_
- If answer is "no" list the owners and tract descriptions which have actually been consolidated. (Use reverse side of this form if necessary.)
- No allowable will be assigned to the well until all interests have been consolidated (by commutation, unmineral, force-pooling, or otherwise) or until a non-consent test, eliminating such interests, has been approved by the Division.

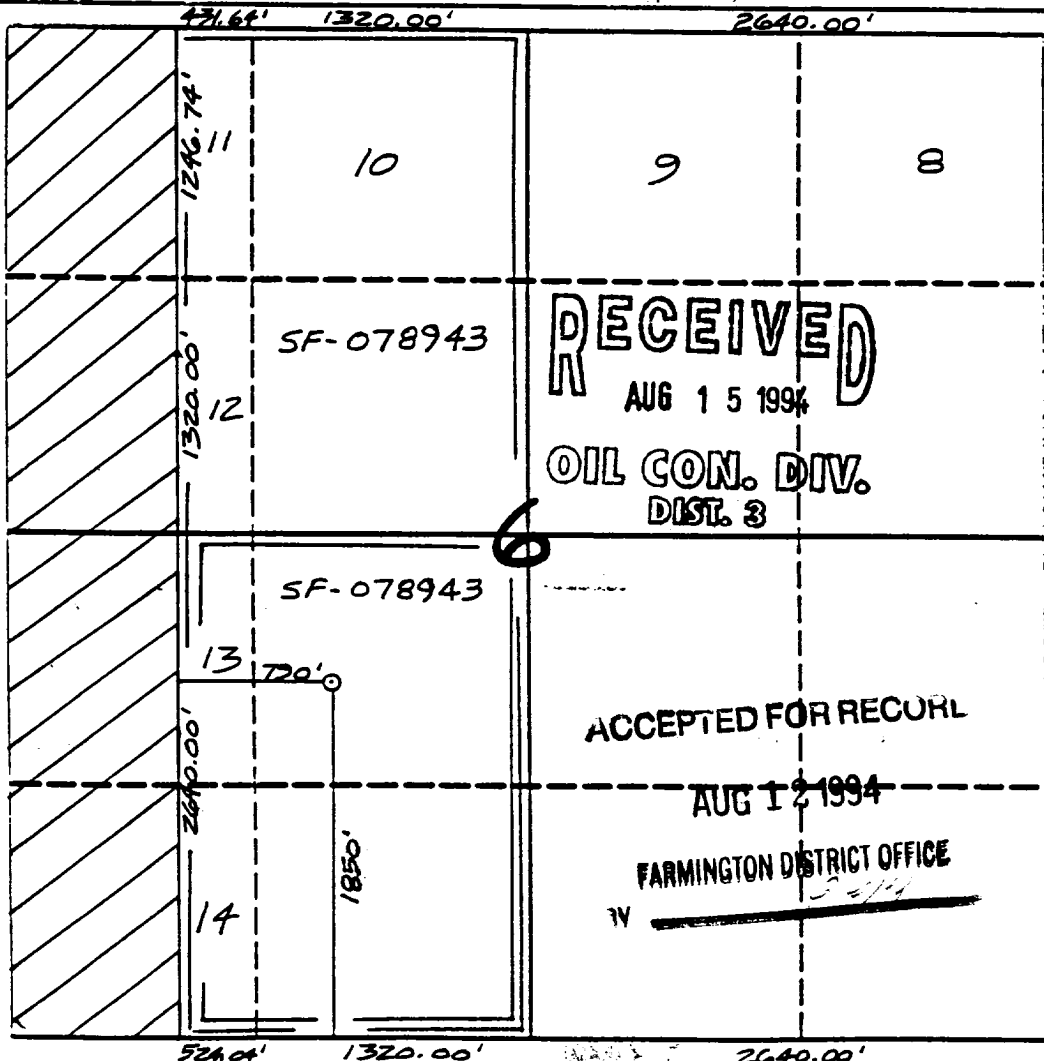

**OPERATOR CERTIFICATION**

I hereby certify that the information contained herein is true and complete to the best of my knowledge and belief.

*Peggy Bradfield*  
 Signature

Peggy Bradfield  
 Printed Name

Regulatory Affairs  
 Position

Meridian Oil Inc  
 Company

3-10-93  
 Date

**SURVEYOR CERTIFICATION**

I hereby certify that the well location shown on this plat was plotted from field notes of actual surveys made by me or under my supervision, and that the same is true and correct to the best of my knowledge and belief.

2-12-93  
 Date Surveyed

Neil C. Edwards  
 Signature

Professional Surveyor  
 8857

*Neil C. Edwards*  
 Signature

6857

ACCEPTED FOR RECORD

AUG 12 1994

FARMINGTON DISTRICT OFFICE

14