

UNITED STATES
DEPARTMENT OF THE INTERIOR
BUREAU OF LAND MANAGEMENT

APPLICATION FOR PERMIT TO DRILL, DEEPEN, OR PLUG BACK

1a. Type of Work
DRILL

5. Lease Number
SF-078423

Unit Reporting Number
8910016500

1b. Type of Well
GAS

6. If Indian, All. or Tribe

2. Operator
**BURLINGTON
RESOURCES** Oil & Gas Company
14538

7. Unit Agreement Name
San Juan 29-7 Unit

3. Address & Phone No. of Operator
PO Box 4289, Farmington, NM 87499
(505) 326-9700

8. Farm or Lease Name
7465 San Juan 29-7 Unit
9. Well Number
54B

4. Location of Well
785' FNL, 400' FWL
Latitude 36° 43.9, Longitude 107° 32.8

10. Field, Pool, Wildcat
72319 Blanco Mesa Verde
11. Sec., Twn, Rge, Mer. (NMPM)
D Sec 14, T-29-N, R-7-W
API # 30-039- 25858

14. Distance in Miles from Nearest Town
3 miles to Navajo City

12. County 13. State
Rio Arriba NM

15. Distance from Proposed Location to Nearest Property or Lease Line
400'

16. Acres in Lease

17. Acres Assigned to Well
320 W/2

18. Distance from Proposed Location to Nearest Well, Drig, Compl, or Applied for on this Lease
1400'

19. Proposed Dept
5648' This action is subject to technical and
procedural review pursuant to 43 CFR 3165.3,
and appeal pursuant to 43 CFR 3165.4.

20. Rotary or Cable Tools
Rotary

21. Elevations (DF, FT, GR, Etc.)
6234' GR

22. Approx. Date Work will Start

23. Proposed Casing and Cementing Program
See Operations Plan attached

DRILLING OPERATIONS AUTHORIZED ARE
SUBJECT TO COMPLIANCE WITH ATTACHED
"GENERAL REQUIREMENTS"

24. Authorized by: Donna Bradfield
Regulatory/Compliance Administrator

3-30-98
Date

PERMIT NO. _____

APPROVAL DATE

APPROVED BY /s/ Duane W. Spencer

TITLE _____

DATE MAY 15 1998

Archaeological Report to be submitted

Threatened and Endangered Species Report to be submitted

NOTE: This format is issued in lieu of U.S. BLM Form 3160-3

Title 18 U.S.C. Section 1001, makes it a crime for any person knowingly and willfully to make to any department or agency of the United States any false, fictitious or fraudulent statements or presentations as to any matter within its jurisdiction.

NMOCD

District I
PO Box 1980, Hobbs, NM 88241-1980

District II
PO Drawer 00, Artesia, NM 88211-0719

District III
1000 Rio Brazos Rd., Aztec, NM 87410

District IV
PO Box 2088, Santa Fe, NM 87504-2088

State of New Mexico
Energy, Minerals & Natural Resources Department

OIL CONSERVATION DIVISION
PO Box 2088
Santa Fe, NM 87504-2088

Form C-10
Revised February 21, 1999
Instructions on back
Submit to Appropriate District Office
State Lease - 4 Copies
Fee Lease - 3 Copies

☐ AMENDED REPORT

SC 100-2 711 1:36

WELL LOCATION AND ACREAGE DEDICATION PLAT

*API Number 30-039-25858		*Pool Code 72319	*Pool Name Blanco Mesaverde
*Property Code 7465	*Property Name SAN JUAN 29-7 UNIT		*Well Number 54B
*GRID No. 14538	*Operator Name BURLINGTON RESOURCES OIL & GAS COMPANY		*Elevation 6234'

10 Surface Location

UL or lot no.	Section	Township	Range	Lot Idn	Feet from the	North/South line	Feet from the	East/West line	County
0	14	29N	7W		785	NORTH	400	WEST	RIO ARriba

11 Bottom Hole Location If Different From Surface

UL or lot no.	Section	Township	Range	Lot Idn	Feet from the	North/South line	Feet from the	East/West line	County

12 Dedicated Acres W/320	13 Joint or Infill	14 Consolidation Code	15 Order No.
-----------------------------	--------------------	-----------------------	--------------

NO ALLOWABLE WILL BE ASSIGNED TO THIS COMPLETION UNTIL ALL INTERESTS HAVE BEEN CONSOLIDATED OR A NON-STANDARD UNIT HAS BEEN APPROVED BY THE DIVISION

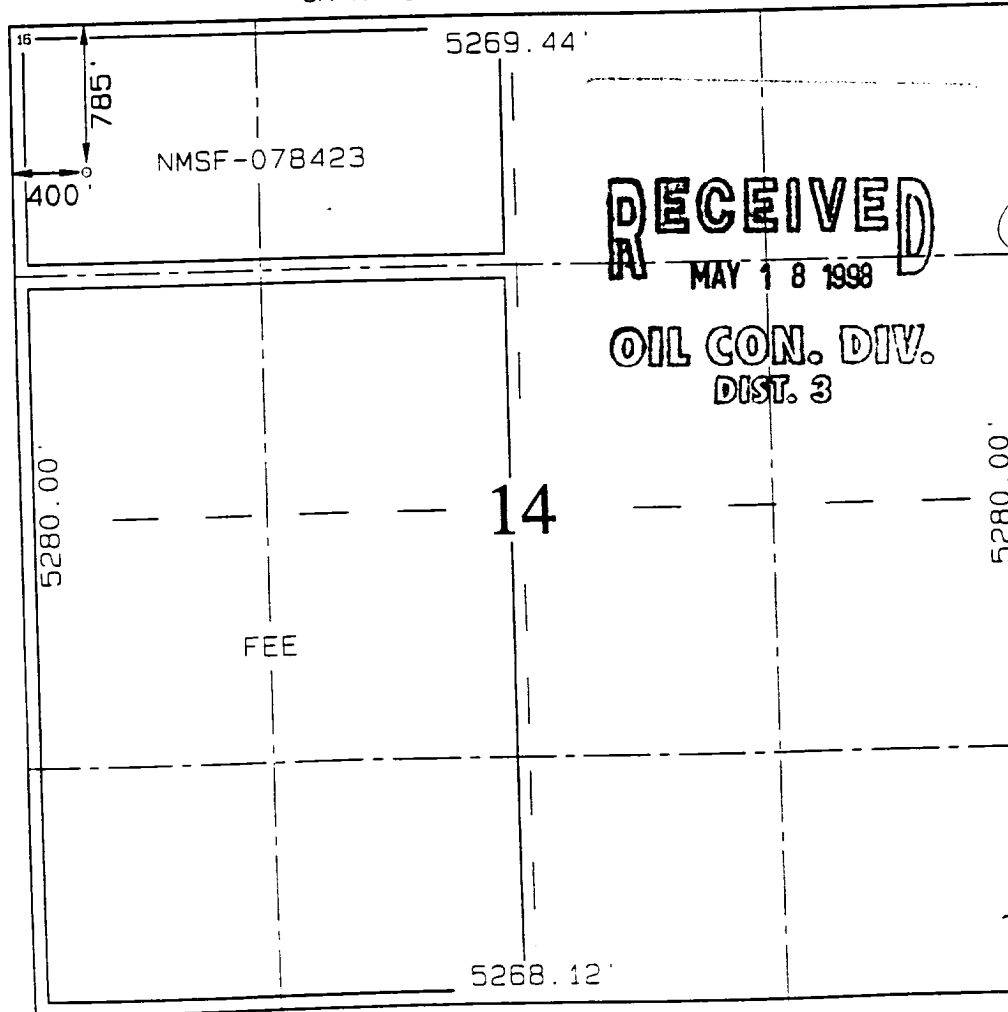

17 OPERATOR CERTIFICATION
I hereby certify that the information contained herein is true and complete to the best of my knowledge and belief.

Peggy Bradfield
Signature
Peggy Bradfield
Printed Name
Regulatory Administrator
Title
3-30-98
Date

18 SURVEYOR CERTIFICATION
I hereby certify that the well location shown on this plat was plotted from field notes of actual surveys made by or under my supervision, and that the same is true and correct to the best of my belief.

FEBRUARY 8, 1998
Date of Survey

Signature and Seal of Professional Surveyor

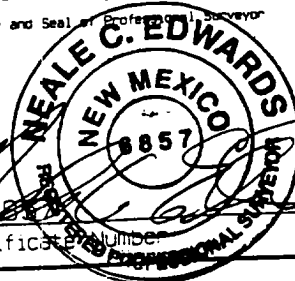

Certificate Number

OPERATIONS PLAN

Well Name: San Juan 29-7 Unit #54B
Location: 785' FNL, 400' FWL Section 14, T-29-N, R-7-W
Rio Arriba County, New Mexico
Latitude 36° 43.9, Longitude 107° 32.8
Formation: Blanco Mesa Verde
Elevation: 6234' GL

<u>Formation Tops:</u>	<u>Top</u>	<u>Bottom</u>	<u>Contents</u>
Surface	San Jose	2165'	aquifer
Ojo Alamo	2165'	2281'	aquifer
Kirtland	2281'	2644'	
Fruitland	2644'	3058'	
Pictured Cliffs	3058'	3262'	gas
Lewis	3262'	3821'	gas
Intermediate TD	3362'		
Huerfanito Bentonite	3821'	4039'	
Chacra	4039'	4799'	
Massive Cliff House	4799'	4910'	gas
Menefee	4910'	5248'	gas
Massive Point Lookout	5248'	5654'	gas
Mancos Shale	5654'		
Total Depth	5648'		

Logging Program:

Cased hole logging - Gamma Ray Neutron
Coring/DST - none

Mud Program:

<u>Interval</u>	<u>Type</u>	<u>Weight</u>	<u>Vis.</u>	<u>Fluid Loss</u>
0- 200'	Spud	8.4-9.0	40-50	no control
200-3362'	LSND	8.4-9.0	30-60	no control
3362-5648'	Gas/Mist	n/a	n/a	n/a

Pit levels will be visually monitored to detect gain or loss of fluid control.

Casing Program (as listed, the equivalent, or better):

<u>Hole Size</u>	<u>Depth Interval</u>	<u>Csq. Size</u>	<u>Wt.</u>	<u>Grade</u>
12 1/4"	0' - 200'	9 5/8"	32.3#	H-40
8 3/4"	0' - 3362'	7"	20.0#	J-55
6 1/4"	3262' - 5648'	4 1/2"	10.5#	J-55

Tubing Program:

0' - 5648' 2 3/8" 4.7# J-55

BOP Specifications, Wellhead and Tests:

Surface to Intermediate TD -

11" 2000 psi minimum double gate BOP stack (Reference Figure #1).
After nipple-up prior to drilling out surface casing, rams and casing will be tested to 600 psi for 30 minutes.

BURLINGTON RESOURCES OIL & GAS COMPANY SAN JUAN 29-7 UNIT #54B

785' FNL & 400' FWL, SECTION 14, T29N, R7W, N.M.P.M.

RIO ARriba COUNTY, NEW MEXICO

APD MAP #1

NO' NEW CONSTRUCTION -
NWNW SECTION 14, T29N, R7W

