

(SUBMIT IN TRIPLICATE)
**UNITED STATES
DEPARTMENT OF THE INTERIOR
GEOLOGICAL SURVEY**

Land Office Santa Fe
Lease No. 078046
Unit J.F. Hughes

SUNDRY NOTICES AND REPORTS ON WELLS

NOTICE OF INTENTION TO DRILL.....	<input checked="" type="checkbox"/>	SUBSEQUENT REPORT OF WATER SHUT-OFF.....
NOTICE OF INTENTION TO CHANGE PLANS.....		SUBSEQUENT REPORT OF SHOOTING OR ACIDIZING.....
NOTICE OF INTENTION TO TEST WATER SHUT-OFF.....		SUBSEQUENT REPORT OF ALTERING CASING.....
NOTICE OF INTENTION TO RE-DRILL OR REPAIR WELL.....		SUBSEQUENT REPORT OF REDRILLING OR REPAIR.....
NOTICE OF INTENTION TO SHOOT OR ACIDIZE.....		SUBSEQUENT REPORT OF ABANDONMENT.....
NOTICE OF INTENTION TO PULL OR ALTER CASING.....		SUPPLEMENTARY WELL HISTORY.....
NOTICE OF INTENTION TO ABANDON WELL.....		

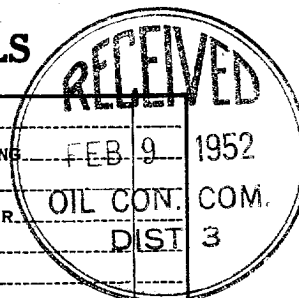

(INDICATE ABOVE BY CHECK MARK NATURE OF REPORT, NOTICE, OR OTHER DATA)

December 14, 1951

Well No. 3-B is located 970 ft. from N line and 1780 ft. from E line of sec. 20

SE NW NE Sec. 20 29N 8W N.M.P.M.
(1/4 Sec. and Sec. No.) (Twp.) (Range) (Meridian)
Blanco San Juan New Mexico
(Field) (County or Subdivision) (State or Territory)

The elevation of the derrick floor above sea level is 6061 ft. Ground.

DETAILS OF WORK

(State names of and expected depths to objective sands; show sizes, weights, and lengths of proposed casings; indicate mudding jobs, cementing points, and all other important proposed work)

Drill Mesa Verde Test with Rotary Tools to Top of Cliff House to approximate depth of 4268'. Set 7" O.D. casing on top of Cliff House and drill in with gas with Rotary Tools to an approximate depth of 5045'.

Set 175' - 10-3/4" O.D. 40# smls. casing cemented w/150 sacks.

Set 4268' - 7" O.D. 20# smls. casing cemented w/300 sack

Estimated Total Depth 5045'

Designated Drilling Unit E/2 Section 20.

I understand that this plan of work must receive approval in writing by the Geological Survey before operations may be commenced.

Company Three States Natural Gas Company

Address P.O. Box 911

Durango, Colorado

By John Carothers
John Carothers
Title Dist. Office Mgr.

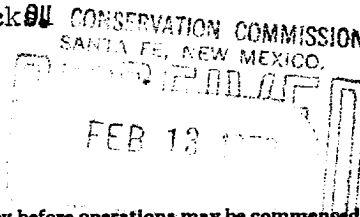

Company Three States Natural Gas Co.

Lease J. F. Hughes Well No. 3

Sec. 20 T. 29 N. R. 8 W., N.M.P.M.

Location 970' from the North line and 1780' from the East line,

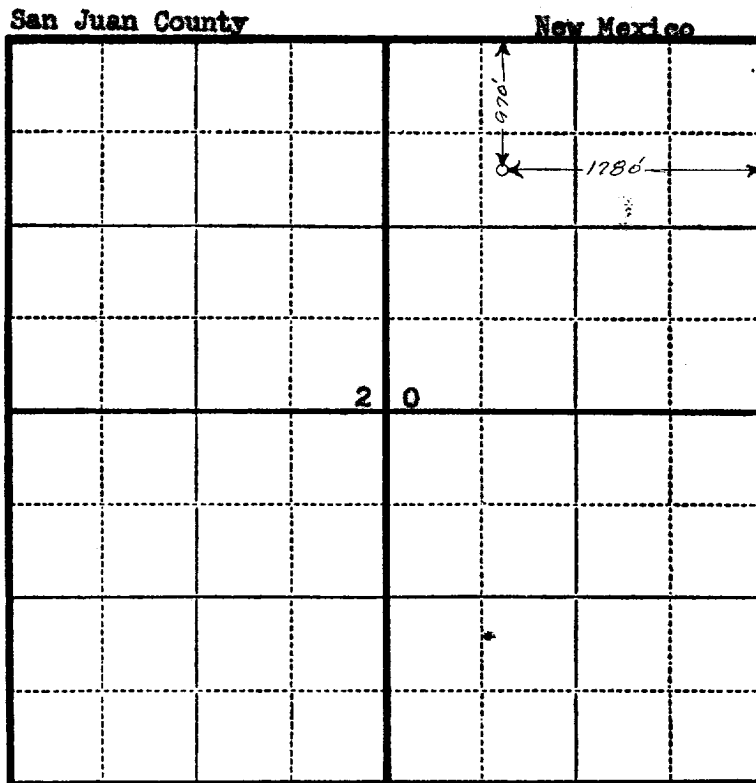

Scale—4 inches equals 1 mile.

This is to certify that the above plat was prepared from field notes of actual surveys made by me or under my supervision and that the same are true and correct to the best of my knowledge and belief.

Seal:

Registered Professional
Engineer and Land Surveyor.

Charles J. Finklea
Charles J. Finklea
N. Mex. Reg. No. 1302

Surveyed December 3, 1951.



Elevation Survey

RECEIVED
DEC 17 1951
OIL CON. SURVEY
FARMINGTON, N. M.

Company Three States Natural Gas Co.

Lease J. P. Hughes Well No. 3

Sec. 20 T. 29 N., R. 8 W., N.M.P.M.

Location 970' from the North line and 1700' from the East line.

San Juan County

New Mexico

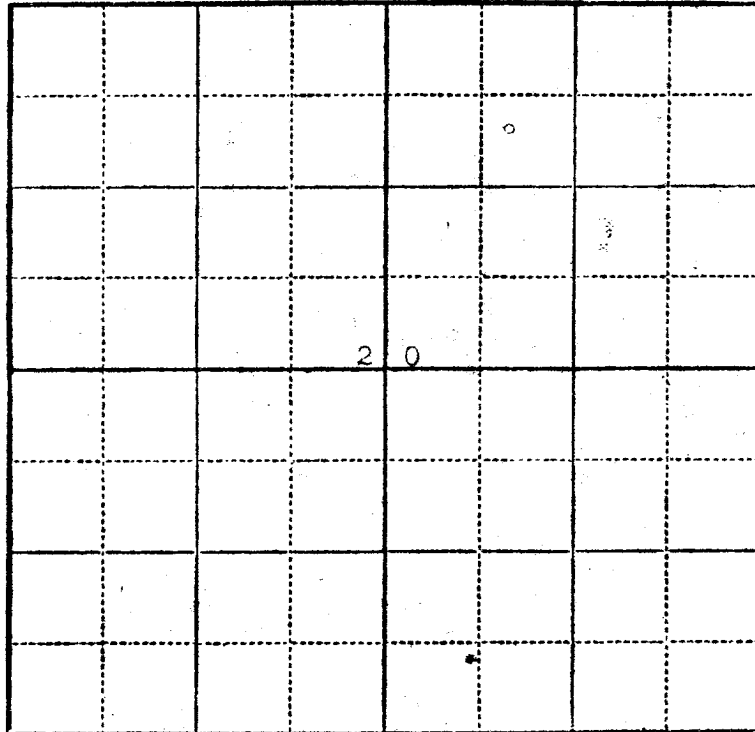

Scale—4 inches equals 1 mile.

Ungraded ground elevation 6061.1

Graded ground elevation

Derrick floor elevation

Temporary bench mark elevation

Remarks: Sea level datum.

SAN JUAN ENGINEERING CO.
Farmington, New Mexico

Date Surveyed December 4 19 51