

STATE OF NEW MEXICO
OIL CONSERVATION
COMMISSION
DISTRICT NO. 3
Phone 99 P. O. Box 697
AZTEC, NEW MEXICO

(SUBMIT IN TRIPLICATE)
UNITED STATES
DEPARTMENT OF THE INTERIOR
GEOLOGICAL SURVEY

Santa Fe
Land Office 076457
Lease No. 117 Sec. 4, 28th P. 31
Unit

RECEIVED

JAN 8 1953

SUNDRY NOTICES AND REPORTS ON WELLS
GEOLOGICAL SURVEY
WASHINGTON, D. C.

NOTICE OF INTENTION TO DRILL	<input checked="" type="checkbox"/>	SUBSEQUENT REPORT OF WATER SHUT-OFF	
NOTICE OF INTENTION TO CHANGE PLANS		SUBSEQUENT REPORT OF SHOOTING OR ACIDIZING	
NOTICE OF INTENTION TO TEST WATER SHUT-OFF		SUBSEQUENT REPORT OF ALTERING CASING	
NOTICE OF INTENTION TO RE-DRILL OR REPAIR WELL		SUBSEQUENT REPORT OF REDRILLING OR REPAIR	
NOTICE OF INTENTION TO SHOOT OR ACIDIZE		SUBSEQUENT REPORT OF ABANDONMENT	
NOTICE OF INTENTION TO PULL OR ALTER CASING		SUPPLEMENTARY WELL HISTORY	
NOTICE OF INTENTION TO ABANDON WELL			

(INDICATE ABOVE BY CHECK MARK NATURE OF REPORT, NOTICE, OR OTHER DATA)

December 29, 1952

19

Well No. 1 H111 is located 1650 ft. from N line and 1650 ft. from E line of sec. 4
NE 1/4 SW 1/4 Sec. 4 29 North 8 West N.M.P.M.
(1/4 Sec. and Sec. No.) (Twp.) (Range) (Meridian)
Blanco San Juan County New Mexico
(Field) (County or Subdivision) (State or Territory)

The elevation of the derrick floor above sea level is _____ ft. - To be furnished

DETAILS OF WORK

(State names of and expected depths to objective sands; show sizes, weights, and lengths of proposed casings; indicate mudding jobs, cementing points, and all other important proposed work)

The objective sands are the Cliff House and the Point Lookout and their respective tops are expected at about 4650 and 5225 feet.

Approximate casing program: 10-3/4" O.D. - 375', cemented with 75 sacks
7" O.D. 4650' " " 200 "

Well will be drilled with rotary tools to top of Cliff House, 7" production string set and cemented, and pay sands drilled with rotary using natural gas method to a total depth of approximately 5525'.

Well will be shot with approximately 1800 quarts of nitro glycerine

I understand that this plan of work must receive approval in writing by the Geological Survey before operations may be commenced.

Company SOUTHERN UNION GAS COMPANY

Address Burt Building

Dallas, Texas

By Van Thompson
Van Thompson

Title Manager Exploration Dept.



GEOLOGICAL SURVEY
 DEPARTMENT OF THE INTERIOR
 UNITED STATES
 (SUBMIT IN TRIPLICATE)

[illegible]

1. NAME _____
 2. DATE _____
 3. TIME _____
 4. LOCATION _____
 5. REMARKS _____
 6. SIGNATURE _____
 7. OFFICIAL _____
 8. UNIT _____
 9. GRADE _____
 10. POST OFFICE _____
 11. STATE _____
 12. CITY _____
 13. ZIP _____
 14. TELEPHONE _____
 15. TELETYPE _____
 16. FAX _____
 17. E-MAIL _____
 18. INTERNET _____
 19. OTHER _____
 20. REMARKS _____
 21. SIGNATURE _____
 22. OFFICIAL _____
 23. UNIT _____
 24. GRADE _____
 25. POST OFFICE _____
 26. STATE _____
 27. CITY _____
 28. ZIP _____
 29. TELEPHONE _____
 30. TELETYPE _____
 31. FAX _____
 32. E-MAIL _____
 33. INTERNET _____
 34. OTHER _____
 35. REMARKS _____
 36. SIGNATURE _____
 37. OFFICIAL _____
 38. UNIT _____
 39. GRADE _____
 40. POST OFFICE _____
 41. STATE _____
 42. CITY _____
 43. ZIP _____
 44. TELEPHONE _____
 45. TELETYPE _____
 46. FAX _____
 47. E-MAIL _____
 48. INTERNET _____
 49. OTHER _____
 50. REMARKS _____
 51. SIGNATURE _____
 52. OFFICIAL _____
 53. UNIT _____
 54. GRADE _____
 55. POST OFFICE _____
 56. STATE _____
 57. CITY _____
 58. ZIP _____
 59. TELEPHONE _____
 60. TELETYPE _____
 61. FAX _____
 62. E-MAIL _____
 63. INTERNET _____
 64. OTHER _____
 65. REMARKS _____
 66. SIGNATURE _____
 67. OFFICIAL _____
 68. UNIT _____
 69. GRADE _____
 70. POST OFFICE _____
 71. STATE _____
 72. CITY _____
 73. ZIP _____
 74. TELEPHONE _____
 75. TELETYPE _____
 76. FAX _____
 77. E-MAIL _____
 78. INTERNET _____
 79. OTHER _____
 80. REMARKS _____
 81. SIGNATURE _____
 82. OFFICIAL _____
 83. UNIT _____
 84. GRADE _____
 85. POST OFFICE _____
 86. STATE _____
 87. CITY _____
 88. ZIP _____
 89. TELEPHONE _____
 90. TELETYPE _____
 91. FAX _____
 92. E-MAIL _____
 93. INTERNET _____
 94. OTHER _____
 95. REMARKS _____
 96. SIGNATURE _____
 97. OFFICIAL _____
 98. UNIT _____
 99. GRADE _____
 100. POST OFFICE _____
 101. STATE _____
 102. CITY _____
 103. ZIP _____
 104. TELEPHONE _____
 105. TELETYPE _____
 106. FAX _____
 107. E-MAIL _____
 108. INTERNET _____
 109. OTHER _____
 110. REMARKS _____
 111. SIGNATURE _____
 112. OFFICIAL _____
 113. UNIT _____
 114. GRADE _____
 115. POST OFFICE _____
 116. STATE _____
 117. CITY _____
 118. ZIP _____
 119. TELEPHONE _____
 120. TELETYPE _____
 121. FAX _____
 122. E-MAIL _____
 123. INTERNET _____
 124. OTHER _____
 125. REMARKS _____
 126. SIGNATURE _____
 127. OFFICIAL _____
 128. UNIT _____
 129. GRADE _____
 130. POST OFFICE _____
 131. STATE _____
 132. CITY _____
 133. ZIP _____
 134. TELEPHONE _____
 135. TELETYPE _____
 136. FAX _____
 137. E-MAIL _____
 138. INTERNET _____
 139. OTHER _____
 140. REMARKS _____
 141. SIGNATURE _____
 142. OFFICIAL _____
 143. UNIT _____
 144. GRADE _____
 145. POST OFFICE _____
 146. STATE _____
 147. CITY _____
 148. ZIP _____
 149. TELEPHONE _____
 150. TELETYPE _____
 151. FAX _____
 152. E-MAIL _____
 153. INTERNET _____
 154. OTHER _____
 155. REMARKS _____
 156. SIGNATURE _____
 157. OFFICIAL _____
 158. UNIT _____
 159. GRADE _____
 160. POST OFFICE _____
 161. STATE _____
 162. CITY _____
 163. ZIP _____
 164. TELEPHONE _____
 165. TELETYPE _____
 166. FAX _____
 167. E-MAIL _____
 168. INTERNET _____
 169. OTHER _____
 170. REMARKS _____
 171. SIGNATURE _____
 172. OFFICIAL _____
 173. UNIT _____
 174. GRADE _____
 175. POST OFFICE _____
 176. STATE _____
 177. CITY _____
 178. ZIP _____
 179. TELEPHONE _____
 180. TELETYPE _____
 181. FAX _____
 182. E-MAIL _____
 183. INTERNET _____
 184. OTHER _____
 185. REMARKS _____
 186. SIGNATURE _____
 187. OFFICIAL _____
 188. UNIT _____
 189. GRADE _____
 190. POST OFFICE _____
 191. STATE _____
 192. CITY _____
 193. ZIP _____
 194. TELEPHONE _____
 195. TELETYPE _____
 196. FAX _____
 197. E-MAIL _____
 198. INTERNET _____
 199. OTHER _____
 200. REMARKS _____
 201. SIGNATURE _____
 202. OFFICIAL _____
 203. UNIT _____
 204. GRADE _____
 205. POST OFFICE _____
 206. STATE _____
 207. CITY _____
 208. ZIP _____
 209. TELEPHONE _____
 210. TELETYPE _____
 211. FAX _____
 212. E-MAIL _____
 213. INTERNET _____
 214. OTHER _____
 215. REMARKS _____
 216. SIGNATURE _____
 217. OFFICIAL _____
 218. UNIT _____
 219. GRADE _____
 220. POST OFFICE _____
 221. STATE _____
 222. CITY _____
 223. ZIP _____
 224. TELEPHONE</

1. The first of these is the fact that the "new" and "old" versions of the document are identical in all respects, including the spelling of names and the use of capital letters. This suggests that the two versions were produced by the same person or group of people.

Witnessed and sworn before me this 14th day of June 1964

...and that this plan of work must be a

2000 2001 2002 2003 2004 2005 2006 2007 2008 2009 2010 2011 2012 2013 2014 2015 2016 2017 2018 2019 2020 2021 2022 2023 2024 2025 2026 2027 2028 2029 2030 2031 2032 2033 2034 2035 2036 2037 2038 2039 2040 2041 2042 2043 2044 2045 2046 2047 2048 2049 2050 2051 2052 2053 2054 2055 2056 2057 2058 2059 2060 2061 2062 2063 2064 2065 2066 2067 2068 2069 2070 2071 2072 2073 2074 2075 2076 2077 2078 2079 2080 2081 2082 2083 2084 2085 2086 2087 2088 2089 2090 2091 2092 2093 2094 2095 2096 2097 2098 2099 2100 2101 2102 2103 2104 2105 2106 2107 2108 2109 2110 2111 2112 2113 2114 2115 2116 2117 2118 2119 2120 2121 2122 2123 2124 2125 2126 2127 2128 2129 2130 2131 2132 2133 2134 2135 2136 2137 2138 2139 2140 2141 2142 2143 2144 2145 2146 2147 2148 2149 2150 2151 2152 2153 2154 2155 2156 2157 2158 2159 2160 2161 2162 2163 2164 2165 2166 2167 2168 2169 2170 2171 2172 2173 2174 2175 2176 2177 2178 2179 2180 2181 2182 2183 2184 2185 2186 2187 2188 2189 2190 2191 2192 2193 2194 2195 2196 2197 2198 2199 2200 2201 2202 2203 2204 2205 2206 2207 2208 2209 2210 2211 2212 2213 2214 2215 2216 2217 2218 2219 2220 2221 2222 2223 2224 2225 2226 2227 2228 2229 2230 2231 2232 2233 2234 2235 2236 2237 2238 2239 2240 2241 2242 2243 2244 2245 2246 2247 2248 2249 2250 2251 2252 2253 2254 2255 2256 2257 2258 2259 2260 2261 2262 2263 2264 2265 2266 2267 2268 2269 2270 2271 2272 2273 2274 2275 2276 2277 2278 2279 2280 2281 2282 2283 2284 2285 2286 2287 2288 2289 2290 2291 2292 2293 2294 2295 2296 2297 2298 2299 2300 2301 2302 2303 2304 2305 2306 2307 2308 2309 2310 2311 2312 2313 2314 2315 2316 2317 2318 2319 2320 2321 2322 2323 2324 2325 2326 2327 2328 2329 2330 2331 2332 2333 2334 2335 2336 2337 2338 2339 2340 2341 2342 2343 2344 2345 2346 2347 2348 2349 2350 2351 2352 2353 2354 2355 2356 2357 2358 2359 2360 2361 2362 2363 2364 2365 2366 2367 2368 2369 2370 2371 2372 2373 2374 2375 2376 2377 2378 2379 2380 2381 2382 2383 2384 2385 2386 2387 2388 2389 2390 2391 2392 2393 2394 2395 2396 2397 2398 2399 2400 2401 2402 2403 2404 2405 2406 2407 2408 2409 2410 2411 2412 2413 2414 2415 2416 2417 2418 2419 2420 2421 2422 2423 2424 2425 2426 2427 2428 2429 2430 2431 2432 2433 2434 2435 2436 2437 2438 2439 2440 2441 2442 2443 2444 2445 2446 2447 2448 2449 2450 2451 2452 2453 2454 2455 2456 2457 2458 2459 2460 2461 2462 2463 2464 2465 2466 2467 2468 2469 2470 2471 2472 2473 2474 2475 2476 2477 2478 2479 2480 2481 2482 2483 2484 2485 2486 2487 2488 2489 2490 2491 2492 2493 2494 2495 2496 2497 2498 2499 2500 2501 2502 2503 2504 2505 2506 2507 2508 2509 2510 2511 2512 2513 2514 2515 2516 2517 2518 2519 2520 2521 2522 2523 2524 2525 2526 2527 2528 2529 2530 2531 2532 2533 2534 2535 2536 2537 2538 2539 2540 2541 2542 2543 2544 2545 2546 2547 2548 2549 2550 2551 2552 2553 2554 2555 2556 2557 2558 2559 2560 2561 2562 2563 2564 2565 2566 2567 2568 2569 2570 2571 2572 2573 2574 2575 2576 2577 2578 2579 2580 2581 2582 2583 2584 2585 2586 2587 2588 2589 2590 2591 2592 2593 2594 2595 2596 2597 2598 2599 2600 2601 2602 2603 2604 2605 2606 2607 2608 2609 2610 2611 2612 2613 2614 2615 2616 2617 2618 2619 2620 2621 2622 2623 2624 2625 2626 2627 2628 2629 2630 2631 2632 2633 2634 2635 2636 2637 2638 2639 2640 2641 2642 2643 2644 2645 2646 2647 2648 2649 2650 2651 2652 2653 2654 2655 2656 2657 2658 2659 2660 2661 2662 2663 2664 2665 2666 2667 2668 2669 2670 2671 2672 2673 2674 2675 2676 2677 2678 2679 2680 2681 2682 2683 2684 2685 2686 2687 2688 2689 2690 2691 2692 2693 2694 2695 2696 2697 2698 2699 2700 2701 2702 2703 2704 2705 2706 2707 2708 2709 2710 2711 2712 2713 2714 2715 2716 2717 2718 2719 2720 2721 2722 2723 2724 2725 2726 2727 2728 2729 2730 2731 2732 2733 2734 2735 2736 2737 2738 2739 2740 2741 2742 2743 2744 2745 2746 2747 2748 2749 2750 2751 2752 2753 2754 2755 2756 2757 2758 2759 2760 2761 2762 2763 2764 2765 2766 2767 2768 2769 2770 2771 2772 2773 2774 2775 2776 2777 2778 2779 2780 2781 2782 2783 2784 2785 2786 2787 2788 2789 2790 2791 2792 2793 2794 2795 2796 2797 2798 2799 2800 2801 2802 2803 2804 2805 2806 2807 2808 2809 2810 2811 2812 2813 2814 2815 2816 2817 2818

225

100-443887-100



RECEIVED

1953
OIL CON. SURVEY
TAMING CO. N. M.

Company Southern Union Gas Company

Lease 2111 Well No. 1

Sec. 4, T. 29 N., R. 8 W., N.M.P.M.

Location 1650' from the South line and 1650' from the West line.

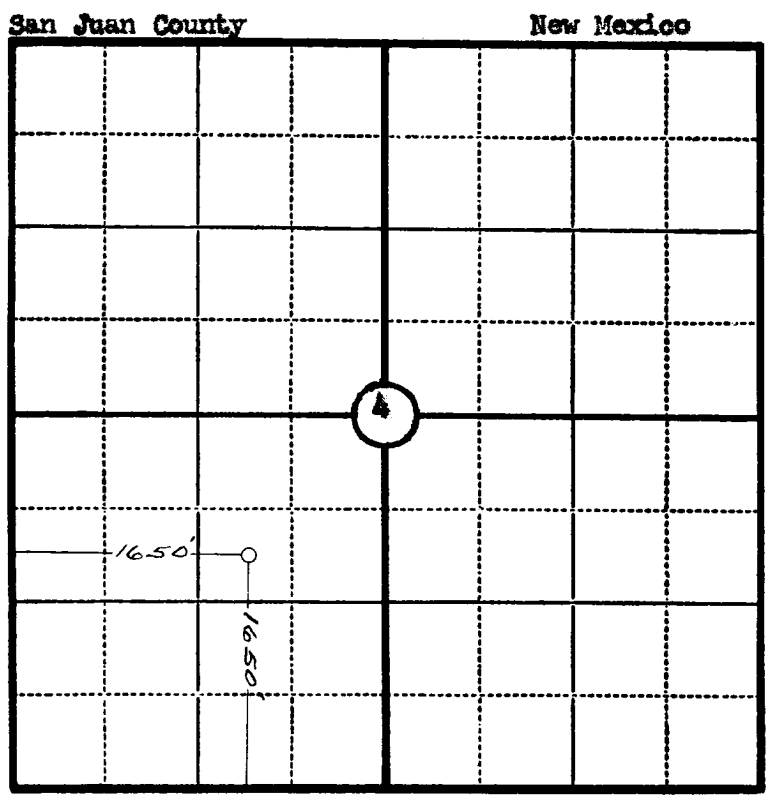

Scale—4 inches equal 1 mile.

This is to certify that the above plat was prepared from field notes of actual surveys made by me or under my supervision and that the same are true and correct to the best of my knowledge and belief.

Charles J. Finklea

Seal:

Registered Professional
Engineer and Land Surveyor.

Charles J. Finklea
N. Mex. Reg. No. 1302



Surveyed December 23, 19 52