

NO. OF COPIES RECEIVED	6
DISTRIBUTION	
SANTA FE	1
FILE	1
U.S.G.S.	2
LAND OFFICE	1
OPERATOR	1

NEW MEXICO OIL CONSERVATION COMMISSION

30-049-02809

Form C-101
Revised 1-1-65

5A. Indicate Type of Lease	
STATE <input checked="" type="checkbox"/>	FEE <input type="checkbox"/>
5. State Oil & Gas Lease No. E-5226-1	

APPLICATION FOR PERMIT TO DRILL, DEEPEN, OR PLUG BACK

1a. Type of Work DRILL <input checked="" type="checkbox"/> DEEPEN <input type="checkbox"/> PLUG BACK <input type="checkbox"/>		7. Unit Agreement Name
b. Type of Well OIL WELL <input type="checkbox"/> GAS WELL <input checked="" type="checkbox"/> OTHER <input type="checkbox"/> SINGLE ZONE <input checked="" type="checkbox"/> MULTIPLE ZONE <input type="checkbox"/>		8. Farm or Lease Name State Com
2. Name of Operator Mesa Petroleum Company		9. Well No. 46
3. Address of Operator Box 2009, Amarillo, Texas 79105		10. Field and Pool, or Well at Kuntz P. C. West
4. Location of Well UNIT LETTER H LOCATED 1450 FEET FROM THE north LINE AND 1160 FEET FROM THE east LINE OF SEC. 16 TWP. 29N RGE. 8W NMPM		12. County San Juan
19. Proposed Depth 3275		19A. Formation Pictured Cliff
20. Rotary or C.T. rotary		
21. Elevations (Show whether DF, RT, etc.) 6391 GL	21A. Kind & Status Plug. Bond State	21B. Drilling Contractor unknown
22. Approx. Date Work will start February 1, 1978		

23.

PROPOSED CASING AND CEMENT PROGRAM

SIZE OF HOLE	SIZE OF CASING	WEIGHT PER FOOT	SETTING DEPTH	SACKS OF CEMENT	EST. TOP
12 1/4"	8 5/8	24	150	110	surface
6 1/4"	3 1/2	9.2	3275	400	surface

Move in and rig up rotary tools. Drill 12 1/4" hole to 150. Run cement casing as above. Install BOP and test same. Drill 6" hole to total depth 3275. Run open hole logs IES, FDC-CNL. If commercial production is indicated 3 1/2" casing will be run and cemented as above. If the well is non-commercial, same will be plugged and abandoned as per Oil Conservation Commission specifications.

3-15-78

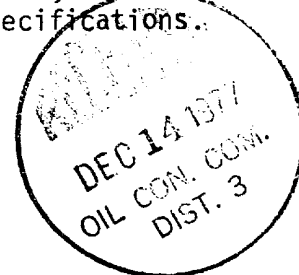

IN ABOVE SPACE DESCRIBE PROPOSED PROGRAM; IF PROPOSAL IS TO DEEPEN OR PLUG BACK, GIVE DATA ON PRESENT PRODUCTIVE ZONE AND PROPOSED NEW PRODUCTIVE ZONE. GIVE BLOWOUT PREVENTER PROGRAM, IF ANY.

I hereby certify that the information above is true and complete to the best of my knowledge and belief.

Signed William T. Jones Title Agent Date December 13, 1977
(This space for State Use)

APPROVED BY AK Dendrick TITLE Commissioner DATE 12/13/77
CONDITIONS OF APPROVAL, IF ANY:

NEW MEXICO OIL CONSERVATION COMMISSION
WELL LOCATION AND ACREAGE DEDICATION PLAT

Form C-102
Supersedes C-128
Effective 1-1-65

All distances must be from the outer boundaries of the Section.

Operator Mesa Petroleum Company			Lease State Com		Well No. 16
Unit Letter H	Section 16	Township 29N	Range 8W	County San Juan	
Actual Footage Location of Well: 1450 feet from the North line and 1160 feet from the East line					
Ground Level Elev. 6391	Producing Formation Pictured Cliff		Pool Kuntz Pictured Cliff West	Dedicated Acreage 160 Acres	

1. Outline the acreage dedicated to the subject well by colored pencil or hachure marks on the plat below.
2. If more than one lease is dedicated to the well, outline each and identify the ownership thereof (both as to working interest and royalty).
3. If more than one lease of different ownership is dedicated to the well, have the interests of all owners been consolidated by communitization, unitization, force-pooling, etc?

☐ Yes ☐ No If answer is "yes," type of consolidation _____

If answer is "no," list the owners and tract descriptions which have actually been consolidated. (Use reverse side of this form if necessary.) _____

No allowable will be assigned to the well until all interests have been consolidated (by communitization, unitization, forced-pooling, or otherwise) or until a non-standard unit, eliminating such interests, has been approved by the Commission.

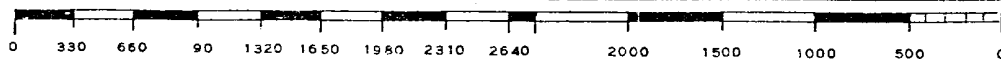
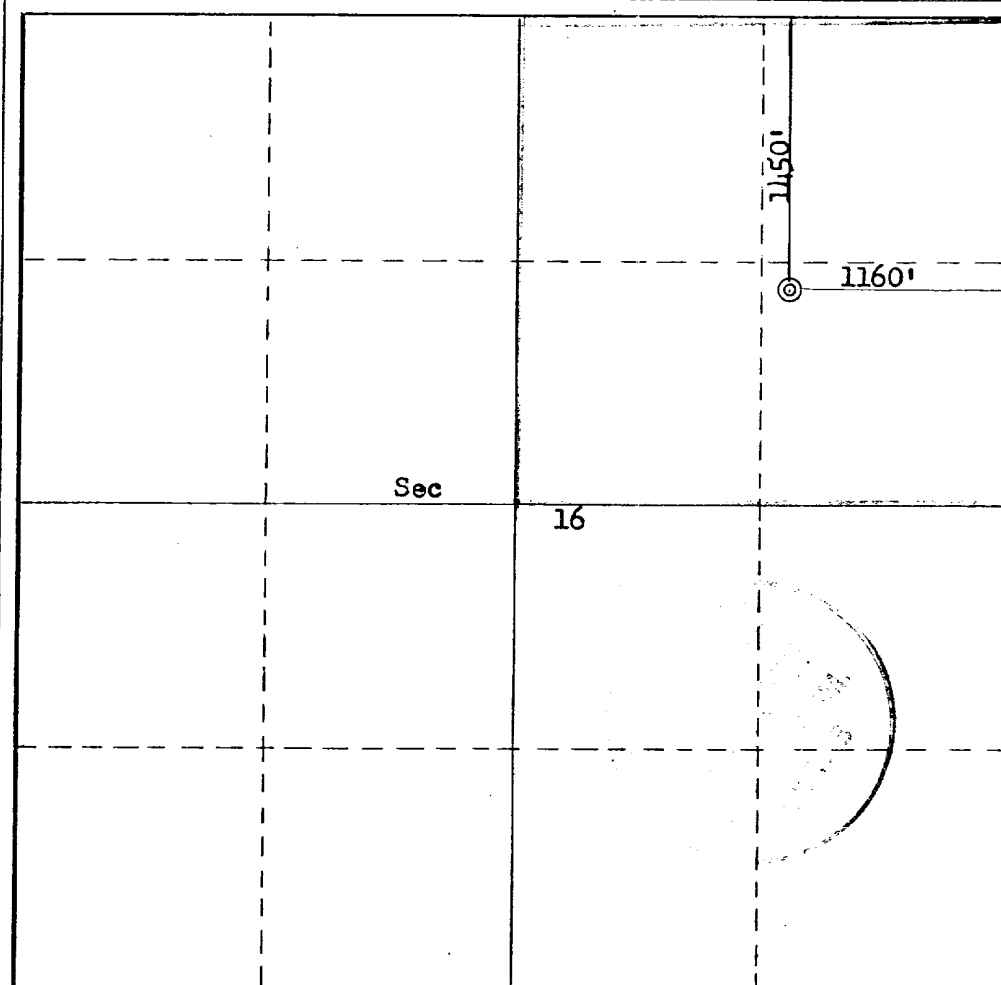

CERTIFICATION

I hereby certify that the information contained herein is true and complete to the best of my knowledge and belief.

William T. Jones
Name
William T. Jones

Position
Agent

Company
Mesa Petroleum Company

Date
December 13, 1977

I hereby certify that the well location shown on this plat was plotted from field notes of actual surveys made by me or under my supervision, and that the same is true and correct to the best of my knowledge and belief.

Date Surveyed
December 12, 1977

Registered Professional Engineer and/or Land Surveyor

Fred B. Kerr Jr.
Fred B. Kerr Jr.

Certificate No.

3950

Vicinity Map for
MESA PETROLEUM CO. #46 State Com
11450'FNL 1160'FEL Sec 16-T29N-R8W
San Juan County, New Mexico

Vicinity Map for
MESA PETROLEUM CO. #46 State Com
1450'FNL 1160'FEL Sec 16-T29N-R8W
San Juan County, New Mexico