

NEW MEXICO OIL CONSERVATION COMMISSION WELL LOCATION AND ACREAGE DEDICATION PLAT

Form C-102
Supersedes C-130
Effective 1-1-85

All distances must be from the outer boundaries of the Section.

TENNECO OIL COMPANY			Lease HUGHES A LS		Well No. 2B
Section 27	Township 29 N	Range 8 W	County SAN JUAN		
Footage Location of Well: 1125 feet from the North line and 1828 feet from the East line	Dedicated Acreage: 320 Acres				
Producing Formation Blanco Mesaverde	Pool Mesaverde				
Level Elev. 6747					

Outline the acreage dedicated to the subject well by colored pencil or hatchure marks on the plat below.

2. If more than one lease is dedicated to the well, outline each and identify the ownership thereof (both as to working interest and royalty).

3. If more than one lease of different ownership is dedicated to the well, have the interests of all owners been consolidated by communitization, unitization, force-pooling, etc?

☐ Yes ☐ No If answer is "yes," type of consolidation _____

If answer is "no," list the owners and tract descriptions which have actually been consolidated. (Use reverse side of this form if necessary.) _____

No allowable will be assigned to the well until all interests have been consolidated (by communitization, unitization, forced-pooling, or otherwise) or until a non-standard unit, eliminating such interests, has been approved by the Commission.

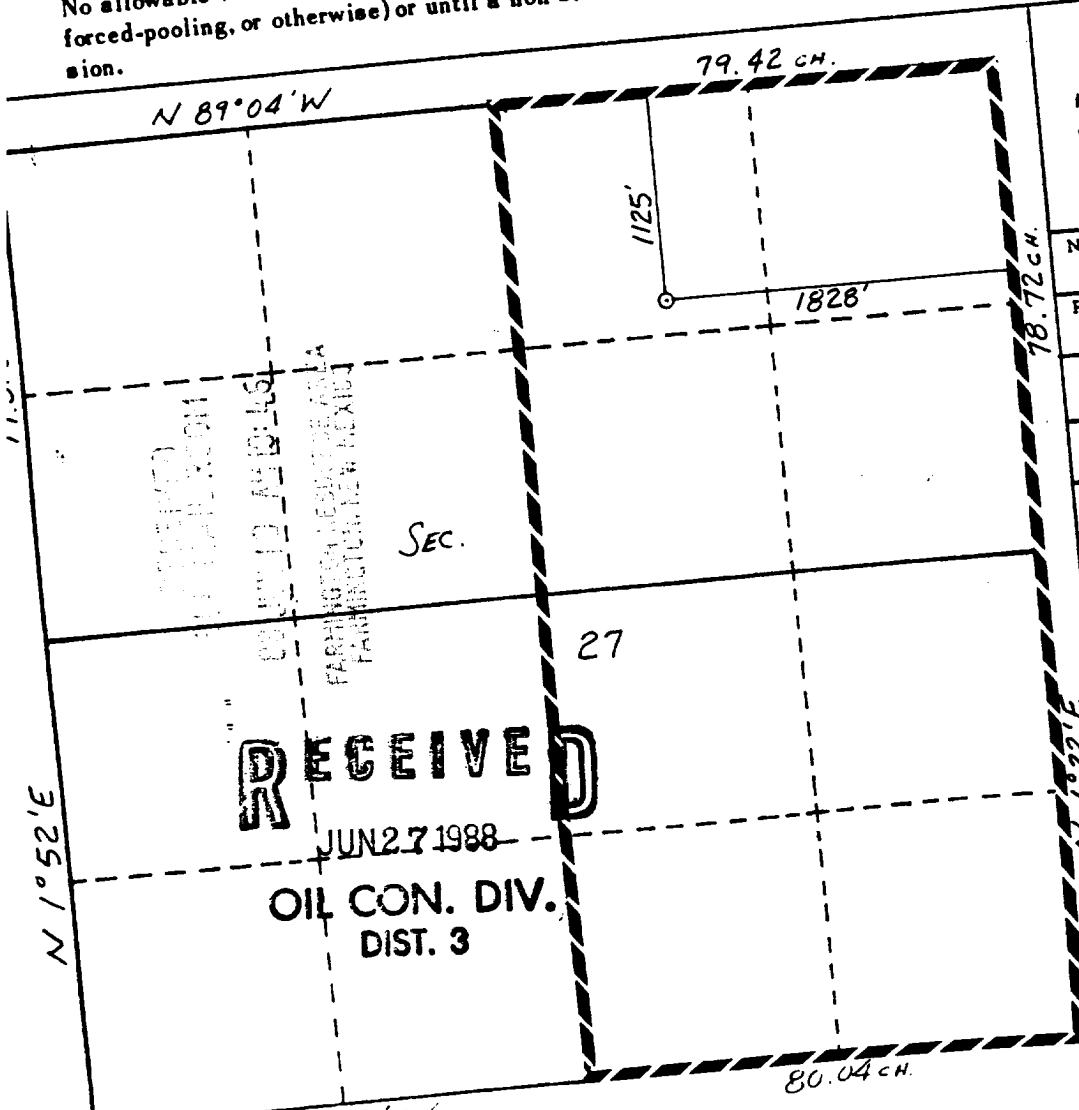

CERTIFICATION

I hereby certify that the information contained herein is true and complete to the best of my knowledge and belief.

Name Niles V. Jokela

Position Staff Analyst

Company Tenneco Oil Company

Date 5/5/88

I hereby certify that the well location shown on this plat was plotted from field notes of actual surveys made by me or under my supervision, and that the same is true and correct to the best of my knowledge and belief.

Date Surveyed
William E. Mahnke
Registered Professional Engineer
and Land Surveyor

Certificate No. 8466