

All distances must be from the outer boundaries of the Section.

Operator MERIDIAN OIL INC.			Lease DAY		Well No. #201
Unit Letter K	Section 17	Township 29 N.	Range 8 W.	County San Juan	
Actual Footage Location of Wells 1425 feet from the SOUTH line and 1425 feet from the WEST line					
Ground Level Elev. 6425	Producing Formation Fruitland Coal		Pool Undesignated		Dedicated Acreage: Acres

1. Outline the acreage dedicated to the subject well by colored pencil or hachure marks on the plat below.
2. If more than one lease is dedicated to the well, outline each and identify the ownership thereof (both as to working interest and royalty).
3. If more than one lease of different ownership is dedicated to the well, have the interests of all owners been consolidated by communitization, unitization, force-pooling, etc?

☐ Yes ☐ No If answer is "yes," type of consolidation _____

If answer is "no," list the owners and tract descriptions which have actually been consolidated. (Use reverse side of this form if necessary.) _____

No allowable will be assigned to the well until all interests have been consolidated (by communitization, unitization, forced-pooling, or otherwise) or until a non-standard unit, eliminating such interests, has been approved by the Division.

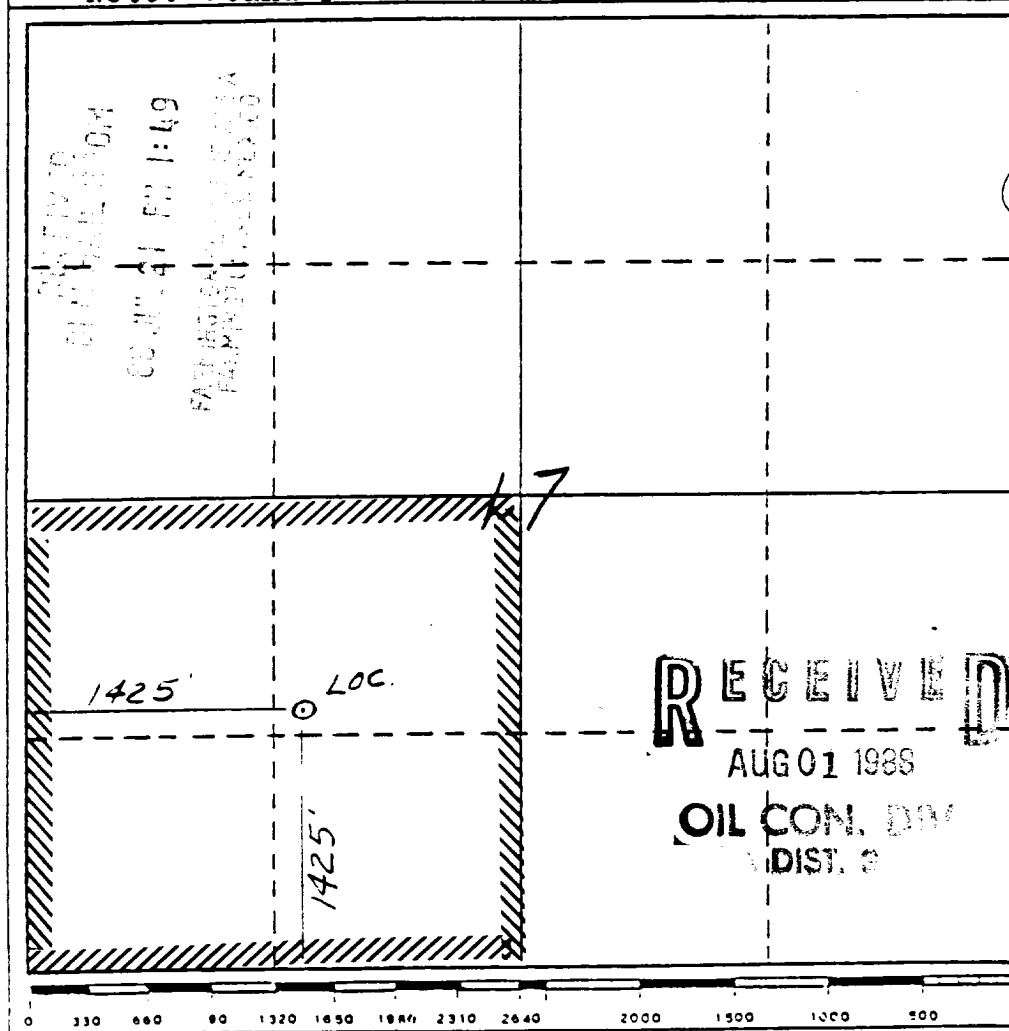
***Note: Standard Location**

CERTIFICATION

I hereby certify that the information contained herein is true and complete to the best of my knowledge and belief.

Name
Regulatory AffairsPosition
Meridian Oil Inc.Company
7-21-88

Date

I hereby certify that the well location shown on this plat was proved from field notes of actual surveys made by me or under my supervision and that the same is true and correct to the best of my knowledge and belief.

Date Surveyed
6-9-88

Registered Land Surveyor

Neale C. Edwards

Certificate No.
6357

