

UNITED STATES
DEPARTMENT OF THE INTERIOR
BUREAU OF LAND MANAGEMENT

SUBMIT IN TRIPLICATE
(Other instructions on re-
verse side)

Budget Bureau No. 1004-0135
Expires August 31, 1985

SUNDRY NOTICES AND REPORTS ON WELLS

(Do not use this form for proposals to drill or to deepen or plug back to a different reservoir.
Use "APPLICATION FOR PERMIT" for such proposals.)

1. <input type="checkbox"/> OIL WELL <input type="checkbox"/> GAS WELL <input checked="" type="checkbox"/> OTHER	7. UNIT AGREEMENT NAME
2. NAME OF OPERATOR Meridian Oil Inc.	8. FARM OR LEASE NAME Day
3. ADDRESS OF OPERATOR P.O. Box 4289, Farmington, NM 87499	9. WELL NO. 201
4. LOCATION OF WELL (Report location clearly and in accordance with any State requirements. See also space 17 below.) At surface 1450'S, 1450'W 25 25	10. FIELD AND POOL, OR WILDCAT Basin Fruitland Coal
11. SEC., T., S., M., OR S.E. AND SURVEY OR AREA Sec. 17, T29N, R8W NMPM	12. COUNTY OR PARISH 13. STATE San Juan NM
14. PERMIT NO.	15. ELEVATIONS (Show whether OF, TO, OR, etc.) 6425' GL

16. Check Appropriate Box To Indicate Nature of Notice, Report, or Other Data

NOTICE OF INTENTION TO:		SUBSEQUENT REPORT OF:	
TEST WATER SHUT-OFF	<input type="checkbox"/>	WATER SHUT-OFF	<input type="checkbox"/>
FRAC TURE TREAT	<input type="checkbox"/>	FRAC TURE TREATMENT	<input type="checkbox"/>
SHOOT OR ACIDIZE	<input type="checkbox"/>	SHOOTING OR ACIDIZING	<input type="checkbox"/>
REPAIR WELL	<input type="checkbox"/>	(Other)	<input type="checkbox"/>
(Other) Revision	<input checked="" type="checkbox"/>		

17. DESCRIBE PROPOSED OR COMPLETED OPERATIONS (Include state all pertinent details, and give pertinent dates, including estimated date of starting any proposed work. If well is directionally drilled, give subsurface locations and measured and true vertical depths for all markers and zones pertinent to this work.)

Attached is a copy of the C102 showing the revised pool & dedication.

RECEIVED

DEC 28 1983

BUREAU OF LAND MANAGEMENT
FARMINGTON RESOURCE AREA

19. I hereby certify that the foregoing is true and correct

SIGNED [Signature] TITLE Regulatory Affairs DATE 12/23/83 SP

(This space for Federal or State office use)

APPROVED BY _____ TITLE _____ DATE 12/28/83

CONDITIONS OF APPROVAL, IF ANY:

FARMINGTON RESOURCE AREA

BY [Signature]

*See Instructions on Reverse Side

Title 18 U.S.C. Section 1001, makes it a crime for any person knowingly and willfully to make to any department or agency of the United States any false, fictitious or fraudulent statements or representations as to any matter within its jurisdiction.

All distances must be from the outer boundaries of the Section.

Operator MERIDIAN OIL INC.			Lease DAY		Well No. #201
Unit Letter K	Section 17	Township 29 N.	Range 8 W.	County San Juan	
Actual Footage Location of Well: 1425 feet from the SOUTH line and 1425 feet from the WEST line					
Ground Level Elev. 6425	Producing Formation Fruitland Coal		Pool Basin	Dedicated Acreage: 320 Acres	

1. Outline the acreage dedicated to the subject well by colored pencil or hachure marks on the plat below.
2. If more than one lease is dedicated to the well, outline each and identify the ownership thereof (both as to working interest and royalty).
3. If more than one lease of different ownership is dedicated to the well, have the interests of all owners been consolidated by communitization, unitization, force-pooling, etc?

☐ Yes ☐ No If answer is "yes," type of consolidation _____

If answer is "no," list the owners and tract descriptions which have actually been consolidated. (Use reverse side of this form if necessary.) _____

No allowable will be assigned to the well until all interests have been consolidated (by communitization, unitization, forced-pooling, or otherwise) or until a non-standard unit, eliminating such interests, has been approved by the Division.

*Note: Standard Location

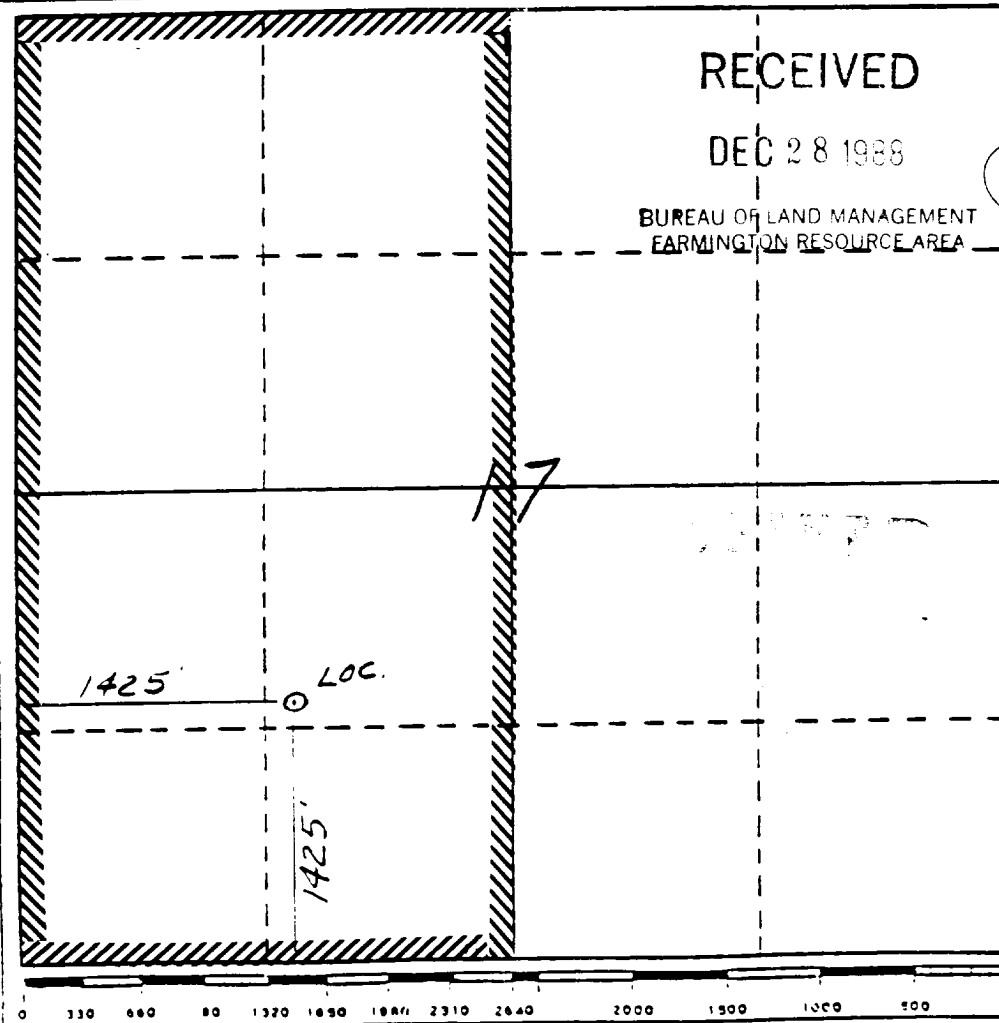

CERTIFICATION

I hereby certify that the information contained herein is true and complete to the best of my knowledge and belief.

Name

Regulatory Affairs

Position

Meridian Oil Inc

Company

12-23-88

Date

I have surveyed the well location shown on this plat and from field notes of actual surveys made by me or under my supervision and that the same is true and correct to the best of my knowledge and belief.

Date Surveyed

6-9-88

Registered Land Surveyor

Neale C. Edwards

Certificate No.

6357