

UNITED STATES
DEPARTMENT OF THE INTERIOR
BUREAU OF LAND MANAGEMENT

APPLICATION FOR PERMIT TO DRILL, DEEPEN, OR PLUG BACK

1a. TYPE OF WORK DRILL <input checked="" type="checkbox"/> DEEPEN <input type="checkbox"/> PLUG BACK <input type="checkbox"/>		22 PM 2:16	
b. TYPE OF WELL OIL WELL <input type="checkbox"/> GAS WELL <input checked="" type="checkbox"/> OTHER <input type="checkbox"/>		FARMINGTON SINGLE ZONE <input checked="" type="checkbox"/> MULTIPLE ZONE <input type="checkbox"/>	
2. NAME OF OPERATOR Meridian Oil Inc.			
3. ADDRESS OF OPERATOR PO Box 4289, Farmington, NM 87499			
4. LOCATION OF WELL (Report location clearly and in accordance with any State requirements.) At surface 865'S, 1770'W At proposed prod. zone			
14. DISTANCE IN MILES AND DIRECTION FROM NEAREST TOWN OR POST OFFICE* 10 miles to Blanco, NM			
15. DISTANCE FROM PROPOSED* LOCATION TO NEAREST PROPERTY OR LEASE LINE, FT. (Also to nearest drig. unit line, if any) 935'		16. NO. OF ACRES IN LEASE 644.52	
18. DISTANCE FROM PROPOSED LOCATION* TO NEAREST WELL, DRILLING, COMPLETED, OR APPLIED FOR, ON THIS LEASE, FT. 800'		19. PROPOSED DEPTH 3075'	
17. NO. OF ACRES ASSIGNED TO THIS WELL 160.00		20. ROTARY OR CABLE TOOLS Rotary	
21. ELEVATIONS (Show whether DF, RT, GR, etc.) 6422' GL		22. APPROX. DATE WORK WILL START*	
23. DRILLING OPERATIONS AUTHORIZED ARE SUBJECT TO COMPLIANCE WITH ATTACHED PROPOSED CASING AND CEMENTING PROGRAM "GENERAL REQUIREMENTS"			
This action is subject to technical and procedural review pursuant to 43 CFR 3165.3 and appeal pursuant to 43 CFR 3165.4.			
SIZE OF HOLE	SIZE OF CASING	WEIGHT PER FOOT	SETTING DEPTH
12 1/4"	9 5/8"	32.3#	200'
8 3/4"	7"	20.0#	2930'
6 1/4"	5 1/2" inner	23.0#	3075'
QUANTITY OF CEMENT		130 cf. circulated 950 cf circ. surface do not cement	

The Fruitland coal formation will be completed.

A 3000 psi WP and 6000 psi test double gate preventer equipped with blind and pipe rams will be used for blow out prevention on this well.

This gas is dedicated.

The SW/4 of Section 5 is dedicated to this well.

RECEIVED
AUG 29 1988
OIL CON. DIV.

IN ABOVE SPACE DESCRIBE PROPOSED PROGRAM: If proposal is to deepen or plug back, give data on present productive zone and proposed new productive zone. If proposal is to drill or deepen directionally, give pertinent data on subsurface locations and measured and true vertical depths. Give blowout preventer program, if any.

24. SIGNED [Signature] TITLE Regulatory Affairs DATE 08-18-88

(This space for Federal or State office use)

"Approval of this action does

APPROVAL DATE

not warrant that the applicant

holds legal or equitable rights

or title to this lease."

TITLE

NM000

*See Instructions On Reverse Side

Title 18 U.S.C. Section 1001, makes it a crime for any person knowingly and willfully to make to any department or agency of the United States any false, fictitious or fraudulent statements or representations as to any matter within its jurisdiction.

All distances must be from the outer boundaries of the Section.

Operator Meridian Oil Inc.		Lease Sunray (SF-078487C)		Well No. 211
Unit Letter N	Section 5	Township 29 North	Range 8 West	County San Juan
Actual Footage Location of Wells 865 feet from the South North line and 1770 feet from the West line				
Ground Level Elev. 5422'	Producing Formation Fruitland Coal	Pool Undesignated	Dedicated Acreage: 160 Acres	

1. Outline the acreage dedicated to the subject well by colored pencil or hatchure marks on the plat below.
2. If more than one lease is dedicated to the well, outline each and identify the ownership thereof (both as to working interest and royalty).
3. If more than one lease of different ownership is dedicated to the well, have the interests of all owners been consolidated by communitization, unitization, force-pooling, etc?

☐ Yes ☐ No If answer is "yes," type of consolidation _____

If answer is "no," list the owners and tract descriptions which have actually been consolidated. (Use reverse side of this form if necessary.) _____

No allowable will be assigned to the well until all interests have been consolidated (by communitization, unitization, forced-pooling, or otherwise) or until a non-standard unit, eliminating such interests, has been approved by the Division

NOTE: reissued to show moved location

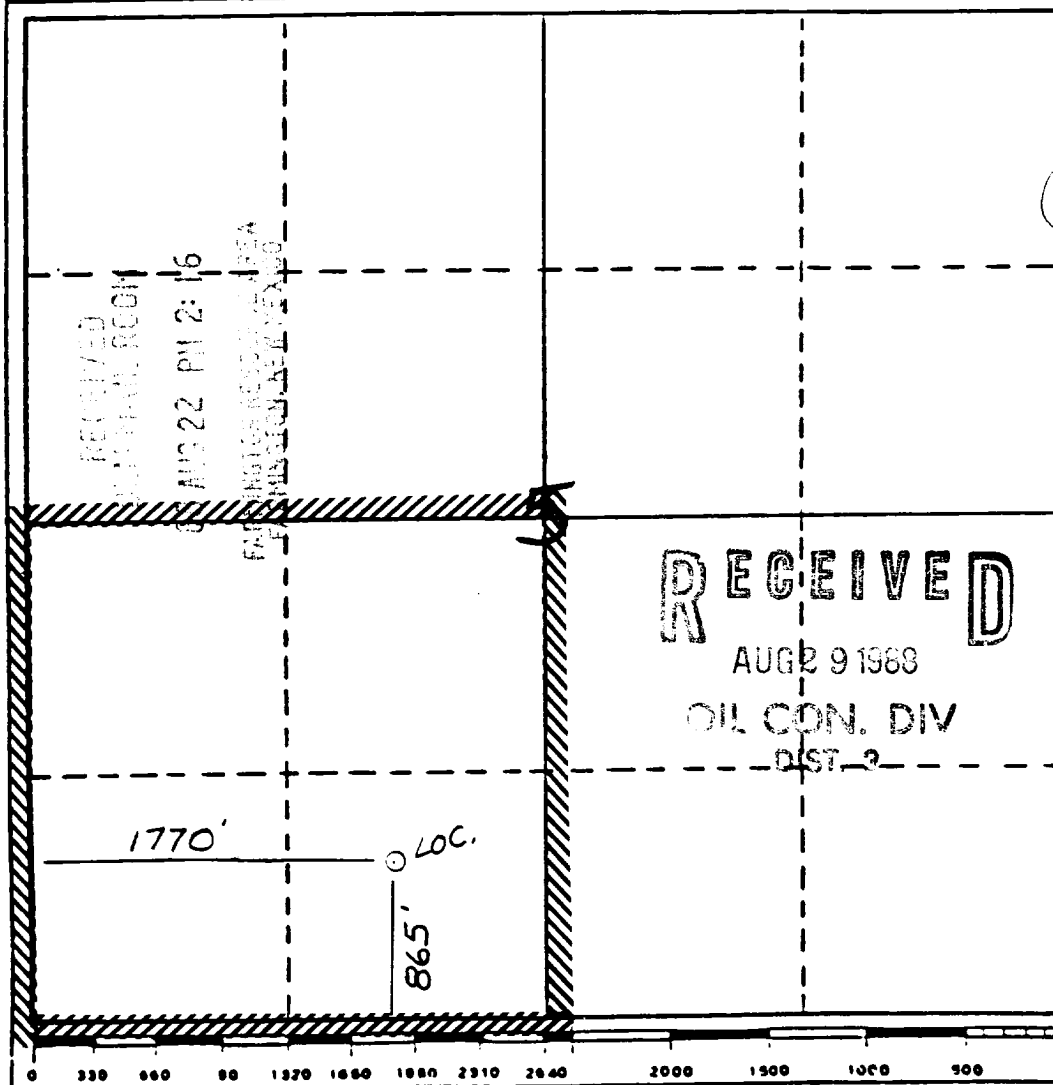

CERTIFICATION

I hereby certify that the information contained herein is true and complete to the best of my knowledge and belief.

Name
Regulatory Affairs
Position
Meridian Oil Inc.
Company
8-19-88

Date
8-19-88

I hereby certify that the location shown on this plat is plotted from field notes of actual surveys made by me or under my supervision, and that the same is true to the best of my knowledge and belief.

Date Surveyed
7-17-88
Registered Professional Engineer and/or Land Surveyor

Heale C. Edwards
Certificate No.
6857

SF078487A

5

Baltazar Peak

BLM ROW

Canyon

Existing or
Applied for
ROW - Howell M 300

BLM ROW
T 29 N, R 8 W
Sec 8: NE NW
450'
SUNRAY 211

Map 2