

UNITED STATES  
DEPARTMENT OF THE INTERIOR  
BUREAU OF LAND MANAGEMENT

APPLICATION FOR PERMIT TO DRILL, DEEPEN, OR PLUG BACK

1a. TYPE OF WORK DRILL <input checked="" type="checkbox"/> DEEPEN <input type="checkbox"/> PLUG BACK <input type="checkbox"/>		5. LEASE DESIGNATION AND SERIAL NO. SF-078046		
b. TYPE OF WELL OIL WELL <input type="checkbox"/> GAS WELL <input checked="" type="checkbox"/> OTHER Coal Seam SINGLE ZONE <input checked="" type="checkbox"/> MULTIPLE ZONE <input type="checkbox"/>		6. IF INDIAN, ALLOTTEE OR TRIBE NAME		
2. NAME OF OPERATOR Conoco Inc. 3817 Northwest Expressway Oklahoma City, OK 73112-1400 (405) 948-3100		7. UNIT AGREEMENT NAME		
3. AT <u>1170' FSL, 1400 FWL SE/SW</u> At surface <u>1170' FSL, 1400 FWL SE/SW</u> At proposed prod. zone <u>same</u>		8. FARM OR LEASE NAME Hughes /B/		
4. <u>1170' FSL, 1400 FWL SE/SW</u> and in accordance with any State requirements.*		9. WELL NO. 17		
14. DISTANCE IN MILES AND DIRECTION FROM NEAREST TOWN OR POST OFFICE* <u>22 miles from Bloomfield, NM</u>		10. FIELD AND POOL, OR WILDCAT Basin Fruitland Coal Gas		
15. DISTANCE FROM PROPOSED LOCATION TO NEAREST PROPERTY OR LEASE LINE, FT. (Also to nearest drlg. unit line, if any) <u>1170'</u>		11. SEC., T., R., M., OR BLK. AND SURVEY OR AREA Sec. 20, T29N-R8W		
16. NO. OF ACRES IN LEASE <u>2,538.24</u>		12. COUNTY OR PARISH San Juan		
17. NO. OF ACRES ASSIGNED TO THIS WELL <u>320 acres W/2</u>		13. STATE NM		
18. DISTANCE FROM PROPOSED LOCATION TO NEAREST WELL, DRILLING, COMPLETED, OR APPLIED FOR, ON THIS LEASE, FT.		19. PROPOSED DEPTH <u>3259' TD</u>		
20. ROTARY OR CABLE TOOLS Rotary		21. ELEVATIONS (Show whether DF, RT, GR, etc.) <u>6476' GR</u>		
22. APPROX. DATE WORK WILL START* As soon as permitted		23. <u>PROPOSED PROGRAM</u> This action is subject to technical and procedural review pursuant to 43 CFR 3165.4 and appeal pursuant to 43 CFR 3165.4.		
SIZE OF HOLE <u>12 1/4"</u> <u>7 7/8"</u>	SIZE OF CASING <u>8 5/8"</u> <u>5 1/2"</u>	WEIGHT PER FOOT <u>24#</u> <u>17#</u>	SETTING DEPTH <u>250'</u> <u>3259' (TD)</u>	QUANTITY OF CEMENT <u>250 cf (cement to surface)</u> <u>913 cf (cement to surface)</u>

Notice of Staking was submitted: 4/18/90

Lease Description:

T28N-R8W:  
Sec. 10: Lots 1,2  
T29N-R8W:  
Sec. 19: Lots 1-4, E/2, E/2W/2  
Sec. 20: ALL  
Sec. 21: ALL  
Sec. 29: ALL

RECEIVED  
SEP 04 1990  
OIL CON. DIV.  
DIST. 3

IN ABOVE SPACE DESCRIBE PROPOSED PROGRAM: If proposal is to deepen or plug back, give data on present productive zone and proposed new productive zone. If proposal is to drill or deepen directionally, give pertinent data on subsurface locations and measured and true vertical depths. Give blowout preventer program, if any.

24. SIGNED <u>J.L. Hampton</u> <u>J.L. Hampton/ceb</u> (This space for Federal or State office use)		TITLE <u>Sr. Staff Admin. Supv.</u>	DATE <u>4/20/90</u>
PERMIT NO. _____		APPROVAL DATE _____	
APPROVED BY _____		TITLE _____	
CONDITIONS OF APPROVAL, IF ANY:			

NMOCD

\*See Instructions On Reverse Side

Title 18 U.S.C. Section 1001, makes it a crime for any person knowingly and willfully to make to any department or agency of the United States any false, fictitious or fraudulent statements or representations as to any matter within its jurisdiction.

Submit to Appropriate  
District Office  
State Lease - 4 copies  
Fee Lease - 3 copies

State of New Mexico  
Energy, Minerals and Natural Resources Department

Form C-102  
Revised 1-1-89

OIL CONSERVATION DIVISION

P.O. Box 2088  
Santa Fe, New Mexico 87504-2088

DISTRICT I  
P.O. Box 1980, Hobbs, NM 88240

DISTRICT II  
P.O. Drawer DD, Artesia, NM 88210

DISTRICT III  
1000 Rio Brazos Rd., Aztec, NM 87410

WELL LOCATION AND ACREAGE DEDICATION PLAT

All Distances must be from the outer boundaries of the section

Operator <i>Conoco Inc</i> <b>AMOCO PRODUCTION COMPANY</b>			Lease <b>HUGHES /B/</b>		Well No. <b># 17</b>
Unit Letter <b>N</b>	Section <b>20</b>	Township <b>29 NORTH</b>	Range <b>B WEST</b>	County <b>SAN JUAN</b>	

Actual Footage Location of Well:

**1170** feet from the **SOUTH** line and **1400** feet from the **WEST** line

Ground level Elev. <b>6476</b>	Producing Formation <b>Fruitland Coal</b>	Pool <b>Basin Fruitland Coal Gas</b>	Dedicated Acreage: <b>W/2 320</b> Acres
-----------------------------------	--	---	---

- Outline the acreage dedicated to the subject well by colored pencil or hatchure marks on the plat below.
- If more than one lease is dedicated to the well, outline each and identify the ownership thereof (both as to working interest and royalty).
- If more than one lease of different ownership is dedicated to the well, have the interest of all owners been consolidated by communitization, unitization, force-pooling, etc.?  
☐ Yes ☐ No If answer is "yes" type of consolidation \_\_\_\_\_  
If answer is "no" list the owners and tract descriptions which have actually been consolidated. (Use reverse side of this form if necessary.) \_\_\_\_\_  
No allowable will be assigned to the well until all interests have been consolidated (by communitization, unitization, forced-pooling, or otherwise) or until a non-standard unit, eliminating such interest, has been approved by the Division.

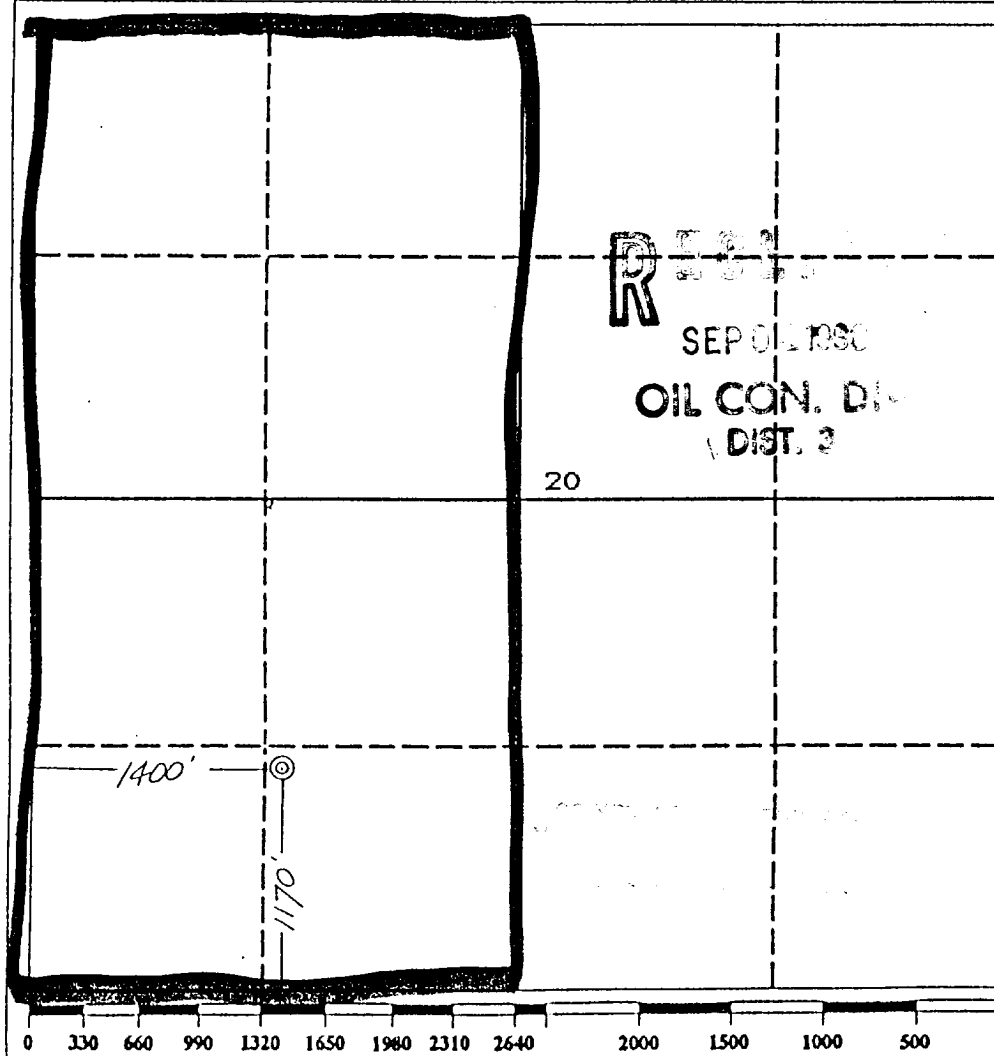

OPERATOR CERTIFICATION

I hereby certify that the information contained herein is true and complete to the best of my knowledge and belief.

Signature *JL Hampton*  
Printed Name **JL Hampton**  
Position **Sr. Staff Admin. Supr**  
Company **Amoco Prod**  
Date **4-17-90**

SURVEYOR CERTIFICATION

I hereby certify that the well location shown on this plat was plotted from field notes of actual surveys made by me or under my supervision, and that the same is true and correct to the best of my knowledge and belief.

Date Surveyed **April 9, 1990**

Signature & Seal of Professional Surveyor  
*Gary D. Vann*  
**GARY D. VANN**  
7016  
7016

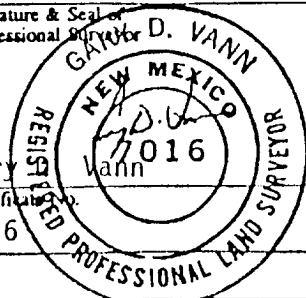

Amoco proposes to drill the well to further develop the Fruitland Coal reservoir. The well will be drilled to the surface casing point using native mud. The well will then be drilled to the total depth with a non-dispersed mud system. The attached modified 12" 3000 psi blowout preventer will be used (please see attached BOP information). The well will be completed in the Fruitland Coal with a fracture stimulation.

Quantity	Size	Weight	Description	Cementing Program
----------	------	--------	-------------	-------------------

SURFACE CASING

250'	8-5/8"	24#	K55 ST&C	250 cf Class B, 2% CaCl <sub>2</sub> 15.6 ppg
------	--------	-----	----------	--

INTERMEDIATE STRING

3259	5.5"	17#	K55 ST&C	913 cf Class B, 65:35:6 10% salt, .25% dispersant 13.1 ppg 118 cf Class B, 2% CaCl <sub>2</sub> 15.6 ppg
------	------	-----	----------	---

The above casing design is based upon a 11.0#/gal mud weight.

EVALUATION

The log surveys (FDC/GR/CAL, Microlog) will be run per attached drilling and completion program.

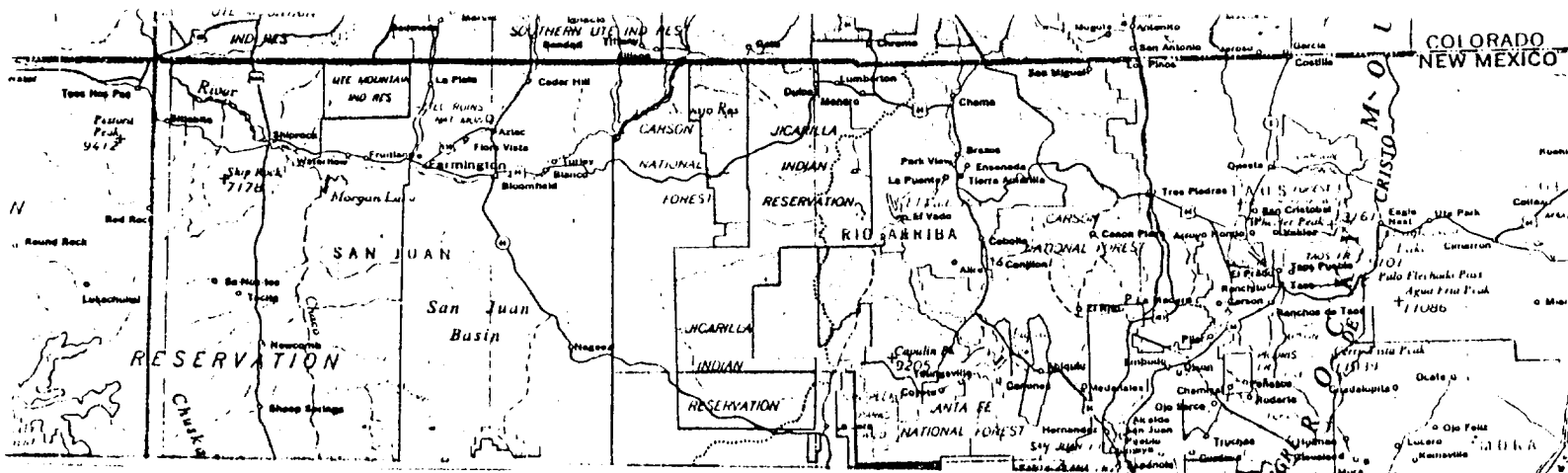

HUGHES /B/ # 17  
 1170' F/SL 1400' F/WL  
 SEC. 20, T29N, RBW, NMPM  
 RAIL POINT: 173 miles from Montrose, Co.  
 MUD POINT: 31 miles from Aztec, NM  
 CEMENT POINT: 35 miles from Farmington, NM

(2)

