

# EL PASO FIELD SERVICES PRODUCTION PIT CLOSURE

Valencia Gas Com B#1  
Meter/Line ID - 75199

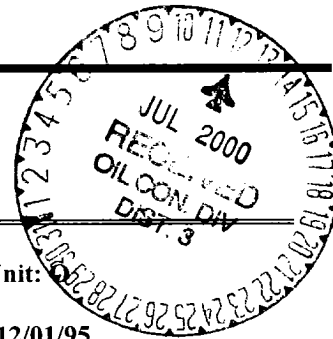

## SITE DETAILS

Legals - Twn: 29N  
NMOCD Hazard Ranking: 20  
Operator: Amoco

Rng: 9W

Sec: 18  
Land Type: FEE  
Pit Closure Date: 12/01/95

## RATIONALE FOR CLOSURE

The pit noted above was assessed and ranked according to the criteria in the New Mexico Oil Conservation Division's (NMOCD) Unlined Surface Impoundment Closure Guidelines.

A Phase I excavation was conducted on May 23, 1994, to 12 feet below ground surface and a soil sample was collected for field headspace analysis and laboratory analysis for benzene, total BTEX, and TPH. Groundwater was not encountered in the test pit. Approximately 40 cubic yards of excavated material was removed for landfarming and sent to an OCD approved centralized site. The pit was backfilled and graded in a manner to direct surface runoff away from the pit area. Headspace analysis indicated an organic vapor content of 356 ppm; laboratory analysis indicated a benzene concentration of 0.28 mg/kg, a total BTEX concentration of 52 mg/kg, and a TPH concentration of 564 mg/kg. Total BTEX and TPH were above required remediation levels for the Hazard Ranking Score.

A Phase II drill borehole was conducted on August 18, 1995, and elevated headspace readings were encountered at the bedrock interface at 12 feet below ground surface. A soil sample was not collected for laboratory analysis.

On December 1, 1995, a Phase III excavation was conducted to 20 feet below ground surface and a soil sample was collected for field headspace analysis and laboratory analysis for benzene, total BTEX, and TPH. Groundwater was not encountered in the test pit. Following the boring, approximately 110 cubic yards of excavated material was removed for landfarming and sent to an OCD approved centralized site. The pit was sprayed with 50 pounds of fertilizer, backfilled, and graded in a manner to direct surface runoff away from the pit area. Headspace analysis indicated an organic vapor content of 72 ppm; laboratory analysis indicated a benzene concentration of <0.5 mg/kg, a total BTEX concentration of <3 mg/kg, and a TPH concentration of 42 mg/kg.

El Paso Field Services Company (EPFS) requests closure of the above mentioned production pit location for the following reasons:

- The primary source, discharge to the pit, has been removed for almost six years.
- The test pit was backfilled and the former pit area graded to direct surface runoff away from the former pit.
- Groundwater was not encountered in the excavations.
- Residual hydrocarbons in the soil will degrade naturally with minimal risk to the environment.

# FIELD PIT SITE ASSESSMENT FORM

GENERAL	<p>Meter: <u>75199</u> Location: <u>VALENCIA GAS COM B #1</u></p> <p>Operator #: <u>0203</u> Operator Name: <u>AMOCO</u> P/L District: <u>BLANCO</u></p> <p>Coordinates: Letter: <u>0</u> Section <u>18</u> Township: <u>29</u> Range: <u>9</u></p> <p>Or Latitude _____ Longitude _____</p> <p>Pit Type: Dehydrator <input checked="" type="checkbox"/> Location Drip: _____ Line Drip: _____ Other: _____</p> <p>Site Assessment Date: <u>5.14.94</u> Area: <u>13</u> Run: <u>22</u></p>
SITE ASSESSMENT	<p><b>NMOCD Zone:</b> (From NMOCD Maps)</p> <p>Inside <input checked="" type="checkbox"/> (1) Outside <input type="checkbox"/> (2)</p> <p><b>Land Type:</b> BLM <input type="checkbox"/> (1) State <input type="checkbox"/> (2) Fee <input checked="" type="checkbox"/> (3) Indian _____</p> <p><b>Depth to Groundwater</b></p> <p>Less Than 50 Feet (20 points) <input type="checkbox"/> (1) 50 Ft to 99 Ft (10 points) <input checked="" type="checkbox"/> (2) Greater Than 100 Ft (0 points) <input type="checkbox"/> (3)</p> <p><b>Wellhead Protection Area :</b></p> <p>Is it less than 1000 ft from wells, springs, or other sources of fresh water extraction? , or ; Is it less than 200 ft from a private domestic water source? <input type="checkbox"/> (1) YES (20 points) <input checked="" type="checkbox"/> (2) NO (0 points)</p> <p><b>Horizontal Distance to Surface Water Body</b></p> <p>Less Than 200 Ft (20 points) <input type="checkbox"/> (1) 200 Ft to 1000 Ft (10 points) <input checked="" type="checkbox"/> (2) Greater Than 1000 Ft (0 points) <input type="checkbox"/> (3)</p> <p>Name of Surface Water Body <u>SAN JUAN RIVER</u></p> <p>(Surface Water Body : Perennial Rivers, Major Wash, Streams, Creeks, Irrigation Canals, Ditches, Lakes, Ponds)</p> <p>Distance to Nearest Ephemeral Stream <input type="checkbox"/> (1) &lt; 100' (Navajo Pits Only) <input type="checkbox"/> (2) &gt; 100'</p> <p><b>TOTAL HAZARD RANKING SCORE:</b> <u>20</u> POINTS</p>
REMARKS	<p>Remarks : <u>TWO PITS ON LOCATION. WILL CLOSE ONLY ONE. PIT IS DRY.</u>  <u>LOCATION IS ON A HILL S.E. OF THE BLANCO FIELD OFFICE AND JUST</u>  <u>ABOVE THE SAN JUAN RIVER. REDLINE AND TOPO CONFIRMED LOCATION</u>  <u>TO BE INSIDE U.Z.</u> <span style="float: right;">DIG # <u>HALL</u></span></p>

# ORIGINAL PIT LOCATION

Original Pit : a) Degrees from North 272° Footage from Wellhead 174'  
 b) Length : 15' Width : 13' Depth : 2'

ORIGINAL PIT LOCATION

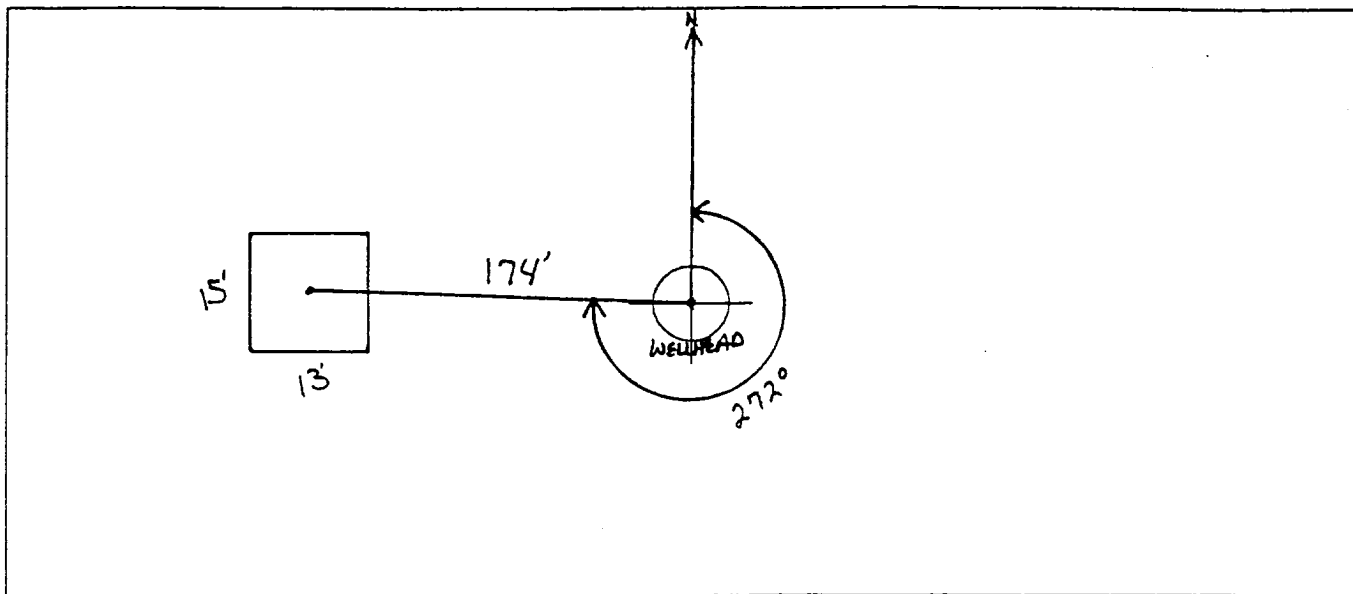

## Remarks :

TOOK PICTURES AT 7:09 A.M.

END DUMP

REMARKS

Completed By:

Robert Thompson  
 Signature

5.14.94  
 Date

## FIELD PIT REMEDIATION/CLOSURE FORM

Meter: 75199 Location: Valencia Gas Com B#1

Coordinates: Letter: O Section 18 Township: 29 Range: 9

Or Latitude \_\_\_\_\_ Longitude \_\_\_\_\_

Date Started : 5-23-94 Area: 13 Run: 22

Sample Number(s): KD 81 \_\_\_\_\_

Sample Depth: 12 Feet

Final PID Reading 356 ppm PID Reading Depth 12 Feet

Yes No

Groundwater Encountered ☐ (1) ☒ (2) Approximate Depth \_\_\_\_\_ Feet

Remediation Method :

Excavation ☒ (1) Approx. Cubic Yards 40

Onsite Bioremediation ☐ (2)

Backfill Pit Without Excavation ☐ (3)

Soil Disposition:

Envirotech ☐ (1) ☒ (3) Tierra

Other Facility ☐ (2) Name: \_\_\_\_\_

Pit Closure Date: 5-23-94 Pit Closed By: BEI

Remarks : Hit Cobble Layer At 6', Excavated to 12', Took  
PID Sample, Closed pit

Signature of Specialist: Wing Leach



## CHAIN OF CUSTODY RECORD

[illegible]



20

**FIELD SERVICES LABORATORY**  
**ANALYTICAL REPORT**  
**PIT CLOSURE PROJECT - Soil**

**SAMPLE IDENTIFICATION**

	Field ID	Lab ID
SAMPLE NUMBER:	KD81	945266
MTR CODE   SITE NAME:	75199	N/A
SAMPLE DATE   TIME (Hrs):	5-23-94	1030
SAMPLED BY:	N/A	
DATE OF TPH EXT.   ANAL.:	5-24-94	5/24/94
DATE OF BTEX EXT.   ANAL.:	5/27/94	6/3/94
TYPE   DESCRIPTION:	VC	Brown coarse Sand

REMARKS:

**RESULTS**

PARAMETER	RESULT	UNITS	QUALIFIERS			
			DF	Q	M(g)	V(ml)
BENZENE	0.28	MG/KG	10			
TOLUENE	20	MG/KG	10			
ETHYL BENZENE	1.8	MG/KG	10			
TOTAL XYLENES	30	MG/KG	10			
TOTAL BTEX	52	MG/KG				
TPH (418.1)	<del>500</del> 56.4	MG/KG			2.11	28
HEADSPACE PID	356	PPM				
PERCENT SOLIDS	94.8	%				

— TPH is by EPA Method 418.1 and BTEX is by EPA Method 8020 —

The Surrogate Recovery was at 197 % for this sample All QA/QC was acceptable.

Narrative:

ATI results attached. Surrogate recovery was outside  
ATI QC limits due to matrix interference.

DF = Dilution Factor Used

Approved By:

*John L. ...*

Date:

7/14/94



Analytical **Technologies**, Inc.

2709-D Pan American Freeway, NE Albuquerque, NM 87107  
Phone (505) 344-3777 FAX (505) 344-4413

ATI I.D. 405406

June 8, 1994

El Paso Natural Gas Co.  
P.O. Box 4990  
Farmington, NM 87499

Project Name/Number: PIT CLOSURE 24324

Attention: John Lambdin

On 05/25/94, Analytical Technologies, Inc., (ADHS License No. AZ0015), received a request to analyze **non-aqueous** samples. The samples were analyzed with EPA methodology or equivalent methods. The results of these analyses and the quality control data, which follow each set of analyses, are enclosed.

If you have any questions or comments, please do not hesitate to contact us at (505) 344-3777.

Letitia Krakowski, Ph.D.  
Project Manager

H. Mitchell Rubenstein, Ph.D.  
Laboratory Manager

MR:jd

Enclosure



Analytical Technologies, Inc.

## GAS CHROMATOGRAPHY RESULTS

TEST : BTEX (EPA 8020)  
CLIENT : EL PASO NATURAL GAS CO. ATI I.D.: 405406  
PROJECT # : 24324  
PROJECT NAME : PIT CLOSURE

SAMPLE ID. #	CLIENT I.D.	MATRIX	DATE SAMPLED	DATE EXTRACTED	DATE ANALYZED	DIL. FACTOR
13	945265	NON-AQ	05/23/94	05/27/94	06/01/94	25
14	945266	NON-AQ	05/23/94	05/27/94	06/03/94	10
15	945267	NON-AQ	05/23/94	05/27/94	06/01/94	20
PARAMETER			UNITS	13	14	15
BENZENE			MG/KG	<0.62	0.28	8.0
TOLUENE			MG/KG	<0.62	20	63
ETHYLBENZENE			MG/KG	2.8	1.8	5.9
TOTAL XYLENES			MG/KG	43	30	61
SURROGATE:						
BROMOFLUOROBENZENE (%)				85	197*	92

\*OUTSIDE ATI QUALITY CONTROL LIMITS DUE TO MATRIX INTERFERENCE



# RECORD OF SUBSURFACE EXPLORATION

## PHILIP ENVIRONMENTAL

4000 Monroe Road  
Farmington, New Mexico 87401  
(505) 326-2282 FAX (505) 326-2388

Borehole # BH-1  
Well # \_\_\_\_\_  
Page 1 of 1

Project Name EPNG PITS  
Project Number 14509 Phase 6000 77  
Project Location Valencia Gas Com B#1 75199

Elevation \_\_\_\_\_  
Borehole Location QD-S18-T29-R9  
GWL Depth \_\_\_\_\_  
Logged By CM CHANCE  
Drilled By K Padilla  
Date/Time Started 8/18/95 - 1340  
Date/Time Completed 8/18/95 - 1415

Well Logged By CM Chance  
Personnel On-Site K Padilla, F. Rivera, D. Charlie  
Contractors On-Site \_\_\_\_\_  
Client Personnel On-Site \_\_\_\_\_

Drilling Method 4 1/4" ID HSA  
Air Monitoring Method PID, CGI

Depth (Feet)	Sample Number	Sample Interval	Sample Type & Recovery (inches)	Sample Description Classification System: USCS	USCS Symbol	Depth Lithology Change (feet)	Air Monitoring			Drilling Conditions & Blow Counts
							Units: PPM			
							BZ	BH	HS	
0				Backfill to 12'						
5										
10	1	12-13'	1"	Gry - OK Br SAND, F-med, + coarse sand, cobble fragments, dense			0	65	$\frac{100}{143}$	- cobbles @ 12' - Refusal @ 12' w/ augers - 1346 h
15										
20										
25										
30										
35										
40										

Comments: Refusal @ 12'. Sample from 12-13. Insufficient volume for lab sample. No sample submitted.

Geologist Signature CM Chance

# FIELD PIT REMEDIATION/CLOSURE FORM/PHASE II

GENERAL

Meter: 75199 Location: Valencia Gas Com B#1  
 Coordinates: Letter: 0 Section 18 Township: 29 Range: 09  
 Or Latitude \_\_\_\_\_ Longitude \_\_\_\_\_  
 Date Started : 12-1-95 Area: 13 Run: 22

FIELD OBSERVATIONS

Sample Number(s): 1P97  
 Sample Depth: 20 Feet  
 Final PID Reading 72 PID Reading Depth 20 Feet  
 Yes No  
 Groundwater Encountered ☐ (1) ☒ (2) Approximate Depth \_\_\_\_\_ Feet  
 Final Dimensions: Length 21 Width 14 Depth 20

CLOSURE

Remediation Method :

Excavation ☒ (1) Approx. Cubic Yards 110 <sup>12/5/95</sup>  
 Onsite Bioremediation ☐ (2)  
 Backfill Pit Without Excavation ☐ (3)  
 Overburden Cubic Yards 14 <sup>12/5/95</sup>

Soil Disposition:

Envirotech ☒ (1) ☐ (3) Tierra  
 Other Facility ☐ (2) Name: \_\_\_\_\_

Pit Closure Date: 12-1-95 Pit Closed By: Philips Env  
Phase III

REMARKS

Remarks : Dug to 20 Ft, did not encounter groundwater. Took  
PID Readings N wall 53 ppm S wall 62 ppm E wall 21 ppm  
W wall 11 ppm Bot 326 ppm Comp 72 ppm  
Used 50 lbs Fertilizer

Signature of Specialist: James J. Puccio



## FIELD SERVICES LABORATORY

## ANALYTICAL REPORT

## PIT CLOSURE PROJECT - Soil Samples Inside the GWV Zone

## SAMPLE IDENTIFICATION

	Field ID	Lab ID
SAMPLE NUMBER:	JP 97	947823
MTR CODE   SITE NAME:	75199	VALENCIA GAS CO. B#1
SAMPLE DATE   TIME (Hrs):	12-1-95	1000
PROJECT:	Phase III Excavation	
DATE OF TPH EXT.   ANAL.:	12/6/95	
DATE OF BTEX EXT.   ANAL.:	12/4/95	12/4/95
TYPE   DESCRIPTION:	VC	Light brown fine sand & clay

Field Remarks: (N-03)(S-62)(E-21)(W-11)

## RESULTS

PARAMETER	RESULT	UNITS	QUALIFIERS			
			DF	Q	M(g)	V(ml)
BENZENE	< 0.5	MG/KG				
TOLUENE	< 0.5	MG/KG				
ETHYL BENZENE	< 0.5	MG/KG				
TOTAL XYLENES	< 1.5	MG/KG				
TOTAL BTEX	< 3	MG/KG				
TPH (418.1)	42	MG/KG			2.0	28
HEADSPACE PID	72	PPM				
PERCENT SOLIDS	97.0	%				

-- TPH is by EPA Method 418.1 and BTEX is by EPA Method 8020 --

The Surrogate Recovery was at 97% for this sample All QA/QC was acceptable.  
Narrative:

DF = Dilution Factor Used

Approved By: Date: 12-7-95

# BTEX SOIL SAMPLE WORKSHEET

<b>File</b>	<b>:</b>	947823	<b>Date Printed</b>	<b>:</b>	12/5/95
<b>Soil Mass (g)</b>	<b>:</b>	4.99	<b>Multiplier (L/g)</b>	<b>:</b>	0.00100
<b>Extraction vol. (mL)</b>	<b>:</b>	10	<b>CAL FACTOR (Analytical):</b>		200
<b>Shot Volume (uL)</b>	<b>:</b>	50	<b>CAL FACTOR (Report):</b>		0.20040

		<b>DILUTION FACTOR:</b>	<b>1</b>	<b>Det. Limit</b>	
<b>Benzene (ug/L)</b>	<b>:</b>	0.16	<b>Benzene (mg/Kg):</b>	<b>0.032</b>	0.501
<b>Toluene (ug/L)</b>	<b>:</b>	0.62	<b>Toluene (mg/Kg):</b>	<b>0.124</b>	0.501
<b>Ethylbenzene (ug/L)</b>	<b>:</b>	0.24	<b>Ethylbenzene (mg/Kg):</b>	<b>0.048</b>	0.501
<b>p &amp; m-xylene (ug/L)</b>	<b>:</b>	1.60	<b>p &amp; m-xylene (mg/Kg):</b>	0.321	1.002
<b>o-xylene (ug/L)</b>	<b>:</b>	0.61	<b>o-xylene (mg/Kg):</b>	0.122	0.501
			<b>Total xylenes (mg/Kg):</b>	<b>0.443</b>	1.503
			<b>Total BTEX (mg/Kg):</b>	<b>0.647</b>	