

NEW MEXICO OIL CONSERVATION COMMISSION
MISCELLANEOUS REPORTS ON WELLS

(Submit to appropriate District Office as per Commission Rule 1106)

COMPANY PAN AMERICAN PETROLEUM CORPORATION Box 487, Farmington, New Mexico
(Address)

LEASE Heath Gas Unit "F" WELL NO. 1 UNIT E S 8 T 29N R 9W
DATE WORK PERFORMED August 7, 1959 POOL Blanco Pictured Cliffs

This is a Report of: (Check appropriate block) ☒ Results of Test of Casing Shut-off
☐ Beginning Drilling Operations ☐ Remedial Work
☐ Plugging ☐ Other _____

Detailed account of work done, nature and quantity of materials used and results obtained.

Heath Gas Unit "F" Well No. 1 on July 31, 1959, 4-1/2" casing was set at 2292' with 600 sacks 6% gel cement containing 2 pounds TufPlug per sack followed by 50 sacks neat cement. Circulated 95 sacks of cement. Tested 4-1/2" casing with 2900 psi and dropped to 1000 psi in 5 minutes. Pumped into casing at 2500 psi. Shut down and bled off pressure. Ran wireline and found plug at 2230'. Pumped plug down and shut in casing under pressure. Moved out safety tools and moved in completion unit. Ran Baker full bore cementer set at 2253'. Tested below Packer with 3000 psi, did not hold. Tested above Packer with 3000 psi, held okay. Pulled Packer and set Baker Bridge Plug at 2251'. Tested casing with 3000 psi, which held with no indication of pressure drop.

FILL IN BELOW FOR REMEDIAL WORK REPORTS ONLY

Original Well Data:

DF Elev. _____ TD _____ PBD _____ Prod. Int. _____ Compl Date _____
Tbng. Dia _____ Tbng Depth _____ Oil String Dia _____ Oil String Depth _____
Perf Interval (s) _____
Open Hole Interval _____ Producing Formation (s) _____

RESULTS OF WORKOVER:	BEFORE	AFTER
Date of Test	_____	_____
Oil Production, bbls. per day	_____	_____
Gas Production, Mcf per day	_____	_____
Water Production, bbls. per day	_____	_____
Gas-Oil Ratio, cu. ft. per bbl.	_____	_____
Gas Well Potential, Mcf per day	_____	_____
Witnessed by _____		
		(Company)

OIL CONSERVATION COMMISSION

Original Signed Emery C. Arnold
Name _____
Title Supervisor Dist. # 3
Date AUG 10 1959

I hereby certify that the information given above is true and complete to the best of my knowledge.

ORIGINAL SIGNED BY
Name R. M. Bauer, Jr.
Position Area Engineer
Company PAN AMERICAN PETROLEUM CORPORATION
Box 487
Farmington, New Mexico



NEW MEXICO OIL CONSERVATION COMMISSION

Well Location and Acreage Dedication Plat

Section A.

Date June 16, 1959

Operator Pan American Petroleum Corporation Lease Heath Gas Unit "F"
Well No. 1 Unit Letter E Section 8 Township 29 North Range 9 West NMPM
Located 1830' Feet From North Line, 1125' Feet From West Line
County San Juan G. L. Elevation * Dedicated Acreage 160 Acres
Name of Producing Formation Pictured Cliffs Pool Blanco Pictured Cliffs

1. Is the Operator the only owner* in the dedicated acreage outlined on the plat below?
Yes X No * To be reported later
2. If the answer to question one is "no," have the interests of all the owners been consolidated by communitization agreement or otherwise? Yes No . If answer is "yes,"
Type of Consolidation
3. If the answer to question two is "no," list all the owners and their respective interests below:

Owner

Land Description

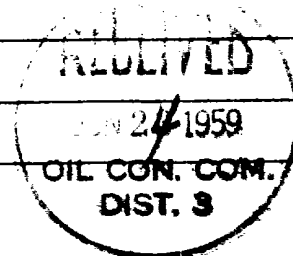

Section. B

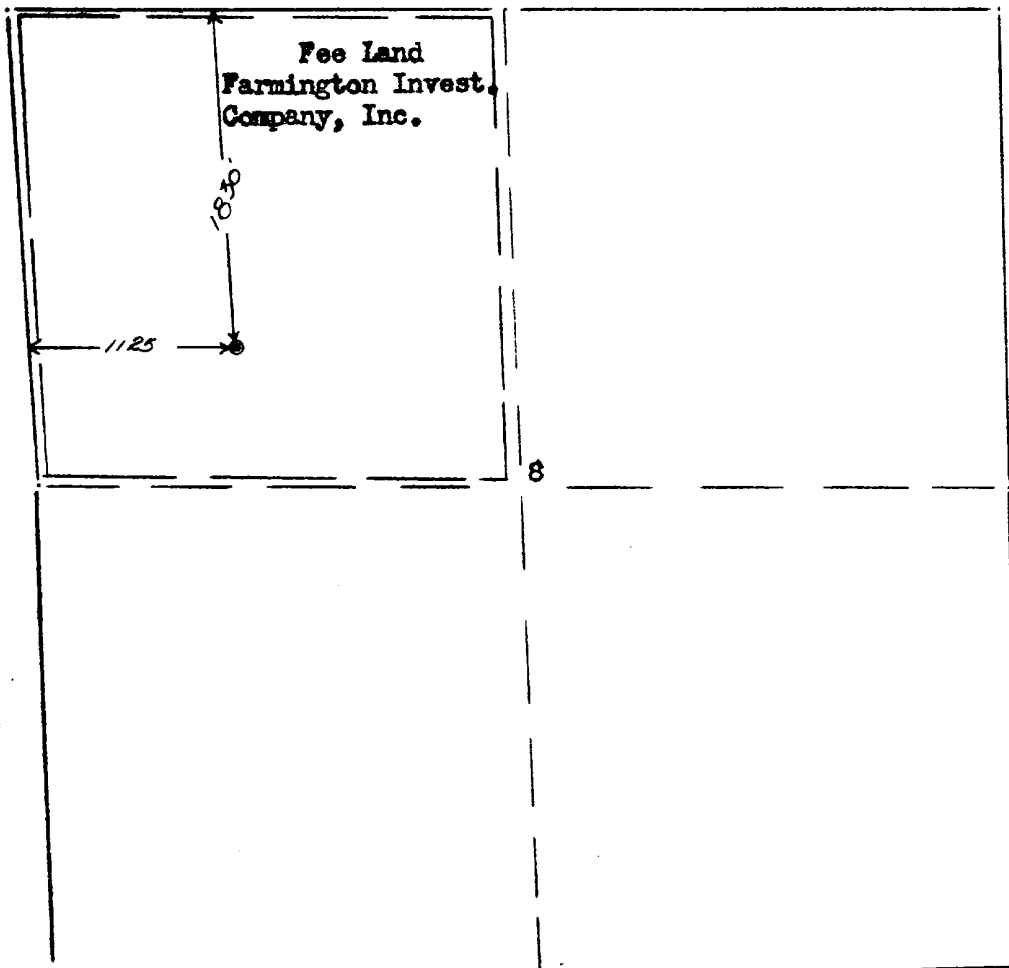

This is to certify that the information in Section A above is true and complete to the best of my knowledge and belief.

Pan American Petroleum Corp.

(Operator)
R.M. Bauer, Jr.

(Representative)
Box 487
Farmington, New Mexico

Address

This is to certify that the well location shown on the plat in Section A was plotted from field notes of actual surveys made by me or under my supervision and that the same is true and correct to the best of my knowledge and belief.

Date Surveyed June 9, 1959

Ernest V. Echohawk
Ernest V. Echohawk
Registered Land Surveyor.

Certificate No. 1545

OIL CONSERVATION COMMISSION		
AZTEC DISTRICT OFFICE		
No. Copies Received 6		
DISTRIBUTION		
	NO. FURNISHED	
Operator	1	
State Pa	1	
Protection Office		
State Land Office	1	
U. S. G. B.	1	
Transporter		
File	1	✓