

NUMBER OF COPIES RECEIVED	
DISTRIBUTION	
SANTA FE	1
FILE	1
U.S.F.S.	2
LAND OFFICE	
TRANSPORT	
GAS	
PRODUCTION OFFICE	
OPERATING	1

**NEW MEXICO OIL CONSERVATION COMMISSION**  
**Santa Fe, New Mexico**

Form C-101  
 Revised (12/1/55)

## NOTICE OF INTENTION TO DRILL

Notice must be given to the District Office of the Oil Conservation Commission and approval obtained before drilling or recompletion begins. If changes in the proposed plan are considered advisable, a copy of this notice showing such changes will be returned to the sender. Submit this notice in QUINTUPLICATE. One copy will be returned following approval. See additional instructions in Rules and Regulations of the Commission. If State Land submit 6 Copies Attach Form C-128 in triplicate to first 3 copies of form C-101

**Farmington, New Mexico**

(Place)

**December 15, 1964**

(Date)

OIL CONSERVATION COMMISSION  
 SANTA FE, NEW MEXICO

Gentlemen:

You are hereby notified that it is our intention to commence the Drilling of a well to be known as  
**PAN AMERICAN PETROLEUM CORPORATION**

(Company, or Operator)

**Nye Gas Unit "B"**

(Lease)

Well No. **1**, in **N** (Unit) The well is

located **1500** feet from the **North** line and **800** feet from the

**East** line of Section **7**, T-**29-N**, R-**9-W**, NMPM.

(GIVE LOCATION FROM SECTION LINE) **Basin Dakota** Pool, **San Juan** County

D	C	B	A
E	F	G	<b>X</b> H
L	K	J	I
M	N	O	P

If State Land the Oil and Gas Lease is No. \_\_\_\_\_

If patented land the owner is **Pascual Valencia**

Address **Blanco, New Mexico**

We propose to drill well with drilling equipment as follows: **Rotary tools to total depth.**

The status of plugging bond is **Statewide**

Drilling Contractor **Brinkerhoff Drig. Corp.**

**870 Denver Club Bldg.**

**Denver, Colorado**

We intend to complete this well in the **Dakota** formation at an approximate depth of **6650** feet.

### CASING PROGRAM

We propose to use the following strings of Casing and to cement them as indicated:

Size of Hole	Size of Casing	Weight per Foot	New or Second Hand	Depth	Sacks Cement
<b>13-3/4"</b>	<b>10-3/4"</b>	<b>32.75#</b>	<b>New</b>	<b>275</b>	<b>300</b>
<b>9-7/8"</b>	<b>7-5/8"</b>	<b>24#</b>	<b>New</b>	<b>2450</b>	<b>600</b>
<b>6-3/4"</b>	<b>4-1/2"</b>	<b>10.5#</b>	<b>New</b>	<b>6650</b>	<b>450</b> (fug-)

If changes in the above plans become advisable we will notify you immediately.

ADDITIONAL INFORMATION (If recompletion give full details of proposed plan of work.)

**Copies of Location Plat are attached.**  
**Copies of any logs run will be furnished upon completion of well.**  
**Completion will be as indicated upon reaching total depth.**

Approved 12-17, 19 64  
 Except as follows:

OIL CONSERVATION COMMISSION

By Emery C. [Signature]

Sincerely yours,

**PAN AMERICAN PETROLEUM CORPORATION**

**Fred L. Nabors**, (Company or Operator) **District Engineer**

By **F. H. HOLLINGSWORTH**

Position **Send Communications regarding well to**

Name **L. O. Spear, Jr.**

Address **Box 480, Farmington, New Mexico**



## Well Location and Acreage Dedication Plat

Section A.

DECEMBER 15, 1964

Operator PAN AMERICAN PETROLEUM CORPORATION NYE GAS UNIT B  
 Well No. 1 Unit Letter H Section 7 Township 29 NORTH Range 9 WEST North Line  
 Located 1500 Feet From the NORTH Line 800 Feet From the EAST Line  
 County SAN JUAN G. L. Elevation REPORT LATER Dedicated Acreage 336.66 Acres  
 Name of Producing Formation DAKOTA Pool BASIN DAKOTA  
 1. Is the Operator the only owner in the dedicated acreage outlined on the plat below? Non-Standard unit approved  
 Yes X No \_\_\_\_\_ by NMOCC Order R-2046 (Tract C).  
 2. If the answer to question one is "no", have the interests of all the owners been consolidated by a community agreement or otherwise? Yes \_\_\_\_\_ No \_\_\_\_\_ If answer is "yes", type of Consolidation \_\_\_\_\_  
 3. If the answer to question two is "no", list all the owners and their respective interests below.

Owner

## Section B.

This is to certify that the information in Section A above is true and complete to the best of my knowledge and belief.

PAN AMERICAN PETROLEUM CORP.

F. H. Hollingsworth (Operator)

(Representative)

P. O. Box 480

(Address)

Farmington, New Mexico

Ref: GLO plat dated 2 July 1952

Note: All distances must be from outer boundaries of section.

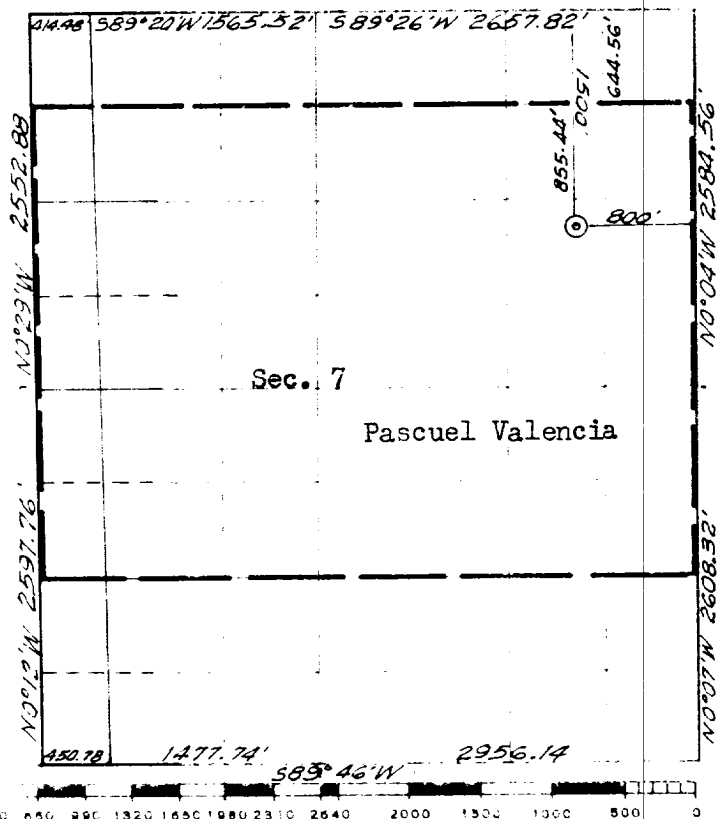

Scale 1 inch equal 1 mile

**Nye Gas Unit "B"**

This is to certify that the above plat was prepared from field notes of actual surveys made by me or under my supervision and that the same are true and correct to the best of my knowledge and belief.

Date Surveyed December 10, 1964

James P. Leese  
 Registered Professional Engineer and/or Land Surveyor  
 James P. Leese, N. Mex. Reg. No. 1463

Farmington, New Mexico