

NO. OF COPIES RECEIVED	5
DISTRIBUTION	
SANTA FE	/
FILE	/
U.S.G.S.	/
LAND OFFICE	/
OPERATOR	/

NEW MEXICO OIL CONSERVATION COMMISSION

Form C-101
Revised 1-1-65

5A. Indicate Type of Lease	
STATE <input type="checkbox"/>	FEE <input checked="" type="checkbox"/>
5. State Oil & Gas Lease No.	

APPLICATION FOR PERMIT TO DRILL, DEEPEN, OR PLUG BACK

1a. Type of Work		7. Unit Agreement Name	
b. Type of Well DRILL <input checked="" type="checkbox"/> DEEPEN <input type="checkbox"/> PLUG BACK <input type="checkbox"/>		8. Farm or Lease Name Jaquez Gas Unit "A"	
OIL WELL <input type="checkbox"/> GAS WELL <input checked="" type="checkbox"/> OTHER <input type="checkbox"/>		9. Well No. 3	
2. Name of Operator PAN AMERICAN PETROLEUM CORPORATION		10. Field and Pool, or Wildcat Basin Dakota	
3. Address of Operator P. O. Box 480, Farmington, New Mexico		12. County San Juan	
4. Location of Well UNIT LETTER G LOCATED 1620 FEET FROM THE North LINE AND 1900 FEET FROM THE East LINE OF SEC. 5 TWP. 29-N RGE. 9-W NMPM			
19. Proposed Depth 6750		19A. Formation Dakota	
20. Rotary or C.T. Rotary			
21. Elevations (Show whether DF, RT, etc.) Will Report Later		21B. Drilling Contractor Cactus Drilling Corp.	
21A. Kind & Status Plug. Bond Statewide		22. Approx. Date Work will start March 29, 1965	

23.

PROPOSED CASING AND CEMENT PROGRAM

SIZE OF HOLE	SIZE OF CASING	WEIGHT PER FOOT	SETTING DEPTH	SACKS OF CEMENT	EST. TOP
13-3/4"	10-3/4"	48#	300	300	Surface
9-7/8"	7-5/8"	24#	2350	600	Surface
6-3/4"	4-1/2"	10.5#	6750	450*	2200'

(* Stage Collar set 100' Below Base of Mesaverde.)

Copies of location plat are attached.

Copies of any logs run will be furnished upon completion of well.



Verbal approval received March 29, 1965 A. R. Kendrick to J. C. Glover.

IN ABOVE SPACE DESCRIBE PROPOSED PROGRAM: IF PROPOSAL IS TO DEEPEN OR PLUG BACK, GIVE DATA ON PRESENT PRODUCTIVE ZONE AND PROPOSED NEW PRODUCTIVE ZONE. GIVE BLOWOUT PREVENTER PROGRAM, IF ANY.

I hereby certify that the information above is true and complete to the best of my knowledge and belief.

Fred L. Nabors, District Engineer

Signed ORIGINAL SIGNED BY Title March 29, 1965
F. H. MOLLINGSWORTH
(This space for State Use)

APPROVED BY A. R. Kendrick TITLE DATE 4-1-65
CONDITIONS OF APPROVAL, IF ANY:

NEW MEXICO OIL CONSERVATION COMMISSION

Well Location and Acreage Dedication Plat

Date MARCH 29, 1965

Section A.

Operator PAN AMERICAN PETROLEUM CORPORATION Lease JAQUEZ GAS UNIT A
 Well No. 3 Unit Letter G Section 5 Township 29 NORTH Range 9 WEST NMPM
 Located 1620 Feet From NORTH Line, 1900 Feet From EAST Line
 County SAN JUAN G. L. Elevation REPORT LATER Dedicated Acreage 320.96 Acres
 Name of Producing Formation DAKOTA Pool BASIN DAKOTA

1. Is the Operator the only owner in the dedicated acreage outlined on the plat below?
 Yes X No _____

2. If the answer to question one is "no", have the interests of all the owners been consolidated by communitization agreement or otherwise? Yes _____ No _____. If answer is "yes", Type of Consolidation _____

3. If the answer to question two is "no", list all the owners and their respective interests below:

Owner

Land Description

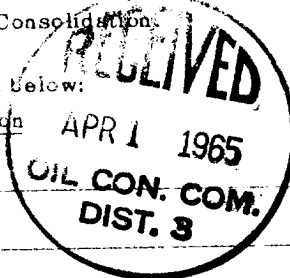

Section B.

This is to certify that the information in Section A above is true and complete to the best of my knowledge and belief.

PAN AMERICAN PETROLEUM CORP.

(Operator)

F. H. Hollingsworth

(Representative)

P. O. Box 480

(Address)

Farmington, New Mexico

Ref: BLM plat dated July 2, 1952

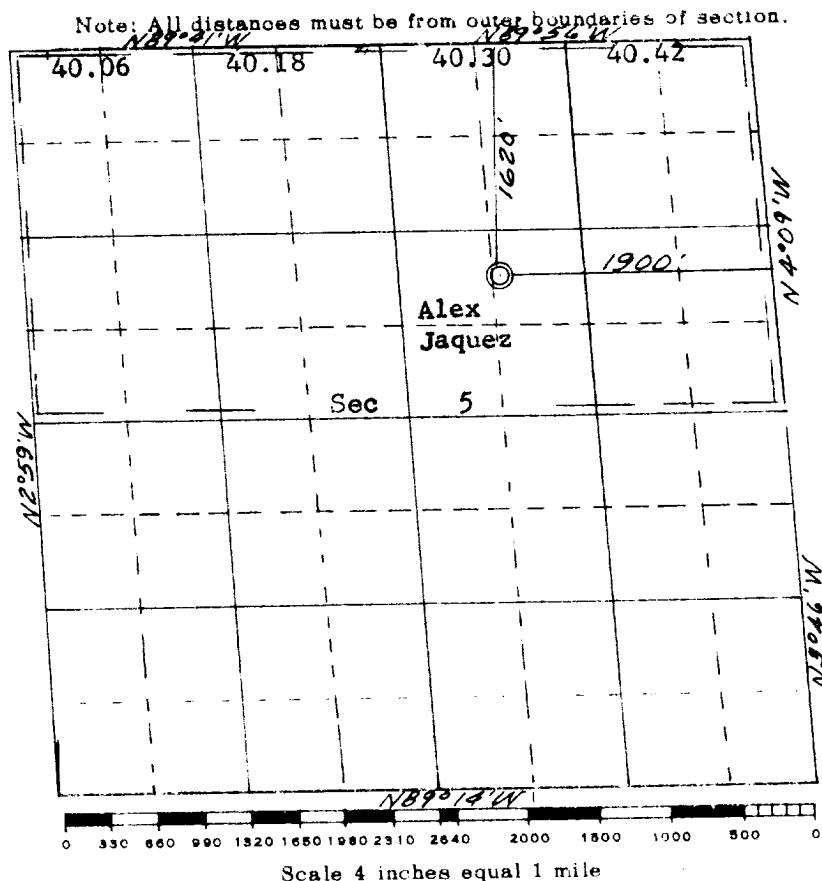

This is to certify that the above plat was prepared from field notes of actual surveys made by me or under my supervision and that the same are true and correct to the best of my knowledge and belief.

(Seal)

Date Surveyed March 25, 1965.

Farmington, New Mexico

James P. Leese
 Registered Professional Engineer and/or Land Surveyor
 James P. Leese, N.Mex. Reg. No. 1463
 San Juan Engineering Company