

NEW MEXICO OIL CONSERVATION COMMISSION
Santa Fe, New Mexico

Form C-101
Revised (12/1/55)

NOTICE OF INTENTION TO DRILL

Notice must be given to the District Office of the Oil Conservation Commission and approval obtained before drilling or recompletion begins. If changes in the proposed plan are considered advisable, a copy of this notice showing such changes will be returned to the sender. Submit this notice in QUINTUPLICATE. One copy will be returned following approval. See additional instructions in Rules and Regulations of the Commission. If State Land submit 6 Copies Attach Form C- 128 in triplicate to first 3 copies of form C-101

Farmington, New Mexico

(Place)

April 25, 1957

(Date)

OIL CONSERVATION COMMISSION
SANTA FE, NEW MEXICO

Gentlemen:

You are hereby notified that it is our intention to commence the Drilling of a well to be known as

Pan American Petroleum Corporation

(Company or Operator)

Jaquez Gas Unit "A"

(Lease)

Well No. 2

in E

(Unit)

The well is

located 1530 feet from the North

line and 890

feet from the

West

line of Section 5, T. 29N, R. 9W, NMPM.

(GIVE LOCATION FROM SECTION LINE) Blanco Pictured Cliffs Pool, San Juan County

If State Land the Oil and Gas Lease is No.

If patented land the owner is T. S. Archuleta

Address Blanco, New Mexico

We propose to drill well with drilling equipment as follows: Rotary tools to total

Depth

The status of plugging bond is

Drilling Contractor Sage Drilling Company

Box 788

San Angelo, Texas

We intend to complete this well in the Pictured Cliffs

formation at an approximate depth of 2450

CASING PROGRAM

We propose to use the following strings of Casing and to cement them as indicated:

| Size of Hole | Size of Casing | Weight per Foot | New or Second Hand | Depth | Links Cement |
|--------------|----------------|-----------------|--------------------|-------|--------------|
| 11" | 8-5/8" | 22.7# | New | 250 | 200 |
| 7-7/8" | 5-1/2" | 14# | New | 2450 | 100 |
| | | | | | |
| | | | | | |

If changes in the above plans become advisable we will notify you immediately.

ADDITIONAL INFORMATION (If recompletion give full details of proposed plan of work.)
Plan to perforate opposite well developed sand in Pictured Cliffs and stimulate by sand water fracking with 20,000 gallons water and 30,000 pounds sand.

Approved
Except as follows:

4-29, 1957

OIL CONSERVATION COMMISSION

By

Sincerely yours,

Pan American Petroleum Corporation

(Company or Operator)

By

Position Field Superintendent

Send Communications regarding well to

Name L. O. Speer, Jr.

Address Box 487, Farmington, New Mexico

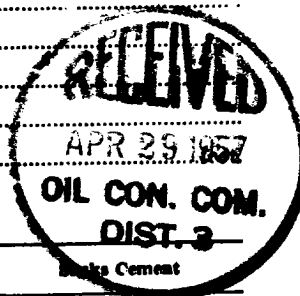

NEW MEXICO
OIL CONSERVATION COMMISSION

Form C-128

Well Location and/or Gas Proration Plat

Date April 11, 1957

Operator Pan American Petroleum Corp. Lease Jaquez Gas Unit Gas

Well No. No. 2 Section 5 Township 29 North Range 9 West NMPM

Located 1530 Feet From North Line, 890 Feet From West Line,

San Juan County, New Mexico. G. L. Elevation 5657

Name of Producing Formation Pictured Cliffs Pool Blanco-Pictured Cliffs Dedicated Acreage 160.24

(Note: All distances must be from outer boundaries of Section)

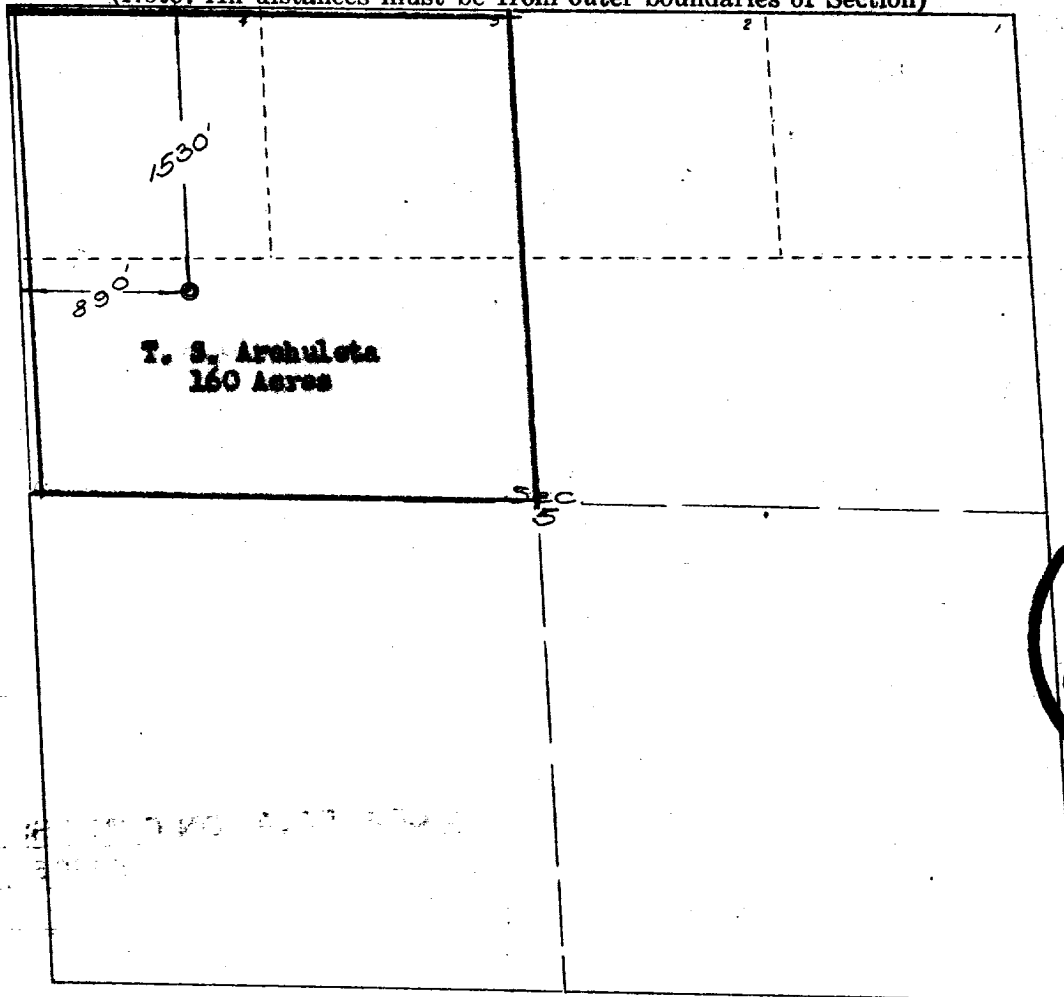

NOTE

This section of form is to be used for gas wells only.

SCALE: 1"=1000'

1. Is this Well a Dual Comp. ? Yes No
2. If the answer to Question 1 is yes, are there any other dually completed wells within the dedicated acreage?
Yes No

Name B. M. Amer, Jr.
Position Field Engineer
Representing Pan American Petroleum Corporation
Address Box 487, Farmington, New Mexico

This is to certify that the above plat was prepared from field notes of actual surveys made by me or under my supervision and that the same are true and correct to the best of my knowledge and belief.

Date Surveyed March 12, 1957

Ernest V. Echohawk
Reg. Land Surveyor, N. Mex., Reg. No. 1545



| | | |
|------------------------------------|------------------|-------------------------------------|
| OIL CONSERVATION COMMISSION | | |
| AZTEC DISTRICT OFFICE | | |
| No. Copies Received <u>5</u> | | |
| DISTRIBUTION | | |
| | NO. FURNISHED | |
| Operator | <u>1</u> | |
| Santa Fe | <u>1</u> | |
| Proration Office | | |
| State Land Office | | |
| U. S. G. S. | <u>2</u> | |
| Transporter | | |
| File | <u>1</u> | <input checked="" type="checkbox"/> |
| | | |

PAN AMERICAN PETROLEUM CORPORATION

3-25-68

WELLS REQUIRING FILE CORRECTIONS ONLY

| <u>LEASE NAME & WELL NUMBER</u> | <u>LOCATION</u> | <u>POOL</u> | <u>PRESENT ACREAGE</u> | <u>CORRECT ACREAGE</u> |
|-------------------------------------|-----------------------|-------------------------|--|----------------------------|
| Jicarilla Apache 102 #6 | K-3-26N-4W | Blanco MV | W 320 | W 321.68 ✓ |
| Jicarilla Apache 102 #4 | K-4-26N-4W | Blanco MV | W 320 | W 322.88 ✓ |
| Jicarilla Contract 155 #10 | M-30-26N-5W | So. Blanco PC | 160 | 159.59 ✓ |
| Gallegos Canyon Unit #146 | I-6-27N-12W | Basin Dakota | E 320 | E 319.88 ✓ |
| Shipp Gas Com #1 | O-1-27N-13W | Basin Dakota | E 320 | E 319.97 ✓ |
| Gallegos Canyon Unit #255 | C-18-28N-11W | Pinon Fruit. | 160 | 157.80 ✓ |
| Gallegos Canyon Unit #139 | P-18-28N-11W | Basin Dakota | S 317.89 | S 317.88 ✓ |
| Gallegos Canyon Unit #253 | E-19-28N-11W | Pinon Gallup | 80 W/2 NW/4 | 78.96 ✓ |
| T. L. Rhodes #1 | F-30-28N-11W | Simpson Gal. | 80 S/2 NW/4 | 78.99 ✓ |
| T. L. Rhodes C #1 | G-30-28N-11W | Basin Dakota | N 317.90 | N 317.96 ✓ |
| State Gas Com L #1 | H-2-29N-9W | Blanco MV | N 322.84 | N 324 ✓ |
| Chaves Gas Com D #1 | G-3-29N-9W | Basin Dakota | E 320 | E 323.40 ✓ |
| Jaquez Gas Com B #2 | C-4-29N-9W | Blanco PC | 160 | 160.52 ✓ |
| Jaquez Gas Com B #3 | K-4-29N-9W | Basin Dakota | W 321.32 | W 320.52 ✓ |
| Jaquez Gas Com A #2 | E-5-29N-9W | Blanco PC | 160 | 160.24 ✓ |
| Jaquez Gas Com B #3 | E-5-29N-9W | Basin Dakota | | |
| Archuleta Gas Com A #2 | I-5-29N-9W | Blanco PC | 160.45 | 160 ✓ |
| Archuleta Gas Com A #3 | K-5-29N-9W | Basin Dakota | S 320.51 | S 320 ✓ |
| Jaquez Gas Com C #1 | O-6-29N-9W | Blanco MV | 334.12 S/2 Sec. 6 & N/2 N/2 N/2 Sec. 7 | 334.14 ✓ |
| Sammons Gas Com B #1 | A-18-29N-9W | Blanco MV | 331 | 331.68 ✓ |
| Abrams Gas Com E #1 | I-30-29N-10W | Basin Dakota | S/2 S/2 Sec. 7 & N/2 N/2 Sec. 18 & N/2 | S/2 N/2 of 18 S 318.80 ✓ |
| Hutton Gas Com #1 | H-6-29N-12W | Basin Dakota | N 320 | N 317.94 ✓ |
| Lillywhite Gas Com #1 | C-13-30N-12W | Basin Dakota | W 317.21 | W 320 ✓ |
| Carpenter Gas Com B #1 | K-25-30N-14W | Basin Dakota | W 320 | W 320.36 ✓ |
| Wallace Gas Com #1 | H-35-31N-11W | Blanco MV | N 319.82 | N 320 ✓ |