

NO. OF COPIES RECEIVED	6
DISTRIBUTION	
SANTA FE	1
FILE	1
U.S.G.S.	2
LAND OFFICE	1
OPERATOR	1

NEW MEXICO OIL CONSERVATION COMMISSION

Form C-101
Revised 1-1-65 30-045-20294

5A. Indicate Type of Lease	
STATE <input checked="" type="checkbox"/>	FEE <input type="checkbox"/>
5. State Oil & Gas Lease No.	
E-2940	

APPLICATION FOR PERMIT TO DRILL, DEEPEN, OR PLUG BACK

1a. Type of Work		7. Unit Agreement Name	
DRILL <input checked="" type="checkbox"/> DEEPEN <input type="checkbox"/> PLUG BACK <input type="checkbox"/>			
b. Type of Well		8. Farm or Lease Name	
OIL WELL <input type="checkbox"/> GAS WELL <input checked="" type="checkbox"/> OTHER <input type="checkbox"/>		State Gas Com "NM"	
2. Name of Operator		9. Well No.	
PAN AMERICAN PETROLEUM CORPORATION		1	
3. Address of Operator		10. Field and Pool, or Wildcat	
501 Airport Drive, Farmington, New Mexico 87401		Blanco Pictured Cliffs	
4. Location of Well		12. County	
UNIT LETTER <u>N</u> LOCATED <u>1600</u> FEET FROM THE <u>North</u> LINE AND <u>1190'</u> FEET FROM THE <u>East</u> LINE OF SEC. <u>2</u> TWP. <u>29N</u> RGE. <u>9W</u> NMMP		San Juan	
21. Elevations (Show whether DF, RT, etc.)		19. Proposed Depth	19A. Formation
Will report later		2500'	Pictured Cliffs
21A. Kind & Status Plug. Bond	21B. Drilling Contractor	20. Rotary or C.T.	22. Approx. Date Work will start
Statewide		Rotary	June 19, 1968

23. PROPOSED CASING AND CEMENT PROGRAM

SIZE OF HOLE	SIZE OF CASING	WEIGHT PER FOOT	SETTING DEPTH	SACKS OF CEMENT	EST. TOP
12-1/4"	8-5/8"	24#	200'	200	Surface
7-7/8"	4-1/2"	9.5#	2500'	600	Surface

Copy of Location Plat attached.

Copies of all logs run will be furnished upon reaching total depth.

Completion procedure will be designed as indicated by logs and data obtained during drilling operations.

APPROVAL VALID
FOR 90 DAYS UNLESS
DRILLING COMMENCED,

EXPIRES Sept 9, 1968

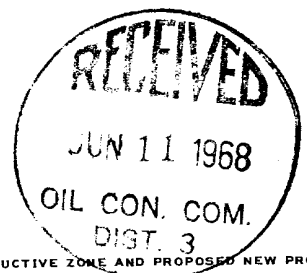

IN ABOVE SPACE DESCRIBE PROPOSED PROGRAM: IF PROPOSAL IS TO DEEPEN OR PLUG BACK, GIVE DATA ON PRESENT PRODUCTIVE ZONE AND PROPOSED NEW PRODUCTIVE ZONE. GIVE BLOWOUT PREVENTER PROGRAM, IF ANY.

I hereby certify that the information above is true and complete to the best of my knowledge and belief.

Signed G. W. Eaton, Jr. ORIGINAL SIGNED BY G. W. Eaton, Jr. Title Area Engineer Date June 7, 1968

(This space for State Use)

APPROVED BY A. R. Kendrick TITLE PETROLEUM ENGINEER DIST. NO. 3 DATE JUN 11 1968

CONDITIONS OF APPROVAL, IF ANY:

NEW MEXICO OIL CONSERVATION COMMISSION

WELL LOCATION AND ACERAGE DEDICATION PLAT

All distances must be from the outer boundaries of the Section

Operator PAN AMERICAN PETROLEUM CORPORATION			Lease STATE GAS COM "BM"		Well No. 1
Unit Letter H	Section 2	Township 29 NORTH	Range 9 WEST	County SAN JUAN	
Actual Footage Location of Well: 1600 feet from the NORTH line and 1190 feet from the East line					
Ground Level Elev. Report Later	Producing Formation Pictured Cliffs		Pool Blanco Pictured Cliffs	Dedicated Acreage: 160.60 Acres	

1. Outline the acreage dedicated to the subject well by colored pencil or hachure marks on the plat below.

2. If more than one lease is dedicated to the well, outline each and identify the ownership thereof (show working interest and royalty),

3. If more than one lease of different ownership is dedicated to the well, have the interests of all owners been consolidated by communitization, unitization, force-pooling, etc?

(☒) Yes () No If answer is "yes," type of consolidation Communitization

If answer is "no," list the owners and tract descriptions which have actually consolidated. (Use reverse side of this form if necessary.)

No allowable will be assigned to the well until all interests have been consolidated (by communitization, unitization, forced-pooling, or otherwise) or until a non standard unit, eliminating such interests, has been approved by the Commission.

CERTIFICATION

I hereby certify that the information contained herein is true and complete to the best of my knowledge and belief.

Name G. W. Eaton, Jr.

Position Area Engineer

Company PAN AMERICAN PETROLEUM CORP.

Date May 21, 1968

Date April 23, 1968

Date May 21, 1968

I hereby certify that the well location shown on this plat was plotted from field notes of actual surveys made by me or under my supervision, and that the same is true and correct to the best of my knowledge and belief.

Date Surveyed April 23, 1968

Registered Professional Engineer
and/or Land Surveyor

JAMES P. LEEGE

Certificate No. 1463

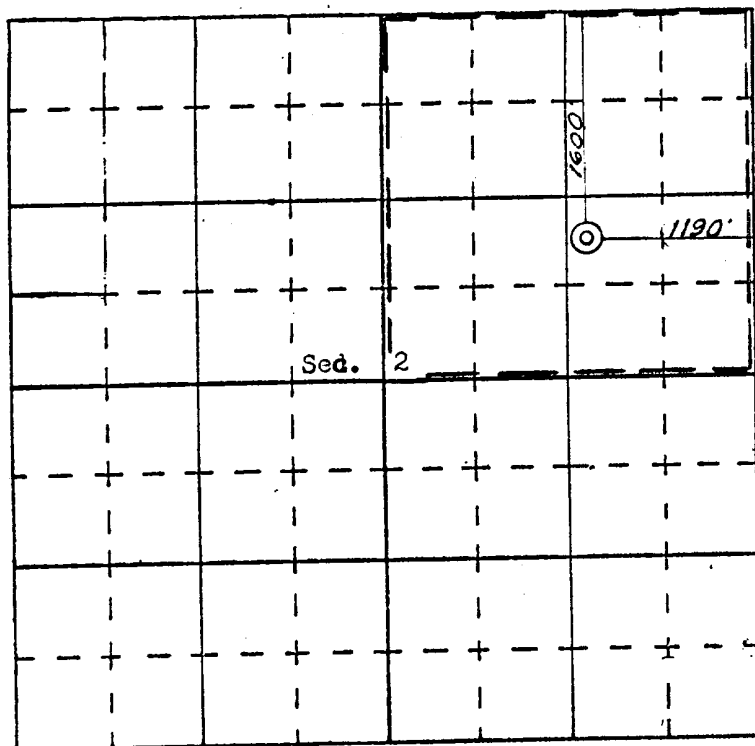

SCALE—1 INCHES EQUALS 1 MILE

SAN JUAN ENGINEERING COMPANY, FARMINGTON, N. M.

TABULATION OF DEVIATION TESTS
STATE GAS COM "EM" NO. 1
PAN AMERICAN PETROLEUM CORPORATION

<u>DEPTH</u>	<u>DEVIATION</u>
60'	3/4°
150'	1°
190'	3/4°
680'	3/4°
1062'	3/4°
1356'	2-3/4°
1893'	2-3/4°
2370'	2-3/4°
2521'	2-1/2°

A F F I D A V I T

THIS IS TO CERTIFY that to the best of my knowledge the above tabulation details the deviation test taken on PAN AMERICAN PETROLEUM CORPORATION'S State Gas Com "EM" No. 1 located 1600' FNL & 1190' FEL, Section 2, T-29-N, R-9-W, San Juan County, New Mexico.

Signed *G. W. Eaton, Jr.*
Title Area Engineer

NEW MEXICO
THE STATE OF ~~COLORADO~~
SAN JUAN) SS.
COUNTY OF ~~DENVER~~)

BEFORE ME, the undersigned authority, on this day personally appeared G. W. Eaton, Jr. known to me to be Area Engineer for Pan American Petroleum Corporation and to be the person whose name is subscribed to the above statement, who, being by me duly sworn on oath, states that he has knowledge of the facts stated herein and that said statement is true and correct.

SUBSCRIBED AND SWORN TO before me, a Notary Public in and for said County and State this 20th day of August, 1968.

Nancy Elaine Jones (York)
Notary Public

My Commission Expires: 8-20-1970

