

NO. OF COPIES RECEIVED	5
DISTRIBUTION	
SANTA FE	1
FILE	1
U.S.G.S.	1
LAND OFFICE	1
OPERATOR	1

NEW MEXICO OIL CONSERVATION COMMISSION

Form C-101
Revised 1-1-65 30-645-20587

5A. Indicate Type of Lease STATE <input checked="" type="checkbox"/> FEE <input type="checkbox"/>
5. State Oil & Gas Lease No. E-397
7. Unit Agreement Name
8. Farm or Lease Name Mims State Com
9. Well No. No. 2
10. Field and Pool, or Wildcat Basin Dakota
12. County San Juan
19. Proposed Depth 6850
19A. Formation Dakota
20. Rotary or C.T. Rotary
21. Elevations (Show whether DF, RT, etc.) 5771 Ungraded Gr.
21A. Kind & Status Plug. Bond State Wide
21B. Drilling Contractor Pico Drlg. Co.
22. Approx. Date Work will start December 1, 1969

1a. Type of Work b. Type of Well OIL WELL <input type="checkbox"/> GAS WELL <input checked="" type="checkbox"/> OTHER <input type="checkbox"/>		DEEPEN <input type="checkbox"/>		PLUG BACK <input type="checkbox"/>	
2. Name of Operator Southern Union Production Company					
3. Address of Operator P. O. Box 808, Farmington, New Mexico 87401					
4. Location of Well UNIT LETTER C LOCATED 925 FEET FROM THE North LINE AND 1740 FEET FROM THE West LINE OF SEC. 16 TWP. 29N RGE. 9W NMPM					
23.					

PROPOSED CASING AND CEMENT PROGRAM

SIZE OF HOLE	SIZE OF CASING	WEIGHT PER FOOT	SETTING DEPTH	SACKS OF CEMENT	EST. TOP
13-3/4"	10-3/4"	32.75#	300 ft.	250	Surface
9-7/8"	7-5/8"	26.40#	2475 ft.	600	Surface
6-3/4"	4-1/2" (Liner)	10.50#	2300 to 6850	800	2300

1. It is our intent to drill a Dakota well to a total depth of approx. 6850 ft.
2. The well will be drilled with mud to a depth of 2475 ft. where a 7-5/8" intermediate string of casing will be set.
3. The well will then be gas drilled to a T.D. of approx. 6850 ft. and a 4-1/2" liner will be run from 2300 ft. to a T.D. of approx. 6850 ft.
4. The Dakota will be sand fraced to stimulate production.
5. 2" tubing will be run to approx. 6800 ft.

APPROVAL VALID
FOR 90 DAYS UNLESS
DRILLING COMMENCED,

EXPIRES Feb 23, 1970



IN ABOVE SPACE DESCRIBE PROPOSED PROGRAM: IF PROPOSAL IS TO DEEPEN OR PLUG BACK, GIVE DATA ON PRESENT PRODUCTIVE ZONE AND PROPOSED NEW PRODUCTIVE ZONE. GIVE BLOWOUT PREVENTER PROGRAM, IF ANY.

I hereby certify that the information above is true and complete to the best of my knowledge and belief.

ORIGINAL SIGNED BY R. B. Vanderslice Title Area Superintendent Date November 21, 1969
(This space for State Use)

APPROVED BY [Signature] TITLE PETROLEUM ENGINEER DIST. NO. 3 DATE 11-24-69
CONDITIONS OF APPROVAL, IF ANY:

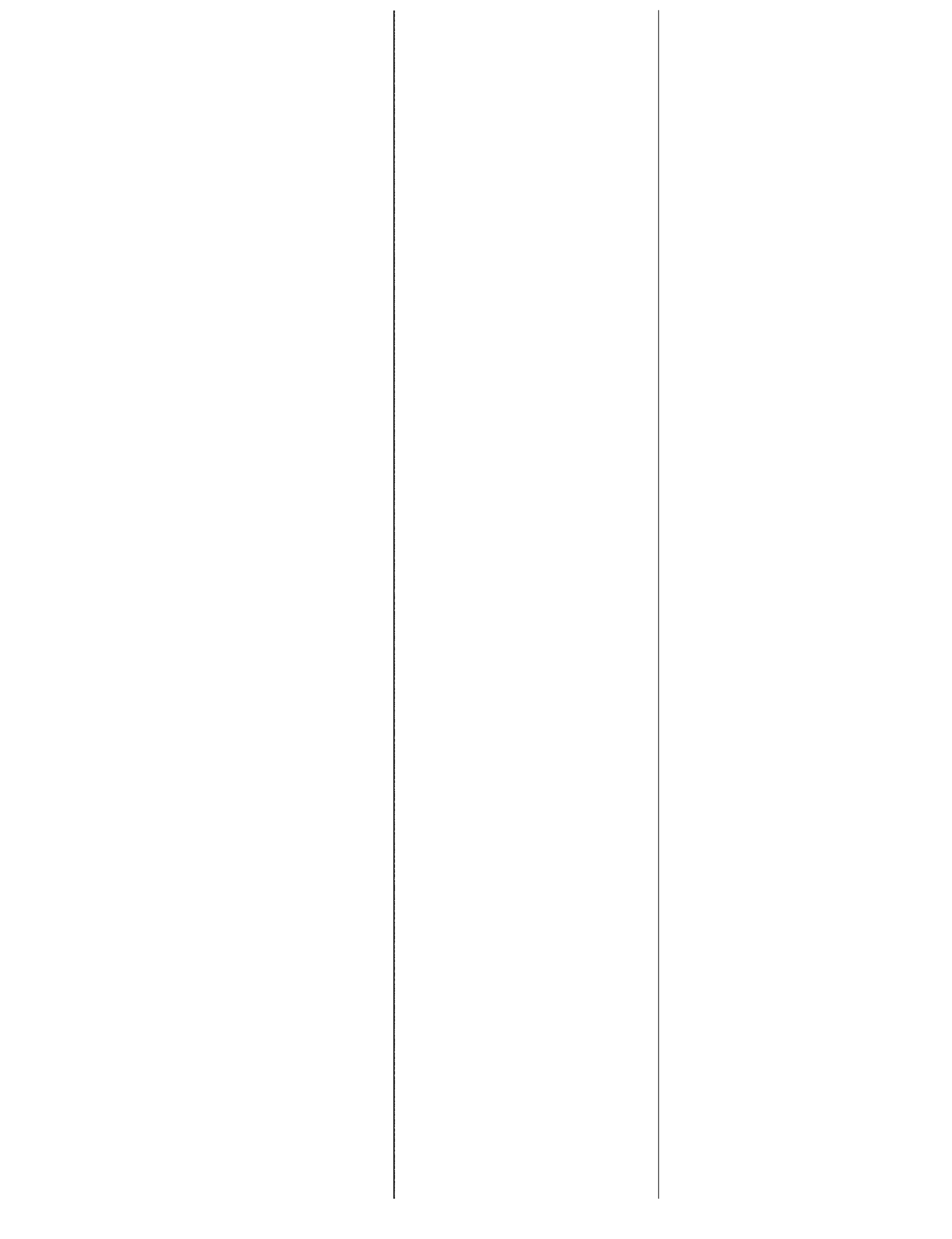

[illegible]

NEW MEXICO OIL CONSERVATION COMMISSION

WELL LOCATION AND AVERAGE DEDICATION PLAT

All distances must be from the outer boundaries of the Section

Operator **SOUTHERN UNION PRODUCTION COMPANY** Well No. **2**
 Unit **C** Section **16** Township **29 NORTH** Range **9 WEST** County **SAN JUAN**
 Acres from location of Well **925** Section **1740** Township **WEST**
 Geologic Formation **Dakota** Basin **Basin Dakota** Dedication Average **316.6 320.00** Acres

- Outline the acreage dedicated to the subject well by color, pencil or machine marks on the plat below.
- If more than one lease is dedicated to the well, outline and label them on the ownership thereof (both as to making interest and royalty).
- If more than one lease of different ownership is dedicated to the well, have the interests of all owners been consolidated by communitization, unitization, forced pooling, etc.?

Communitization Agreement



X If more than one lease of different ownership is dedicated to the well, have the interests of all owners been consolidated by communitization, unitization, forced pooling, etc.?

If no, list the owners, acreage, tract description, which have actually been consolidated (Use reverse side of this form if necessary).

If no, list the owners, acreage, tract description, which have actually been consolidated (Use reverse side of this form if necessary).

ILLEGIBLE

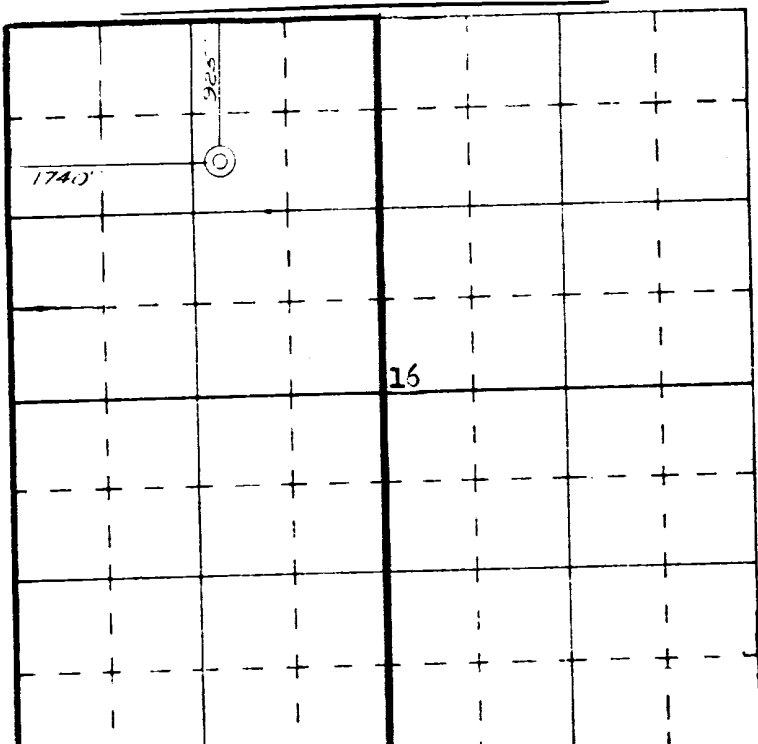

CERTIFICATION

I hereby certify that the information contained herein is true and complete to the best of my knowledge and belief.

ORIGINAL SIGNED BY
B. R. VANDERSLICE
 Name **B. R. Vanderslice**
 Position **Area Superintendent**
 Company **Southern Union Production Co.**
 Date **November 21, 1969**

I hereby certify that the well location shown on this plat was plotted from field notes of actual surveys made by me or under my supervision, and that the same is true and correct to the knowledge and belief.

1 March 1969
 Registered Professional Engineer
 and Land Surveyor **H.M. Reg. #1463**