

UNITED STATES
DEPARTMENT OF THE INTERIOR
GEOLOGICAL SURVEY

APPLICATION FOR PERMIT TO DRILL, DEEPEN, OR PLUG BACK

1a. TYPE OF WORK
DRILL ☒ DEEPEN ☐ PLUG BACK ☐

b. TYPE OF WELL
OIL WELL ☐ GAS WELL ☒ OTHER ☐ SINGLE ZONE ☐ MULTIPLE ZONE ☐

2. NAME OF OPERATOR
Lively Exploration Company

3. ADDRESS OF OPERATOR
Box 234, Farmington, New Mexico 87401

4. LOCATION OF WELL (Report location clearly and in accordance with any State requirements.)*
At surface
990' FSL - 990' FEL
At proposed prod. zone

14. DISTANCE IN MILES AND DIRECTION FROM NEAREST TOWN OR POST OFFICE*
8 miles east Blanco, New Mexico

10. DISTANCE FROM PROPOSED* LOCATION TO NEAREST PROPERTY OR LEASE LINE, FT. (Also to nearest drlg. unit line, if any) 990'

16. NO. OF ACRES IN LEASE

17. NO. OF ACRES ASSIGNED TO THIS WELL
320 332.05

18. DISTANCE FROM PROPOSED LOCATION* TO NEAREST WELL, DRILLING, COMPLETED, OR APPLIED FOR, ON THIS LEASE, FT. 500' approx.

19. PROPOSED DEPTH 7650'

20. ROTARY OR CABLE TOOLS
Rotary

21. ELEVATIONS (Show whether DF, RT, GR, etc.)
6430' GR

22. APPROX. DATE WORK WILL START*
11-15-72

12. COUNTY OR PARISH 13. STATE
San Juan N.M.

5. LEASE DESIGNATION AND SERIAL NO.
SF 078201A

6. IF INDIAN, ALLOTTEE OR TRIBE NAME

7. UNIT AGREEMENT NAME

8. FARM OR LEASE NAME
Lively

9. WELL NO.
5

10. FIELD AND POOL, OR WILDCAT
Basin Dakota

11. SEC., T., R., M., OR BLK. AND SURVEY OR AREA
Sec. 1, T29N, R9W

23. PROPOSED CASING AND CEMENTING PROGRAM

SIZE OF HOLE	SIZE OF CASING	WEIGHT PER FOOT	SETTING DEPTH	QUANTITY OF CEMENT
13 3/4	9 5/8	32.30	300	200 cu. ft.
8 3/4	7	20	3450	600 cu. ft.
6 1/4	4 1/2	10.5	7650	600 cu. ft.

Plan to drill with water or minimum mud to 3450', set 7" intermediate csg and cement with 600 cu. ft. cement. Drill 6 1/4" hole with gas to T.D. to test Dakota formation. Run 4 1/2" production csg thru Dakota, selective perforate and sand water frac, clean out, run 1 1/4" tbg and complete well.

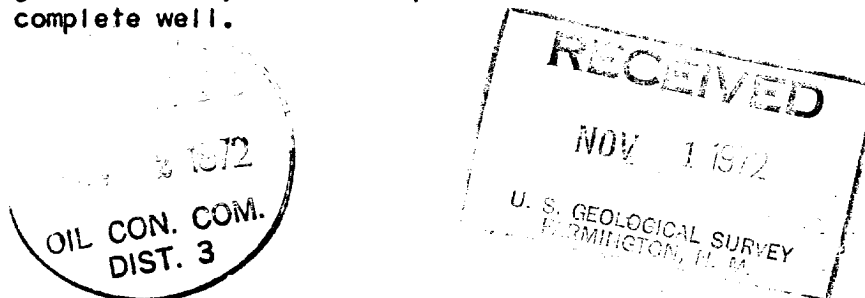

IN ABOVE SPACE DESCRIBE PROPOSED PROGRAM: If proposal is to deepen or plug back, give data on present productive zone and proposed new productive zone. If proposal is to drill or deepen directionally, give pertinent data on subsurface locations and measured and true vertical depths. Give blowout preventer program, if any.

24. Original signed by T. A. Dugan
SIGNED _____ TITLE Engineer DATE 10-30-72

(This space for Federal or State office use)

PERMIT NO. _____ APPROVAL DATE _____

APPROVED BY *ea* _____ TITLE _____ DATE _____

CONDITIONS OF APPROVAL, IF ANY:

issue N.S.W.

*See Instructions On Reverse Side

NEW MEXICO OIL CONSERVATION COMMISSION

WELL LOCATION AND ACERAGE DEDICATION PLAT

All distances must be from the outer boundaries of the Section

Operator LIVELY EXPLORATION COMPANY			Lease Lively		Well No. 5
Unit Letter P	Section 1	Township 29 North	Range 9 West	County San Juan	

Actual Footage Location of Well:
990 feet from the **South** line and **990** feet from the **East** line

Ground Level Elev. 6430	Producing Formation Dakota	Pool Basin	Dedicated Acreage: 332.05 320 Acres
-----------------------------------	--------------------------------------	----------------------	--

1. Outline the acreage dedicated to the subject well by colored pencil or hachure marks on the plat below.
2. If more than one lease is dedicated to the well, outline each and identify the ownership thereof (both as to working interest and royalty),
3. If more than one lease of different ownership is dedicated to the well, have the interests of all owners been consolidated by communitization, unitization, force-pooling, etc?

() Yes () No If answer is "yes," type of consolidation

If answer is "no," list the owners and tract descriptions which have actually consolidated. (Use reverse side of this form if necessary.)

No allowable will be assigned to the well until all interests have been consolidated (by communitization, unitization, forced-pooling, or otherwise) or until a non standard unit, eliminating such interests, has been approved by the Commission.

CERTIFICATION

I hereby certify that the information contained herein is true and complete to the best of my knowledge and belief.

Original signed by T. A. Dugan

Name
Thomas A. Dugan
 Position
Engineer
 Company
Lively Exploration Company
 Date
10-30-72

I hereby certify that the location shown on this plat was plotted from notes of actual surveys made by me or under my supervision, and that the same is true and correct to the best of my knowledge and belief.

Date Surveyed V. ECHOHAWK
October 13, 1972
 Registered Professional Engineer
 and/or Land Surveyor

E. V. Echohawk
 Certificate No. 3602
E. V. Echohawk LS

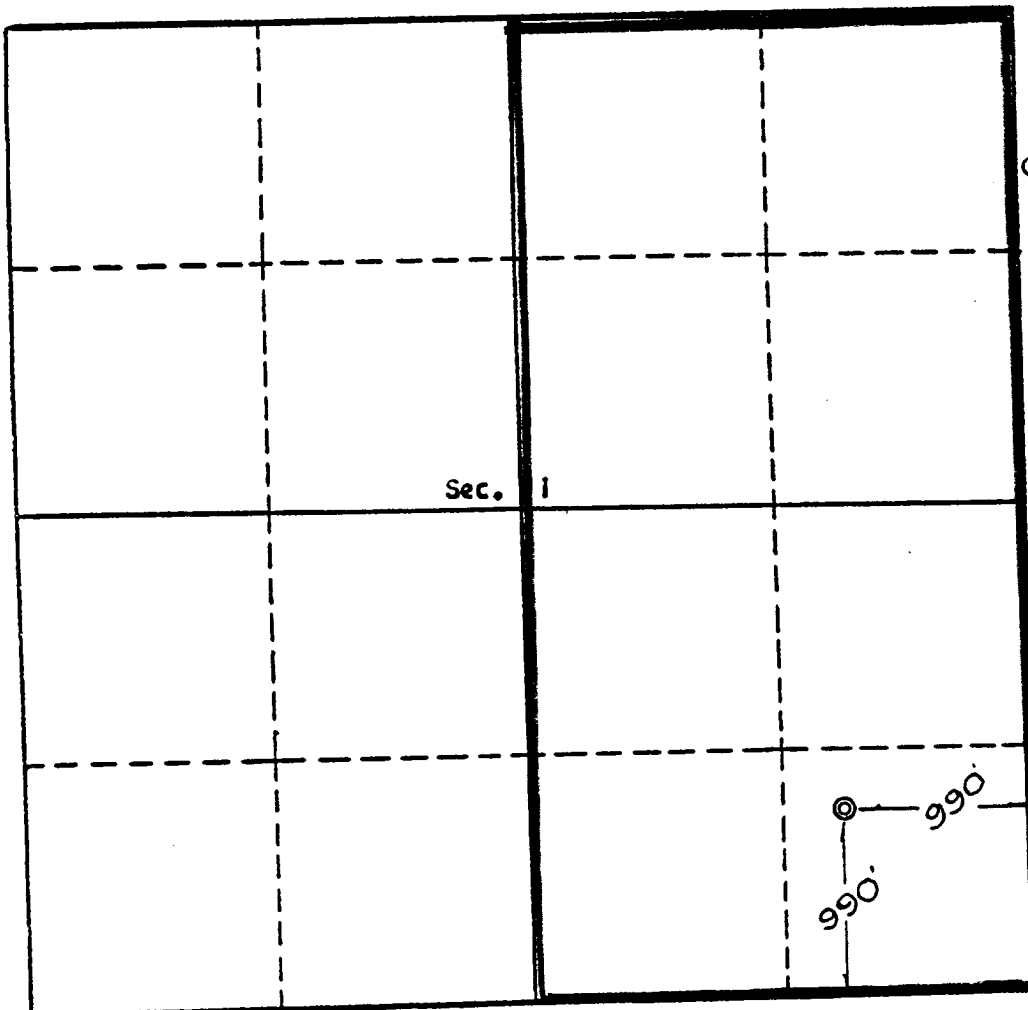

Scale, 1 inch = 1,000 feet