

UNITED STATES  
DEPARTMENT OF THE INTERIOR  
GEOLOGICAL SURVEY30-045-22246  
5. LEASE DESIGNATION AND SERIAL NO.

SF-080246

6. IF INDIAN, ALLOTTEE OR TRIBE NAME

7. UNIT AGREEMENT NAME

8. FARM OR LEASE NAME

Florance

9. WELL NO.

#41A

10. FIELD AND POOL OR WILDCAT

Blanco Mesa Verde

11. SEC., T., R., M., OR BLK.  
AND SURVEY OR AREA

Sec. 21, T29N, R9W

12. COUNTY OR PARISH 13. STATE

San Juan New Mexico

## APPLICATION FOR PERMIT TO DRILL, DEEPEN, OR PLUG BACK

1a. TYPE OF WORK

DRILL ☒DEEPEN ☐PLUG BACK ☐

b. TYPE OF WELL

OIL  
WELL ☐GAS  
WELL ☒

OTHER

SINGLE  
ZONE ☐MULTIPLE  
ZONE ☐

2. NAME OF OPERATOR

Tenneco Oil Company

3. ADDRESS OF OPERATOR

1860 Lincoln St., Suite 1200, Denver, Colorado 80203

4. LOCATION OF WELL (Report location clearly and in accordance with any State requirements.)\*

At surface

1530 'FSL and 1840 'FEL, Unit

At proposed prod. zone

14. DISTANCE IN MILES AND DIRECTION FROM NEAREST TOWN OR POST OFFICE\*

See Point 1 of Surface Use Plan

15. DISTANCE FROM PROPOSED\*

LOCATION TO NEAREST  
PROPERTY OR LEASE LINE, FT.  
(Also to nearest drlg. unit line, if any)

18. DISTANCE FROM PROPOSED LOCATION\*

TO NEAREST WELL, DRILLING, COMPLETED,  
OR APPLIED FOR, ON THIS LEASE, FT.

16. NO. OF ACRES IN LEASE

312.8

19. PROPOSED DEPTH

± 4950'

17. NO. OF ACRES ASSIGNED  
TO THIS WELL

E/312.80

20. ROTARY OR CABLE TOOLS

Rotary

21. ELEVATIONS (Show whether DF, RT, GR, etc.)

5599'

22. APPROX. DATE WORK WILL START\*

12-15-76

23.

## PROPOSED CASING AND CEMENTING PROGRAM

SIZE OF HOLE	SIZE OF CASING	WEIGHT PER FOOT	SETTING DEPTH	QUANTITY OF CEMENT
12-1/4"	9-5/8"	36#	± 200'	Suff. to circulate to surface
8-3/4"	7"	23#	± 2500'	Suff. to cement back to surface
6-1/8"	4-1/2"	10.5#	± 2200'-4950'	Suff. to cement back to 7" cs

Plan to drill well as follows:

1. MIRURT, drill 12-1/4" hole to ± 200'.
2. Set and cement 9-5/8" casing to ± 200' & cement with suff. cement to circ. to surf
3. Drill out with 8-3/4" bit to ± 2500'.
4. Run 7" casing and cement back to surface casing.
5. Drill out of 7" using gas as the circulating fluid, do not drill more than 10' below the 7" casing shoe until the hole has dried up completely and is dusting.
6. Drill the hole to T. D., log the hole dry as requested by drillsite geologist.
7. Run 4-1/2" liner to T. D., load hole with mud and cement liner back to top of 4-1/2" Set liner hanger and POH w/drill pipe.
8. This well will be completed through casing perforations and stimulated as necessary to establish commercial production.
9. Clean up area.
10. Approximately 8 days will be required to drill this well.
11. The gas has been dedicated to Southern Union Gathering Co.

Continued to Page 2

IN ABOVE SPACE DESCRIBE PROPOSED PROGRAM: If proposal is to deepen or plug back, give data on present productive zone and proposed new productive zone. If proposal is to drill or deepen directionally, give pertinent data on subsurface locations and measured and true vertical depths. Give blowout preventer program, if any.

24.

SIGNED

*R. E. Brown*

TITLE

Div. Drilling Engineer

DATE

11-1-76

(This space for Federal or State office use)

PERMIT NO.

APPROVAL DATE

APPROVED BY

TITLE

CONDITIONS OF APPROVAL, IF ANY:

*Okal*

\*See Instructions On Reverse Side

RECEIVED

DATE

NOV 5 1976

U. S. GEOLOGICAL SURVEY  
FARMINGTON, N. M.

APPLICATION FOR PERMIT TO DRILL, DEEPEN, OR PLUG BACK

( PAGE 2 ) for Florance 41A

12. SURFACE FORMATION IS San Jose (EOCENE)

13. FORMATION TOPS (Estimated)

Pictured Cliffs	+ 2070'	possible oil or gas producer
Cliff House	+ 3750'	possible oil or gas producer
Menefee	+ 3880'	possible oil or gas producer
Point Lookout	+ 4340'	possible oil or gas producer
Mancos Shale	- 4750'	

14. Mud program : see point 7 of 7 point well control plan

15. No coring or drill stem tests will be taken

16. Logs to be taken= Density  
Gamma Ray  
Caliper and temperature logs  
Deviation surveys will also be taken

## 7 POINT WELL CONTROL PLAN

1. Surface casing: 9 5/8", 24#, approximately 200, grade K-55, new condition.
2. Casinghead will be 10", 900 Series, 3,000 psi rating.
3. Intermediate casing - 7", 20#, K-55, will be set at  $\pm 2500'$  and cemented to surface casing.
4. Blowout preventors: Hydraulic, double ram, 10". One set of rams will be provided for each size drill pipe in the hole. One set of blind rams at all times. Fill line will be 2", kill line will be 2", choke relief line will be 2" with variable choke.
5. Auxiliary equipment:
  - (1) Kelly cock will be in use at all times.
  - (2) Stabbing valve to fit drill pipe will be present on floor at all times.
  - (3) Mud monitoring will be visual, no abnormal pressures are anticipated in this area.
  - (4) Rotating head will be used when drilling with gas.
6. Anticipated bottom-hole pressure:

This is an area of known pressure. Maximum anticipated pressure at TD is 1200 psi. No abnormal pressure is anticipated.
7. Drilling Fluids:

0 - 200'	Spud mud
200- 2500'	Gel water - low solids as needed to maintain good conditions.
2500' - T.D.	Compressed gas

## SURFACE USE PLAN

TENNECO OIL COMPANY'S  
Florance #41A, SE 1/4 of Sec. 21, T29N, R9W,  
Lease #SF 080246, San Juan County, New Mexico

This plan is to accompany "Application for Permit to Drill" for the  
above mentioned well.

The following is a discussion of pertinent information concerning possible  
effect which the proposed drilling of the well may have on the environment  
of the well and road sites and surrounding acreage. A copy will be posted  
on the derrick floor so that all contractors and subcontractors will be  
aware of all items of this plan.

1. AREAL ROAD MAP - Exhibit "A" is a portion of a USGS topographic map, San Juan County, New Mexico, showing existing black top roads. Approximately 1-3/4 miles east of Blanco Camp, New Mexico on 511, turn south on Largo station road until you see a red ribbon on the right side of the road, take a right down through gate for 1/2 mile west. New site is 900' east of D.J. Simmons # 10.
2. LOCATION OF EXISTING WELLS - Several MV, Dak., and P.C. have been drilled in a two mile radius and are shown on Exhibit "B".
3. PROPOSED WELL MAT AND IMMEDIATE AREA - Refer to Exhibit "C" for direction orientation and road access.
  - a. Mat size - 130' x 300'
  - b. Surface - Will be native soil, bladed, watered and capped with clay only when necessary.
  - c. Reserve pit - 150' x 150' unlined pit, joining mat to the southwest.
  - d. Cut & Fill - 3'-4' cut on the NE side of location
  - e. Drill Site Layout - Exhibit "C" shows position of mat, reserve pits, burn pits, trash pits, and mud pits in relation to the well bore. Rig will be erected with the V-Door to the northwest.
  - f. Setting & Environment -
    - (1) Terrain - Rocky cliffs to NE See Exhibit "A", topographic map of area.
    - (2) Soil - Extremely sandy soil
    - (3) Vegetation - Sparse grass, predominately sagebrush.
    - (4) Surface Use - Unknown, possibly used for grazing.

# NEW MEXICO OIL CONSERVATION COMMISSION

## WELL LOCATION AND ACERAGE DEDICATION PLAT

All distances must be from the outer boundaries of the Section

Operator <b>TENNECO OIL COMPANY</b>			Lease <b>FLORANCE</b>		Well No. <b>41-A</b>
Unit Letter <b>J</b>	Section <b>21</b>	Township <b>29 NORTH</b>	Range <b>9 WEST</b>	County <b>SAN JUAN</b>	

Actual Footage Location of Well:  
**1530** feet from the **SOUTH** line and **1840** feet from the **EAST** line

Ground Level Elev. <b>5599</b>	Producing Formation <b>blanco Mesa Verde</b>	Pool <b>blanco Mesa Verde</b>	Dedicated Acreage: <b>E/312.8</b>	Acreage <b>Acres</b>
-----------------------------------	-------------------------------------------------	----------------------------------	--------------------------------------	-------------------------

1. Outline the acreage dedicated to the subject well by colored pencil or hatchure marks on the plat below.
2. If more than one lease is dedicated to the well, outline each and identify the ownership thereof (both as to working interest and royalty),
3. If more than one lease of different ownership is dedicated to the well, have the interests of all owners been consolidated by communitization, unitization, force-pooling, etc?

( ) Yes ( ) No If answer is "yes," type of consolidation One Lease.

If answer is "no," list the owners and tract descriptions which have actually consolidated. (Use reverse side of this form if necessary.)

No allowable will be assigned to the well until all interests have been consolidated (by communitization, unitization, forced-pooling, or otherwise) or until a non standard unit, eliminating such interests, has been approved by the Commission.

### CERTIFICATION

I hereby certify that the information contained herein is true and complete to the best of my knowledge and belief.

Name Ted P. Drake  
 Position Production Clerk  
 Company Tenneco Oil Company  
 Date October 26, 1976

I hereby certify that the well location shown on this plat was plotted from field notes of surveys made by me or under my supervision and that the same is true and correct to the best of my knowledge and belief.

Date Surveyed 13 October 1976  
James P. Lee  
 Registered Professional Engineer  
 and/or Land Surveyor **James P. Lee**

1463

Certificate No.

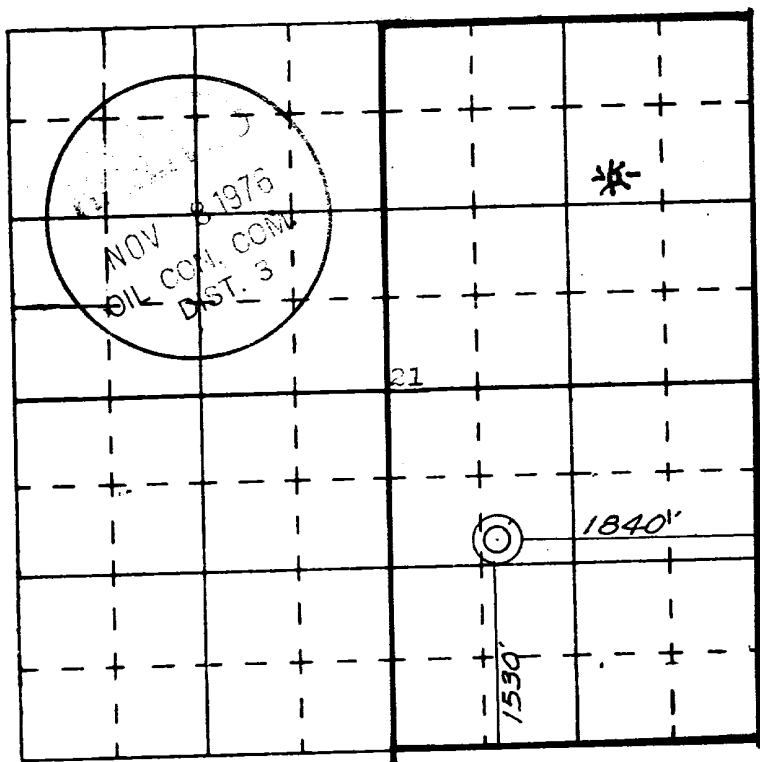

- (5) Other - Drill site. Has a low cliff to the NE and slopes to the SW. It is a low environmental risk area, and the effect of drilling the well in this area will be negligible.

g. Distances to:

- (1) Ponds and Streams - There are no surface waters within 1/2 mile.
- (2) Water Wells - No water well or windmill could be seen within 1/2 mile.
- (3) Residences and Buildings - There are no houses or buildings within 1/2 mile.
- (4) Arroyos, Canyons, etc. - See Exhibit "A". An arroyo to the southwest of location. It is about 200' away.

h. Well Sign - Sign identifying and locating well will be maintained at drill site with the spudding of the well.

i. Open Pits - All pits containing mud or other liquids will be fenced.

4. ROADS

a. Existing roads - All existing roads within one mile of the location are shown on Exhibit "A" and Exhibit "D".

b. Planned roads - Plan to construct 900' of new 14 foot wide road.

c. Fences, Gates and Cattleguards - None

5. TANK BATTERY - This is expected to be a dry gas well, therefore, a tank battery will not be required.

6. LEASE PIPELINES

a. Existing - Not furnished by the Operator, to be connected by Southern Union Gathering Co.

b. Planned - If production is encountered, all lease lines are to be constructed on a well mat.

7. WASTE DISPOSAL - Well cuttings will be disposed in reserve pit. Barrel trash containers to be in accessible locations within drill site area during drilling and completion procedures. All detrimental waste will be hauled away, burned or buried with a minimum cover of 24" dirt. See Exhibit "C" for location of pits. If well is productive, maintenance waste will be placed in special trash cans and hauled away periodically. No produced water is anticipated.

8. WATER SUPPLY - Supply water will be hauled from the San Juan River or nearest wash.
9. ARCHAEOLOGICAL RESOURCES - Report will be furnished by Nancy Hewitt from Salamon Ruins, Bloomfield, New Mexico.
10. RESTORATION OF SURFACE - If well is productive, pits will be backfilled and leveled as soon as practical to original condition.
11. OPERATOR'S REPRESENTATIVE - Field personnel who can be contacted concerning compliance of this Surface Use Plan are as follows:

Production & Drilling

Darrell Brown  
1860 Lincoln St., Suite 1200  
Denver, Colorado 80203

Office Phone: (303) 292-9920 Ext. 254  
Home Phone: (303) 771-8297

12. CERTIFICATION

I hereby certify that I, or persons under my direct supervision, have inspected the proposed drill site and access route; that I am familiar with the conditions as they actually exist; that the statements made in this plan are, to the best of my knowledge, true and correct; and that the proposed work performed by Tenneco Oil Company and its contractors and sub-contractors will conform to this plan.

11-1-76  
Date

D. E. Brown  
D. E. Brown  
Div. Drilling Engineer

**Tenneco Oil**  
A Tenneco Company  
EXHIBIT " A "

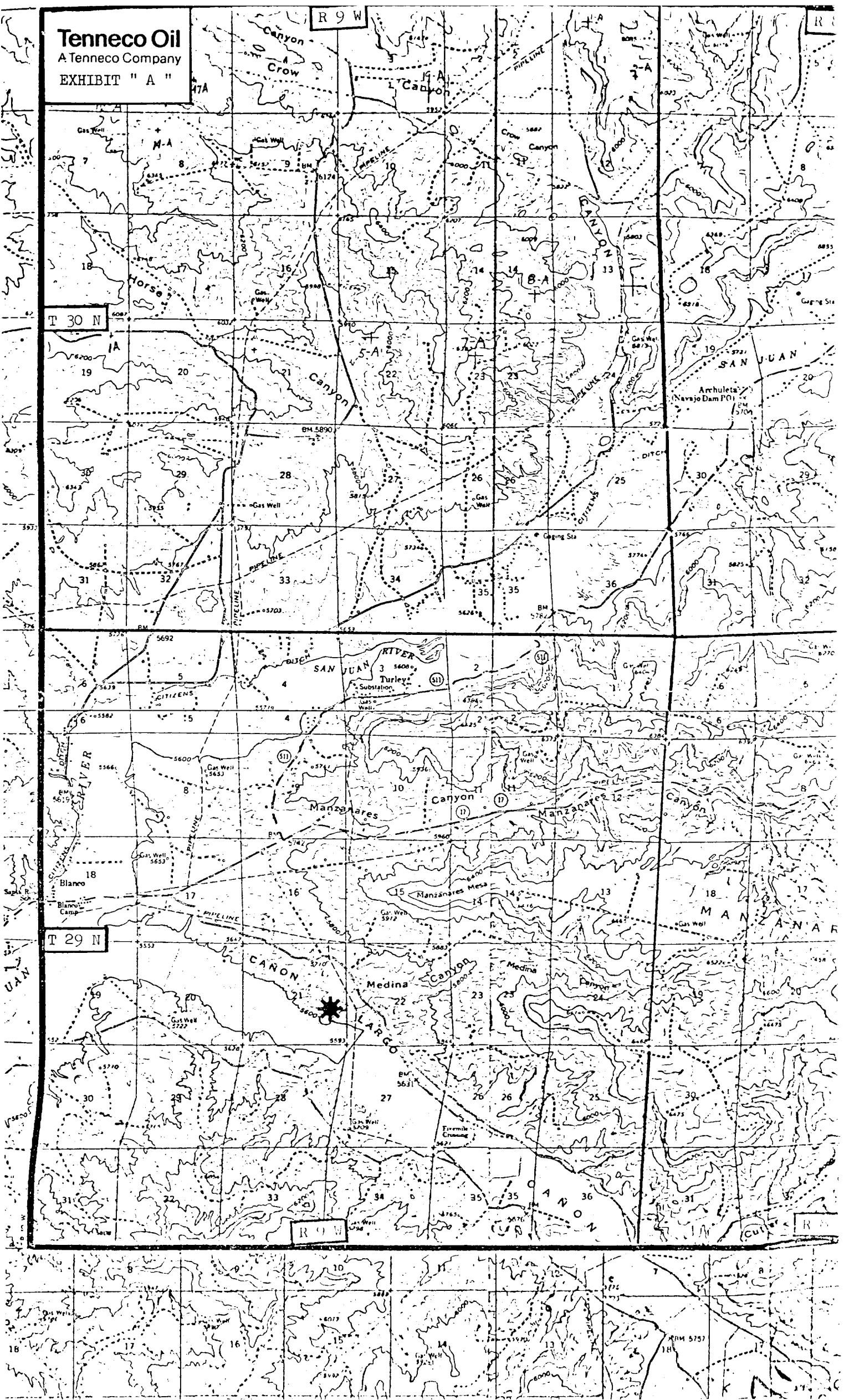



30  
N

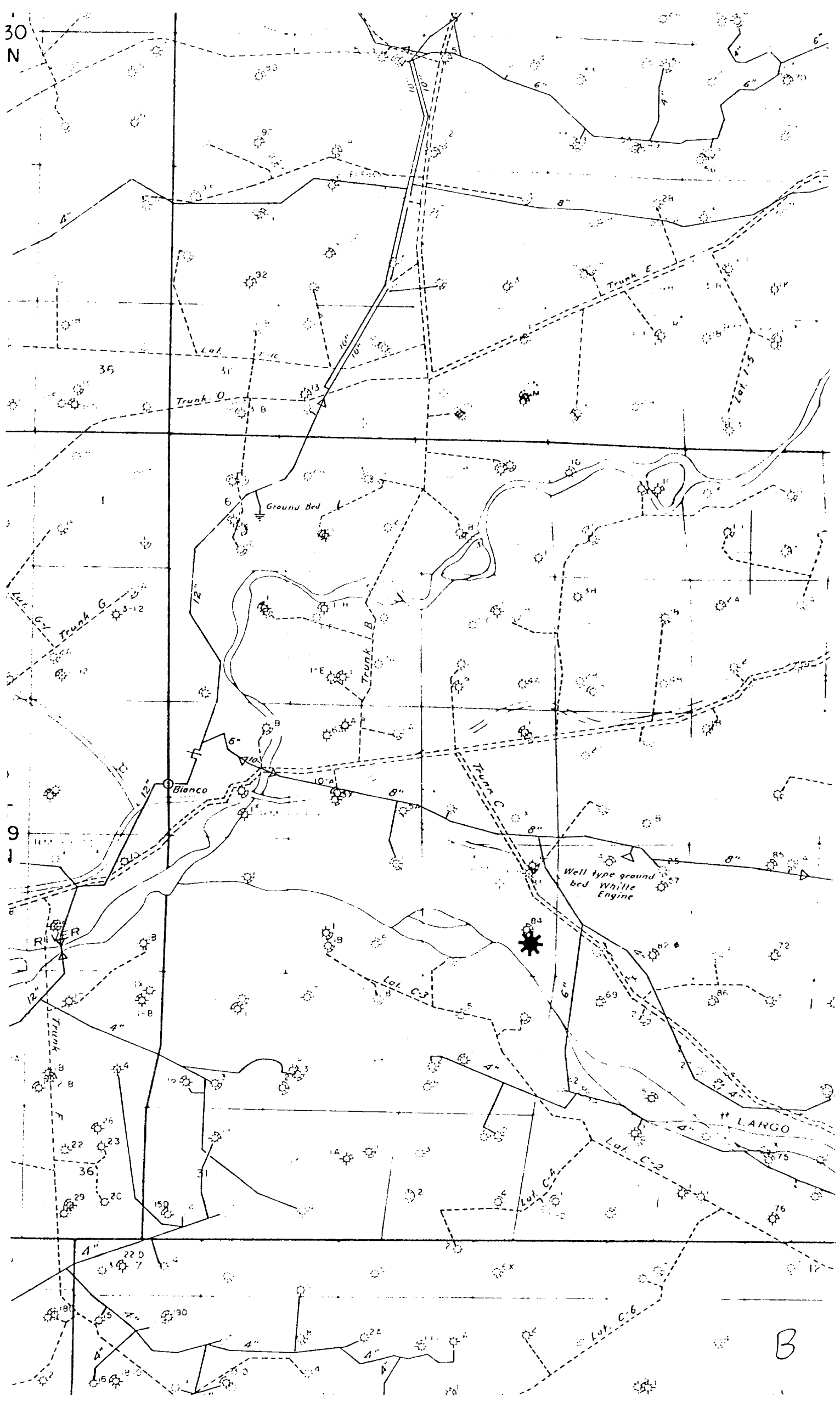
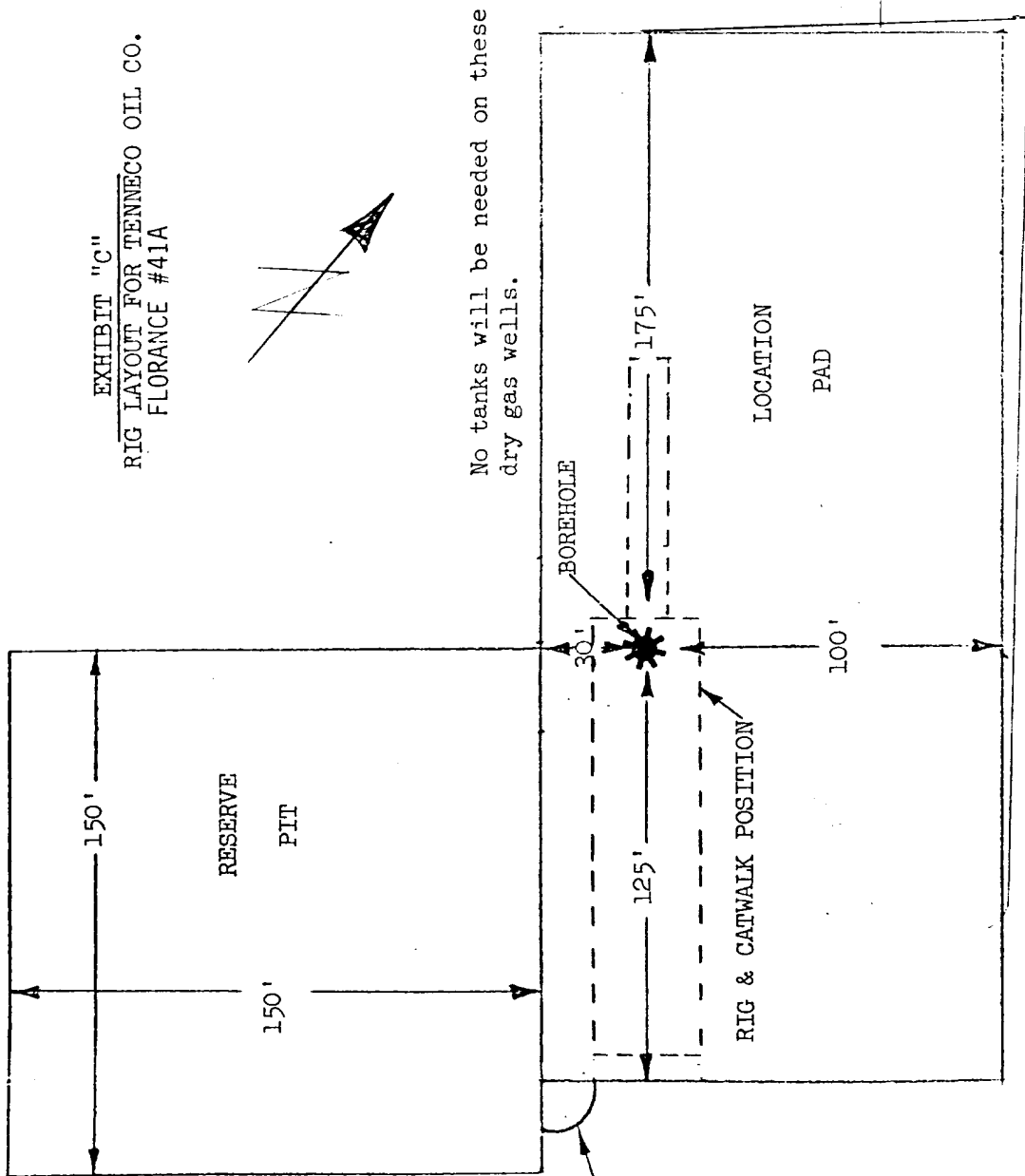
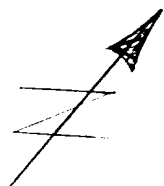

EXHIBIT "C"  
RIG LAYOUT FOR TENNECO OIL CO.  
FLORANCE #41A



scale 1" = 50'

700' at 91° W N 10° E  
T.D. J. 200 #10

# Plata

# County

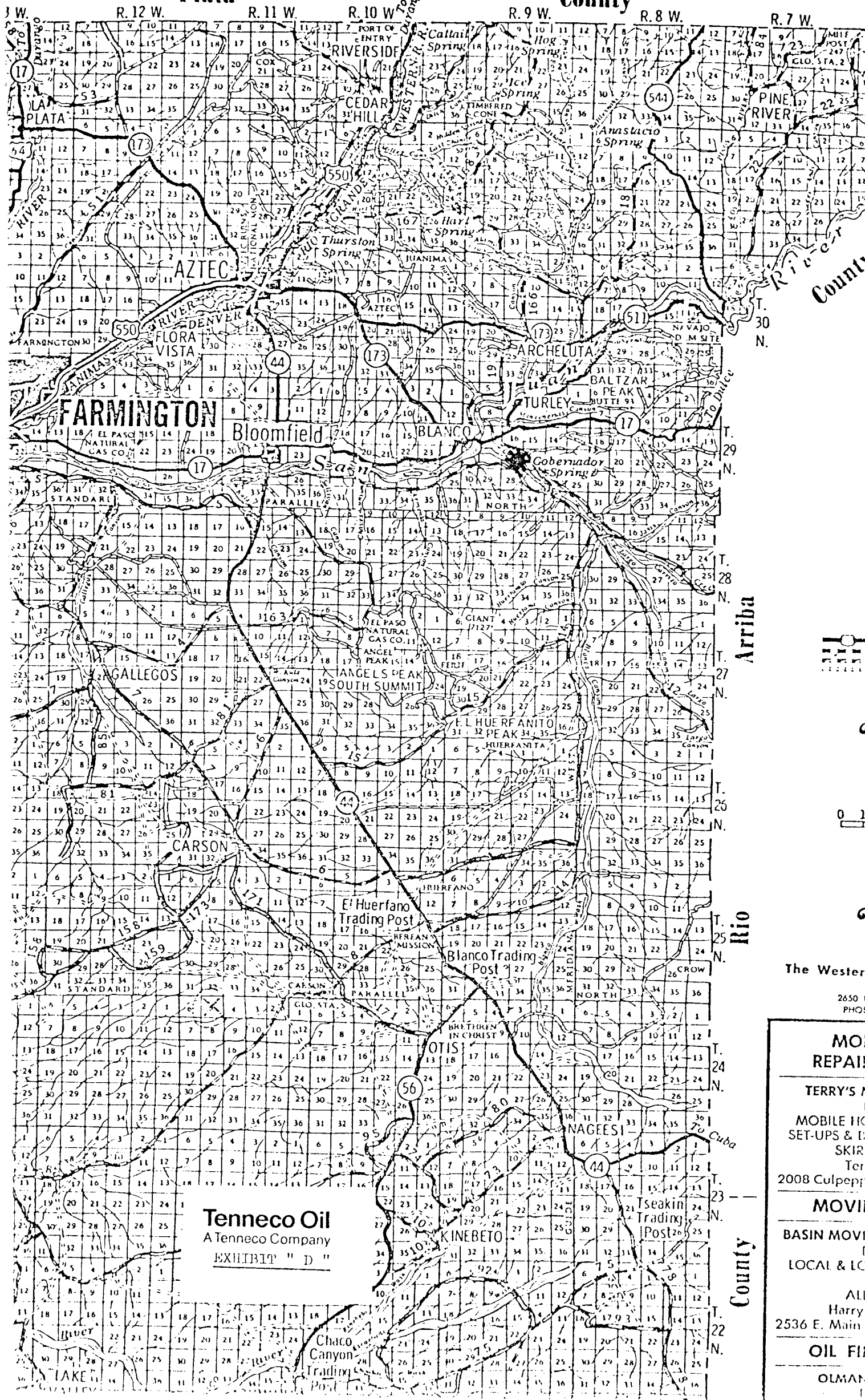

**Tenneco Oil**  
A Tenneco Company  
EXHIBIT " D "

Arriba

Rio

County

The Western

2650 E.  
PHOS

**MOE  
REPAIR**

**TERRY'S**  
MOBILE HO  
SET-UPS & D  
SKIR  
Terr  
2008 Culppe

**MOVIN**

**BASIN MOVI**  
LOCAL & LO

ALL  
Harry  
2536 E. Main

**OIL FI**

OLMAN