

UNITED STATES
DEPARTMENT OF THE INTERIOR
GEOLOGICAL SURVEY

APPLICATION FOR PERMIT TO DRILL, DEEPEN, OR PLUG BACK

1. TYPE OF WORK

DRILL ☒DEEPEN ☐PLUG BACK ☐

2. TYPE OF WELL

OIL
WELL ☐GAS
WELL ☒

OTHER

SINGLE
ZONE ☐MULTIPLE
ZONE ☐

3. NAME OF OPERATOR

Tenneco Oil Company

4. ADDRESS OF OPERATOR

1860 Lincoln St., Suite 1200, Denver, Colorado 80203

5. LOCATION OF WELL (Report location clearly and in accordance with any State requirements.)*

At surface

1850' FSL and 1470' FEL, Unit J

At proposed prod. zone

6. DISTANCE IN MILES AND DIRECTION FROM NEAREST TOWN OR POST OFFICE*

See Point One of Surface Use Plan

7. DISTANCE FROM PROPOSED*

LOCATION TO NEAREST
PROPERTY OR LEASE LINE, FT.
(Also to nearest drlg. unit line, if any)

8. DISTANCE FROM PROPOSED LOCATION*

TO NEAREST WELL, DRILLING, COMPLETED,
OR APPLIED FOR, ON THIS LEASE, FT.

9. NO. OF ACRES IN LEASE

320

10. PROPOSED DEPTH

- 4860'

11. NO. OF ACRES ASSIGNED
TO THIS WELL

E/320

E/311.97

12. ROTARY OR CABLE TOOLS

Rotary

13. ELEVATIONS (Show whether DF, RT, GR, etc.)

5761' GL

14. APPROX. DATE WORK WILL START

1-2-77

PROPOSED CASING AND CEMENTING PROGRAM

SIZE OF HOLE	SIZE OF CASING	WEIGHT PER FOOT	SETTING DEPTH	QUANTITY OF CEMENT
12-1/4"	9-5/8"	36#	± 200'	Suff. to circulate to surface
8-3/4"	7"	23#	± 2860'	Suff. to cement back to surface
6-1/8"	4-1/2"	10.5#	± 2560'-4860'	Suff. to cement back to 7" casing

Plan to drill well as follows:

1. MIRURT, drill 12-1/4" hole to ± 200'.
2. Set and cement 9-5/8" casing to ± 200' & cement with suff. cement to circ. to surface.
3. Drill out with 8-3/4" bit to ± 2860'.
4. Run 7" casing and cement back to surface casing.
5. Drill out of 7" using gas as the circulating fluid, do not drill more than 10' below the 7" casing shoe until the hole has dried up completely and is dusting.
6. Drill the hole to T. D., log the hole dry as requested by drillsite geologist.
7. Run 4-1/2" liner to T. D., load hole with mud and cement liner back to top of 4-1/2" Set liner hanger and POH w/drill pipe.
8. This well will be completed through casing perforations and stimulated as necessary to establish commercial production.
9. Clean up area.
10. Approximately 8 days will be required to drill this well.
11. The gas has been dedicated to Southern Union Gathering Co.

Continued to Page 2

IN ABOVE SPACE DESCRIBE PROPOSED PROGRAM: If proposal is to deepen or plug back, give data on present productive zone and proposed new productive zone. If proposal is to drill or deepen directionally, give pertinent data on subsurface locations and measured and true vertical depths. Give blowout preventer program, if any.

SIGNED

H. E. [Signature]

TITLE

Div. Drilling Engineer

DATE

11-4-76

(This space for Federal or State office use)

PERMIT NO.

APPROVED BY

CONDITIONS OF APPROVAL, IF ANY:

OK

N 11118 14

*See Instructions On Reverse Side

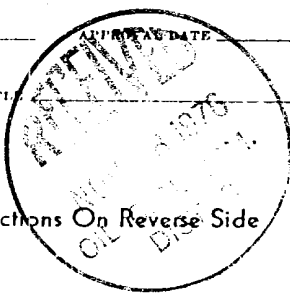

RECEIVED

DATE

NOV 5 1976

U. S. GEOLOGICAL SURVEY
FARMINGTON, N. M.

APPLICATION FOR PERMIT TO DRILL, DEEPEN, OR PLUG BACK

(PAGE 2) for Florance #25A

12. SURFACE FORMATION IS San Jose (EOCENE)

13. FORMATION TOPS (Estimated)

Pictured Cliffs	± 2360'	possible oil or gas producer
Cliff House	± 4065'	possible oil or gas producer
Menefee	± 4185'	possible oil or gas producer
Point Lookout	± 4635'	possible oil or gas producer

14. Mud program : see point 7 of 7 point well control plan

15. No coring or drill stem tests will be taken

16. Logs to be taken= Density
Gamma Ray
Caliper and temperature logs
Deviation surveys will also be taken

**NEW MEXICO OIL CONSERVATION COMMISSION
WELL LOCATION AND ACERAGE DEDICATION PLAT**

All distances must be from the outer boundaries of the Section

Operator TENNECO OIL COMPANY			Lease FLORANCE		Well No. 25-A
Unit Letter J	Section 22	Township 29 NORTH	Range 9 WEST	County SAN JUAN	

Actual Footage Location of Well:
1850 feet from the **SOUTH** line and **1470** feet from the **EAST** line

Ground Level Elev. 5761	Producing Formation Blanco Mesa Verde	Pool Blanco Mesa Verde	Dedicated Average: E/320 E/311.97 Acres
-----------------------------------	---	----------------------------------	--

1. Outline the acreage dedicated to the subject well by colored pencil or hatchure marks on the plat below.
2. If more than one lease is dedicated to the well, outline each and identify the ownership thereof (both as to working interest and royalty).
3. If more than one lease of different ownership is dedicated to the well, have the interests of all owners been consolidated by communitization, unitization, force-pooling, etc?

☒ Yes ☐ No If answer is "yes," type of consolidation **One Lease.**

If answer is "no," list the owners and tract descriptions which have actually consolidated. (Use reverse side of this form if necessary.)

No allowable will be assigned to the well until all interests have been consolidated (by communitization, unitization, forced-pooling, or otherwise) or until a non standard unit, eliminating such interests, has been approved by the Commission.

CERTIFICATION

I hereby certify that the information contained herein is true and complete to the best of my knowledge and belief.

Name *W. F. Drake*
 Position **Production Clerk**
 Company **Tenneco Oil Company**
 Date **October 26, 1976**

I hereby certify that the well location shown on this plat was plotted from field notes of actual surveys made by me or under my supervision, and that the same is true and correct to the best of my knowledge and belief.

13 October 1976
 Date Surveyed
James P. Leese
 Registered Professional Engineer
 and/or Land Surveyor **James P. Leese**

1463

Certificate No.

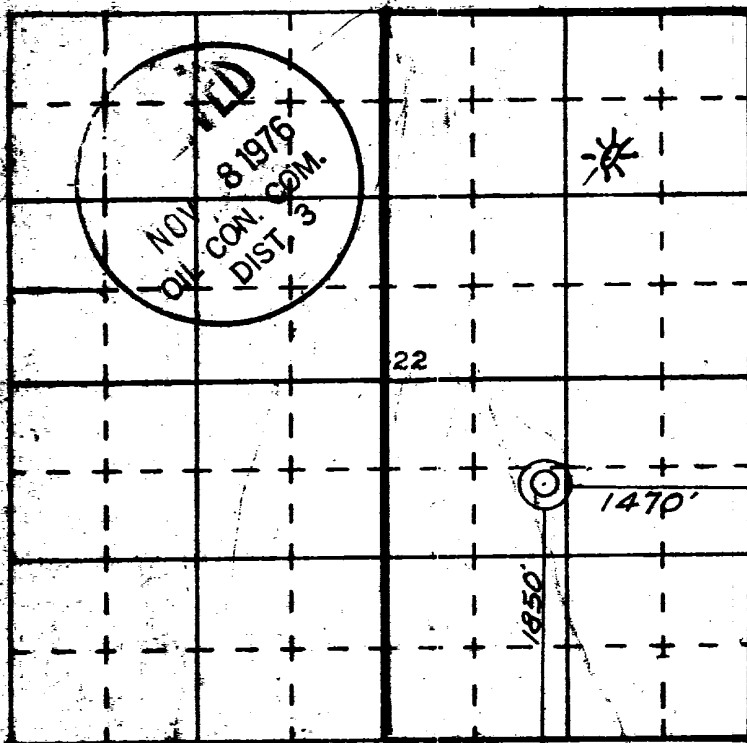

7 POINT WELL CONTROL PLAN

1. Surface casing: 9 5/8", 24#, approximately 200, grade K-55, new condition.
2. Casinghead will be 10", 900 Series, 3,000 psi rating.
3. Intermediate casing - 7", 20#, K-55, will be set at \pm 2860' and cemented to surface casing.
4. Blowout preventors: Hydraulic, double ram, 10". One set of rams will be provided for each size drill pipe in the hole. One set of blind rams at all times. Fill line will be 2", kill line will be 2", choke relief line will be 2" with variable choke.
5. Auxiliary equipment:
 - (1) Kelly cock will be in use at all times.
 - (2) Stabbing valve to fit drill pipe will be present on floor at all times.
 - (3) Mud monitoring will be visual, no abnormal pressures are anticipated in this area.
 - (4) Rotating head will be used when drilling with gas.
6. Anticipated bottom-hole pressure:

This is an area of known pressure. Maximum anticipated pressure at TD is 1200psi. No abnormal pressure is anticipated.
7. Drilling Fluids:

0 - 200'	Spud mud
200'- 2860'	Geo water - low solids as needed to maintain good conditions.
2860'- T.D.	Compressed gas

BLM SEEDING REQUIREMENTS
IN THE FARMINGTON RESOURCE AREA

1. SEED MIXTURE 2

2. TIME:

All seeding will take place between July 1 and September 15.

3. EQUIPMENT:

Seeding will be done with a disc-type drill with two boxes for various seed sizes. The drill rows will be eight to ten inches apart. The seed will be planted not less than one-half inch deep or more than one inch deep. The seeder will be followed with a drag, packer, or roller to insure uniform coverage of the seed, and adequate compaction. Drilling will be done on the contour where possible, not up and down the slope. Where slopes are too steep for contour drilling, a "cyclone" hand seeder or similar broadcast seeder will be used. Seed will then be covered to the depth described above by whatever means is practical.

4. SPECIES TO BE PLANTED IN POUNDS PURE-LIVE-SEED PER ACRE:

CRESTED WHEATGRASS (Agropyron desertorum) - $3\frac{1}{4}$ lbs.

FOURWING SALTBUSH (dewinged) (Atriplex canescens) - $\frac{1}{2}$ lb.

SAND DROPSEED (Sporobolus cryptandrus) - $\frac{3}{4}$ lb.

WINTERFAT (Eurotia lanata) - $\frac{1}{2}$ lb.

ALKALI SACATON (Sporobolus airoides) - $\frac{3}{4}$ lb.

BLM COLOR REQUIREMENTS
IN THE FARMINGTON RESOURCE AREA

1. All equipment shall be painted **green** to match the surrounding area.

SURFACE USE PLAN

TENNECO OIL COMPANY'S
Florance #25A, SE 1/4 of Sec. 22, T29N, R9W,
Lease #SF 080246, San Juan County, New Mexico

This plan is to accompany "Application for Permit to Drill" for the above mentioned well.

The following is a discussion of pertinent information concerning possible effect which the proposed drilling of the well may have on the environment of the well and road sites and surrounding acreage. A copy will be posted on the derrick floor so that all contractors and subcontractors will be aware of all items of this plan.

1. 'AREAL ROAD MAP - Exhibit "A" is a portion of a USGS topographic map, San Juan County, New Mexico, showing existing black top roads. Approximately 1-3/4 miles east of Blanco Camp, New Mexico or 511, turn south on Largo station road for 2 miles, take first left after cattleguard past Florance # 82 and then follow red flags to location.
2. LOCATION OF EXISTING WELLS - Several MV, Dak., and P.C. have been drilled in a two mile radius and are shown on Exhibit "B".
3. PROPOSED WELL MAT AND IMMEDIATE AREA - Refer to Exhibit "C" for direction orientation and road access.
 - a. Mat size - 130' x 300'
 - b. Surface - Will be native soil, bladed, watered and capped with clay only when necessary.
 - c. Reserve pit - 150' x 150' unlined pit, joining mat to the South West.
 - d. Cut & Fill - 3'-4' cut on the North and East sides.
 - e. Drill Site Layout - Exhibit "C" shows position of mat, reserve pits, burn pits, trash pits, and mud pits in relation to the well bore. Rig will be erected with the V-Door to the North West.
 - f. Setting & Environment -
 - (1) Terrain - Rolling hills of area. See Exhibit "A", topographic map
 - (2) Soil - Extremely sandy soil
 - (3) Vegetation - Sparse grass, sagebrush, juniper, and pinion pine.
 - (4) Surface Use - Unknown, possibly used for grazing.

- (5) Other - Drill site, which has a low hill to the Southwest, is in a low environmental risk area.

g. Distances to:

- (1) Ponds and Streams - There are no surface waters within 1/2 mile.
- (2) Water Wells - No water well or windmill could be seen within 1/2 mile.
- (3) Residences and Buildings - There are no houses or buildings within 1/2 mile.
- (4) Arroyos, Canyons, etc. - See Exhibit "A". An arroyo makes a 3/4 circle around the location.

h. Well Sign - Sign identifying and locating well will be maintained at drill site with the spudding of the well.

i. Open Pits - All pits containing mud or other liquids will be fenced.

4. ROADS

a. Existing roads - All existing roads within one mile of the location are shown on Exhibit "A" and Exhibit "D".

b. Planned roads - Plan to construct 900' of new 14 foot wide road.

c. Fences, Gates and Cattleguards - None

5. TANK BATTERY - This is expected to be a dry gas well, therefore, a tank battery will not be required.

6. LEASE PIPELINES

a. Existing - Not furnished by the Operator, to be connected by Southern Union Gathering Co.

b. Planned - If production is encountered, all lease lines are to be constructed on a well mat.

7. WASTE DISPOSAL - Well cuttings will be disposed in reserve pit. Barrel trash containers to be in accessible locations within drill site area during drilling and completion procedures. All detrimental waste will be hauled away, burned or buried with a minimum cover of 24" dirt. See Exhibit "C" for location of pits. If well is productive, maintenance waste will be placed in special trash cans and hauled away periodically. No produced water is anticipated.

8. WATER SUPPLY - Supply water will be hauled from the San Juan River or nearest wash.
9. ARCHAEOLOGICAL RESOURCES - Report will be furnished by Nancy Hewitt from Salamon Ruins, Bloomfield, New Mexico.
10. RESTORATION OF SURFACE - If well is productive, pits will be backfilled and leveled as soon as practical to original condition.
11. OPERATOR'S REPRESENTATIVE - Field personnel who can be contacted concerning compliance of this Surface Use Plan are as follows:

Production & Drilling

Carrell Brown
1360 Lincoln St., Suite 1200
Denver, Colorado 80203

Office Phone: (303) 292-9920 Ext. 254
Home Phone: (303) 771-8297

12. CERTIFICATION

I hereby certify that I, or persons under my direct supervision, have inspected the proposed drill site and access route; that I am familiar with the conditions as they actually exist; that the statements made in this plan are, to the best of my knowledge, true and correct; and that the proposed work performed by Tenneco Oil Company and its contractors and sub-contractors will conform to this plan.

11-7-76
Date

D. E. Brown
D. E. Brown

Div. Drilling Engineer

Tenneco Oil
A Tenneco Company
EXHIBIT " A "

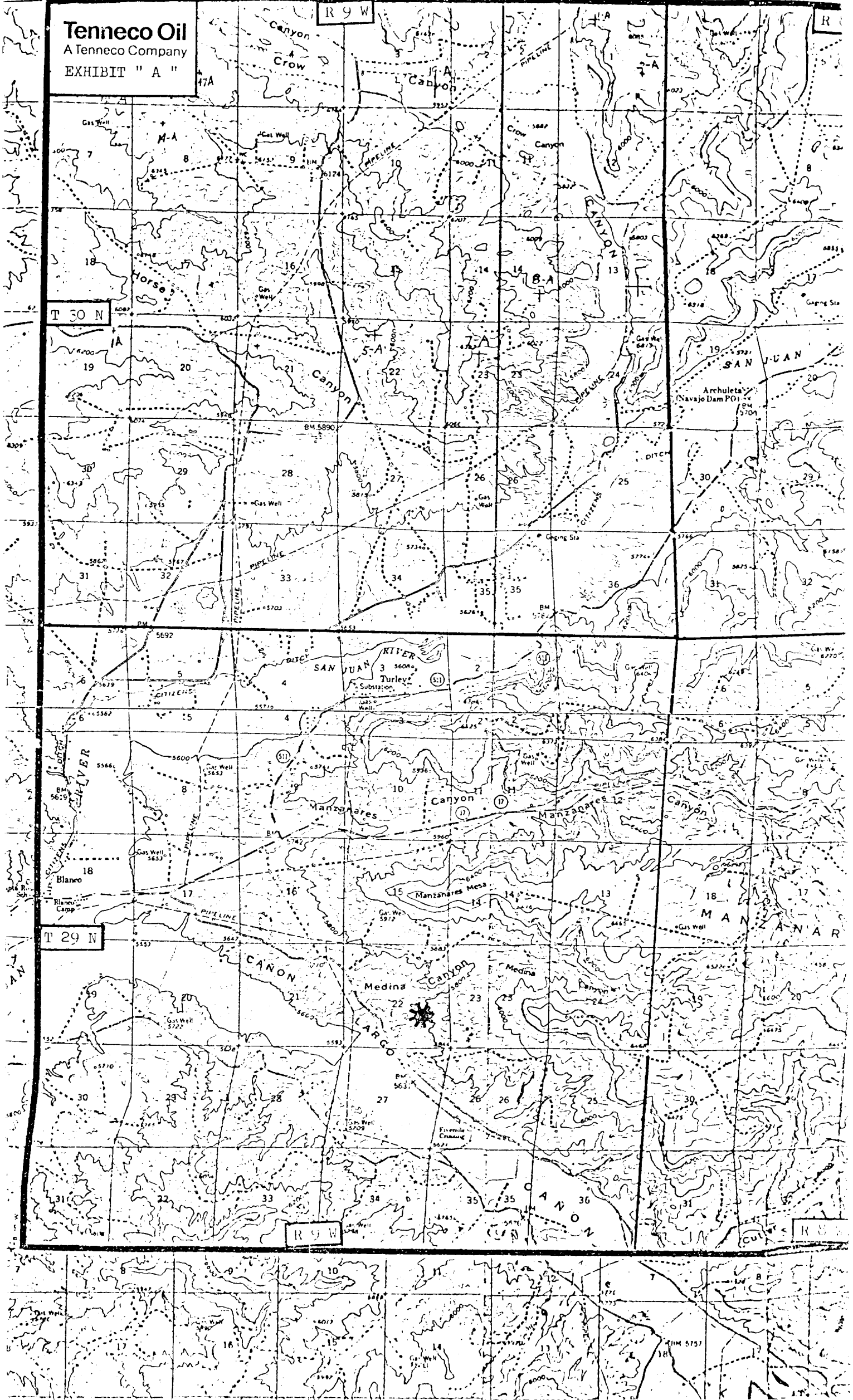

30 N

T 9 V

Ground Bed

Well type ground bed White Engine

LARGO

Trunk A

Trunk B

Trunk C

Trunk D

Trunk E

Trunk F

Trunk G

Lol. C-1

Lol. C-2

Lol. C-3

Lol. C-4

Lol. C-5

Lol. C-6

Lol. 1-16

Lol. 1-17

Lol. 1-18

Lol. 1-19

Lol. 1-20

Lol. 1-21

Lol. 1-22

Lol. 1-23

Lol. 1-24

Lol. 1-25

Lol. 1-26

Lol. 1-27

Lol. 1-28

Lol. 1-29

Lol. 1-30

Lol. 1-31

Lol. 1-32

Lol. 1-33

Lol. 1-34

Lol. 1-35

Lol. 1-36

Lol. 1-37

Lol. 1-38

Lol. 1-39

Lol. 1-40

Lol. 1-41

Lol. 1-42

Lol. 1-43

Lol. 1-44

Lol. 1-45

Lol. 1-46

Lol. 1-47

Lol. 1-48

Lol. 1-49

Lol. 1-50

Lol. 1-51

Lol. 1-52

Lol. 1-53

Lol. 1-54

Lol. 1-55

Lol. 1-56

Lol. 1-57

Lol. 1-58

Lol. 1-59

Lol. 1-60

Lol. 1-61

Lol. 1-62

Lol. 1-63

Lol. 1-64

Lol. 1-65

Lol. 1-66

Lol. 1-67

Lol. 1-68

Lol. 1-69

Lol. 1-70

Lol. 1-71

Lol. 1-72

Lol. 1-73

Lol. 1-74

Lol. 1-75

Lol. 1-76

Lol. 1-77

Lol. 1-78

Lol. 1-79

Lol. 1-80

Lol. 1-81

Lol. 1-82

Lol. 1-83

Lol. 1-84

Lol. 1-85

Lol. 1-86

Lol. 1-87

Lol. 1-88

Lol. 1-89

Lol. 1-90

Lol. 1-91

Lol. 1-92

Lol. 1-93

Lol. 1-94

Lol. 1-95

Lol. 1-96

Lol. 1-97

Lol. 1-98

Lol. 1-99

Lol. 1-100

Lol. 1-101

Lol. 1-102

Lol. 1-103

Lol. 1-104

Lol. 1-105

Lol. 1-106

Lol. 1-107

Lol. 1-108

Lol. 1-109

Lol. 1-110

Lol. 1-111

Lol. 1-112

Lol. 1-113

Lol. 1-114

Lol. 1-115

Lol. 1-116

Lol. 1-117

Lol. 1-118

Lol. 1-119

Lol. 1-120

Lol. 1-121

Lol. 1-122

Lol. 1-123

Lol. 1-124

Lol. 1-125

Lol. 1-126

Lol. 1-127

Lol. 1-128

Lol. 1-129

Lol. 1-130

Lol. 1-131

Lol. 1-132

Lol. 1-133

Lol. 1-134

Lol. 1-135

Lol. 1-136

Lol. 1-137

Lol. 1-138

Lol. 1-139

Lol. 1-140

Lol. 1-141

Lol. 1-142

Lol. 1-143

Lol. 1-144

Lol. 1-145

Lol. 1-146

Lol. 1-147

Lol. 1-148

Lol. 1-149

Lol. 1-150

Lol. 1-151

Lol. 1-152

Lol. 1-153

Lol. 1-154

Lol. 1-155

Lol. 1-156

Lol. 1-157

Lol. 1-158

Lol. 1-159

Lol. 1-160

Lol. 1-161

Lol. 1-162

Lol. 1-163

Lol. 1-164

Lol. 1-165

Lol. 1-166

Lol. 1-167

Lol. 1-168

Lol. 1-169

Lol. 1-170

Lol. 1-171

Lol. 1-172

Lol. 1-173

Lol. 1-174

Lol. 1-175

Lol. 1-176

Lol. 1-177

Lol. 1-178

Lol. 1-179

Lol. 1-180

Lol. 1-181

Lol. 1-182

Lol. 1-183

Lol. 1-184

Lol. 1-185

Lol. 1-186

Lol. 1-187

Lol. 1-188

Lol. 1-189

Lol. 1-190

Lol. 1-191

Lol. 1-192

Lol. 1-193

Lol. 1-194

Lol. 1-195

Lol. 1-196

Lol. 1-197

Lol. 1-198

Lol. 1-199

Lol. 1-200

Lol. 1-201

Lol. 1-202

Lol. 1-203

Lol. 1-204

Lol. 1-205

Lol. 1-206

Lol. 1-207

Lol. 1-208

Lol. 1-209

Lol. 1-210

Lol. 1-211

Lol. 1-212

Lol. 1-213

Lol. 1-214

Lol. 1-215

Lol. 1-216

Lol. 1-217

Lol. 1-218

Lol. 1-219

Lol. 1-220

Lol. 1-221

Lol. 1-222

Lol. 1-223

Lol. 1-224

Lol. 1-225

Lol. 1-226

Lol. 1-227

Lol. 1-228

Lol. 1-229

Lol. 1-230

Lol. 1-231

Lol. 1-232

Lol. 1-233

Lol. 1-234

Lol. 1-235

Lol. 1-236

Lol. 1-237

Lol. 1-238

Lol. 1-239

Lol. 1-240

Lol. 1-241

Lol. 1-242

Lol. 1-243

Lol. 1-244

Lol. 1-245

Lol. 1-246

Lol. 1-247

Lol. 1-248

Lol. 1-249

Lol. 1-250

Lol. 1-251

Lol. 1-252

Lol. 1-253

Lol. 1-254

Lol. 1-255

Lol. 1-256

Lol. 1-257

Lol. 1-258

Lol. 1-259

Lol. 1-260

Lol. 1-261

Lol. 1-262

Lol. 1-263

Lol. 1-264

Lol. 1-265

Lol. 1-266

Lol. 1-267

Lol. 1-268

Lol. 1-269

Lol. 1-270

Lol. 1-271

Lol. 1-272

Lol. 1-273

Lol. 1-274

Lol. 1-275

Lol. 1-276

Lol. 1-277

Lol. 1-278

Lol. 1-279

Lol. 1-280

Lol. 1-281

Lol. 1-282

Lol. 1-283

Lol. 1-284

Lol. 1-285

Lol. 1-286

Lol. 1-287

Lol. 1-288

Lol. 1-289

Lol. 1-290

Lol. 1-291

Lol. 1-292

Lol. 1-293

Lol. 1-294

L

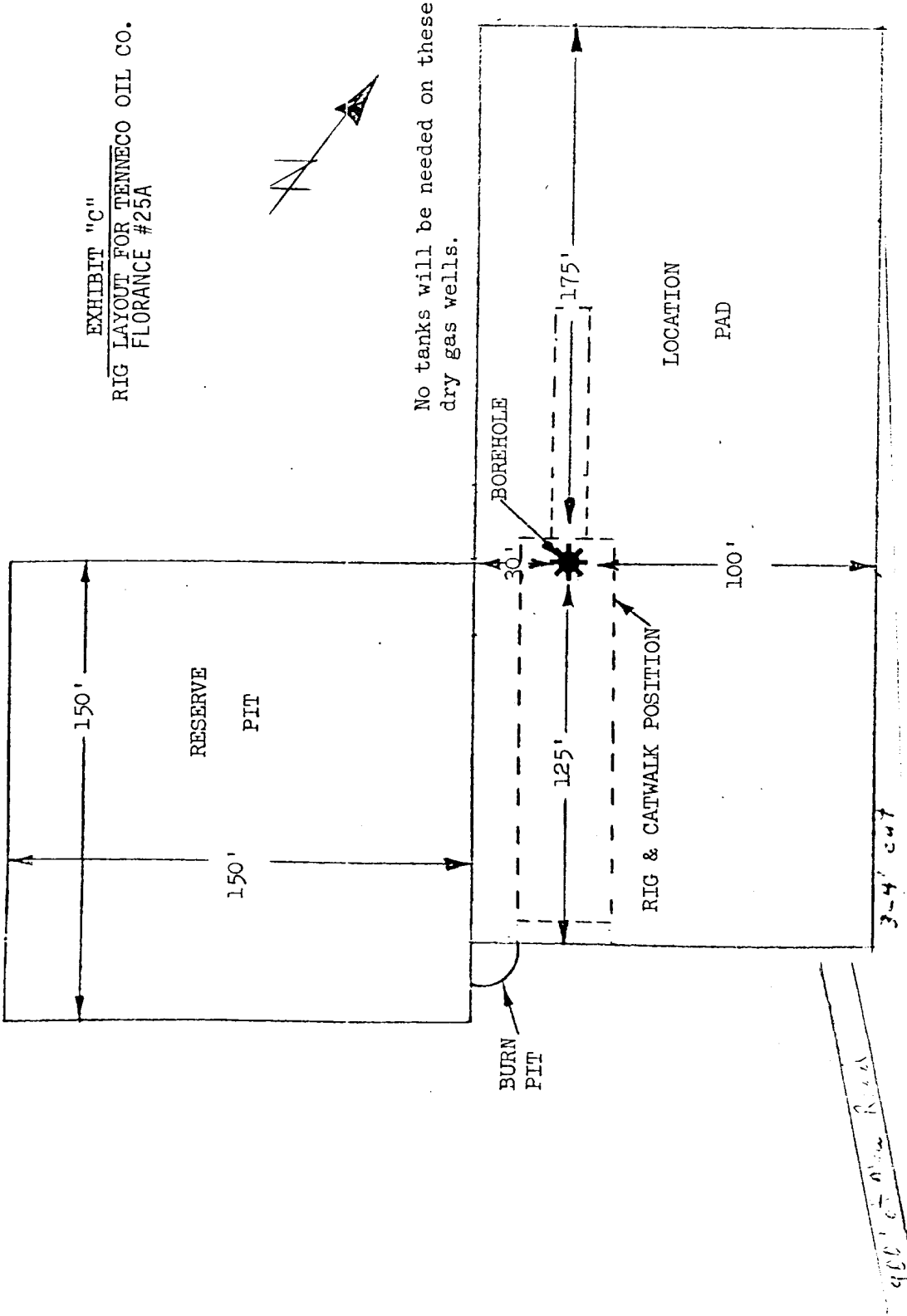

scale 1" = 50'

Drawings Attached

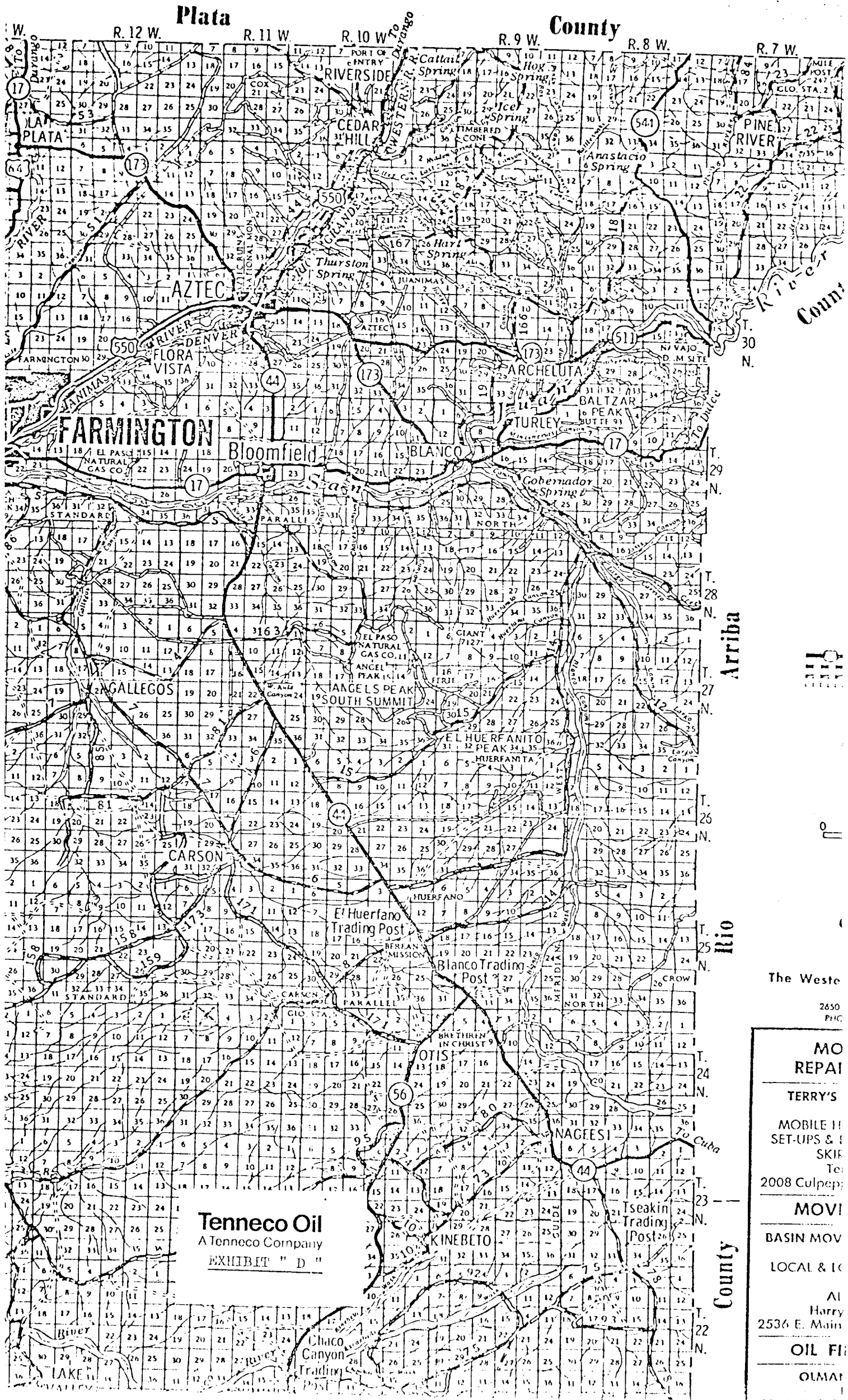

Tenneco Oil
A Tenneco Company
EXHIBIT " D "

The West

2650
PHC

**MO
REPAI**

TERRY'S

MOBILE H
SET-UPS & I
SKIF
Tel
2008 Culpepp

MOVI

BASIN MOV

LOCAL & IC

Al
Harry
2536 E. Main

OIL FI

OLMAR