

NO. OF COPIES RECEIVED	6
DISTRIBUTION	
SANTA FE	1
FILE	1
U.S.G.S.	2
LAND OFFICE	1
OPERATOR	1

NEW MEXICO OIL CONSERVATION COMMISSION

APPROVAL GRANT
FOR 90 DAYS UNLESS
DRILLING COMMENCES

EXPIRES 9-18-77

30-645-22587
Form C-101
Revised 1-1-65

5A. Indicate Type of Lease
STATE <input checked="" type="checkbox"/> FEE <input type="checkbox"/>
5. State Oil & Gas Lease No.
E-5226-1/B-10603-1

APPLICATION FOR PERMIT TO DRILL, DEEPEN, OR PLUG BACK

1a. Type of Work		7. Unit Agreement Name	
b. Type of Well OIL WELL <input type="checkbox"/> GAS WELL <input checked="" type="checkbox"/> OTHER <input type="checkbox"/>		8. Farm or Lease Name State Comm	
2. Name of Operator Mesa Petroleum Company		9. Well No. 43	
3. Address of Operator P.O. Box 2009, Amarillo, Texas 79105		10. Field and Pool, or Wildcat Blanco Pictured Cliff	
4. Location of Well UNIT LETTER <u>N</u> LOCATED <u>990</u> FEET FROM THE <u>south</u> LINE AND <u>1450</u> FEET FROM THE <u>west</u> LINE OF SEC. <u>36</u> TWP. <u>29N</u> RGE. <u>8W</u> NMPM		12. County San Juan	
19. Proposed Depth 3130		19A. Formation Pictured Cliff	
20. Rotary or C.T. Rotary		21. Elevations (Show whether DF, RT, etc.) 6295	
21A. Kind & Status Plug. Bond State Wide		21B. Drilling Contractor unknown	
22. Approx. Date Work will start July 1, 1977			

23.

PROPOSED CASING AND CEMENT PROGRAM

SIZE OF HOLE	SIZE OF CASING	WEIGHT PER FOOT	SETTING DEPTH	SACKS OF CEMENT	EST. TOP
12 1/4	8 5/8	20#	150	150 class "B"	surface
7 7/8	3 1/2	9.2#	3130	+ 2% CaCl ₂	2050
				100 sacks 65-35 Poz Mix + 12% gel, 100 sacks class "B"	

Move in - rig up rotary tools. Drill 12 1/4" hole to 150 feet and case as above. Install and test blow out preventer. Drill 7 7/8" hole to 3130 feet and case as above. If well is non-commercial it will be plugged and abandoned as per Oil Conservation Commission instructions.

No abnormal pressures are anticipated and the well will be drilled with mud having the following characteristics: WT 9.0# per gallon, viscosity 32± seconds per quart, w.l. 10 c.c ±.

Gas under this lease is dedicated to Southern Union Gas.

IN ABOVE SPACE DESCRIBE PROPOSED PROGRAM; IF PROPOSAL IS TO DEEPEN OR PLUG BACK, GIVE DATA ON PRESENT PRODUCTIVE ZONE AND PROPOSED NEW PRODUCTIVE ZONE. GIVE BLOWOUT PREVENTER PROGRAM, IF ANY.

I hereby certify that the information above is true and complete to the best of my knowledge and belief.

Signed John Alexander Title Agent Date 5-31-77
(This space for State Use)
ORIGINAL SIGNED BY N. E. MAXWELL, JR. PETROLEUM ENGINEER DIST. NO. 3

APPROVED BY _____ TITLE _____ DATE JUN 20 1977
CONDITIONS OF APPROVAL, IF ANY:

**NEW MEXICO OIL CONSERVATION COMMISSION
WELL LOCATION AND ACERAGE DEDICATION PLAT**

All distances must be from the outer boundaries of the Section

Operator MESA PETROLEUM COMPANY		Lease STATE COMM.		Well No. 43
Unit Letter N	Section 36	Township 29 NORTH	Range 8 WEST	County SAN JUAN
Actual-Footage Location of Well:				
990 feet from the SOUTH line and		1450 feet from the WEST line		
Ground Level Elev. 6295	Producing Formation Pictured Cliffs	Pool Blanco-Pictured Cliffs	Dedicated Average: 160 Acres	

1. Outline the acreage dedicated to the subject well by colored pencil or hachure marks on the plat below.
2. If more than one lease is dedicated to the well, outline each and identify the ownership thereof (both as to working interest and royalty),
3. If more than one lease of different ownership is dedicated to the well, have the interests of all owners been consolidated by communitization, unitization, force-pooling, etc?

() Yes () No If answer is "yes," type of consolidation

If answer is "no," list the owners and tract descriptions which have actually consolidated. (Use reverse side of this form if necessary.)

No allowable will be assigned to the well until all interests have been consolidated (by communitization, unitization, forced-pooling, or otherwise) or until a non standard unit, eliminating such interests, has been approved by the Commission.

CERTIFICATION

I hereby certify that the information contained herein is true and complete to the best of my knowledge and belief.

S. E. Dobler
Name
S. E. Dobler
Position
Supervisor, Drilling & Prod.
Company
Oil Con. Com.

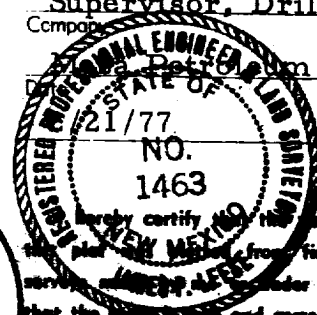

I hereby certify that the well location shown on this plat is from field notes of actual survey, made under my supervision, and that the same is true and correct to the best of my knowledge and belief.

29 January 1977
Date Surveyed
James P. Leese
Registered Professional Engineer
and/or Land Surveyor **James P. Leese**

1463
Certificate No.

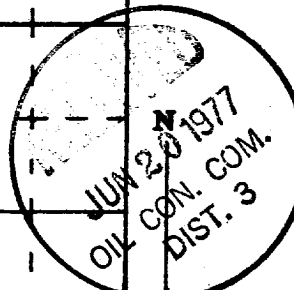
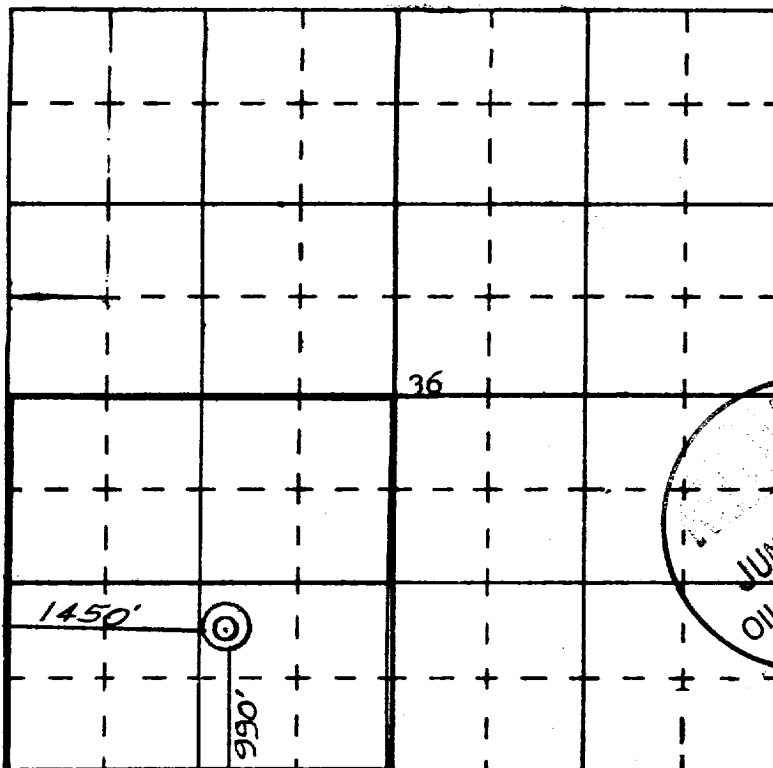

State **E-5226-1 N/2 SW/4**
B-10603-17 SW/4 SW/4





OIL CONSERVATION COMMISSION

STATE OF NEW MEXICO
1000 RIO BRAZOS RD. - AZTEC

87410

LAND COMMISSIONER
PHIL R. LUCERO

DIRECTOR
JOE D. RAMEY



STATE GEOLOGIST
EMERY C. ARNOLD

September 19, 1977

Mesa Petroleum Company

P. O. Box 2009

Amarillo, Texas 79105

Re: Mesa Petroleum Company

State Comm #143

N-36-29N-8W

Gentlemen:

Ninety days have elapsed since approval of Commission Form C-101, Notice of Intention to Drill, for the subject well and to date no progress reports, Forms C-103, have been received. Therefore, Commission approval of Form C-101 has now expired and no drilling operations are to be initiated or continued without further notice to and approval by the Commission. Pending such approval this will be considered an abandoned location.

Yours very truly,

A. R. Kendrick
Supervisor, District 3

xc: OCC, Santa Fe