

NO. OF COPIES RECEIVED	5
DISTRIBUTION	
SANTA FE	1
FILE	1
U.S.G.S.	2
LAND OFFICE	
OPERATOR	1

# NEW MEXICO OIL CONSERVATION COMMISSION

APPROVED  
FOR  
DEPT. OF

EXPIRES 11-19-79

30-045-23724  
Form C-101  
Revised 1-1-65

5A. Indicate Type of Lease	STATE <input type="checkbox"/>	FEE <input checked="" type="checkbox"/>
----------------------------	--------------------------------	---

5. State Oil & Gas Lease No.

## APPLICATION FOR PERMIT TO DRILL, DEEPEN, OR PLUG BACK

1a. Type of Work		7. Unit Agreement Name	
b. Type of Well OIL WELL <input type="checkbox"/> GAS WELL <input checked="" type="checkbox"/> OTHER <input type="checkbox"/> <b>Infill</b>		8. Farm or Lease Name <b>Chavez Gas Com "D"</b>	
2. Name of Operator <b>AMOCO PRODUCTION COMPANY</b>		9. Well No. <b>1E</b>	
3. Address of Operator <b>501 Airport Drive, Farmington, New Mexico 87401</b>		10. Field and Pool, or Wildcat <b>Basin Dakota</b>	
4. Location of Well UNIT LETTER <b>J</b> LOCATED <b>1560</b> FEET FROM THE <b>South</b> LINE AND <b>1760</b> FEET FROM THE <b>East</b> LINE OF SEC. <b>9</b> TWP. <b>29N</b> RGE. <b>9W</b> NMPM		12. County <b>San Juan</b>	
19. Proposed Depth <b>7067'</b>		19A. Formation <b>Dakota</b>	
20. Rotary or C.T. <b>Rotary</b>		21. Elevations (Show whether D.F., R.T., etc.) <b>5672' GL</b>	
21A. Kind & Status Plug. Bond <b>Statewide</b>		21B. Drilling Contractor <b>Unknown</b>	
22. Approx. Date Work will start <b>9/17/79</b>			

23.

## PROPOSED CASING AND CEMENT PROGRAM

SIZE OF HOLE	SIZE OF CASING	WEIGHT PER FOOT	SETTING DEPTH	SACKS OF CEMENT	EST. TOP
12-1/4"	9-5/8"	32.3 #	300'	240 sz.	Surface
8-3/4"	7"	23 #	2703'	400 sz.	Surface
6-1/4"	4-1/2"	11.6 #	7067'	270 sz.	2553

Amoco proposes to drill the above well to further develop the Basin Dakota reservoir. The well will be drilled to the surface casing point using native mud. The well will then be drilled to the intermediate casing point with a low solids nondispersed mud system and to TD with air. Completion design will be based on open hole logs. Copy of all logs will be filed upon completion. Amoco's standard blowout prevention will be employed; see attached drawing for blowout preventer design.

Upon completion the well location will be cleaned and the reserve pit filled and leveled.

Gas produced from this well is dedicated to El Paso Natural Gas Co.

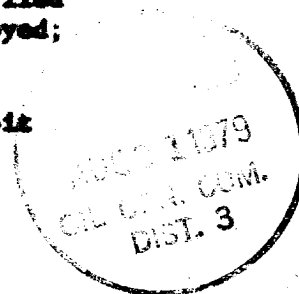

IN ABOVE SPACE DESCRIBE PROPOSED PROGRAM: IF PROPOSAL IS TO DEEPEN OR PLUG BACK, GIVE DATA ON PRESENT PRODUCTIVE ZONE AND PROPOSED NEW PRODUCTIVE ZONE. GIVE BLOWOUT PREVENTER PROGRAM, IF ANY.

I hereby certify that the information above is true and complete to the best of my knowledge and belief.

Signed B. E. FACKRELL Title District Engineer Date August 17, 1979

(This space for State Use)

APPROVED BY Frank S. Cheng TITLE DEPUTY OIL CON. COM. DIST. 3 DATE AUG 21 1979

CONDITIONS OF APPROVAL, IF ANY:

All distances must be from the outer boundaries of the Section.

Operator <b>AMOCO PRODUCTION COMPANY</b>			Lease <b>CHAVEZ GAS COM "D"</b>		Well No. <b>1 E</b>
Unit Letter <b>J</b>	Section <b>3</b>	Township <b>29N</b>	Range <b>9W</b>	County <b>San Juan</b>	
Actual Footage Location of Well: <b>1560</b> feet from the <b>South</b> line and <b>1760</b> feet from the <b>East</b> line					
Ground Level Elev. <b>5672</b>	Producing Formation <b>Dakota</b>		Pool <b>Basin Dakota</b>		Dedicated Acreage: <b>323.40</b> Acres

1. Outline the acreage dedicated to the subject well by colored pencil or hachure marks on the plat below.
2. If more than one lease is dedicated to the well, outline each and identify the ownership thereof (both as to working interest and royalty).
3. If more than one lease of different ownership is dedicated to the well, have the interests of all owners been consolidated by communitization, unitization, force-pooling, etc?

☒ Yes ☐ No If answer is "yes," type of consolidation Communitization

If answer is "no," list the owners and tract descriptions which have actually been consolidated. (Use reverse side of this form if necessary.)

No allowable will be assigned to the well until all interests have been consolidated (by communitization, unitization, forced-pooling, or otherwise) or until a non-standard unit, eliminating such interests, has been approved by the Commission.

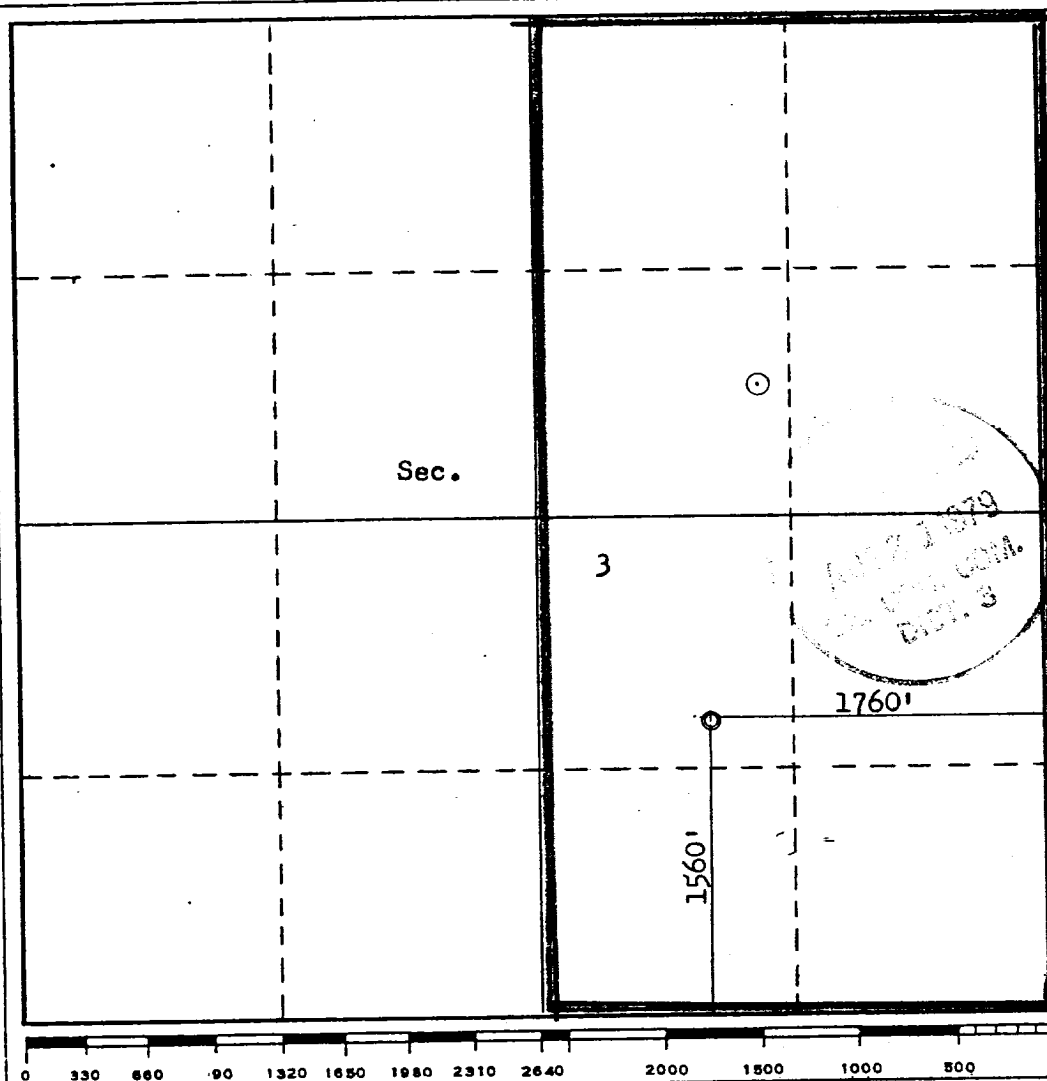

CERTIFICATION

I hereby certify that the information contained herein is true and complete to the best of my knowledge and belief.

*B. E. Fackrell*

Name  
**B. E. FACKRELL**

Position  
**DISTRICT ENGINEER**

Company  
**AMOCO PRODUCTION COMPANY**

Date  
**AUGUST 7, 1979**

I hereby certify that the well location shown on this plat was plotted from field notes of actual surveys made by me or under my supervision, and that the same is true and correct to the best of my knowledge and belief.

Date Surveyed

**AUGUST 14, 1979**

Registered Professional Engineer and/or Land Surveyor

*Fred B. Kerr, Jr.*

Certificate No. **3950 KERR, JR.**