

NO. OF COPIES RECEIVED	
DISTRIBUTION	
SANTA FE	
FILE	
U.S.G.S.	
LAND OFFICE	
OPERATOR	

# NEW MEXICO OIL CONSERVATION COMMISSION

Form C-101  
Revised 1-1-65

30-043-24817

5A. Indicate Type of Lease	
STATE <input checked="" type="checkbox"/>	FEE <input type="checkbox"/>
5. State Oil & Gas Lease No.	
E-5226	

## APPLICATION FOR PERMIT TO DRILL, DEEPEN, OR PLUG BACK

1a. Type of Work		7. Unit Agreement Name	
b. Type of Well DRILL <input checked="" type="checkbox"/> DEEPEN <input type="checkbox"/> PLUG BACK <input type="checkbox"/> OIL WELL <input type="checkbox"/> GAS WELL <input checked="" type="checkbox"/> OTHER <input type="checkbox"/> SINGLE ZONE <input type="checkbox"/> MULTIPLE ZONE <input checked="" type="checkbox"/>		8. Farm or Lease Name JESUS CANYON	
2. Name of Operator MESA PETROLEUM CO.		9. Well No. 1	
3. Address of Operator 1660 Lincoln, 2800 Lincoln Center, Denver, Colorado 80264		10. Field and Pool or Wildcat CANYON FRUITLAND BLANCO PICTURED CLIFFS	
4. Location of Well UNIT LETTER H LOCATED 1660 FEET FROM THE NORTH LINE AND 1170 FEET FROM THE EAST LINE OF SEC. 36 TWP. 29N RGE. 8W NMPM		12. County SAN JUAN	
19. Proposed Depth 3150		19A. Formation FRUITLAND PICTURED CLIFFS	
20. Rotary or C.T. ROTARY		21. Elevations (Show whether DF, RT, etc.) 6254 GL	
21A. Kind & Status Plug. Bond STATEWIDE		21B. Drilling Contractor UNKNOWN	
22. Approx. Date Work will start February 21, 1981		23.	

## PROPOSED CASING AND CEMENT PROGRAM

SIZE OF HOLE	SIZE OF CASING	WEIGHT PER FOOT	SETTING DEPTH	SACKS OF CEMENT	EST. TOP
12 1/4	8 5/8	24	200	150	Surface
7 7/8	4 1/2	10.5	3150	500	Surface

A double-ram BOP, 10"-900 series, will be installed and operational for all drilling below surface casing. Adequate mud and weight material will be stocked on location. Mud weight will be increased to control any blowout situation.

Gas under this lease is dedicated to a contract.

APPROVED FOR STATE  
DRILLING PERMIT  
EXPIRES 7-23-81

IN ABOVE SPACE DESCRIBE PROPOSED PROGRAM; IF PROPOSAL IS TO DEEPEN OR PLUG BACK, GIVE DATA ON PRESENT PRODUCTIVE ZONE AND PROPOSED NEW PRODUCTIVE ZONE. GIVE BLOWOUT PREVENTER PROGRAM, IF ANY.

I hereby certify that the information above is true and complete to the best of my knowledge and belief.

Signed John Alexander AGENT Date January 16, 1981

(This space for State Use)

APPROVED BY Frank J. [Signature] TITLE SUPERVISOR DATE JAN 22 1981

CONDITIONS OF APPROVAL, IF ANY:

All distances must be from the outer boundaries of the Section.

Operator <b>MESA PETROLEUM COMPANY</b>		Lease <i>Spas</i> <b>13505 CANYON</b>		Well No. <b>1</b>
Unit Letter <b>H</b>	Section <b>36</b>	Township <b>29N</b>	Range <b>8W</b>	County <b>San Juan</b>
Actual Footage Location of Well: <b>1660</b> feet from the <b>North</b> line and <b>1170</b> feet from the <b>East</b> line				
Ground Level Elev. <b>6254</b>	Producing Formation <b>FRUITLAND PICTURED CLIFFS</b>		<b>BLANCO PICTURED CLIFFS</b>	Dedicated Acreage: <b>160</b> Acres

1. Outline the acreage dedicated to the subject well by colored pencil or hachure marks on the plat below.
2. If more than one lease is dedicated to the well, outline each and identify the ownership thereof (both as to working interest and royalty).
3. If more than one lease of different ownership is dedicated to the well, have the interests of all owners been consolidated by communitization, unitization, force-pooling, etc?

☐ Yes ☐ No If answer is "yes," type of consolidation \_\_\_\_\_

If answer is "no," list the owners and tract descriptions which have actually been consolidated. (Use reverse side of this form if necessary.) \_\_\_\_\_

No allowable will be assigned to the well until all interests have been consolidated (by communitization, unitization, forced-pooling, or otherwise) or until a non-standard unit, eliminating such interests, has been approved by the Commission.

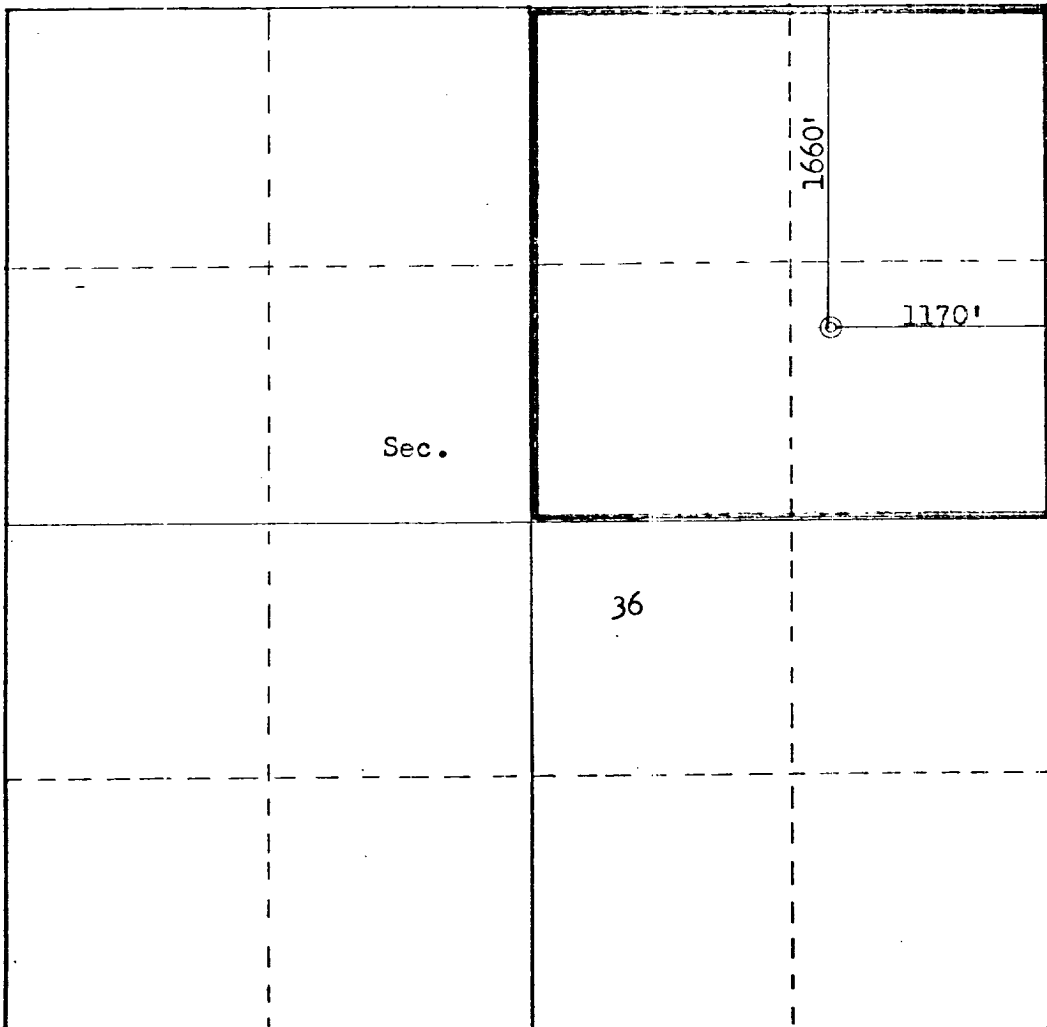

Scale: 1"=1000'

CERTIFICATION

I hereby certify that the information contained herein is true and complete to the best of my knowledge and belief.

*John Alexander*

Name  
**JOHN ALEXANDER**

Position

**AGENT**

Company

**MESA PETROLEUM CO.**

Date

**January 16, 1981**

I hereby certify that the well location shown on this plat was plotted from field notes of actual measurements by me or under my supervision, and that the same is true and correct to the best of my knowledge and belief.

Date Surveyed

**December 20, 1980**

Registered Professional Engineer and Land Surveyor

*Fred B. Kerr*

Certified New Mexico

**3950 KERR, JR.**