

Submit to Appropriate
District Office
State Lease - 6 copies
Fee Lease - 5 copies

State of New Mexico
Energy, Minerals and Natural Resources Department

Form C-101
Revised 1-1-89

OIL CONSERVATION DIVISION

DISTRICT I
P.O. Box 1980, Hobbs, NM 88240

DISTRICT II
P.O. Drawer DD, Artesia, NM 88210

DISTRICT III
1000 Rio Brazos Rd., Aztec, NM 87410

P.O. Box 2088
Santa Fe, New Mexico 87504-2088

API NO. (assigned by OCD on New Wells)

30-045-29013

5. Indicate Type of Lease

STATE ☒

FEE ☐

6. State Oil & Gas Lease No.
E-5226

APPLICATION FOR PERMIT TO DRILL, DEEPEN, OR PLUG BACK

1a. Type of Work:

DRILL ☒

RE-ENTER ☐

DEEPEN ☐

PLUG BACK ☐

b. Type of Well:

OIL
WELL ☐

GAS
WELL ☒

OTHER

SINGLE
ZONE ☐

MULTIPLE
ZONE ☒

7. Lease Name or Unit Agreement Name

State Com Q

2. Name of Operator

Conoco, Inc. 5673

8. Well No.
13R

3. Address of Operator

10 Desta Dr. Ste 100W, Midland, TX 79705

9. Pool name or Wildcat
Blanco MV / Basin Dakota

4. Well Location

Unit Letter H : 1660' Feet From The North Line and 1105' Feet From The East Line

Section 36

Township 29N

Range 8W

NMPM

San Juan County

10. Proposed Depth

7800'

11. Formation

Mesaverde / Dakota

12. Rotary or C.T.

13. Elevations (Show whether DF, RT, GR, etc.)

6270'

14. Kind & Status Plug. Bond

15. Drilling Contractor

16. Approx. Date Work will start

17. PROPOSED CASING AND CEMENT PROGRAM

SIZE OF HOLE	SIZE OF CASING	WEIGHT PER FOOT	SETTING DEPTH	SACKS OF CEMENT	EST. TOP
13-1/2"	10-3/4"	40.5#	300'	285 sxs	surface
9-7/8"	7-5/8"	26.4#	3400'	370 sxs	surface
6-3/4"	5-1/2" F/J	15.5#	7200'	156 sxs	2900'
4-3/4"	3-1/2" F/J	9.3#	7800'	51 sxs	7000'

It is proposed to drill this dual Mesaverde / Dakota well to a depth of 3085' according to the well plan contained in the following attachments:

1. Well Location and Acreage Dedication Plat (C-102)
2. Proposed Well Plan Outline
3. Casing, Cementing, and Mud programs information sheet
4. BOP information sheet
5. BOP / Choke Diagram

This Approval

Expires 2-11-95

And will not be

Extended

RECEIVED

FEB 11 1994

OIL CON. D
DIST. 3

IN ABOVE SPACE DESCRIBE PROPOSED PROGRAM: IF PROPOSAL IS TO DEEPEN OR PLUG BACK, GIVE DATA ON PRESENT PRODUCTIVE ZONE AND PROPOSED NEW PRODUCTIVE ZONE. GIVE BLOWOUT PREVENTER PROGRAM, IF ANY.

I hereby certify that the information above is true and complete to the best of my knowledge and belief.

SIGNATURE

Gerry W. Hoover

TITLE

Sr. Conservation Coordinator

DATE 2/7/94

TYPE OR PRINT NAME

Gerry W. Hoover

(915) 686-6548 TELEPHONE NO.

(This space for State Use)

APPROVED BY

Ernie B. ...

TITLE

DEPUTY OIL & GAS INSPECTOR, DIST. #3

DATE

FEB 11 1994

CONDITIONS OF APPROVAL, IF ANY:

Submit to Appropriate
District Office
State Lease - 4 copies
Fee Lease - 3 copies

State of New Mexico
Energy, Minerals and Natural Resources Department

Form C-102
Revised 1-1-89

OIL CONSERVATION DIVISION

P.O. Box 2088
Santa Fe, New Mexico 87504-2088

DISTRICT I
P.O. Box 1980, Hobbs, NM 88240

DISTRICT II
P.O. Drawer DD, Artesia, NM 88210

DISTRICT III
1000 Rio Brazos Rd., Aztec, NM 87410

WELL LOCATION AND ACREAGE DEDICATION PLAT

All Distances must be from the outer boundaries of the section

Operator CONOCO INC.			Lease STATE COM Q		Well No. 13R
Unit Letter H	Section 36	Township 29 NORTH	Range 8 WEST	County SAN JUAN	
Actual Footage Location of Well: 1660 feet from the NORTH line and 1105 feet from the EAST line					
Ground level Elev. 6270	Producing Formation Mesaverde/Dakota	Pool Blanco Mesaverde/Basin Dakota	Dedicated Acreage: E/320/320 Acres		
<p>1. Outline the acreage dedicated to the subject well by colored pencil or hatchure marks on the plat below.</p> <p>2. If more than one lease is dedicated to the well, outline each and identify the ownership thereof (both as to working interest and royalty).</p> <p>3. If more than one lease of different ownership is dedicated to the well, have the interest of all owners been consolidated by communitization, unitization, force-pooling, etc.? <input type="checkbox"/> Yes <input type="checkbox"/> No If answer is "yes" type of consolidation _____</p> <p>If answer is "no" list the owners and tract descriptions which have actually been consolidated. (Use reverse side of this form if necessary.) _____</p> <p>No allowable will be assigned to the well until all interests have been consolidated (by communitization, unitization, forced-pooling, or otherwise) or until a non-standard unit, eliminating such interest, has been approved by the Division.</p>					

5258.88'

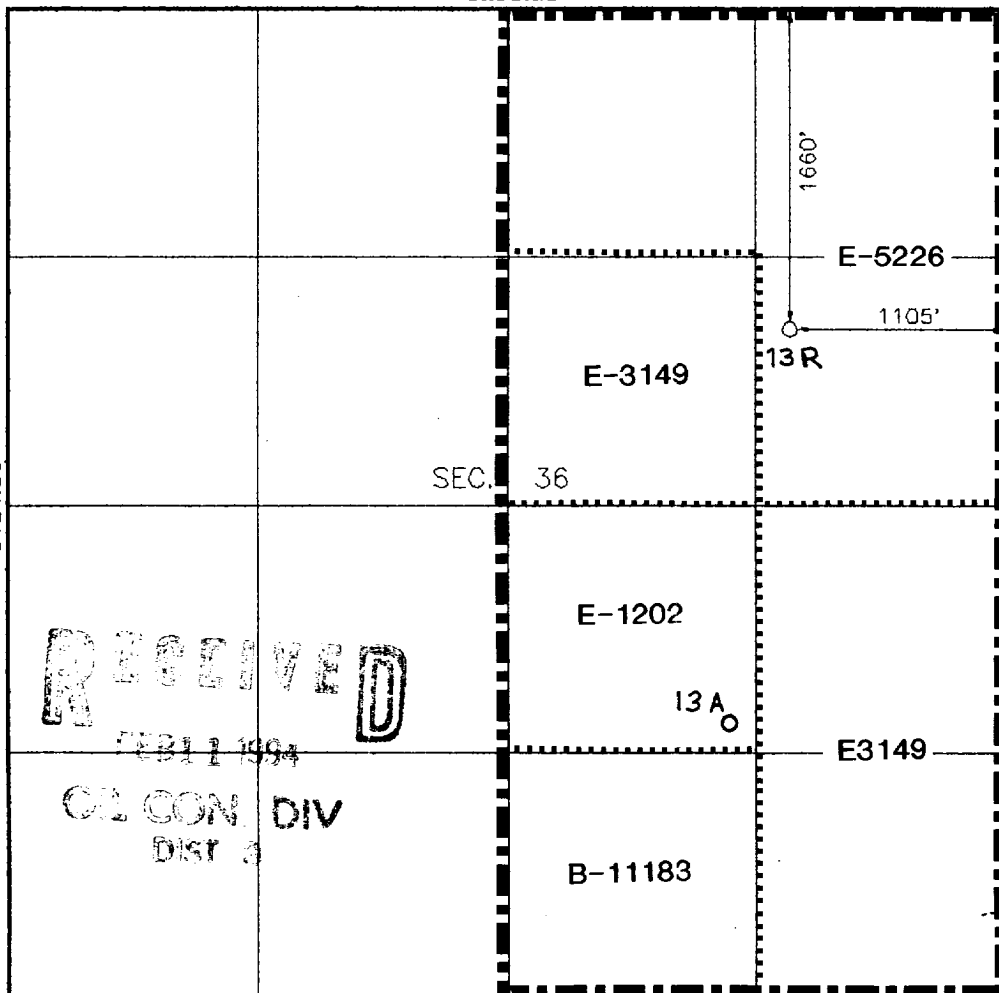

OPERATOR CERTIFICATION

I hereby certify that the information contained herein is true and complete to the best of my knowledge and belief.

Signature
Printed Name
Position
Sr. Conservation Coordinator
Company
Conoco Inc.
Date
2/7/94

SURVEYOR CERTIFICATION

I hereby certify that the well location shown on this plat was plotted from field notes of actual surveys made by me or under my supervision, and that the same is true and correct to the best of my knowledge and belief.
1/20/94

Date Surveyed
Needle C. Edwards
Signature
Professional Surveyor
9857
6857

PROPOSED WELL PLAN OUTLINE

WELL NAME: ST. COM. Q-13R

EST. GLE = +6270'

EST. KB = +6285'

LOCATION: 1660' FNL & 1105' FEL, SEC 36 - T29N - R8W, SAN JUAN CO., NEW MEXICO

TVD IN 1000'	MD	FORMATION TOPS & TYPE	DRILLING PROBLEMS	TYPE OF FORMATION EVALUATION	HOLE SIZE	CASING SIZE DEPTH	FRAC GRAD	FORMATION PRESSURE GRADIENT	MUD WT TYPE	DAYS
0					13-1/2"	10-3/4" 40.5# K-55 ST&C @ 300'		NORMAL	8.4 - 8.8# SPUD MUD	
1					9-7/8"			8.4 - 9.5#	8.4 - 10.0# GEL/WATER	
2		OJAM @ 1946'	POSSIBLE WATER FLOW							
3		FRLD @ 2620' PCCF @ 2924' LWIS @ 3093'	POSSIBLE GAS FLOW POSSIBLE LOST RETURNS		9-7/8"	7-5/8" 26.4# K-55 LT&C		8.4 - 9.5#		
4				GR-DIL-CNL-LDT	6-3/4"				AIR/AIR MIST	
5		CLFH/MV @ 4408' MENF @ 4738'	PROBABLE LOST RETURNS IF FLUID IN HOLE							
6		PTLK @ 5149' MNCS @ 5541'								
7		GLLP @ 6432'			6-3/4"	5-1/2" 15.5# K-55 FLUSH JT.				
8		DKOT @ 7198'	POSSIBLE WATER FLOW POSSIBLE OVERPRESSURE IN DEEP DAKOTAL.	GR-DIL-CNL-LDT	4-3/4"				AIR/AIR MIST	
8		T.D. @ 7800'			4-3/4"	3-1/2" 9.3# K-55 FLUSH JT.				

DATE: JANUARY 1994

STATE COM. Q-13R
SEC 36, T29N, R8W
SAN JUAN COUNTY, NEW MEXICO

Conoco proposes to drill the Q-13R well as a vertical hole to 7800'. The well be a dual completion and develop gas reserves in the Mesa Verde and Dakota formations. Please see the attached Well Plan Outline for the proposed mud program and estimated formation tops.

The well plan calls for setting 10-3/4" casing at \pm 300'. Next a 9-7/8" hole will be drilled to \pm 3400' and 7-5/8" intermediate casing will be set. A 6-3/4" hole is planned to \pm 7200' where 5-1/2" casing is planned. A 4-3/4" hole is planned to total depth of the well at \pm 7800'. A 3-1/2" liner will be set if required. The surface and bottom hole location and casing and cement program are planned as follows:

Surface & PBHL: 1660' FNL & 1105' FEL Sec. 36-29N-8W

CASING AND CEMENTING PROGRAM:

Footage	Casing	Cement
300'	10-3/4" 40.5#, K-55, ST&C	<u>285</u> sxs Cl "G" + 3% CaCl 15.8 ppg, 1.17 cu. ft./sx
3400'	7-5/8" 26.4#, K-55, LT&C	<u>370</u> sxs 35/65 Poz/Cl "G" + 6% Gel + 2% CaCl 12.4 ppg, 1.86 cu. ft./sx <u>60</u> sxs Cl "G" + 2% CaCl 15.8 ppg, 1.16 cu. ft./sx
7200'	5-1/2" 15.5#, K-55, FJ	<u>156</u> sxs 35/65 Poz/Cl "G" + 6% Gel 12.4 ppg, 1.86 cu. ft./sx <u>50</u> sxs Cl "G" + 35% Silica 15.8 ppg, 1.53 cu. ft./sx
7000' - 7800'	3-1/2" 9.3#, K-55, FJ	<u>51</u> sxs Cl "G" + 35% Silica 15.8 ppg, 1.53 cu. ft./sx

MUD PROGRAM

Interval		Mud Weight (lbs/gal)	Viscosity (secs)	Fluid Loss (cc)	Mud Type
0 -	300'	8.4 - 9.4	Native	N/C	Spud Mud
300' -	3400'	8.4 - 9.4	30 - 45	N/C	Gel/Water
3400' -	7200'	N/A	N/A	N/A	Air/Air-mist
7200' -	7800'	N/A	N/A	N/A	Air/Air-mist

The hole interval below 3400' is planned for Air/Air-mist drilling. The hole will be loaded with Gel/Water mud if hole conditions dictate.

No DST's are planned. DIL, LDT, CNL, and Sonic Logs will be run.

BOP INFORMATION

Drilling contractors used in the San Juan Basing supply 3000 psi equipment, but cannot provide annular preventors because of sub-structure limitations. Maximum anticipated surface pressures for this well will not exceed the working pressure of the proposed BOP system. Please see the attached BOP diagram details 2000 psi equipment according to Onshore Order No. 2 even though the equipment will test to 3000 psi. The 2000 psi system allows deletion of the annular preventor and fulfills your requirements (note diagram No. 1). In addition, the following equipment will comprise the 2000 psi system:

1. Two rams with one blind and one pipe ram.
2. Kill line (2 inch maximum).
3. One kill line valve.
4. One choke line valve.
5. Two chokes (reference diagram No. 1).
6. Upper kelly cock valve with handle.
7. Safety valve and subs to fit all drill strings in use.
8. Two-inch minimum choke line.
9. Pressure gauge on choke manifold.
10. Fill-up line above the upper most preventor.
11. Rotating head.

Please direct any questions to: Billy Goodwin - (915) 686-6154 in Conoco's Midland Office.

Q13RPER

DIAGRAM 1

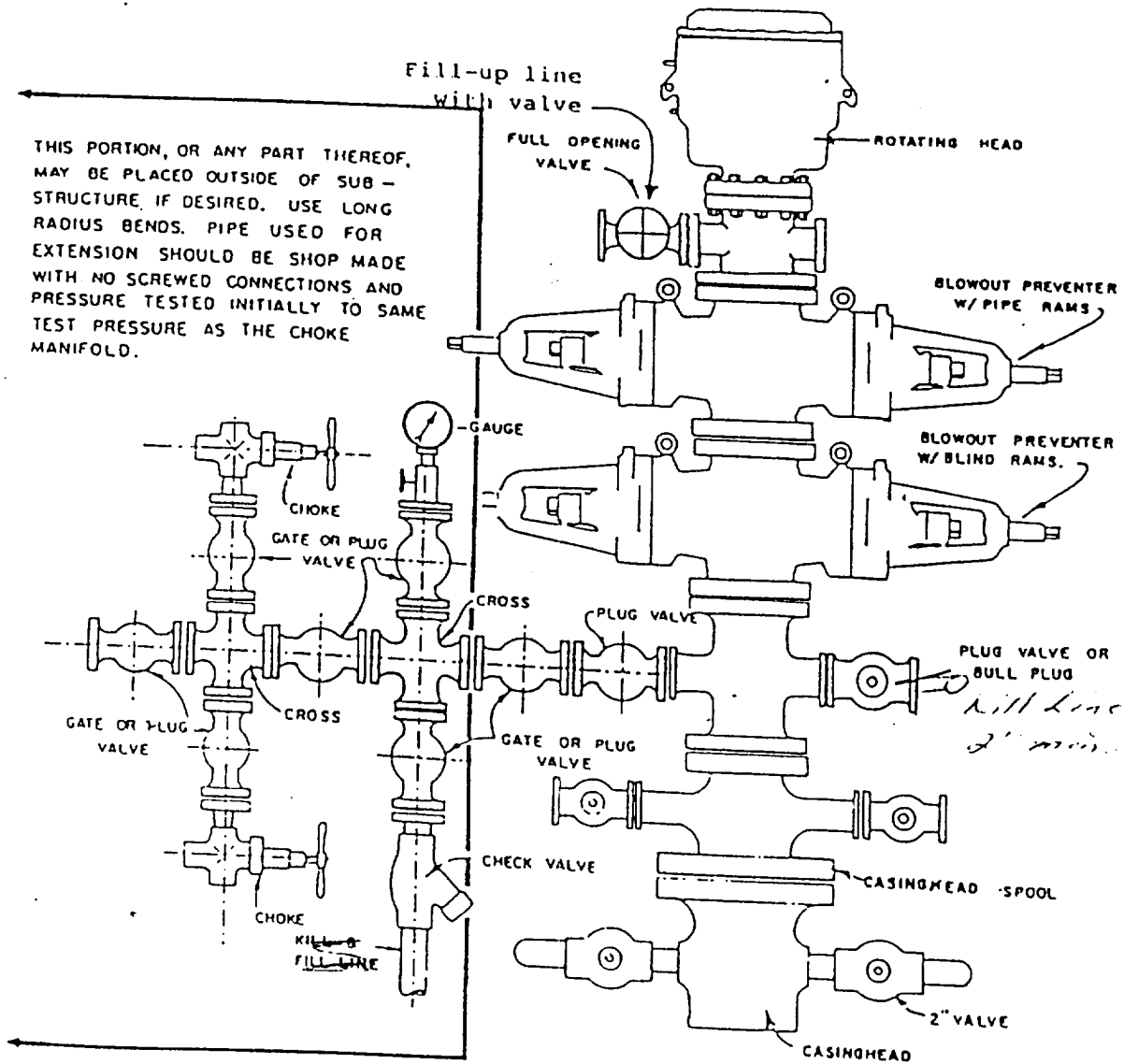

BLOWOUT PREVENTER HOOKUP