



NEW MEXICO ENERGY, MINERALS  
& NATURAL RESOURCES DEPARTMENT

OIL CONSERVATION DIVISION  
2040 South Pacheco Street  
Santa Fe, New Mexico 87505  
(505) 827-7131

April 26, 1999

RECEIVED

Burlington Resources Oil & Gas Company APR 28 1999

Telefax No. (505) 326-9833

P. O. Box 4289

Farmington, New Mexico 87499-4289 OIL CON. DIV.

Attention: Peggy Bradfield

DIST. 3

*Administrative Order NSL-927-A*

Dear Ms. Bradfield:

Reference is made to your application submitted to the New Mexico Oil Conservation Division ("Division") on April 6, 1999 for an exception to the well location requirements provided within the "Special Rules for the Blanco-Mesaverde Pool," as promulgated by New Mexico Oil Conservation Division ("Division") Order No. R-10987-A, issued in Case No. 12069 dated February 1, 1999, for a non-standard Blanco-Mesaverde infill gas well location in an existing standard 320-acre stand-up gas spacing and proration unit ("GPU") for the Blanco-Mesaverde Pool comprising the W/2 of Section 20, Township 29 North, Range 9 West, NMPM, San Juan County, New Mexico.

This GPU is currently dedicated to Burlington Resources Oil & Gas Company's:

- (i) El Paso Well No. 1 (API No. 30-045-11795), located at a standard gas well location 1600 feet from the South line and 1500 feet from the West line (Unit K) of Section 20; and
- (ii) El Paso Well No. 1-A (API No. 30-045-22778), located at an unorthodox infill gas well location (approved by Division Administrative Order NSL-927, dated February 24, 1978) 500 feet from the North line and 1800 feet from the West line (Unit C) of Section 20.

This application has been duly filed under the provisions of Division Rules 104.F and 605.B.

By the authority granted me under the provisions of Division Rule 104.F(2), the following described well to be drilled as the second infill well on this GPU at an unorthodox gas well location in Section 20 is hereby approved:

**El Paso Well No. 1-B  
2165' FNL & 440' FWL (Unit E).**

Further, all three of the aforementioned El Paso Well Nos. 1, 1-A, and 1-B and existing GPU will be subject to all existing rules, regulations, policies, and procedures applicable to prorated gas pools in Northwest, New Mexico and to the Blanco-Mesaverde Pool.

Sincerely,

A handwritten signature in black ink, appearing to read "Lori Wrotenbery / LW", with a stylized flourish at the end.

Lori Wrotenbery  
Director  
LW/MES/kv

cc: New Mexico Oil Conservation Division - Aztec /  
U. S. Bureau of Land Management - Farmington  
File: NSL-927

# BURLINGTON RESOURCES

SAN JUAN DIVISION

Sent Federal Express

Mr. Michael Stogner  
New Mexico Oil Conservation Division  
2040 South Pacheco  
Santa Fe, New Mexico 87505

RECEIVED  
APR - 6 1999  
OIL CON. DIV.  
DIST. 3

Re: El Paso #1B  
2165'FNL, 440'FWL Section 20, T-29-N, R-9-W, San Juan County  
30-045-not assigned

Dear Mr. Stogner:

Burlington Resources is applying for administrative approval of an unorthodox gas well location for the Blanco Mesaverde pool. This location is at the request of the Bureau of Land Management to avoid placing the well in Canyon Largo as shown on the topographic map. The standard windows for this well are covered in Order #10987A and are also shown on the attached topographic map. The extreme southwest corner of the standard windows is now the El Paso #3 located 2210'FNL, 620'FWL, a Pictured Cliffs well. It is intended to twin the El Paso #3 location, utilizing part of it for the proposed El Paso #1B location.

Production from the Blanco Mesa Verde pool is to be included in a standard 320 gas spacing and proration unit comprising the west half (W/2) of Section 20 and is to be dedicated to the El Paso #1A (30-045-22778) located at 500'FNL, 1800'FWL of Section 20 and the El Paso #1 (30-045-11795) located at 1600'FSL, 1500'FWL of Section 20 which was plugged and abandoned in the Mesaverde and recompleted in the Fruitland Coal in September 1989.

The following attachments are for your review:

- Application for Permit to Drill.
- Completed C-102 at referenced location.
- Offset operators/owners plat
- 7.5 minute topographic map

Three copies of this application are being submitted to offset operators by certified mail with a request that they furnish you with a Waiver of Objection, keep one copy for their files and return one copy to this office. We appreciate your earliest consideration of this application.

Sincerely,

  
Peggy Bradfield  
Regulatory/Compliance Administrator

xc: NMOCD - Aztec District Office  
Bureau of Land Management

## WAIVER

\_\_\_\_\_ hereby waives objection to Burlington Resources' application for a non-standard location for the El Paso #1B as proposed above.

By: \_\_\_\_\_ Date: \_\_\_\_\_

UNITED STATES  
DEPARTMENT OF THE INTERIOR  
BUREAU OF LAND MANAGEMENT

APPLICATION FOR PERMIT TO DRILL, DEEPEN, OR PLUG BACK

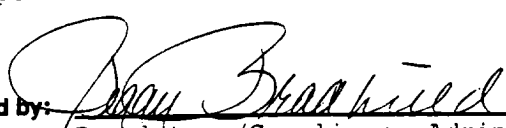
1a. Type of Work DRILL	<b>RECEIVED</b> APR - 6 1999 <b>OIL CON. DIV.</b> DIST. 3	5. Lease Number NM-0560422 Unit Reporting Number
1b. Type of Well GAS		6. If Indian, All. or Tribe
2. Operator <b>BURLINGTON RESOURCES</b> Oil & Gas Company		7. Unit Agreement Name
3. Address & Phone No. of Operator PO Box 4289, Farmington, NM 87499  (505) 326-9700		8. Farm or Lease Name El Paso 9. Well Number 1B
4. Location of Well 2165' FNL, 440' FWL  Latitude 36° 42.7, Longitude 107° 48.5		10. Field, Pool, Wildcat Blanco Mesaverde 11. Sec., Twn, Rge, Mer. (NMPM) Sec. 20, T-29-N, R-9-W API # 30-045-
14. Distance in Miles from Nearest Town 2 miles from Blanco	12. County San Juan	13. State NM
15. Distance from Proposed Location to Nearest Property or Lease Line 440'		
16. Acres in Lease		17. Acres Assigned to Well 320 W/2
18. Distance from Proposed Location to Nearest Well, Drig, Compl, or Applied for on this Lease 200'		
19. Proposed Depth 4724'		20. Rotary or Cable Tools Rotary
21. Elevations (DF, FT, GR, Etc.) 5625'		22. Approx. Date Work will Start
23. Proposed Casing and Cementing Program See Operations Plan attached		
24. Authorized by:  Regulatory/Compliance Administrator		2-1-99 Date

PERMIT NO. \_\_\_\_\_ APPROVAL DATE \_\_\_\_\_  
APPROVED BY \_\_\_\_\_ TITLE \_\_\_\_\_ DATE \_\_\_\_\_

Archaeological Report to be submitted

Threatened and Endangered Species Report to be submitted

NOTE: This format is issued in lieu of U.S. BLM Form 3160-3

Title 18 U.S.C. Section 1001, makes it a crime for any person knowingly and willfully to make to any department or agency of the United States any false, fictitious or fraudulent statements or presentations as to any matter within its jurisdiction.

District I  
PO Box 1980, Hobbs, NM 88241-1980

District II  
PO Drawer 00, Artesia, NM 88211-0719

District III  
1000 Rio Brazos Rd., Aztec, NM 87410

District IV  
PO Box 2088, Santa Fe, NM 87504-2088

State of New Mexico  
Energy, Minerals & Natural Resources Department

OIL CONSERVATION DIVISION  
PO Box 2088  
Santa Fe, NM 87504-2088

Form  
Revised February 2  
Instructions C  
Submit to Appropriate District  
State Lease - 4  
Fee Lease - 3

☐ AMENDED RE

WELL LOCATION AND ACREAGE DEDICATION PLAT

1 API Number 30-039-		2 Pool Code 72319		3 Pool Name Blanco Mesaverde	
4 Property Code		5 Property Name EL PASO			6 Well Number 18
7 OGRID No. 14538		8 Operator Name BURLINGTON RESOURCES OIL & GAS COMPANY			9 Elevation 5625

10 Surface Location

UL or lot no.	Section	Township	Range	Lot Idn	Feet from the	North/South line	Feet from the	East/West line	Co.
E	20	29N	9W		2165	NORTH	440	WEST	SAN

11 Bottom Hole Location If Different From Surface

UL or lot no.	Section	Township	Range	Lot Idn	Feet from the	North/South line	Feet from the	East/West line	Co.

12 Dedicated Acres W/320	13 Joint or Infill	14 Consolidation Code	15 Order No.
-----------------------------	--------------------	-----------------------	--------------

NO ALLOWABLE WILL BE ASSIGNED TO THIS COMPLETION UNTIL ALL INTERESTS HAVE BEEN CONSOLIDATED OR A NON-STANDARD UNIT HAS BEEN APPROVED BY THE DIVISION

	17 OPERATOR CERTIFICATION I hereby certify that the information contained is true and complete to the best of my knowledge.   Signature Peggy Bradfield Printed Name Regulatory Administrator Title 2-1-99 Date
	18 SURVEYOR CERTIFICATION I hereby certify that the well location shown was plotted from field notes of actual surveys or under my supervision, and that the same is correct to the best of my belief.  DECEMBER 9, 1998 Date of Survey  Signature and Seal of Neale C. Edwards NEALE C. EDWARDS NEW MEXICO 6857 Certificate

## OPERATIONS PLAN

Well Name: El Paso #1B  
Surface Location: 2165' FNL, 440' FWL, Section 20, T-29-N, R-9-W  
San Juan County, New Mexico  
Latitude 36° 42.7, Longitude 107° 48.5

Formation: Blanco Mesa Verde  
Elevation: 5625' GL

<u>Formation Tops:</u>	<u>Top</u>	<u>Bottom</u>	<u>Contents</u>
Surface	San Jose	808'	aquifer
Ojo Alamo	808'	1014'	aquifer
Kirtland	1014'	1526'	gas
Fruitland	1526'	2025'	gas
Pictured Cliffs	2025'	2182'	gas
Lewis	2182'	2724'	gas
Intermediate TD	2282'	-	
Mesa Verde	2724'	3021'	gas
Chacra	3021'	3725'	gas
Massive Cliff House	3725'	3797'	gas
Menefee	3797'	4324'	gas
Point Lookout	4324'		gas
Total Depth	4724'		

### Logging Program:

Cased hole logging - Gamma Ray, Cement bond from surface to TD  
Mud Logs/Coring/DST - none

### Mud Program:

<u>Interval- MD</u>	<u>Type</u>	<u>Weight</u>	<u>Vis.</u>	<u>Fluid Loss</u>
0- 300'	Spud	8.4-9.0	40-50	no control
300- 2282'	LSND	8.4-9.0	30-60	no control
2282- 4724'	Air/Mist	n/a	n/a	n/a

Pit levels will be visually monitored to detect gain or loss of fluid control.

### Casing Program (as listed, the equivalent, or better):

<u>Hole Size</u>	<u>Measured Depth</u>	<u>Csg Size</u>	<u>Weight</u>	<u>Grade</u>
12 1/4"	0' - 300'	9 5/8"	32.3#	H-40
8 3/4"	0' - 2282'	7"	20.0#	J-55
6 1/4"	2182' - 4724'	4 1/2"	10.5#	J-55

Tubing Program: 0' - 4724' 2 3/8" 4.7# J-55

### BOP Specifications, Wellhead and Tests:

Surface to Intermediate TD -

11" 2000 psi minimum double gate BOP stack (Reference Figure #1).  
After nipple-up prior to drilling out surface casing, rams and casing will be tested to 600 psi for 30 minutes.

BOP Specifications, Wellhead and Tests (cont'd):

**Intermediate TD to Total Depth -**

11" 2000 psi minimum double gate BOP stack (Reference Figure #1). After nipple-up prior to drilling out intermediate casing, rams and casing will be tested to 1500 psi for 30 minutes.

**Surface to Total Depth -**

2" nominal, 2000 psi minimum choke manifold (Reference Figure #3).

**Completion Operations -**

7 1/16" 2000 psi double gate BOP stack (Reference Figure #2). After nipple-up prior to completion, pipe rams, casing and liner top will be tested to 2000 psi for 15 minutes.

**Wellhead -**

9 5/8" x 7" x 2 3/8" x 2000 psi tree assembly.

**General -**

- Pipe rams will be actuated once each day and blind rams will be actuated once each trip to test proper functioning.
- An upper kelly cock valve with handle available and drill string valves to fit each drill string will be available on the rig floors at all times.
- BOP pit level drill will be conducted weekly for each drill crew.
- All BOP tests & drills will be recorded in daily drilling reports.
- Blind and pipe rams will be equipped with extension hand wheels.

**Cementing:**

9 5/8" surface casing - cement with 239 sx Class "B" cement with 1/4# flocele/sx and 3% calcium chloride (282 cu.ft. of slurry, 200% excess to circulate to surface). WOC 8 hrs. Test casing to 600 psi for 30 minutes.

Saw tooth guide shoe on bottom. Bowspring centralizers will be run in accordance with Onshore Order #2.

**7" intermediate casing -**

Lead w/195 sx Class "B" w/3% sodium metasilicate, 5# gilsonite/sx, 2% gel and 0.5# flocele/sx. Tail w/85 sx 50/50 Class "B" Poz w/2% calcium chloride, 5# gilsonite/sx and 0.5# flocele/sx (686 cu.ft. of slurry, 100% excess to circulate to surface.) WOC minimum of 8 hours before drilling out intermediate casing. If cement does not circulate to surface, a CBL will be run to determine TOC. Test casing to 1500 psi for 30 minutes.

7" intermediate casing alternative two stage: Stage collar at 1450'. First stage: cement with 53 sx Class "B" cmt with 7 pps gilsonite, 1/2 pps cellophane, 3% sodium metasilicate. Tailed w/68 sx Class "B" 50/50 poz w/2% gel, 7 pps Gilsonite, 2% calcium chloride, 0.5 pps Cellophane. Second stage: 150 sx Class "B" with 3% sodium metasilicate, 1/2 pps Cellophane, 7 pps Gilsonite (686 cu.ft., 100% excess to circulate to surface).

Cement nose guide shoe on bottom with float collar spaced on top of shoe joint. Bowspring centralizers spaced every other joint off bottom, to the base of the Ojo Alamo at 1014'. Two turbolating centralizers at the base of the Ojo Alamo at 1014'. Bowspring centralizers spaced every fourth joint from the base of the Ojo Alamo to the base of the surface casing.

## 4 1/2" Production Liner -

Cement to circulate liner top. Pump 297 sx 50/50 Class "B" Poz w/1/4# flocele/sx, 2% gel, 0.1% retardant, 5# gilsonite/sx and 0.4% fluid loss additive (391 cu.ft., 50% excess to circulate liner top). WOC a minimum of 18 hrs prior to completing.

Cement nose guide shoe on bottom with float collar spaced on top of shoe joint. The liner hanger will have a rubber packoff.

- If hole conditions permit, an adequate water spacer will be pumped ahead of each cement job to prevent cement/ mud contamination or cement hydration.

**Special Drilling Operations (Air/Mist Drilling):**

The following equipment will be operational while gas/mist drilling:

- An anchored blooie line will be utilized to discharge all cuttings and circulating medium to the blow pit a minimum of 100' from the wellhead.
- The blooie line will be equipped with an automatic igniter or pilot light.
- Compressors will be located a minimum of 100' from the wellhead in the opposite direction from the blooie line.
- Engines will have spark arresters or water cooled exhaust.
- The rotating head will be properly lubricated and maintained.
- A float valve will be utilized above the bit.
- Mud circulating equipment, water, and mud materials will be sufficient to maintain control of the well.

**Additional Information:**

- The Mesa Verde formation will be completed.
- No abnormal temperatures or hazards are anticipated.
- Anticipated pore pressures are as follows:

Fruitland Coal	800 psi
Pictured Cliffs	800 psi
Mesa Verde	700 psi
- Sufficient LCM will be added to the mud system to maintain well control, if lost circulation is encountered below the top of the Pictured Cliffs.
- The west half of Section 20 is dedicated to the Mesa Verde.
- This gas is dedicated.

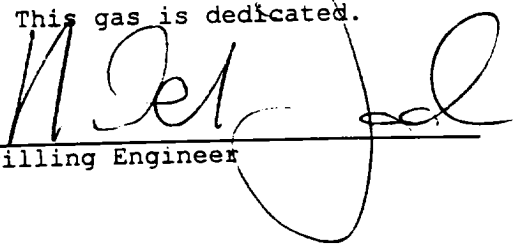
  
Drilling Engineer2/23/99  
Date



***BURLINGTON RESOURCES OIL AND GAS COMPANY***

**El Paso #1B**

**OFFSET OPERATOR/OWNER PLAT**

**Mesaverde Formation**

**Nonstandard Location**

**Township 29 North, Range 9 West**

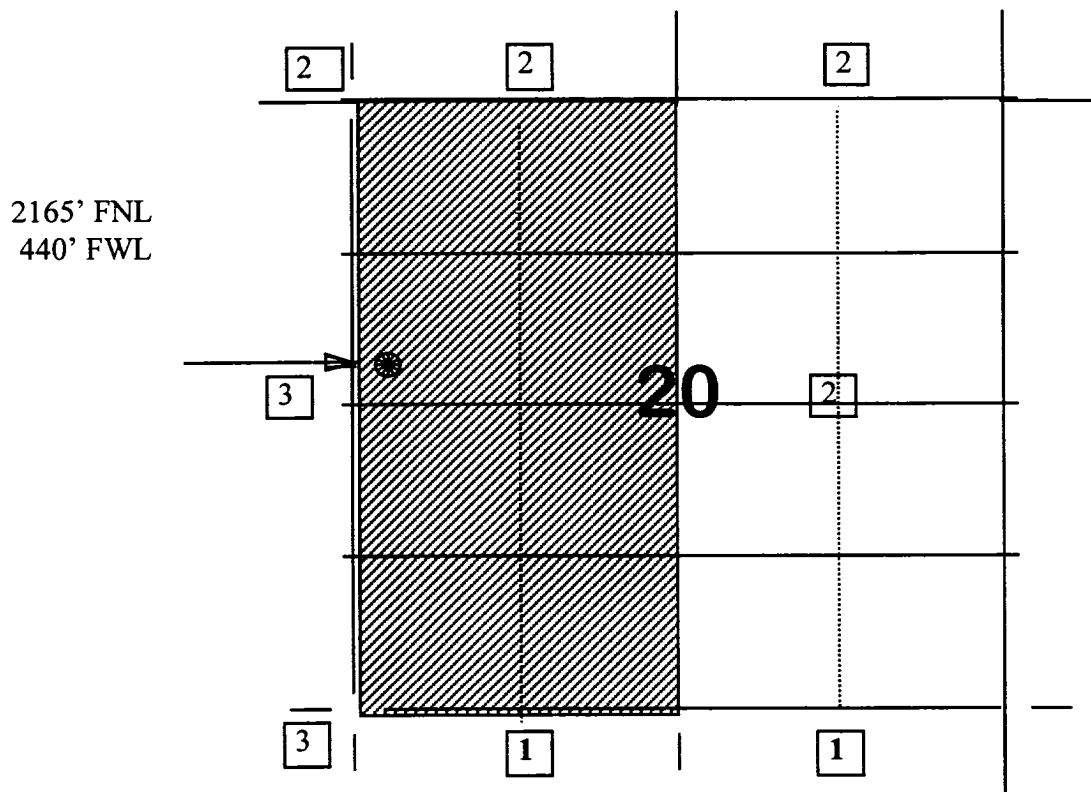

1) Burlington Resources

2) Amoco Production Company - Land Dept.  
Attn: Steve Trefz  
P.O. Box 800  
1670 Broadway  
Denver, CO 80201

3) Cross Timbers Oil Company  
Attn: Vaughn Vennerberg  
810 Houston Street, Suite 2000  
Fort Worth, TX 76102-6298

Re: El Paso #1B  
2165'FNL, 440'FWL Section 20, T-29-N, R-9-W, San Juan County  
30-045-not assigned

I hereby certify that the following offset operators/owners have been mailed notification of our application for non-standard location to drill the referenced well.

Amoco Production Company  
Att: Steve Trefz  
PO Box 800  
1670 Broadway  
Denver, CO 80201

Cross Timbers Oil Company  
6001 US Highway 64  
Bloomfield, NM 87413

A handwritten signature in cursive script, appearing to read "Peggy Bradfield".

Peggy Bradfield

