

6 - N.M.O & G
1 - W.R. Johnston
1 - File

NEW MEXICO OIL CONSERVATION COMMISSION
Santa Fe, New Mexico

NOTICE OF INTENTION TO DRILL OR RECOMPLETE

Notice must be given to the District Office of the Oil Conservation Commission and approval obtained before drilling or recompletion begins. If changes in the proposed plan are considered advisable, a copy of this notice showing such changes will be returned to the sender. Submit this notice in **QUINTUPLICATE**. One copy will be returned following approval. See additional instructions in Rules and Regulations of the Commission.

If State Land submit 6 Copies

Farmington, New Mexico
(Place)

November 8, 1955
(Date)

OIL CONSERVATION COMMISSION
SANTA FE, NEW MEXICO

Gentlemen:

You are hereby notified that it is our intention to commence the (Drilling) (Recompletion) of a well to be known as

PACIFIC NORTHWEST PIPELINE CORPORATION
(Company or Operator)

E-347
(Lease)

Well No. 14-32

in 30-6
(Unit)

The well is

located 1650 feet from the West Section line and 990 feet from the

South line of Section 32, T. 30N, R. 6W, NMPM.

(GIVE LOCATION FROM SECTION LINE) Blanco Pool, Rio Arriba County

If State Land the Oil and Gas Lease is No. E-347

If patented land the owner is.....

Address.....

We propose to drill well with drilling equipment as follows: Rotary from 0 - 5160'

The status of plugging bond is.....

Drilling Contractor.....

We intend to complete this well in the Mesa Verde Formation formation at an approximate depth of 5100 feet.

CASING PROGRAM

We propose to use the following strings of Casing and to cement them as indicated:

Size of Hole	Size of Casing	Weight per Foot	New or Second Hand	Depth	Sacks Cement
15"	10-3/4"	32.75	New	250	125 Sx 4%
9-7/8"	7-5/8"	26.40	New	3451	150 Sx 8%
5-1/2"	6-3/4"	14	New	5160	125 Sx 2%

If changes in the above plans become advisable we will notify you immediately.

ADDITIONAL INFORMATION (If recompletion give full details of proposed plan of work.)

To frac the Menefee, Point Lookout & Cliff House separately, each w/ 40,000 gal water w/ approximately 1 1/2# sd/Gal.

320 Acres dedicated to this well.

Approved.....
Except as follows:

OIL CONSERVATION COMMISSION
By [Signature]
Title Oil and Gas Inspector Dist. #3.

Sincerely yours,
PACIFIC NORTHWEST PIPELINE CORPORATION
(Company or Operator)
By [Signature]
Position District Engineer
Send Communications regarding well to
Name 413 1/2 West Main St, Farmington, N.M.
Address Pacific Northwest Pipeline Corporation

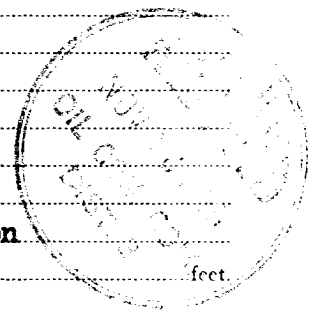

Lease Well No.

Sec. **32** , T. **30 N.** , R. **6 W., N.M.P.M.**

Location **990' FROM THE SOUTH LINE AND 1650' FROM THE WEST LINE.**

Elevation **6487.0 UNGRADED GROUND.**

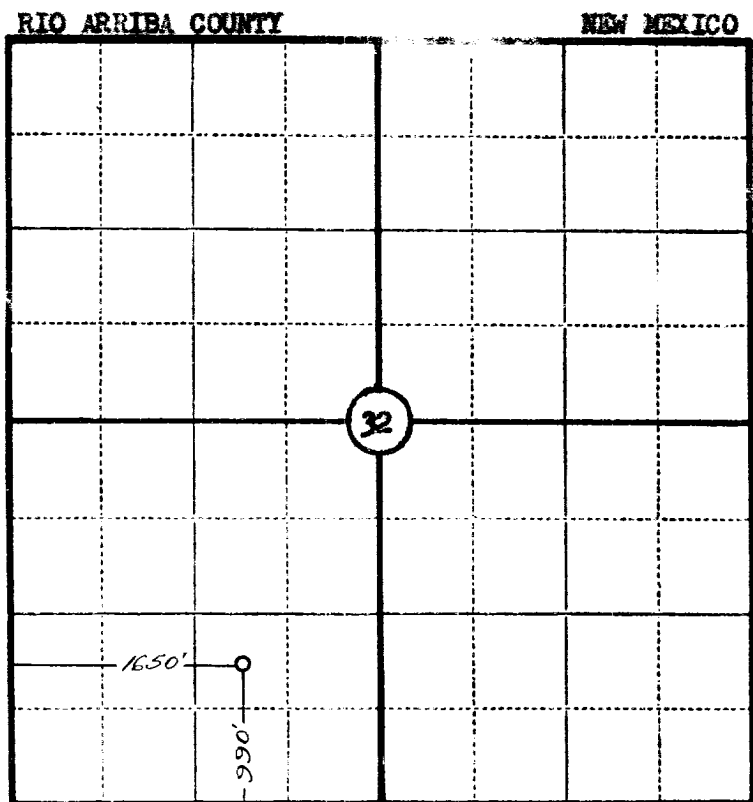

Scale—4 inches equal 1 mile.

This is to certify that the above plat was prepared from field notes of actual surveys made by me or under my supervision and that the same are true and correct to the best of my knowledge and belief.

James P. Lese
.....
Registered Land Surveyor.

Seal:

James P. Lese
N. Mex. Reg. No. 1463

Surveyed **7 July** 19 **55**

SAN JUAN ENGINEERING COMPANY, FARMINGTON, N. M.

N

