



(SUBMIT IN TRIPLICATE)

UNITED STATES  
DEPARTMENT OF THE INTERIOR  
GEOLOGICAL SURVEY

Land Office New Mexico  
Lease No. 02131  
Unit Sec. 33, T-30S, R-7E, N-2E, N.

SUNDRY NOTICES AND REPORTS ON WELLS

NOTICE OF INTENTION TO DRILL.....	<input checked="" type="checkbox"/>	SUBSEQUENT REPORT OF WATER SHUT-OFF.....
NOTICE OF INTENTION TO CHANGE PLANS.....		SUBSEQUENT REPORT OF SHOOTING OR ACIDIZING.....
NOTICE OF INTENTION TO TEST WATER SHUT-OFF.....		SUBSEQUENT REPORT OF ALTERING CASING.....
NOTICE OF INTENTION TO RE-DRILL OR REPAIR WELL.....		SUBSEQUENT REPORT OF REDRILLING OR REPAIR.....
NOTICE OF INTENTION TO SHOOT OR ACIDIZE.....		SUBSEQUENT REPORT OF ABANDONMENT.....
NOTICE OF INTENTION TO PULL OR ALTER CASING.....		SUPPLEMENTARY WELL HISTORY.....
NOTICE OF INTENTION TO ABANDON WELL.....		

(INDICATE ABOVE BY CHECK MARK NATURE OF REPORT, NOTICE, OR OTHER DATA)

June 17, 19 52

Well No. 2-2 is located 1400 ft. from [N] line and 1100 ft. from [E] line of sec. 33

12; NE Section 33 (1/4 Sec. and Sec. No.) N-2E, R-7E (Twp.) N-2E (Range) N-2E (Meridian)  
Alamosa Field (Field) El Alamo (County or Subdivision) New Mexico (State or Territory)

The elevation of the derrick floor above sea level is \_\_\_\_\_ ft. To be furnished

DETAILS OF WORK

(State names of and expected depths to objective sands; show sizes, weights, and lengths of proposed casings; indicate mudding jobs, cementing points, and all other important proposed work)

The objective sands are the Cliff House and Point Lockhart. Their respective tops are expected at about 4775' and 5025'. The producing string will be 5 1/2" O. D. casing which will be cemented.

Approximate Casing Program

10-3/4" O. D. - 175' - cemented with 75 sacks  
5-1/2" O. D. - 4775' - cemented with 175 sacks

Well will be drilled with rotary tools to top of Cliff House, about 4775'. The pay sands will be drilled with rotary tools using natural gas method to a total depth of approximately 5025'. Well will then be shot with approximately 1000 quarts of Nitro Glycerine.

I understand that this plan of work must receive approval in writing by the Geological Survey before operations may be commenced.

Company SOUTHERN UNITED GAS COMPANY

Address 1104 East Building

El Paso, Texas

By Law Thompson  
Law Thompson

Title Manager, Exploration Dept.

Company Southern Union Gas Company

Lease Whitley Well No. 2-B

Sec. 33 T. 30 N., R. 7 E., N.M.P.M.

Location 1650' from the North line and 1180' from  
the East line.

Rio Arriba County

New Mexico

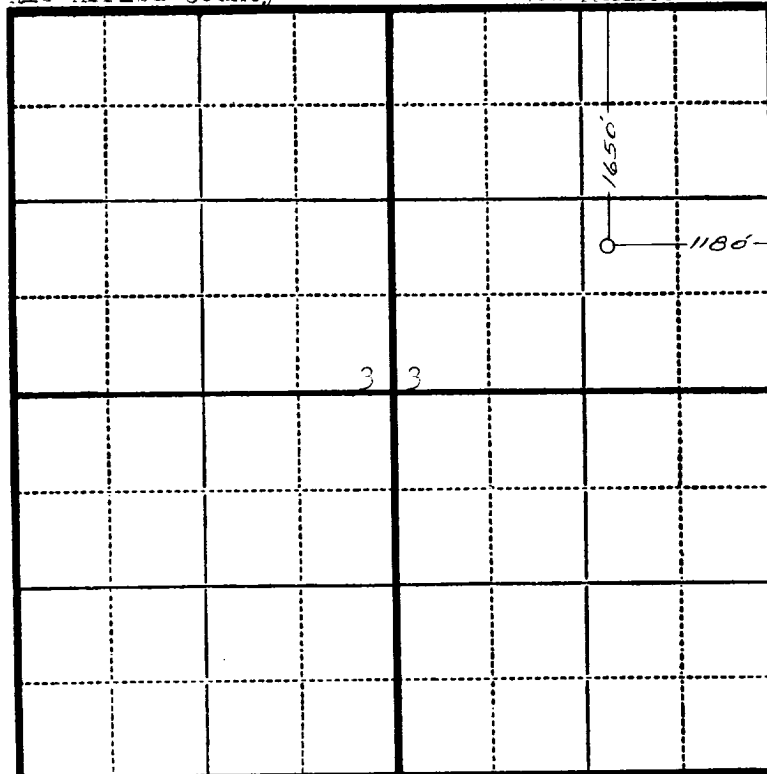

Scale—4 inches equals 1 mile.

This is to certify that the above plat was prepared from field notes of actual surveys made by me or under my supervision and that the same are true and correct to the best of my knowledge and belief.

Seal:

Registered Professional  
Engineer and Land Surveyor.

Charles J. Pinkiea  
N. Mex. Reg. No. 1302

Surveyed May 31, 19 52

