

(SUBMIT IN TRIPLICATE)

UNITED STATES  
DEPARTMENT OF THE INTERIOR  
GEOLOGICAL SURVEY

Land Office **Albuquerque, N.M.**  
Lease No. **112769**  
Unit **San Juan 10-4**  
**14-00-00-130**

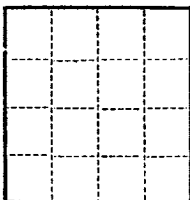

SUNDRY NOTICES AND REPORTS ON WELLS

NOTICE OF INTENTION TO DRILL.....	<input checked="" type="checkbox"/>	SUBSEQUENT REPORT OF WATER SHUT-OFF.....
NOTICE OF INTENTION TO CHANGE PLANS.....		SUBSEQUENT REPORT OF SHOOTING OR ACIDIZING.....
NOTICE OF INTENTION TO TEST WATER SHUT-OFF.....		SUBSEQUENT REPORT OF ALTERING CASING.....
NOTICE OF INTENTION TO RE-DRILL OR REPAIR WELL.....		SUBSEQUENT REPORT OF RE-DRILLING OR REPAIR.....
NOTICE OF INTENTION TO SHOOT OR ACIDIZE.....		SUBSEQUENT REPORT OF ABANDONMENT.....
NOTICE OF INTENTION TO PULL OR ALTER CASING.....		SUPPLEMENTARY WELL HISTORY.....
NOTICE OF INTENTION TO ABANDON WELL.....		

(INDICATE ABOVE BY CHECK MARK NATURE OF REPORT, NOTICE, OR OTHER DATA)

RECEIVED  
JUL 25 1955  
GEOLOGICAL SURVEY  
FARMINGTON, NEW MEXICO

July 18, 1955

Well No. **10-31** is located **990** ft. from **[N]** line and **1650** ft. from **[E]** line of sec. **31**

**10-31** (1/4 Sec. and Sec. No.) **10-31** (Twp.) **7-4** (Range) **10-31** (Meridian)

**Albuquerque** (Field) **San Juan** (County or Subdivision) **New Mexico** (State or Territory)

The elevation of the **wellhead** above sea level is **6327** ft.

DETAILS OF WORK

(State names of and expected depths to objective sands; show sizes, weights, and lengths of proposed casings; indicate mudding jobs, cementing points, and all other important proposed work)

Propose to drill to 175' and set 10-3/4" casing w/ 150 cu. 40% cement. Drill to 350' set 7-1/2" and cement w/ 200 cu. 25 gal cement. Then drill w/ gas to approximately 540, set and cement 5-1/2" casing w/ 200 cu. 25 gal cement. Following the setting of 5-1/2", drill well w/ gas to approximately total depth at 540. Sand free point located w/ 20,000 gals w/ 1/2 sand per gal, and test. Then sand free clifflines and blowers separately using 20,000 gals w/ 1/2 sand per gal, and test. Clean out well, run tubing and complete.

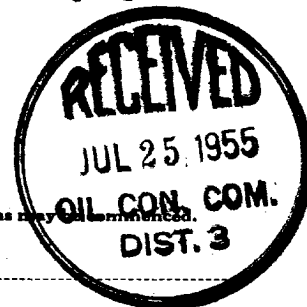

I understand that this plan of work must receive approval in writing by the Geological Survey before operations may be commenced.

Company **Pacific Northwest Pipeline Corp.**  
**413 1/2 W. Main Street**  
Address **Farmington, New Mexico**

By **2. A. Ruzan**  
Title **Engineer**

COMPANY Pacific Northwest Pipeline Corporation

Well Name & No. \_\_\_\_\_ Lease No. \_\_\_\_\_

Location 990' from the North line and 1650' from the East line.

Being in NW 1/4 NE 1/4

Sec. 31, T30 N., R. 7 W., N.M.P.M., Rio Arriba County, New Mexico.

Ground Elevation 6227, ungraded ground.

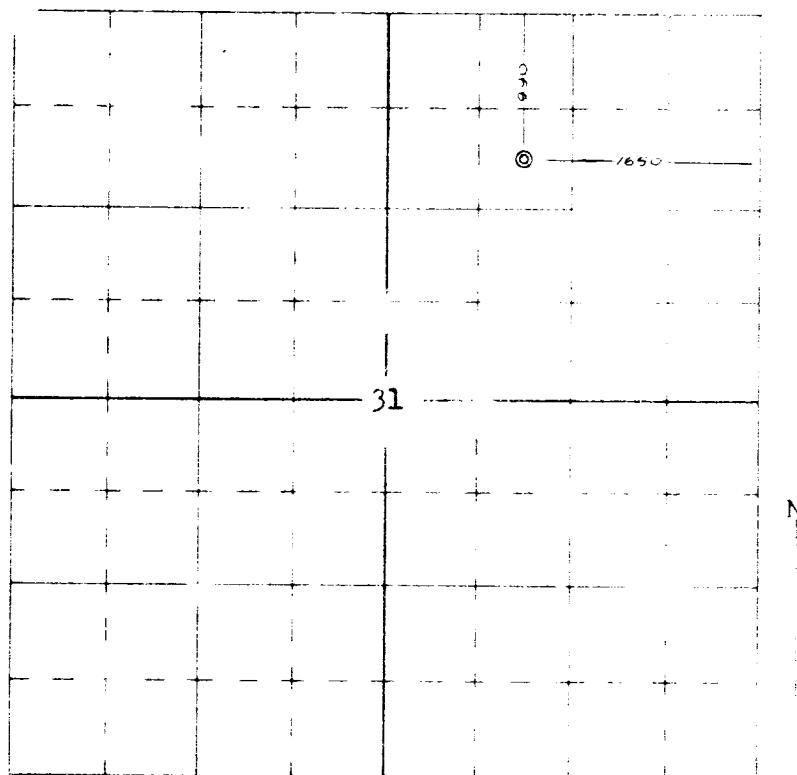

Scale -- 4 inches equals 1 mile

Surveyed June 26, 1955

This is to certify that the above plat was prepared from field notes of actual surveys made by me or under my supervision and that the same are true and correct to the best of my knowledge and belief.

Ernest V. Echohawk

Ernest V. Echohawk  
Registered Land Surveyor  
N. M. Reg. #1545

