

Form 9-381a  
(Feb. 1951)

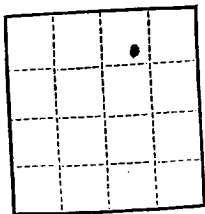

(SUBMIT IN TRIPLICATE)

UNITED STATES  
DEPARTMENT OF THE INTERIOR  
GEOLOGICAL SURVEY

Land Office Santa Fe  
Lease No. 075737  
Unit San Juan Unit 30-5

RECEIVED

APR 20 1953

SUNDRY NOTICES AND REPORTS ON WELLS

NOTICE OF INTENTION TO DRILL	<input checked="" type="checkbox"/>	SUBSEQUENT REPORT OF WATER SHUT-OFF	
NOTICE OF INTENTION TO CHANGE PLANS		SUBSEQUENT REPORT OF SHOOTING OR ACIDIZING	
NOTICE OF INTENTION TO TEST WATER SHUT-OFF		SUBSEQUENT REPORT OF ALTERING CASING	
NOTICE OF INTENTION TO RE-DRILL OR REPAIR WELL		SUBSEQUENT REPORT OF RE-DRILLING OR REPAIR	
NOTICE OF INTENTION TO SHOOT OR ACIDIZE		SUBSEQUENT REPORT OF ABANDONMENT	
NOTICE OF INTENTION TO PULL OR ALTER CASING		SUPPLEMENTARY WELL HISTORY	
NOTICE OF INTENTION TO ABANDON WELL			

(INDICATE ABOVE BY CHECK MARK NATURE OF REPORT, NOTICE, OR OTHER DATA)

Well No. 4-33 is located 900 ft. from [N] line and 1500 ft. from [E] line of sec. 33  
1/4 Sec. and Sec. No. 33 (Twp.) 30N (Range) 10E (Meridian)  
114001 (Field) 114 (County or Subdivision) New Mexico (State or Territory)

The elevation of the ground above sea level is 6725 ft.

DETAILS OF WORK

(State names of and expected depths to objective sands; show sizes, weights, and lengths of proposed casings; indicate mudding jobs, cementing points, and all other important proposed work)

Prepare to drill to approximately 5000' using mud. Set casing at top of pay.  
These sands will be drilled with gas and cleaned out with gas after shot. Rotary  
tools will be used to TD.

Proposed casing:  
at 15-3/8" casing at 150' and cement with approximately 200 sac.  
at 7" casing at top of 15" and cement with approximately 200 sac.

Location plat attached.

U.S.G.S. - - - - -  
S'ville - - - - -  
Region - - - - -  
District - - - - -

I understand that this plan of work must receive approval in writing by the Geological Survey before operations may be commenced.

Company Phillips Petroleum Company

Address P.O. Box 932

Alamos, New Mexico

By Earl Sturges

Title District Superintendent

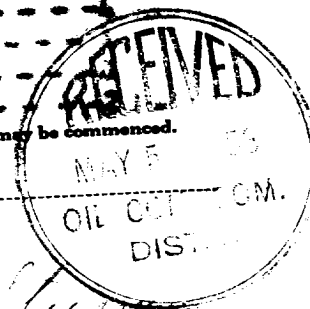

Company...Phillips Petroleum Company.....

Lease.....Well No.....

Sec.....35....., T.....30 N....., R.....5 W., N.M.P.M.....

Location...990' from the North line and 1500' from the East line.

Elevation.....6925.5 Ungraded ground.

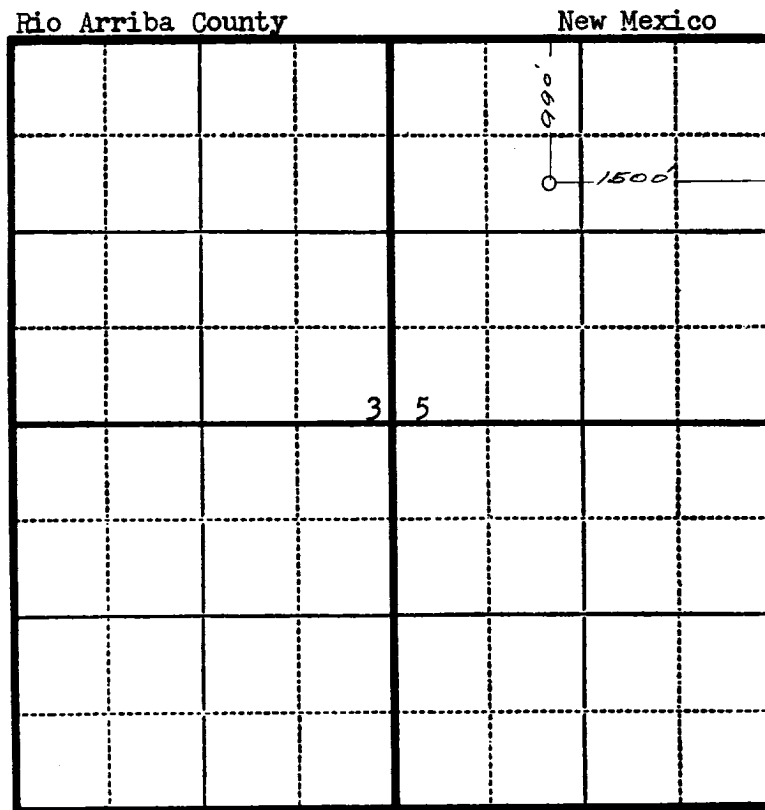

Scale—4 inches equal 1 mile.

This is to certify that the above plat was prepared from field notes of actual surveys made by me or under my supervision and that the same are true and correct to the best of my knowledge and belief.

*Charles J. Finkler*

Seal:

Registered Professional  
Engineer and Land Surveyor.

Charles J. Finkler  
N. Mex. Reg. No. 1302

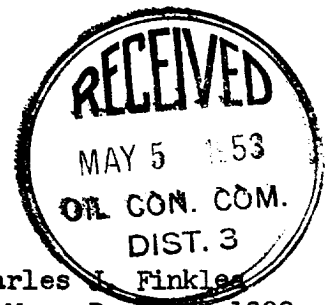

Surveyed .....September 25....., 19...52