

**COPY**

(SUBMIT IN TRIPLICATE)

UNITED STATES  
DEPARTMENT OF THE INTERIOR  
GEOLOGICAL SURVEYBudget Bureau No. 42-R-350.3.  
Approval expires 12-31-55.Indian Agency DulceJicarilla Apache

Allottee

Lease No. Jicarilla Tribal  
257

## SUNDRY NOTICES AND REPORTS ON WELLS

NOTICE OF INTENTION TO DRILL	<input checked="" type="checkbox"/>	SUBSEQUENT REPORT OF WATER SHUT-OFF	
NOTICE OF INTENTION TO CHANGE PLANS		SUBSEQUENT REPORT OF SHOOTING OR ACIDIZING	
NOTICE OF INTENTION TO TEST WATER SHUT-OFF		SUBSEQUENT REPORT OF ALTERING CASING	
NOTICE OF INTENTION TO REDRILL OR REPAIR WELL		SUBSEQUENT REPORT OF REDRILLING OR REPAIR	
NOTICE OF INTENTION TO SHOOT OR ACIDIZE		SUBSEQUENT REPORT OF ABANDONMENT	
NOTICE OF INTENTION TO PULL OR ALTER CASING		SUPPLEMENTARY WELL HISTORY	
NOTICE OF INTENTION TO ABANDON WELL			

(INDICATE ABOVE BY CHECK MARK NATURE OF REPORT, NOTICE, OR OTHER DATA)

March 17, 1964

Jicarilla Tribal

Well No. 1 is located 790 ft. from N line and 790 ft. from E line of sec. 34NW 1/4 Sec. 34  
(1/4 Sec. and Sec. No.)30N  
(Twp.)3W  
(Range)N.M.P.M.  
(Meridian)Wildcat  
(Field)Rio Arriba  
(County or Subdivision)New Mexico  
(State or Territory)The elevation of the ~~derrick floor~~ <sup>ground</sup> above sea level is 7114 ft.

## DETAILS OF WORK

(State names of and expected depths to objective sands; show sizes, weights, and lengths of proposed casings; indicate mudding jobs, cementing points, and all other important proposed work)

It is proposed to: drill with mud to approximately 3900', into Lewis and drill with air or mud to 8300', into Morrison formation. 10 3/4" OD, 32.75# surface casing will be set at 200' and cemented to surface of ground. 7 5/8" OD, 24# intermediate casing will be set at approximately 3900' and cemented 200' above shoe. If productive, 4 1/2" OD, 11.6#, liner will run with packer liner hanger 150' into 7 5/8" OD, and cemented 500' above uppermost producing zone. A mud logger will be in use from 2000' to T.D. and shows will be evaluated by DST. I-E log and Gamma Ray - Sonic logs will be run in mud and Gamma Ray - Induction and Formation Density logs will be run in air.

I understand that this plan of work must receive approval in writing by the Geological Survey before operations may be commenced.

Company SUNRAY OX OIL COMPANYAddress 101 University Blvd.Denver, ColoradoBy F. S. GoddardTitle District Manager

## NEW MEXICO OIL CONSERVATION COMMISSION

## Well Location and Acreage Dedication Plat

March 17, 1964

## Section A.

Date

JICARILLA TRINAL

Operator SUNRAY OIL COMPANY Lease \_\_\_\_\_  
 Well No. \_\_\_\_\_ Unit Letter D Section 34 Township 30 NORTH Range 3 WEST, NMPM  
 Located 790 Feet From the NORTH Line, 790 Feet From the WEST Line  
 County RIO ARriba G. L. Elevation 7114.0 Dedicated Acreage without Acres  
 Name of Producing Formation \_\_\_\_\_ Pool \_\_\_\_\_

1. Is the operator the only owner in the dedicated acreage outlined on the plat below?  
 Yes \_\_\_\_\_ No \_\_\_\_\_

2. If the answer to question one is "no", have the interests of all the owners been consolidated by communitization agreement or otherwise? Yes \_\_\_\_\_ No \_\_\_\_\_. If answer is "yes", Type of Consolidation.

3. If the answer to question two is "no", list all the owners and their respective interests below:

Owner

Land Description

RECEIVED

MAR 20 1964

OIL CON. COM.  
DIST. 3

## Section B.

This is to certify that the information in Section A above is true and complete to the best of my knowledge and belief.

SUNRAY OIL COMPANY

(Operator)

(Representative)

101 University Blvd.

(Address)

Denver, Colorado

Note: All distances must be from outer boundaries of section.

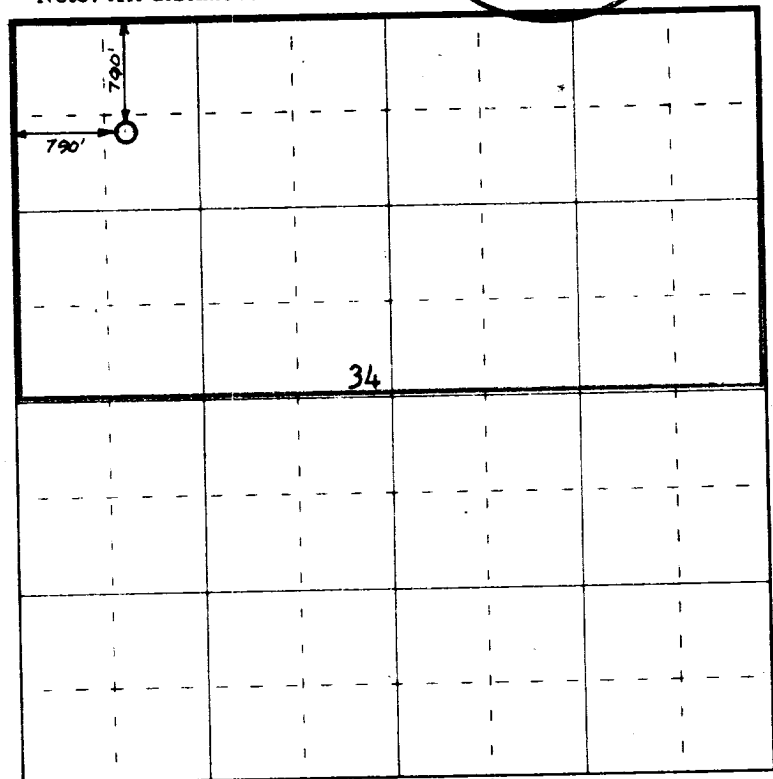

0 330 660 990 1320 1650 1980 2310 2640 2000 1500 1000 500 0

Scale 4 inches equal 1 mile

N

Ref: GLO plat dated April 10, 1895



(Seal)

Farmington, New Mexico

This is to certify that the above plat was prepared from field notes of actual surveys made by me or under my supervision and that the same are true and correct to the best of my knowledge and belief.

Date Surveyed 15 March 1964

James P. Leese  
 Registered Professional Engineer and/or Land Surveyor  
 James P. Leese  
 New Mexico Reg. No. 1463