

3 - U.S.G.S.  
1 - W.A. Johnston  
1 - File

(SUBMIT IN TRIPLICATE)

UNITED STATES  
DEPARTMENT OF THE INTERIOR  
GEOLOGICAL SURVEY

Budget Bureau 42-R358.3  
Approval expires 12-31-55.

Land Office SANTA FE  
Lease No. 077933 NM 012709  
S.J. 30-6  
Unit \_\_\_\_\_  
114-08-002-338

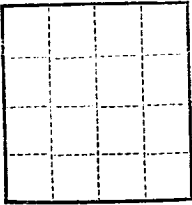

SUNDRY NOTICES AND REPORTS ON WELLS

NOTICE OF INTENTION TO DRILL.....	<input checked="" type="checkbox"/>	SUBSEQUENT REPORT OF WATER SHUT-OFF.....	
NOTICE OF INTENTION TO CHANGE PLANS.....		SUBSEQUENT REPORT OF SHOOTING OR ACIDIZING.....	
NOTICE OF INTENTION TO TEST WATER SHUT-OFF.....		SUBSEQUENT REPORT OF ALTERING CASING.....	
NOTICE OF INTENTION TO RE-DRILL OR REPAIR WELL.....		SUBSEQUENT REPORT OF RE-DRILLING OR REPAIR.....	
NOTICE OF INTENTION TO SHOOT OR ACIDIZE.....		SUBSEQUENT REPORT OF ABANDONMENT.....	
NOTICE OF INTENTION TO PULL OR ALTER CASING.....		SUPPLEMENTARY WELL HISTORY.....	
NOTICE OF INTENTION TO ABANDON WELL.....			

(INDICATE ABOVE BY CHECK MARK NATURE OF REPORT, NOTICE, OR OTHER DATA)

October 12, 1955

Well No. 15-29 is located 1700 ft. from S line and 900 ft. from W line of sec. 29  
N1/4 E1/4 30 N 7W R.1.P.M.  
(1/4 Sec. and Sec. No.) (Twp.) (Range) (Meridian)  
Hiwassee Rio Arriba New Mexico  
(Field) (County or Subdivision) (State or Territory)



The elevation of the ~~derreck~~ drill floor above sea level is 5289.75 ft.

DETAILS OF WORK

(State names of and expected depths to objective sands; show sizes, weights, and lengths of proposed casings; indicate mudding jobs, cementing points, and all other important proposed work)

Propose to drill 15" hole to 175' set 175' of 10-3/4" casing, cemented w/ 150 cu. ft. gal. Then drill with water or minimum mud to 322' & set 7-1/8" C.S. casing cemented with 100 cu. ft. gal & 50 cu. reg. Then drill w/ gas to total depth of 5290' and set 3" casing w/ 150 cu. ft. gal. Sand Free Point Leak Out w/ 40,000 gal water w/ 1/2" oil/gal. Free Hiwassee w/ 40,000 gal water w/ 1/2" oil/gal & Free, Cliff Hiwassee w/ 40,000 gal water w/ 1/2" oil/gal. Clean to Total Depth, run tubing & complete well.

I understand that this plan of work must receive approval in writing by the Geological Survey before operations may be commenced.

Company PACIFIC NORTHWEST PIPELINE CORPORATION  
 Address 413 1/2 West Main Street  
Farmington, New Mexico  
 By J. A. Neuman  
 Title District Engineer

Company..... **PACIFIC NORTHWEST PIPELINE CORPORATION**

Lease..... Well No.....

Sec. **29**, T. **30 N.**, R. **7 W., N.M.P.M.**

Location..... **1700' FROM THE SOUTH LINE AND 900' FROM THE WEST LINE.**

Elevation..... **6289.58 UNGRADED GROUND.**

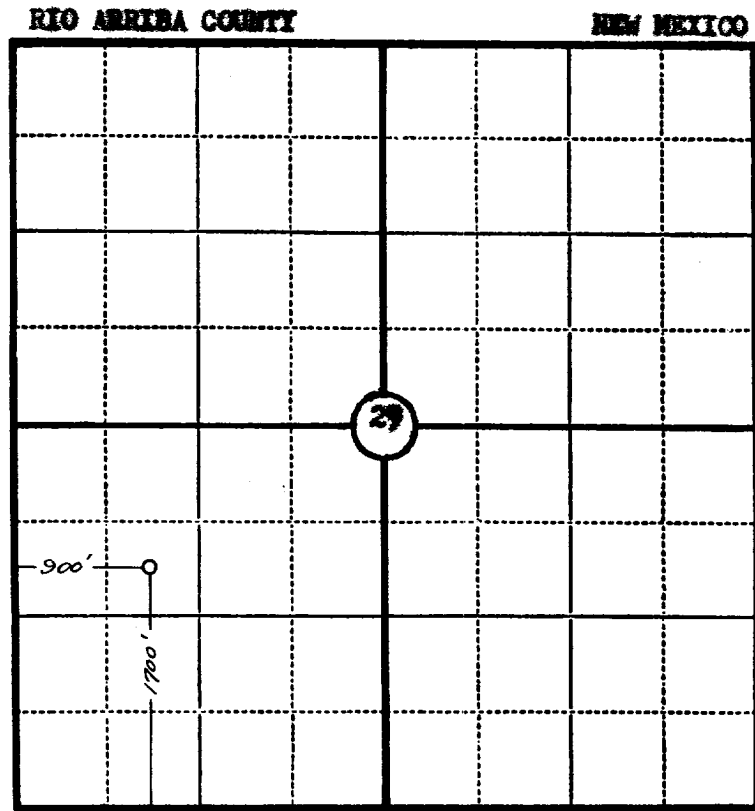

This is to certify that the above plat was prepared from field notes of actual surveys made by me or under my supervision and that the same are true and correct to the best of my knowledge and belief.

Seal: *James P. Lease*  
Registered Land Surveyor.  
**James P. Lease**  
**N. Mex. Reg. No. 1463**

Surveyed ..... **21 September** ..... 19**55**