

1- (SUBMIT IN TRIPLICATE)  
1- Mr. J. Johnston  
1- File UNITED STATES  
2- 51 DEPARTMENT OF THE INTERIOR  
7- GEOLOGICAL SURVEY

Land Office Santa Fe  
Lease No. 078742  
Unit 30-6  
# 14-00-001-538

## SUNDRY NOTICES AND REPORTS ON WELLS

NOTICE OF INTENTION TO DRILL	1	SUBSEQUENT REPORT OF WATER SHUT-OFF
NOTICE OF INTENTION TO CHANGE PLANS		SUBSEQUENT REPORT OF SHOOTING OR ACIDIZING
NOTICE OF INTENTION TO TEST WATER SHUT-OFF		SUBSEQUENT REPORT OF ALTERING CASING
NOTICE OF INTENTION TO RE-DRILL OR REPAIR WELL		SUBSEQUENT REPORT OF RE-DRILLING OR REPAIR
NOTICE OF INTENTION TO SHOOT OR ACIDIZE		SUBSEQUENT REPORT OF ABANDONMENT
NOTICE OF INTENTION TO PULL OR ALTER CASING		SUPPLEMENTARY WELL HISTORY
NOTICE OF INTENTION TO ABANDON WELL		

(INDICATE ABOVE BY CHECK MARK NATURE OF REPORT, NOTICE, OR OTHER DATA)

## RESULTS

March 7, 1954

Well No. 1000 is located 100 ft. from [N] line and 100 ft. from [E] line of sec. 4.

14 Sec. and Sec. No.      30 4      4 1      177E  
 -----  
 (Twp.)      (Range)      (Meridian)

Place Name for a \_\_\_\_\_ to arrive \_\_\_\_\_  
(Field) (County or Subdivision) (State or Territory)

The elevation of the ~~derrick floor~~ above sea level is 6233 ft.

## DETAILS OF WORK

(State names of and expected depths to objective sands; show sizes, weights, and lengths of proposed casings; indicate mudlogging jobs, cementing points, and all other important proposed work)

Drill to 172' Set 10 3/4" csg. cased w/150 ex 24 gal. Drill w/minor cement  
or water to 172' Set 7 1/8" csg. cased. w/150 ex 24 gal. and 20 ex mast. Drill w/gas  
to 170 (Total depth) Set 3 1/2" csg. cased. w/175 ex 24 gal. Perforate and water  
free the Cliff House, manatee and pt lock out, separately each w/40,000 gal water. Clean  
out, run tubing and cml. well. 125 acres, 2/2 Sec 3 dedicated to this well.

**I understand that this plan of work must receive approval in writing by the Geological Survey before operations may be commenced.**

**Company** Pacific Northwest Pipeline Corporation

Address 03 1/2 . Main

Perkins, W. W.

By Original signed by T. A. Dugan

**Title** 11-11-11

1. The first part of the paper is devoted to the study of the properties of the function  $f(x)$  defined by the equation

2. The second part of the paper is devoted to the study of the properties of the function  $f(x)$  defined by the equation

3. The third part of the paper is devoted to the study of the properties of the function  $f(x)$  defined by the equation

4. The fourth part of the paper is devoted to the study of the properties of the function  $f(x)$  defined by the equation

5. The fifth part of the paper is devoted to the study of the properties of the function  $f(x)$  defined by the equation

6. The sixth part of the paper is devoted to the study of the properties of the function  $f(x)$  defined by the equation

7. The seventh part of the paper is devoted to the study of the properties of the function  $f(x)$  defined by the equation

8. The eighth part of the paper is devoted to the study of the properties of the function  $f(x)$  defined by the equation

9. The ninth part of the paper is devoted to the study of the properties of the function  $f(x)$  defined by the equation

10. The tenth part of the paper is devoted to the study of the properties of the function  $f(x)$  defined by the equation

NEW MEXICO  
OIL CONSERVATION COMMISSION

Form C-128

Well Location and/or Gas Proration Plat

Date March 7, 1956

Operator Pacific Northwest Pipeline Corporation Lease San Juan Unit 30-6

Well No. 16-26 Section 26 Township 30 North Range 6 West NMPM

Located 1680 Feet From North Line, 1070 Feet From East Line,

Rio Arriba County, New Mexico. G. L. Elevation 6733, ungraded.

Name of Producing Formation Near Verde Pool Alamosa Dedicated Acreage 320

(Note: All distances must be from outer boundaries of Section)

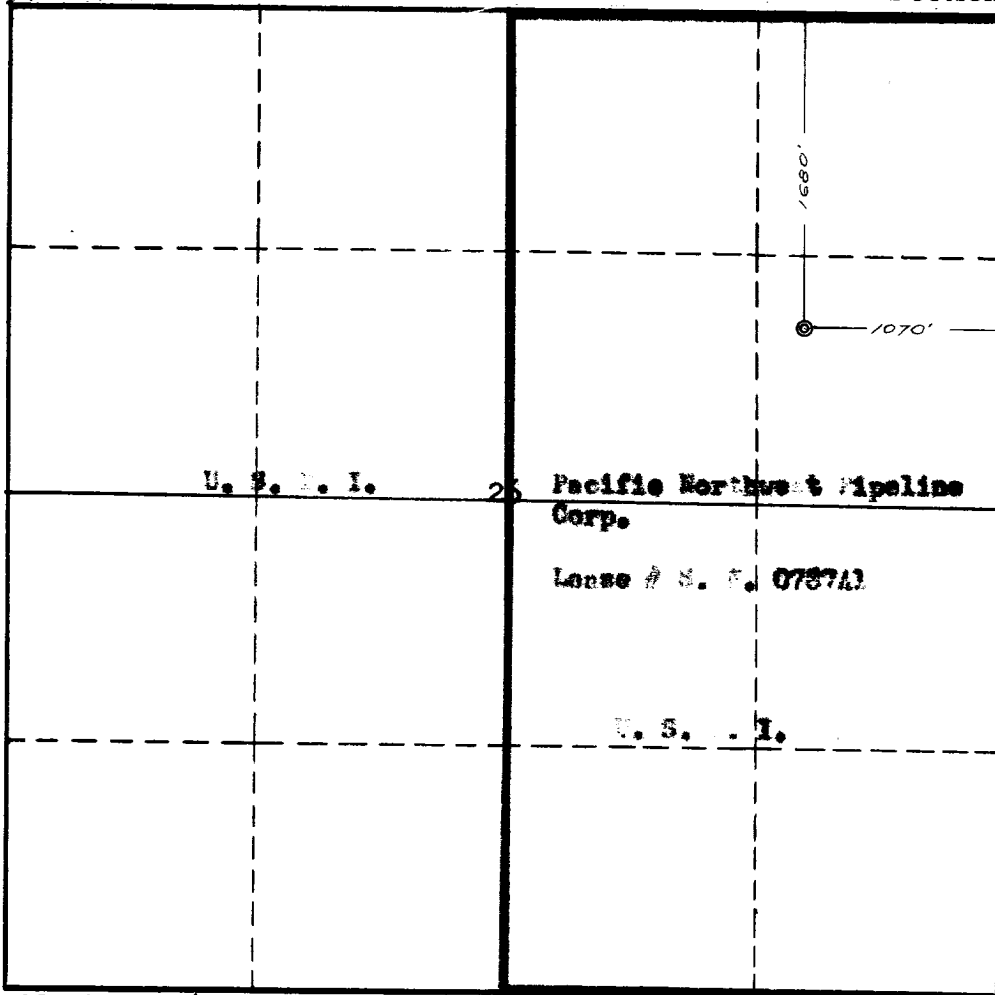

SCALE: 1"=1000'

1. Is this Well a Dual Comp. ? Yes     No X
2. If the answer to Question 1 is yes, are there any other dually completed wells within the dedicated acreage? Yes     No

This is to certify that the above plat was prepared from field notes of actual surveys made by me or under my supervision and that the same are true and correct to the best of my knowledge and belief.

Name Original signed by T. A. Dugan  
Position District Engineer  
Representing Pacific Northwest Pipeline Corp.  
Address 131 W. Main, Farmington, New Mexico

Date Surveyed February 10, 1956  
Ernest J. Cochran  
Registered Professional Engineer and/or  
Land Surveyor **FOUR STATES OIL FIELD SURVEYS**  
**FARMINGTON, NEW MEXICO**

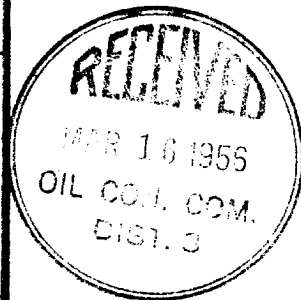



COPY TO O.G.C.

UNITED STATES  
DEPARTMENT OF THE INTERIOR  
GEOLOGICAL SURVEY  
P. O. Box 965  
Farmington, New Mexico

IN REPLY REFER TO:

March 10, 1956

Pacific Northwest Pipeline Corporation  
413 1/2 West Main  
Farmington, New Mexico

Re: Santa Fe 078741  
14-08-001-538

Gentlemen:

Receipt is acknowledged of your "Notice of Intention to Drill" dated March 7, 1956 covering your well No. 16-26 San Juan 30-6 Unit in NE 1/4 sec. 26, T. 30 N., R. 6 W., N. M. P. M., Rio Arriba County, New Mexico, Blanco Mesa Verde pool.

Your proposed work is hereby approved subject to compliance with the provisions of the "Oil and Gas Operating Regulations" revised May 25, 1942, a copy of which will be sent to you on request, and subject to the following conditions:

1. Drilling operations so authorized are subject to the attached sheet for general conditions of approval.
2. Furnish copies of all logs.

Very truly yours,

(Orig. Sgd.) J. W. Long

Jerry W. Long  
Acting District Engineer

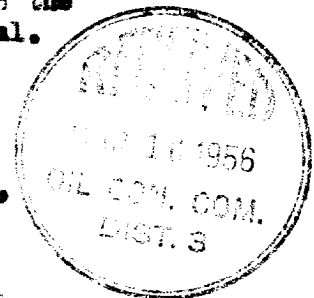

JWLong:ac

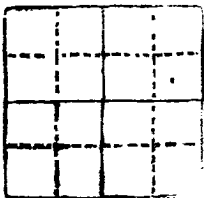

UNITED STATES  
DEPARTMENT OF THE INTERIOR  
GEOLOGICAL SURVEY

WASHINGTON, D. C.  
20508

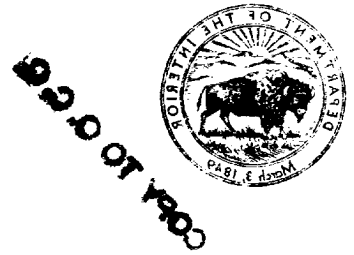

May 1, 1909

Dear Sir:

Very truly yours,

W. H. Dyer

Enclosed for you are two copies of a report of the  
Geological Survey of the United States, published by the  
Government Printing Office, Washington, D. C., 1908.  
The report is entitled "Geological Survey of the United States,  
1908, Part 1, General Report."

The report contains a general description of the geology of the  
United States, and is intended to be a general reference work  
for the public. It is published in two parts, the first part  
containing the general report, and the second part containing  
the detailed reports of the various geological surveys.

The report is published in two parts, the first part  
containing the general report, and the second part containing  
the detailed reports of the various geological surveys.

Very truly yours,

W. H. Dyer

Very truly yours,

W. H. Dyer

W. H. Dyer

