

(SUBMIT IN TRIPLICATE)

UNITED STATES  
DEPARTMENT OF THE INTERIOR  
GEOLOGICAL SURVEY

Budget Bureau No. 42-R358.4.  
Approval expires 12-31-60.

Land Office **Santa Fe**

Lease No. **080712-A**

Unit **Barron-Kidd**

**14-08-001-538**

SUNDRY NOTICES AND REPORTS ON WELLS

NOTICE OF INTENTION TO DRILL.....	<input checked="" type="checkbox"/>	SUBSEQUENT REPORT OF WATER SHUT-OFF.....
NOTICE OF INTENTION TO CHANGE PLANS.....	<input type="checkbox"/>	SUBSEQUENT REPORT OF SHOOTING OR ACIDIZING.....
NOTICE OF INTENTION TO TEST WATER SHUT-OFF.....	<input type="checkbox"/>	SUBSEQUENT REPORT OF ALTERING CASING.....
NOTICE OF INTENTION TO RE-DRILL OR REPAIR WELL.....	<input type="checkbox"/>	SUBSEQUENT REPORT OF RE-DRILLING OR REPAIR.....
NOTICE OF INTENTION TO SHOOT OR ACIDIZE.....	<input type="checkbox"/>	SUBSEQUENT REPORT OF ABANDONMENT.....
NOTICE OF INTENTION TO PULL OR ALTER CASING.....	<input type="checkbox"/>	SUPPLEMENTARY WELL HISTORY.....
NOTICE OF INTENTION TO ABANDON WELL.....	<input type="checkbox"/>	

(INDICATE ABOVE BY CHECK MARK NATURE OF REPORT, NOTICE, OR OTHER DATA)

February 10, 1958

Well No. **8** is located **1580** ft. from **[N]** line and **1150** ft. from **[E]** line of Sec. **29**  
**NE Sec. 29** (1/4 Sec. and Sec. No.) **30N** (Twp.) **6W** (Range) **N.M.P.M.** (Meridian)  
**Blanco** (Field) **Rio Arriba** (County or Subdivision) **New Mexico** (State or Territory)

The elevation of the derrick floor above sea level is **6271** ft.

DETAILS OF WORK

(State names of and expected depths to objective sands; show sizes, weights, and lengths of proposed casings; indicate mudding jobs, cementing points, and all other important proposed work)

It is intended to drill a well with rotary tools thru the Mesa Verde formation. Mud circulation will be used thru the Pictured Cliffs and set intermediate casing. Gas circulation will be used thru the Mesa Verde and production liner will be set. Possible productive intervals will be perforated and fractured. Est. T. D. 5608'.

Casing Program:

- 10 3/4" at 170' with 150 sacks cement circulated to the surface.
- 7 5/8" at 3375' with 250 sacks cement.
- 5 1/2" liner at 5608' with 300 sacks cement.

The E/2 of Section 29 is dedicated to this well.

E/2: SF 080712-A (S/2NE/4); Fee-Jose E. Gomez, et ux (N/2NE/4); Fee-Pacific Northwest (SE/4)

I understand that this plan of work must receive approval in writing by the Geological Survey before operations may be commenced.

Company **El Paso Natural Gas Company**

Address **Box 997**  
**Farmington, New Mexico**

By **Original Signed D. C. Johnston**

Title **Petroleum Engineer**

## NEW MEXICO OIL CONSERVATION COMMISSION

## Well Location and Acreage Dedication Plat

Section A.

Date **FEBRUARY 5, 1958**

Operator **EL PASO NATURAL GAS COMPANY** Lease **BARRON KIID** SF **080712-A**  
 Well No. **8** Unit Letter **H** Section **29** Township **30-N** Range **6-W** NMPM  
 Located **1580** Feet From **NORTH** Line, **1150** Feet From **EAST** Line  
 County **RIO ARriba** G. L. Elevation **6267** Dedicated Acreage **320** Acres  
 Name of Producing Formation **MESA VERDE** Pool **BLANCO**

1. Is the Operator the only owner in the dedicated acreage outlined on the plat below?  
 Yes \_\_\_\_\_ No **X**
2. If the answer to question one is "no", have the interests of all the owners been consolidated by communitization agreement or otherwise? Yes **X** No \_\_\_\_\_ If answer is "yes", Type of Consolidation, \_\_\_\_\_

**Unit Agreement**

3. If the answer to question two is "no", list all the owners and their respective interests below:

Owner

Land Description

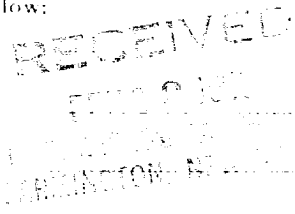
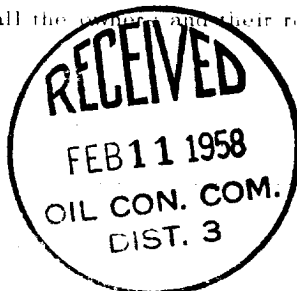

Section B.

This is to certify that the information in Section A above is true and complete to the best of my knowledge and belief.

**El Paso Natural Gas Company**

(Operator)

**Original Signed B. C. Johnston**

(Representative)

**Box 997**

(Address)

**Farmington, New Mexico**

Note: All distances must be from outer boundaries of section.

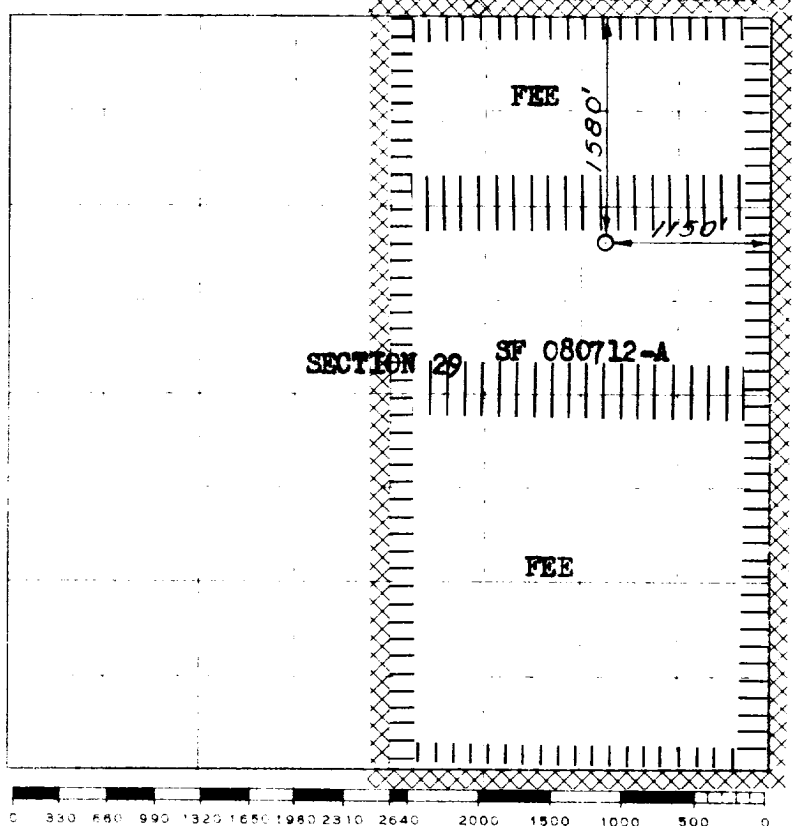

Scale 4 inches equal 1 mile

This is to certify that the above plat was prepared from field notes of actual surveys made by me or under my supervision and that the same are true and correct to the best of my knowledge and belief.

(Seal)

Date Surveyed **JANUARY 13, 1958***David O. Kilven*

Registered Professional Engineer and/or Land Surveyor

Farmington, New Mexico