

U.S.G.S. -4  
S'ville -1  
Region -1  
District -2 (SUBMIT IN TRIPLICATE)

Budget Bureau 42-R358.2  
Approval expires 12-31-52.

Land Office Santa Fe  
Lease No. 576710  
Unit San Juan Unit 30-5

UNITED STATES  
DEPARTMENT OF THE INTERIOR  
GEOLOGICAL SURVEY

SUNDRY NOTICES AND REPORTS ON WELLS

|                                                     |                                     |                                                 |  |
|-----------------------------------------------------|-------------------------------------|-------------------------------------------------|--|
| NOTICE OF INTENTION TO DRILL.....                   | <input checked="" type="checkbox"/> | SUBSEQUENT REPORT OF WATER SHUT-OFF.....        |  |
| NOTICE OF INTENTION TO CHANGE PLANS.....            |                                     | SUBSEQUENT REPORT OF SHOOTING OR ACIDIZING..... |  |
| NOTICE OF INTENTION TO TEST WATER SHUT-OFF.....     |                                     | SUBSEQUENT REPORT OF ALTERING CASING.....       |  |
| NOTICE OF INTENTION TO RE-DRILL OR REPAIR WELL..... |                                     | SUBSEQUENT REPORT OF RE-DRILLING OR REPAIR..... |  |
| NOTICE OF INTENTION TO SHOOT OR ACIDIZE.....        |                                     | SUBSEQUENT REPORT OF ABANDONMENT.....           |  |
| NOTICE OF INTENTION TO PULL OR ALTER CASING.....    |                                     | SUPPLEMENTARY WELL HISTORY.....                 |  |
| NOTICE OF INTENTION TO ABANDON WELL.....            |                                     |                                                 |  |

(INDICATE ABOVE BY CHECK MARK NATURE OF REPORT, NOTICE, OR OTHER DATA)

Well No. 30-5 is located 990 ft. from N line and 990 ft. from E line of sec. 30  
1/4 Sec. and Sec. No. 30N 2E T.1N.2.E.  
(Field) (Twp.) (Range) (Meridian)  
Alameda San Juan New Mexico  
(County or Subdivision) (State or Territory)

The elevation of the ground above sea level is 6229 ft.

DETAILS OF WORK

(State names of and expected depths to objective sands; show sizes, weights, and lengths of proposed casings; indicate mudding jobs, cementing points, and all other important proposed work)

Propose to drill to approximately 3100' using mud. Set casing thru Fruitland, perforate and hydraulics. Rotary tools will be used to TD.

Proposed Casing:

Set 10-3/4" casing at 159' cement with approximately 200 gal.

Set 7" casing thru Fruitland cement with approximately 200 gal.

Location Map attached.



I understand that this plan of work must receive approval in writing by the Geological Survey before operations may be commenced.

Company Phillips Petroleum Company  
Address P.O. Box 939  
Astec, New Mexico  
By Earl Stum  
Title District Superintendent

Company.....Phillips Petroleum Company.....

Lease.....Well No.....

Sec. 30....., T. 30 N....., R. 5 W., N.M.P.M.....

Location.....990' from the North line and 990' from  
the East line.

Elevation.....6229 Ungraded ground.....

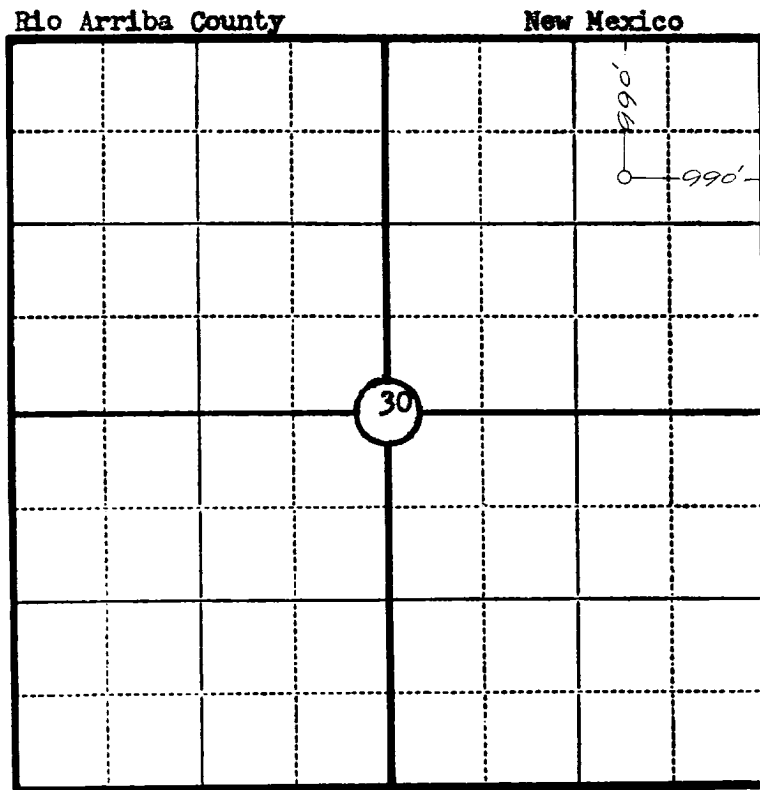

Scale—4 inches equal 1 mile.

This is to certify that the above plat was prepared from field notes of actual surveys made by me or under my supervision and that the same are true and correct to the best of my knowledge and belief.

Seal:

Registered Professional  
Engineer and Land Surveyor.

Ernest V. Echohawk  
N. Mex. Reg. No. 1545

Surveyed May 22....., 19 53.