

(SUBMIT IN TRIPLICATE)

UNITED STATES
DEPARTMENT OF THE INTERIOR
GEOLOGICAL SURVEY

Land Office Santa Fe
Lease No. 079487
Unit San Juan 30-4 Unit
14-08-001-1036

SUNDRY NOTICES AND REPORTS ON WELLS

NOTICE OF INTENTION TO DRILL	<input checked="" type="checkbox"/>	SUBSEQUENT REPORT OF WATER SHUT-OFF
NOTICE OF INTENTION TO CHANGE PLANS		SUBSEQUENT REPORT OF SHOOTING OR ACIDIZING
NOTICE OF INTENTION TO TEST WATER SHUT-OFF		SUBSEQUENT REPORT OF ALTERING CASING
NOTICE OF INTENTION TO RE-DRILL OR REPAIR WELL		SUBSEQUENT REPORT OF RE-DRILLING OR REPAIR
NOTICE OF INTENTION TO SHOOT OR ACIDIZE		SUBSEQUENT REPORT OF ABANDONMENT
NOTICE OF INTENTION TO PULL OR ALTER CASING		SUPPLEMENTARY WELL HISTORY
NOTICE OF INTENTION TO ABANDON WELL		

(INDICATE ABOVE BY CHECK MARK NATURE OF REPORT, NOTICE, OR OTHER DATA)

RECEIVED
JUN 20 1957
U. S. GEOLOGICAL SURVEY
FARMINGTON, N. M.

Well No. 20 is located 800 ft. from S line and 1550 ft. from E line of sec. 22
SE Sec. 22 30N 4W N.M.P.M.
($\frac{1}{4}$ Sec. and Sec. No.) (Twp.) (Range) (Meridian)
East Blanco P.C. Rio Arriba New Mexico
(Field) (County or Subdivision) (State)

The elevation of the derrick floor above sea level is 7464 ft.

DETAILS OF WORK

(State names of and expected depths to objective sands; show sizes, weights, and lengths of proposed casings; indicate mud jobs, cementing points, and all other important proposed work)

It is intended to drill a well thru the Pictured Cliffs formation using rotary tools and to perforate and water fracture possible producing zones. Estimated Total Depth 4500'.

Casing Program:

9-5/8" at 120' with 125 sacks regular cement circulated to surface.

5-1/2" at 4500' with 75 sacks regular cement, 75 sacks Pozmix.

The SE $\frac{1}{4}$ of Section 22 is dedicated to this well.

SP 079487 (SE $\frac{1}{4}$).

I understand that this plan of work must receive approval in writing by the Geological Survey before operations may be commenced.

Company El Paso Natural Gas Company

Address Box 997

Farmington, New Mexico

By

[Signature]

Title Petroleum Engineer



Well Location and Acreage Dedication Plat

Section A.

Date JUNE 12, 1957

Operator EL PASO NATURAL GAS COMPANY Lease SAN JUAN 30-4 UNIT SF 079487
 Well No. 20 Unit Letter 0 Section 22 Township 30 N Range 4 W NMPM
 Located 800 Feet From SOUTH Line, 1550 Feet From EAST Line
 County RIO ARRIBA G. L. Elevation 7454 Dedicated Acreage 160 Acres
 Name of Producing Formation PICTURED CLIFF Pool EAST BLANCO PC

1. Is the Operator the only owner in the dedicated acreage outlined on the plat below?
 Yes ☒ No ☐
2. If the answer to question one is "no", have the interests of all the owners been consolidated by communitization agreement or otherwise? Yes ☐ No ☐ If answer is "yes," Type of Consolidation _____
3. If the answer to question two is "no," list all the owners and their respective interests below

OwnerLand Description

Section B

Note: All distances must be from outer boundaries of section.

This is to certify that the information in Section A above is true and complete to the best of my knowledge and belief

El Paso Natural Gas Company

(Operator)

DC Johnston

(Representative)

Box 997

Address

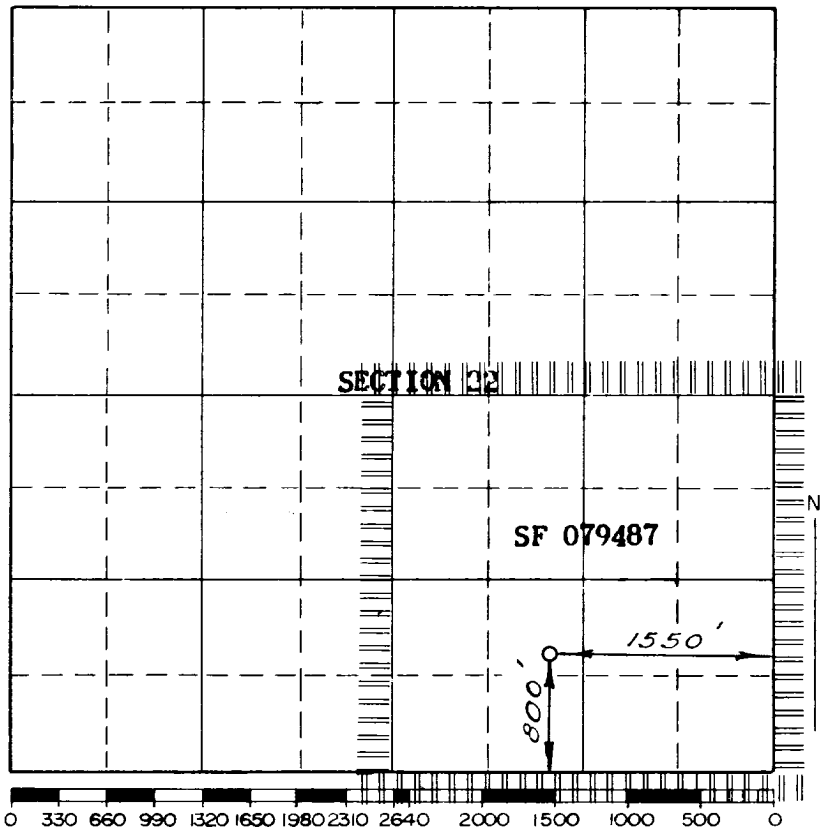
Farmington, New Mexico

Scale 4 inches equal 1 mile

This is to certify that the above plat was prepared from field notes of actual surveys made by me or under my supervision and that the same are true and correct to the best of my knowledge and belief.

Date Surveyed MAY 15, 1957

(Seal)

Farmington, New Mexico

La O. Walker
Registered Professional Engineer and/or Land Surveyor