

Land Office **Santa Fe**Lease No. **079060**Unit **Northeast Blam o**

Unit Agreement No. 1 Sec 929

Form 9-331a
(Feb. 1951)

(SUBMIT IN TRIPLICATE)

UNITED STATES
DEPARTMENT OF THE INTERIOR
GEOLOGICAL SURVEY

SUNDRY NOTICES AND REPORTS ON WELLS

NOTICE OF INTENTION TO DRILL.....	<input checked="" type="checkbox"/>	SUBSEQUENT REPORT OF WATER SHUT-OFF.....
NOTICE OF INTENTION TO CHANGE PLANS.....	<input type="checkbox"/>	SUBSEQUENT REPORT OF SHOOTING OR ACIDIZING.....
NOTICE OF INTENTION TO TEST WATER SHUT-OFF.....	<input type="checkbox"/>	SUBSEQUENT REPORT OF ALTERING CASING.....
NOTICE OF INTENTION TO RE-DRILL OR REPAIR WELL.....	<input type="checkbox"/>	SUBSEQUENT REPORT OF RE-DRILLING OR REPAIR.....
NOTICE OF INTENTION TO SHOOT OR ACIDIZE.....	<input type="checkbox"/>	SUBSEQUENT REPORT OF ABANDONMENT.....
NOTICE OF INTENTION TO PULL OR ALTER CASING.....	<input type="checkbox"/>	SUPPLEMENTARY WELL HISTORY.....
NOTICE OF INTENTION TO ABANDON WELL.....	<input type="checkbox"/>	

(INDICATE ABOVE BY CHECK MARK NATURE OF REPORT, NOTICE, OR OTHER DATA)

March 30, 1955

Well No. **19-20** is located **830** ft. from **[N]** line and **1550** ft. from **[E]** line of sec. **20**

NE 1/4 Sec. 20 (1/4 Sec. and Sec. No.) **30N** (Twp.) **7W** (Range) **RPM** (Meridian)
Blanco Mesaverde (Field) **Rio Arriba** (County or Subdivision) **New Mexico** (State or Territory)

The elevation of the derrick floor above sea level is **6402** ft.

DETAILS OF WORK

(State names of and expected depths to objective sands; show sizes, weights, and lengths of proposed casings; indicate mudding jobs, cementing points, and all other important proposed work)

Set approximately 160' of 10-3/4" 32.75# H40 Casing and circulate cement.

Set approximately 3300' of 7-5/8" 26.40# J55 Casing and cement with 200 or more sacks of cement.

Set approximately 5000' of 5 1/2" 15.50# J55 Casing and cement with 150 or more sacks of cement.

Drill to a TD of approximately 5600' and sand-frac with 20000 gallons of diesel fuel to test the Mesaverde Formation.

I understand that this plan of work must receive approval in writing by the Geological Survey before operations may be commenced.

Company **Blackwood & Nichols Company (Unit Operator)**Address **P. O. Box 1237**
Durango, ColoradoBy **De Lasso Loos**
DE LASSO LOOS
Title **Field Superintendent**

Company.....BLACKWOOD AND NICHOLS COMPANY.....

Lease.....Well No. 19-20

Sec.....20....., T.....30 N....., R.....7 W, N. M. P. M.

Location.....830' from the North line and 1550' from
the East line.

Elevation.....6392 Ungraded ground.

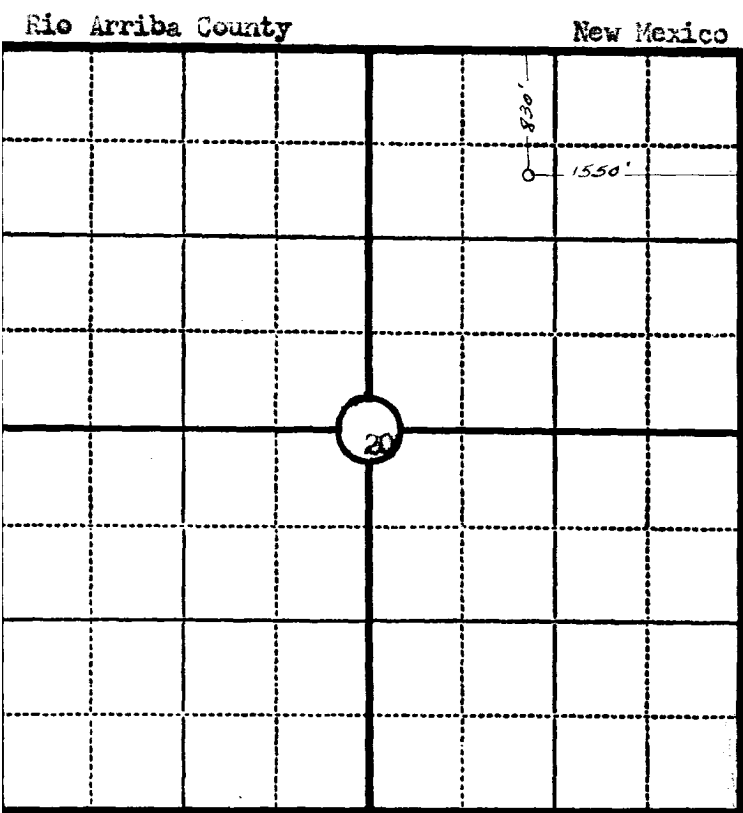

Scale—4 inches equal 1 mile.

This is to certify that the above plat was prepared from field notes
of actual surveys made by me or under my supervision and that the
same are true and correct to the best of my knowledge and belief.

Seal:

James P. Leese

Registered Professional
Engineer and Land Surveyor.

James P. Leese

N. Mex. Reg. No. 1463

Surveyed.....1 March....., 1924