

NEW MEXICO OIL CONSERVATION COMMISSION

Santa Fe, New Mexico

NOTICE OF INTENTION TO DRILL

Notice must be given to the Oil Conservation Commission or its proper agent and approval obtained before drilling begins. If changes in the proposed plan are considered advisable, a copy of this notice showing such changes will be returned to the sender. Submit this notice in triplicate. One copy will be returned following approval. See additional instructions in Rules and Regulations of the Commission.

Oklahoma City, Oklahoma
PlaceNovember 12, 1951
DateOIL CONSERVATION COMMISSION,
Santa Fe, New Mexico,

Gentlemen:

You are hereby notified that it is our intention to commence the drilling of a well to be known as

BLACKWOOD & NICHOLS COMPANY
Company or OperatorAlsup "B"
LeaseWell No. 1

in

OIL CON. COM.DIST. 3of Sec. 14, T. 30N, R. 4W, N. M. P. M., Wildcat Field, Rio Arriba County.
N The well is 990 feet (N.) (S.) of the S line and 815 feet(E) (W.) of the E line of Sec. 14

(Give location from section or other legal subdivision lines. Cross out wrong directions.)

If state land the oil and gas lease is No. _____ Assignment No. _____

If patented land the owner is J. Denton Simms Trustee Estate of Emmet WirtAddress 2128 Cambridge, Albuquerque, N.M.

If government land the permittee is _____

Address _____

The lessee is _____

Address _____

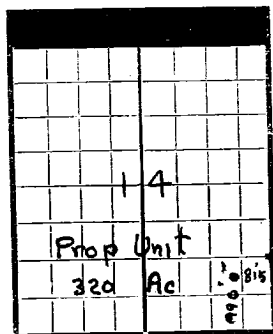

AREA 640 ACRES

LOCATE WELL CORRECTLY

We propose to drill well with drilling equipment as follows: Rotary tools to4400' to explore Pictured Cliff Sand and use cable tool completion.The status of a bond for this well in conformance with Rule 39 of the General Rules and Regulations of the Commission is as follows: Hartford Accident and Indemnity Company

We propose to use the following strings of casing and to land or cement them as indicated:

| Size of Hole | Size of Casing | Weight Per Foot | New or Second Hand | Depth | Landed or Cemented | Sacks Cement |
|----------------|------------------|-----------------|--------------------|--------------|---------------------|--------------|
| <u>13-3/4"</u> | <u>10-3/4 OD</u> | <u>29#</u> | <u>New</u> | <u>250'</u> | <u>Cement Circ.</u> | <u>200</u> |
| <u>8-3/4"</u> | <u>7" OD</u> | <u>20#</u> | <u>New</u> | <u>4150'</u> | <u>Cement</u> | <u>200</u> |

If changes in the above plan become advisable we will notify you before cementing or landing casing. We estimate that the first productive oil or gas sand should occur at a depth of about 4150 feet.

Additional information: We estimate the total depth will be 4400'.

NOTE: Additional information on reverse side.

Approved _____, 19____

except as follows:

Subject to approval of the bond by the Commission.

OIL CONSERVATION COMMISSION,

By Al GurTitle Oil and Gas Inspector Dist. #3.

Sincerely yours,

BLACKWOOD & NICHOLS COMPANY
Company or OperatorBy W. N. LittleW. N. LittlePosition Superintendent

Send communications regarding well to

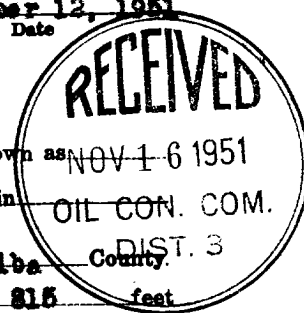
Name BLACKWOOD & NICHOLS COMPANYAddress 2917 First National Building
Oklahoma City, Oklahoma

NOTE: Stanolind Oil and Gas Company is assigning to John W. Nichols that portion of HNS 287 which is located in the SE 1/4 of Sec. 14 (approximately 65 acres). This well is located on this portion of HNS 287 and should the well be a producer this acreage will be communitized with other federal or fee land to include possibly 320 acres.

Company Blackwood-Nichols

Lease Alsup "B" Well No. 1

Sec. 14 T. 30 N., R. 4 W., N.M.P.M.

Location 990' from the South line and 990' from the East line.

Rio Arriba County

New Mexico

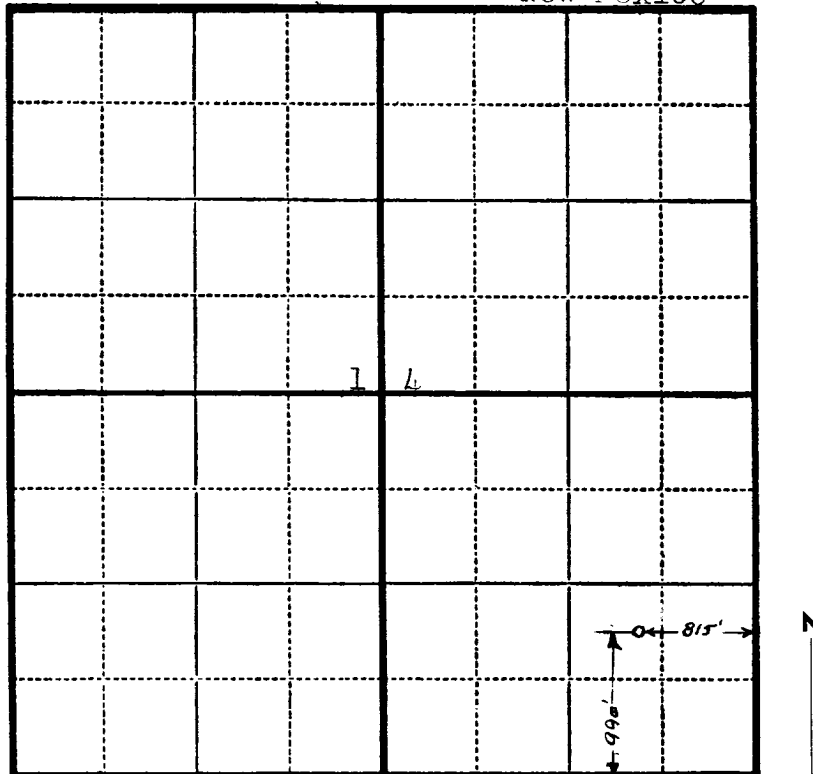

Scale—4 inches equals 1 mile.

This is to certify that the above plat was prepared from field notes of actual surveys made by me or under my supervision and that the same are true and correct to the best of my knowledge and belief.

Charles J. Finklea

Seal:

Registered Professional Charles J. Finklea
Engineer and Land Surveyor. N. Mex. Reg. No. 1302

Surveyed October 25, 1951