

NEW MEXICO OIL CONSERVATION COMMISSION

Santa Fe, New Mexico

6-1040C

1-W. R. Johnston

1-File

NOTICE OF INTENTION TO DRILL OR RECOMPLETE

Notice must be given to the District Office of the Oil Conservation Commission and approval obtained before drilling or recompletion begins. If changes in the proposed plan are considered advisable, a copy of this notice showing such changes will be returned to the sender. Submit this notice in QUINTUPLICATE. One copy will be returned following approval. See additional instructions in Rules and Regulations of the Commission. **If State Land submit 6 Copies**

Farmington, New Mexico
(Place)

December 14, 1955
(Date)

OIL CONSERVATION COMMISSION
SANTA FE, NEW MEXICO

Gentlemen:

You are hereby notified that it is our intention to commence the (Drilling) (Recompletion) of a well to be known as Pacific Northwest Pipeline Corporation

(Company or Operator)

Unit # 30-5

(Lease)

Well No. 13-16

in 30-5

(Unit)

The well is

located 990 feet from the North line and 1650 feet from the

East line of Section 16, T. 30N, R. 5W, NMPM.

(GIVE LOCATION FROM SECTION LINE)

Blanco Pool, Rio Arriba County

If State Land the Oil and Gas Lease is No. E-347

If patented land the owner is.....

Address.....

We propose to drill well with drilling equipment as follows: Rotary tools from zero to 5673'

The status of plugging bond is.....

Drilling Contractor Moran Drilling Co.

We intend to complete this well in the Mesa Verde formation at an approximate depth of 5600 feet.



D	C	B	A
		X	
E	F	G	H
L	K	J	I
M	N	O	P

CASING PROGRAM

We propose to use the following strings of Casing and to cement them as indicated:

Size of Hole	Size of Casing	Weight per Foot	New or Second Hand	Depth	Sacks Cement
15	10-3/4	32.75	New	200'	125 sx 4%
9-7/8	7-5/8	26.40	New	3420	150 sx 8%
6-3/4	5 1/2	14	New	5673	175 sx 2%

If changes in the above plans become advisable we will notify you immediately.

ADDITIONAL INFORMATION (If recompletion give full details of proposed plan of work.)

to Perf and sand frac the Pt. Lookout, Manafee and Cliff House each, Separately w/2,000 gal water w/appx. 1 1/2# sd gal. 320 acres dedicated to this well.

Approved..... 12-16, 1955
Except as follows:

Sincerely yours,

Pacific Northwest Pipeline Corporation
(Company or Operator)

By: J. H. [Signature]

Position District Eng near
Send Communications regarding well to

Name Pacific Northwest Pipeline Corp.

Address 413 1/2 West Main Street

Farmington, New Mexico

OIL CONSERVATION COMMISSION

By: [Signature]

Title Oil and Gas Inspector Dist. #3.

Company **PACIFIC NORTHWEST PIPELINE CORPORATION**

Lease Well No.

Sec. **16** , T. **30 N.** , R. **5 W., N.M.P.M.**

Location **990' FROM THE NORTH LINE AND 1650' FROM THE EAST LINE.**

Elevation **6358.6 UNGRADED GROUND.**

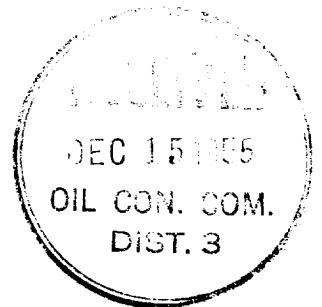
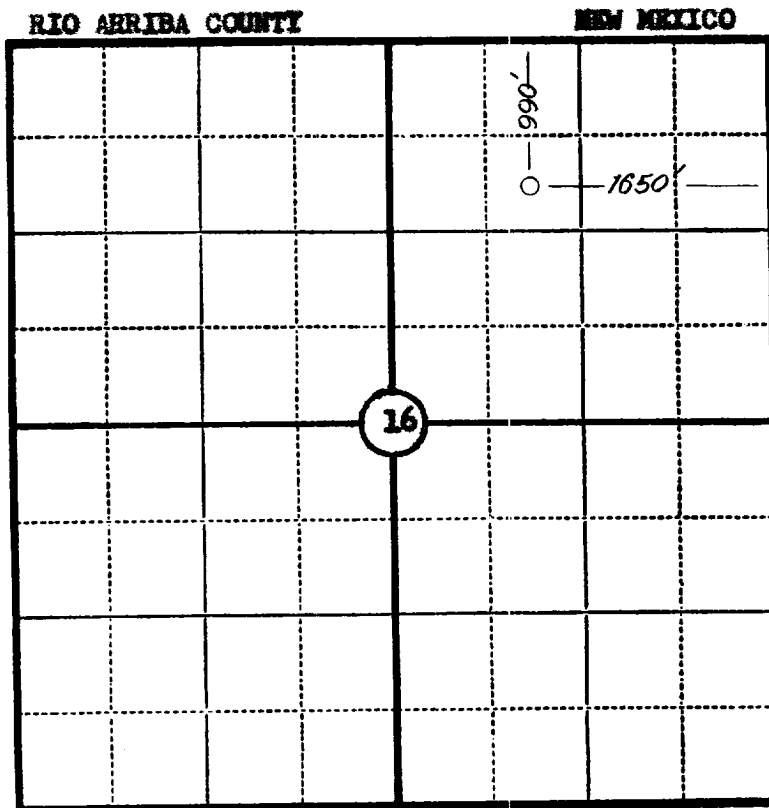

Scale—4 inches equal 1 mile.

This is to certify that the above plat was prepared from field notes of actual surveys made by me or under my supervision and that the same are true and correct to the best of my knowledge and belief.

Seal:

James P. Leese

Registered Land Surveyor.

James P. Leese

N. Mex. Reg. No. 1463

Surveyed **2 December** 19 **55**

SAN JUAN ENGINEERING COMPANY, FARMINGTON, N. M.

OIL CONSERVATION COMMISSION		
ASST. STATE OFFICE		
APR 1951	4	
MAY 1951		
JUN 1951	1	
JUL 1951	1	
AUG 1951	1	
SEP 1951	2	
OCT 1951		
NOV 1951	1	✓
DEC 1951		