

(SUBMIT IN TRIPLICATE)

UNITED STATES
DEPARTMENT OF THE INTERIOR
GEOLOGICAL SURVEY

Land Office Santa Fe
Lease No. 079483
Unit S. D. June 30-4 Unit
14-05-001-1056

SUNDRY NOTICES AND REPORTS ON WELLS

NOTICE OF INTENTION TO DRILL	<input checked="" type="checkbox"/>	SUBSEQUENT REPORT OF WATER SHUT-OFF	
NOTICE OF INTENTION TO CHANGE PLANS		SUBSEQUENT REPORT OF SHOOTING OR ACIDIZING	
NOTICE OF INTENTION TO TEST WATER SHUT-OFF		SUBSEQUENT REPORT OF ALTERING CASING	
NOTICE OF INTENTION TO RE-DRILL OR REPAIR WELL		SUBSEQUENT REPORT OF RE-DRILLING OR REPAIR	
NOTICE OF INTENTION TO SHOOT OR ACIDIZE		SUBSEQUENT REPORT OF ABANDONMENT	
NOTICE OF INTENTION TO PULL OR ALTER CASING		SUPPLEMENTARY WELL HISTORY	
NOTICE OF INTENTION TO ABANDON WELL			

(INDICATE ABOVE BY CHECK MARK NATURE OF REPORT, NOTICE, OR OTHER DATA)

April 30, 1956

Well No. 12 is located 1840 ft. from S line and 1190 ft. from W line of sec. 8

Section 8
($\frac{1}{4}$ Sec. and Sec. No.)

30N
(Twp.)

4E
(Range)

RAPN
(Meridian)

E. Blanco P.C.
(Field)

Mio Arriba
(County or Subdivision)

New Mexico
(State or Territory)

The elevation of the derrick floor above sea level is 7073 ft.

DETAILS OF WORK

(State names of and expected depths to objective sands; show sizes, weights, and lengths of proposed casings; indicate mudlogging jobs, cementing points, and all other important proposed work)

It is intended to drill a well thru the Pictured Cliff formation using rotary tools to the casing point and to drill the pay section with cable tools and to water fracture the entire pay section Est. T.D. 4160'.

Casing Program:

9 5/8" at 120' with 125 sacks regular cement circulated to surface.
5 1/2" at 4160' with 75 sacks regular cement, 75 sacks Pozmix.

The $\frac{3}{4}$ of Section 8 is dedicated to this well
($\frac{5}{8}$ of) SF 079483.

I understand that this plan of work must receive approval in writing by the Geological Survey before operations may be commenced.

Company El Paso Natural Gas Company

Address Box 297

Farmington, New Mexico

By

D.C. Johnston

Title Petroleum Engineer

NEW MEXICO
OIL CONSERVATION COMMISSION

WELL LOCATION AND/OR GAS PRORATION PLAT

DATE APRIL 24, 1956

OPERATOR EL PASO NATURAL GAS COMPANY SAN JUAN 30-4 UNIT SF 079483

SECTION 12 TOWNSHIP 8 RANGE 30-N ZONE 4-W

COUNTY 1840 DIRECTION SOUTH DISTANCE 1190 DIRECTION WEST

RIO ARriba 7063

NEAREST LAND SURVEY PICTURED CLIFF E. BLANCO 160

(1955 PLAT)

Note: All distances must be from outer boundaries of section.

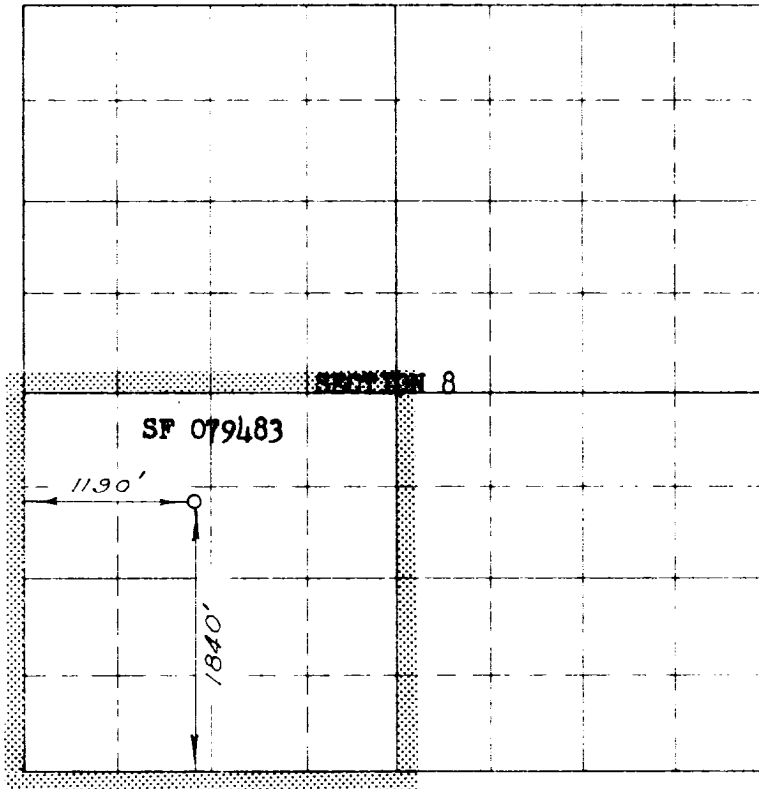

Scale 1 inch = equal 1 mile

NOTE

This section of
form is to be used
for gas wells only.

This is to certify that the above plat was prepared from
field notes of actual surveys made by me or under my
supervision and that the same are true and correct to the
best of my knowledge and belief.

Date Surveyed APRIL 17, 1956

D. O. Walker
Registered Professional Engineer and ~~XXX~~ Land Surveyor

1. Is this well a Dual Comp.
Yes _____ No X
2. If the answer to Question 1
is yes, are there any other dually
completed wells within the
dedicated acreage.
Yes _____ No _____

Original Signed D. C. Johns'on
Name _____

Position Petroleum Engineer

Representing El Paso Natural Gas Co.

Address Box 997, Farmington, N.M.

(Seal)

Farmington, New Mexico