

COPY TO O.C.C.

(SUBMIT IN TRIPLICATE)

UNITED STATES
DEPARTMENT OF THE INTERIOR
GEOLOGICAL SURVEY

Land Office **Santa Fe**Lease No. **079001**Unit **Northeast Blanco**
Unit Agreement No. 1 Sec 929

SUNDRY NOTICES AND REPORTS ON WELLS

NOTICE OF INTENTION TO DRILL.....	<input checked="" type="checkbox"/>	SUBSEQUENT REPORT OF WATER SHUT-OFF.....
NOTICE OF INTENTION TO CHANGE PLANS.....		SUBSEQUENT REPORT OF SHOOTING OR ACIDIZING.....
NOTICE OF INTENTION TO TEST WATER SHUT-OFF.....		SUBSEQUENT REPORT OF ALTERING CASING.....
NOTICE OF INTENTION TO RE-DRILL OR REPAIR WELL.....		SUBSEQUENT REPORT OF RE-DRILLING OR REPAIR.....
NOTICE OF INTENTION TO SHOOT OR ACIDIZE.....		SUBSEQUENT REPORT OF ABANDONMENT.....
NOTICE OF INTENTION TO PULL OR ALTER CASING.....		SUPPLEMENTARY WELL HISTORY.....
NOTICE OF INTENTION TO ABANDON WELL.....		

(INDICATE ABOVE BY CHECK MARK NATURE OF REPORT, NOTICE, OR OTHER DATA)

August 5, 1953

Well No. **8-10** is located **1650** ft. from **S** line and **1650** ft. from **W** line of sec. **10****SW/4 Sec 10**

(1/4 Sec. and Sec. No.)

30 N

(Twp.)

7 W

(Range)

New Mexico Principal

(Meridian)

Blanco

(Field)

Rio Arriba

(County or Subdivision)

New Mexico

(State or Territory)

The elevation of the derrick floor above sea level is **6274** ft.

DETAILS OF WORK

(State names of and expected depths to objective sands; show sizes, weights, and lengths of proposed casings; indicate mudding jobs, cementing points, and all other important proposed work)

Set approximately 200' of 10-3/4" 32.75# H-40 surface casing and circulate cement.

Set approximately 4770' of 7" 23# & 20# production string and cement with 400 or more sacks of cement, if necessary.

Drill to a total depth of approximately 5670' to test the Mesa Verde formation.

I understand that this plan of work must receive approval in writing by the Geological Survey before operations may be commenced.

Company **Blackwood & Nichols Company (Unit Operator)**Address **P. O. Box 611****Durango, Colorado**

By

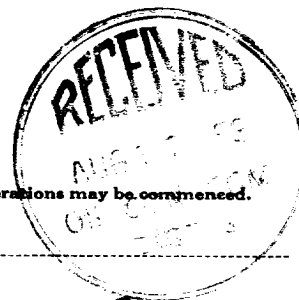
*De Lasso Low*Title **Field Superintendent**

Company Blackwood-Nichols & Company

Lease..... Well No.....

Sec. 10, T. 30N, R. 7W N.M.P.M.

Location 1650' From South line and 1650' From the
West line

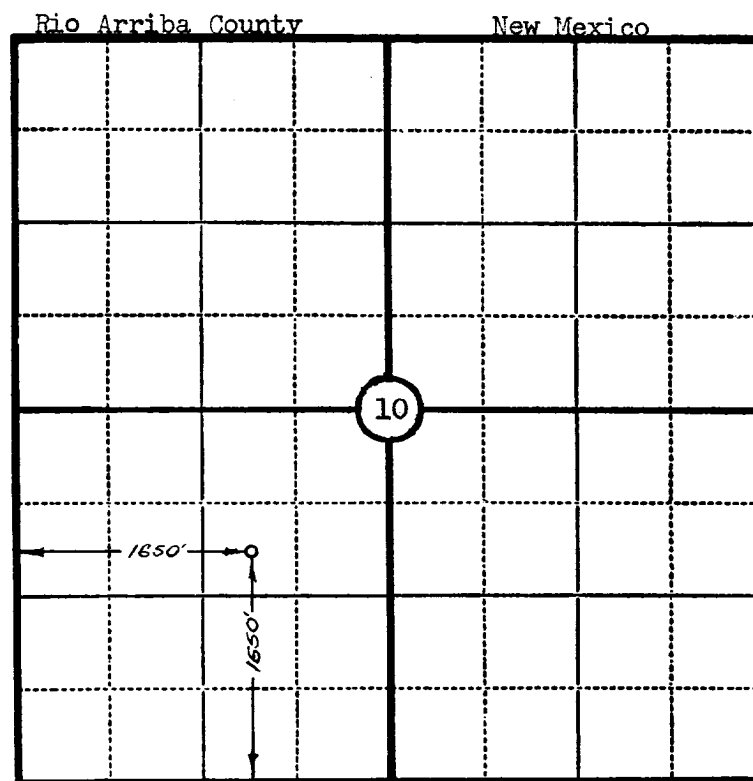

Scale—4 inches equal 1 mile.

This is to certify that the above plat was prepared from field notes of actual surveys made by me or under my supervision and that the same are true and correct to the best of my knowledge and belief.

Seal:

Charles J. Finklea
Registered Professional Charles J. Finklea
Engineer and Land Surveyor N. Mex. Reg. No. 1302

Surveyed April 18, 1953

RECEIVED

AUG 5 1953

U. S. GEOLOGICAL SURVEY
FARMINGTON, N. M.

N

