

(SUBMIT IN TRIPLICATE)

Land Office **Santa Fe**

Lease No. **079049**

Unit **Northeast Kansas**

Unit Agreement No. 1 See 989

UNITED STATES
DEPARTMENT OF THE INTERIOR
GEOLOGICAL SURVEY

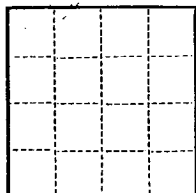

SUNDRY NOTICES AND REPORTS ON WELLS

NOTICE OF INTENTION TO DRILL.....	<input checked="" type="checkbox"/>	SUBSEQUENT REPORT OF WATER SHUT-OFF.....	
NOTICE OF INTENTION TO CHANGE PLANS.....		SUBSEQUENT REPORT OF SHOOTING OR ACIDIZING.....	
NOTICE OF INTENTION TO TEST WATER SHUT-OFF.....		SUBSEQUENT REPORT OF ALTERING CASING.....	
NOTICE OF INTENTION TO RE-DRILL OR REPAIR WELL.....		SUBSEQUENT REPORT OF RE-DRILLING OR REPAIR.....	
NOTICE OF INTENTION TO SHOOT OR ACIDIZE.....		SUBSEQUENT REPORT OF ABANDONMENT.....	
NOTICE OF INTENTION TO PULL OR ALTER CASING.....		SUPPLEMENTARY WELL HISTORY.....	
NOTICE OF INTENTION TO ABANDON WELL.....			

(INDICATE ABOVE BY CHECK MARK NATURE OF REPORT, NOTICE, OR OTHER DATA)

May 21, 1954

Well No. **17-9** is located **1775** ft. from **N** line and **875** ft. from **W** line of sec. **9**

Sec 9
(1/4 Sec. and Sec. No.)

30N
(Twp.)

7N
(Range)

107W
(Meridian)

Kansas Mesaverde
(Field)

El Arriba
(County or Subdivision)

New Mexico
(State or Territory)

The elevation of the derrick floor above sea level is **6316** ft.

DETAILS OF WORK

(State names of and expected depths to objective sands; show sizes, weights, and lengths of proposed casings; indicate mudding jobs, cementing points, and all other important proposed work)

Set approximately 200' of 10-3/4" 32.75# 8-40 casing and circulate cement.

Set approximately 5100' of 7" 23 & 20# 1-55 casing and cement with 300 sacks.

Drill to a total depth of approximately 5800' to test the Mesaverde Formation.

I understand that this plan of work must receive approval in writing by the Geological Survey before operations may be commenced.

Company **Blackwood & Nichols Company (Unit Operator)**

Address **P. O. Box 1237**

Durango, Colorado

By

De Lasso Loos
DE LASSO LOOS

Title

Field Superintendent

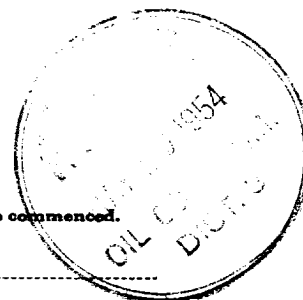

Company.....BLACKWOOD AND NICHOLS COMPANY.....

Lease.....Well No. 17-9.....

Sec. 9, T. 30 N., R. 7 W., N.M.P.M.

Location 1775' from the South line and 875' from the West line.

Elevation.....6306 Ungraded ground.....

MAY 24 1954

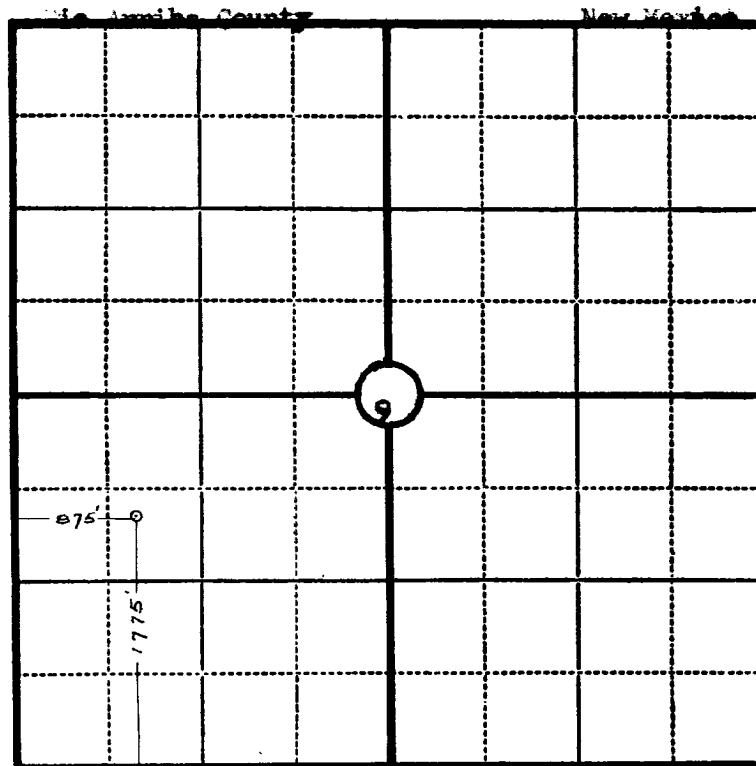

Scale—4 inches equal 1 mile.

This is to certify that the above plat was prepared from field notes of actual surveys made by me or under my supervision and that the same are true and correct to the best of my knowledge and belief.



Seal:

James P. Leese

Registered Professional
Engineer and Land Surveyor.

James P. Leese
N. Mex. Reg. No. 1463

Surveyed 2 March, 1954.....