

NEW MEXICO OIL CONSERVATION COMMISSION
Santa Fe, New Mexico

Form C-101
Revised (12/1/55)

NOTICE OF INTENTION TO DRILL

Notice must be given to the District Office of the Oil Conservation Commission and approval obtained before drilling or recompletion begins. If changes in the proposed plan are considered advisable, a copy of this notice showing such changes will be returned to the sender. Submit this notice in QUINTUPPLICATE. One copy will be returned following approval. See additional instructions in Rules and Regulations of the Commission. If State Land submit 6 Copies Attach Form C- 128 in triplicate to first 3 copies of form C-101

Farmington, New Mexico

May 11, 1961

(Place)

(Date)

OIL CONSERVATION COMMISSION
SANTA FE, NEW MEXICO

Gentlemen:

You are hereby notified that it is our intention to commence the Drilling of a well to be known as
El Paso Natural Gas Company

(Company or Operator)

San Juan 30-5 Unit

Well No. **35**, in **K** The well is

located **1840** (Lease) **South** line and **1650** (Unit) feet from the **West** line of Section **7**, T. **30-N**, R. **5-W**, NMPM.
Blanco Mesa Verde **Rio Arriba**

(GIVE LOCATION FROM SECTION LINE)

Pool, County

D	C	B	A
E	F	G	H
L	K	J	I
M	N	O	P

Elev. 6206 G, 6216 DF

If State Land the Oil and Gas Lease is No.

If patented land the owner is **Agapita G. Gomez et al**

Address **601 White Ave, Aztec, New Mexico**

We propose to drill well with drilling equipment as follows: **Rotary tools, using gas circulation to drill from the Lewis thru the Mesa Verde formation**

The status of plugging bond is **Statewide**

Drilling Contractor

We intend to complete this well in the **Mesa Verde** formation at an approximate depth of **5600** feet.

CASING PROGRAM

We propose to use the following strings of Casing and to cement them as indicated:

Size of Hole	Size of Casing	Weight per Foot	New or Second Hand	Depth	Sacks Cement
13 3/4"	9 5/8"	32.3#	New	280	300
8 3/4"	7"	26.4#	New	3396	270
6 1/4"	2 7/8"	6.4	New	5600	220

If changes in the above plans become advisable we will notify you immediately.

ADDITIONAL INFORMATION (If recompletion give full details of proposed plan of work.)

Possible productive zones in the Mesa Verde will be perforated and fractured.
The W/2 of Section 7 is dedicated to this well.

Approved 5-15, 1961
Except as follows:

Sincerely yours,

El Paso Natural Gas Company

(Company or Operator)

By Original Signed R. G. MILLER

Position **Petroleum Engineer**

Send Communications regarding well to

Name **E. S. Oberly**

Address **Box 990, Farmington, New Mexico**

OIL CONSERVATION COMMISSION

By *Emory C. Lamm*



NEW MEXICO OIL CONSERVATION COMMISSION

Well Location and Acreage Dedication Plat

Date **May 1, 1961**

Section A.

Operator **EL PASO NATURAL GAS COMPANY** Lease **SAN JUAN 30-5 UNIT** Fee **FEE**
 Well No. **35** Unit Letter **K** Section **7** Township **30-N** Range **5-W** NMPM
 Located **1840** Feet From **SOUTH** Line, **1650** Feet From **WEST** Line
 County **RIO ARriba** G. L. Elevation **6206** Dedicated Acreage **320** Acres
 Name of Producing Formation **MESA VERDE** Pool **BLANCO M.V.**

1. Is the Operator the only owner in the dedicated acreage outlined on the plat below?
 Yes ☒ No ☐
2. If the answer to question one is "no", have the interests of all the owners been consolidated by communitization agreement or otherwise? Yes ☐ No ☐ If answer is "yes", Type of Consolidation _____
3. If the answer to question two is "no", list all the owners and their respective interests below:

Owner

Land Description

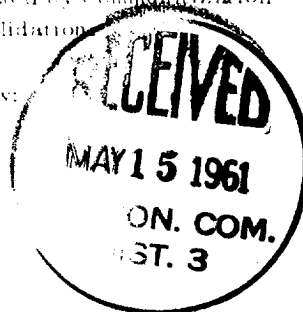

Section B.

This is to certify that the information in Section A above is true and complete to the best of my knowledge and belief.

El Paso Natural Gas Company(Operator)
Original Signed **R. G. MILLER**

(Representative)

Box 990

(Address)

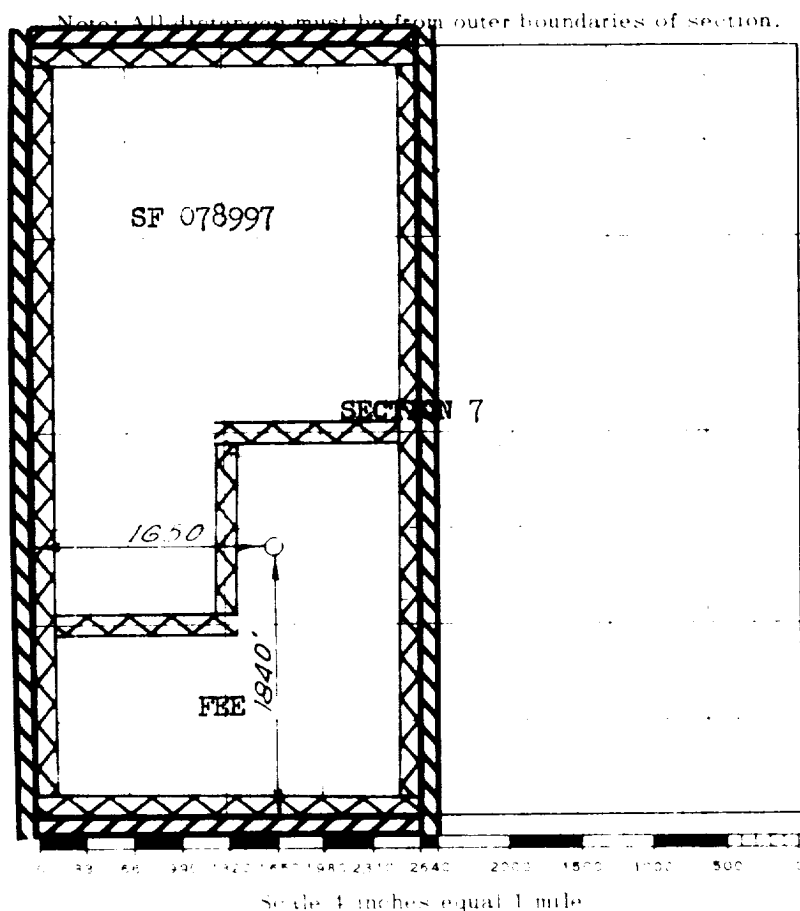
Farmington, New Mexico

This is to certify that the plat was prepared from field notes of actual surveys made by me or under my supervision and that the same are true and correct to the best of my knowledge and belief.

(Seal)

Date Surveyed **March 8, 1961**

David O. Kilmer
 Registered Professional Engineer and/or Land Surveyor

Farmington, New Mexico