

Form 9-331a
(Feb. 1961)

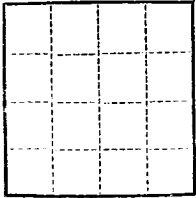

(SUBMIT IN TRIPLICATE)

UNITED STATES
DEPARTMENT OF THE INTERIOR
GEOLOGICAL SURVEY

Land Office Santa Fe

Lease No. MM 012573

Unit Howell
S.J. 30-6 Unit
14-00-001-538

SUNDRY NOTICES AND REPORTS ON WELLS

NOTICE OF INTENTION TO DRILL.....	<input checked="" type="checkbox"/>	SUBSEQUENT REPORT OF WATER SHUT-OFF.....
NOTICE OF INTENTION TO CHANGE PLANS.....		SUBSEQUENT REPORT OF SHOOTING OR ACIDIZING.....
NOTICE OF INTENTION TO TEST WATER SHUT-OFF.....		SUBSEQUENT REPORT OF ALTERING CASING.....
NOTICE OF INTENTION TO RE-DRILL OR REPAIR WELL.....		SUBSEQUENT REPORT OF RE-DRILLING OR REPAIR.....
NOTICE OF INTENTION TO SHOOT OR ACIDIZE.....		SUBSEQUENT REPORT OF ABANDONMENT.....
NOTICE OF INTENTION TO PULL OR ALTER CASING.....		SUPPLEMENTARY WELL HISTORY.....
NOTICE OF INTENTION TO ABANDON WELL.....		

(INDICATE ABOVE BY CHECK MARK NATURE OF REPORT, NOTICE, OR OTHER DATA)

RECEIVED
APR 27 1956
U. S. GEOLOGICAL SURVEY
FARMINGTON, NEW MEXICO

April 26, 1956

Well No. 3-H is located 1600 ft. from N line and 800 ft. from E line of sec. 12

NE Section 12 30N 7E RMPM
(1/4 Sec. and Sec. No.) (Twp.) (Range) (Meridian)

Blanco Rio Arriba New Mexico
(Field) (County or Subdivision) (State or Territory)

The elevation of the derrick floor above sea level is 6347 ft.

DETAILS OF WORK

(State names of and expected depths to objective sands; show sizes, weights, and lengths of proposed casings; indicate mudding jobs, cementing points, and all other important proposed work)

It is intended to drill a well with rotary tools thru the Mesa Verde formation. Mud circulation will be used thru the Pictured Cliffs and set intermediate casing. Gas circulation will be used thru the Mesa Verde and a liner will be set. Possible productive intervals will be perforated and fractured. Est. T.D. 5742'.

Casing Program:

10 3/4" at 170' with 125 sacks cement circulated to the surface.
7 5/8" at 3420' with 250 sacks cement.
5 1/2" at 5742' with 150 sacks cement.

The E/2 of Section 12 is dedicated to this well.
(1/2) SF 079000.

I understand that this plan of work must receive approval in writing by the Geological Survey before operations may be commenced.

Company El Paso Natural Gas Company

Address Box 997

Farmington, New Mexico

By Ceevelli W. W. W.

Title Petroleum Engineer

OIL CONSERVATION COMMISSION

WELL LOCATION AND/OR GAS PRODUCTION PLAT

DATE MARCH 7, 1956OPERATOR EL PASO NATURAL GAS COMPANY LEASE HOWELL "H" N.M.D. 257.3 ~~SE 1/4~~WELL NO. 3 SECTION 12 TOWNSHIP 30-N RANGE 7-W NMPMLOCATED 1600 FEET FROM NORTH LINE 890 FEET FROM EAST LINERIO ARriba COUNTY, NEW MEXICO G. L. ELEVATION 6337NAME OF PRODUCING FORMATION MESA VERDE POOL BLANCO DEDICATED ACREAGE 320

Note: All distances must be from outer boundaries of section.

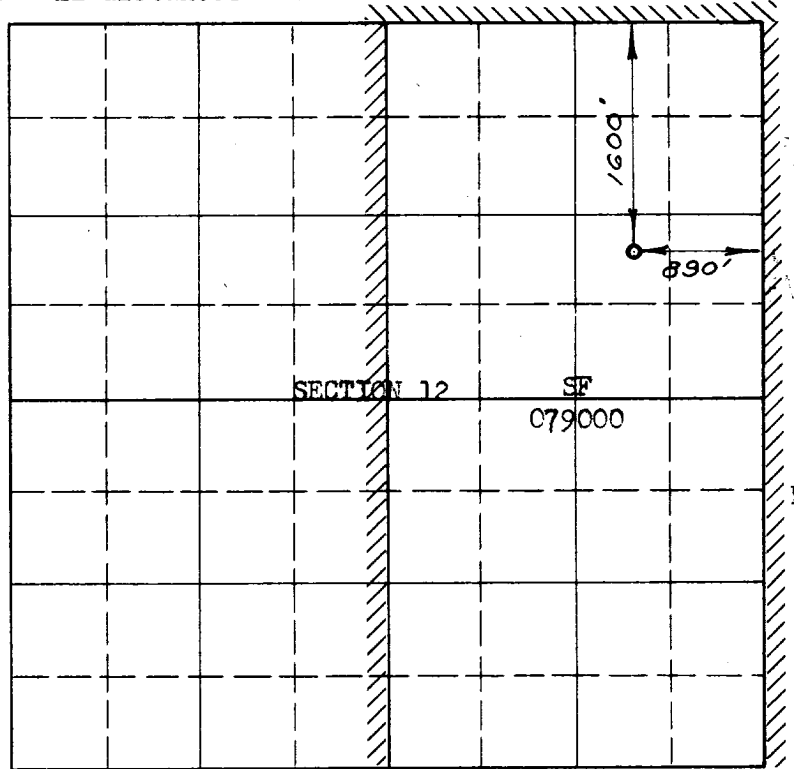

Scale 4 inches equal 1 mile

APR 11 1956
 COUNTY CLERK
 FARMINGTON, NEW MEXICO

NOTE

This section of
 form is to be used
 for gas wells only

This is to certify that the above plat was prepared from field notes of actual surveys made by me or under my supervision and that the same are true and correct to the best of my knowledge and belief.

Date Surveyed DECEMBER 28, 1955

E. O. Walker
 Registered Professional Engineer and/or
 Land Surveyor

(Seal)

Farmington, New Mexico

1. Is this well a Dual Comp.
Yes _____ No X
2. If the answer to Question 1 is yes, are there any other dually completed wells within the dedicated acreage.
Yes _____ No _____

Name Tewell WalkerPosition Petroleum EngineerRepresenting El Paso Natural GasAddress Box 997, Farmington, N.M.

NOTE: THIS PLAT RE-ISSUED ON CORRECT FORM.