

NEW MEXICO OIL CONSERVATION COMMISSION  
Santa Fe, New Mexico

## NOTICE OF INTENTION TO DRILL OR RECOMPLETE

Notice must be given to the District Office of the Oil Conservation Commission and approval obtained before drilling or recompletion begins. If changes in the proposed plan are considered advisable, a copy of this notice showing such changes will be returned to the sender. Submit this notice in QUINTUPLICATE. One copy will be returned following approval. See additional instructions in Rules and Regulations of the Commission.

Durango, Colorado

(Place)

March 5, 1954

(Date)

OIL CONSERVATION COMMISSION  
SANTA FE, NEW MEXICO

Gentlemen:

You are hereby notified that it is our intention to commence the (Drilling) ~~completion~~ of a well to be known as**Blackwood & Nichols Company (Unit Operator)**

(Company or Operator)

**Northeast Hlanco Unit**

(Lease)

Well No. **15-2****L**

(Unit)

located **1650** feet from the **South** line and **990** feet from the**West**line of Section **2**T. **30N**R. **7W**

NMPM

(GIVE LOCATION FROM SECTION LINE)

**Hlanco Mesaverde**

Pool,

**Rio Arriba**

County

If State Land the Oil and Gas Lease is No. **E-289-9**

If patented land the owner is.....

Address.....

We propose to drill well with drilling equipment as follows:

**Appropriate rotary rig.**

The status of plugging bond is.....

Drilling Contractor **Not yet selected.**We intend to complete this well in the **Mesaverde**formation at an approximate depth of **5550** feet.

## CASING PROGRAM

We propose to use the following strings of Casing and to cement them as indicated:

| Size of Hole   | Size of Casing | Weight per Foot      | New or Second Hand | Depth        | Sacks Cement |
|----------------|----------------|----------------------|--------------------|--------------|--------------|
| <b>13-3/4"</b> | <b>10-3/4"</b> | <b>32.75#</b>        | <b>New</b>         | <b>200'</b>  | <b>200</b>   |
| <b>8-3/4"</b>  | <b>7"</b>      | <b>20# &amp; 23#</b> | <b>New</b>         | <b>5050'</b> | <b>980</b>   |
|                |                |                      |                    |              |              |
|                |                |                      |                    |              |              |

If changes in the above plans become advisable we will notify you immediately.

ADDITIONAL INFORMATION (If recompletion give full details of proposed plan of work.)

**The W/2 of Section 2 is designated as a drilling unit.****We propose to shoot the well with approximately 1400 qts from 5100' to 5550'.**Approved....., 19.....  
Except as follows:

Sincerely yours,

**BLACKWOOD & NICHOLS COMPANY**

(Company or Operator)

By **De Lasso Lasso****Field Superintendent**

Position

Send Communications regarding well to

Name

**Blackwood & Nichols Company**

Address

**P. O. Box 1237****Durango, Colorado**

OIL CONSERVATION COMMISSION

By.....

Title.....

Company.....BLACKWOOD AND NICHOLS COMPANY

Lease.....Well No. 15-2

Sec. 2....., T. 30 N....., R. 7 E. N.M.P.M.

Location.....1650' from the South line and 990' from  
the West line.

Elevation.....6322 Ungraded ground.

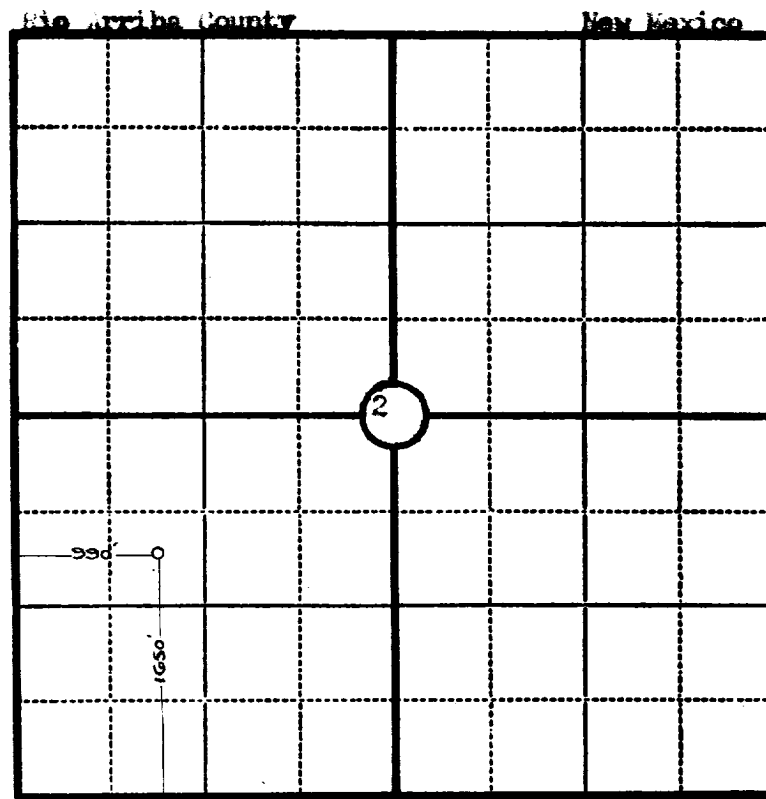

Scale—4 inches equal 1 mile.

This is to certify that the above plat was prepared from field notes of actual surveys made by me or under my supervision and that the same are true and correct to the best of my knowledge and belief.

Seal:

*James P. Leese*

Registered Professional James P. Leese  
Engineer and Land Surveyor. N. Mex. Reg. No. 1453

Surveyed ..... 1 March ..... 1954

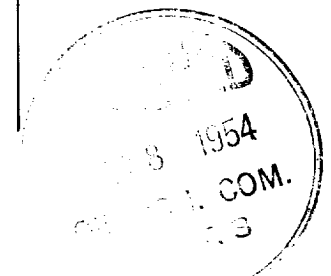

|                              |                  |          |
|------------------------------|------------------|----------|
| OIL CONSERVATION COMMISSION  |                  |          |
| AZTEC DISTRICT OFFICE        |                  |          |
| No. Copies Received <i>6</i> |                  |          |
| DISTRIBUTION                 |                  |          |
|                              | NO.<br>FURNISHED |          |
| Operator                     | <i>1</i>         |          |
| Santa Fe                     | <i>1</i>         |          |
| Proration Office             |                  |          |
| State Land Office            | <i>1</i>         |          |
| U. S. G. S.                  | <i>2</i>         |          |
| Transporter                  |                  |          |
| File                         | <i>1</i>         | <i>/</i> |
|                              |                  |          |