

(SUBMIT IN TRIPLICATE)

UNITED STATES
DEPARTMENT OF THE INTERIOR
GEOLOGICAL SURVEY

Land Office New Mexico
Lease No. 012735
Unit San Juan 31-6 Unit
14-08-001-164

SUNDRY NOTICES AND REPORTS ON WELLS

NOTICE OF INTENTION TO DRILL	<input checked="" type="checkbox"/>	SUBSEQUENT REPORT OF WATER SHUT-OFF	
NOTICE OF INTENTION TO CHANGE PLANS		SUBSEQUENT REPORT OF SHOOTING OR ACIDIZING	
NOTICE OF INTENTION TO TEST WATER SHUT-OFF		SUBSEQUENT REPORT OF ALTERING CASING	
NOTICE OF INTENTION TO RE-DRILL OR REPAIR WELL		SUBSEQUENT REPORT OF RE-DRILLING OR REPAIR	
NOTICE OF INTENTION TO SHOOT OR ACIDIZE		SUBSEQUENT REPORT OF ABANDONMENT	
NOTICE OF INTENTION TO PULL OR ALTER CASING		SUPPLEMENTARY WELL HISTORY	
NOTICE OF INTENTION TO ABANDON WELL			

(INDICATE ABOVE BY CHECK MARK NATURE OF REPORT, NOTICE, OR OTHER DATA)

Well No. 3 is located 1800 ft. from 20 line and 1150 ft. from W line of sec. 6
8 Sec. and Sec. No. 30N 6W 100W
(Twp.) (Range) (Meridian)

Blanco Rio Arriba New Mexico
(Field) (County or Subdivision) (State or Territory)

The elevation of the derrick floor above sea level is 6309 ft.

DETAILS OF WORK

(State names of and expected depths to objective sands; show sizes, weights, and lengths of proposed casings; indicate mudding jobs, cementing points, and all other important proposed work)

It is intended to drill a well with rotary tools thru the Mesa Verde formation. Mud circulation will be used thru the Pictured Cliffs and set intermediate casing. Gas circulation will be used thru the Mesa Verde and production casing will be set. Possible productive intervals will be perforated and fractured. Estimated T.D. 5647'.

Casing Program:

10 3/4" at 170' with 125 sacks cement circulated to the surface
7 5/8" at 3402' with 250 sacks cement.
5 1/2" at 5647' with 150 sacks cement.

The W/2 of Section 6 is dedicated to this well.
W/2 (NM 012735)

I understand that this plan of work must receive approval in writing by the Geological Survey before operations may be commenced.

Company El Paso Natural Gas Company

Address Box 997

Farmington, New Mexico

By [Signature]

Title Petroleum Engineer



THE UNITED STATES OF AMERICA
DEPARTMENT OF THE INTERIOR
BUREAU OF LAND MANAGEMENT
WASHINGTON, D. C.

WATER RESOURCES DIVISION

FOR THE PURPOSE OF THE NATIONAL RECONSTRUCTION AND DEVELOPMENT ACT OF 1948, AS AMENDED, THE FOLLOWING IS A SUMMARY OF THE PROCEEDINGS OF THE PUBLIC HEARING HELD AT THE CITY OF ALBUQUERQUE, NEW MEXICO, ON THE 14TH DAY OF APRIL, 1950, AT 10:00 A. M., FOR THE PURPOSE OF DETERMINING THE FEASIBILITY OF THE PROPOSED ALBUQUERQUE WATER TREATMENT PLANT AND THE APPROPRIATE REMEDIAL ACTION TO BE TAKEN BY THE UNITED STATES OF AMERICA.

1

2

THE PROCEEDINGS OF THE PUBLIC HEARING HELD AT THE CITY OF ALBUQUERQUE, NEW MEXICO, ON THE 14TH DAY OF APRIL, 1950, AT 10:00 A. M., FOR THE PURPOSE OF DETERMINING THE FEASIBILITY OF THE PROPOSED ALBUQUERQUE WATER TREATMENT PLANT AND THE APPROPRIATE REMEDIAL ACTION TO BE TAKEN BY THE UNITED STATES OF AMERICA.

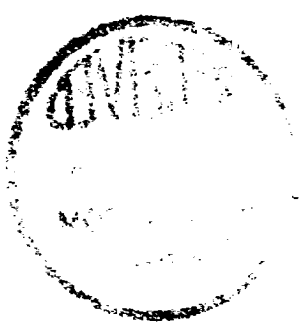

Handwritten signature or initials.

OIL CONSERVATION COMMISSION

WELL LOCATION AND/OR GAS PRODUCTION PLAT

DATE MARCH 13, 1956OPERATOR EL PASO NATURAL GAS COMPANY LEASE SAN JUAN 31-6 UNIT NM 012735WELL NO. 8 SECTION 6 TOWNSHIP 30-N RANGE 6-W NMPMLOCATED 1800 FEET FROM SOUTH LINE 1150 FEET FROM WEST LINERIO ARriba COUNTY, NEW MEXICOG. L. ELEVATION 6299NAME OF PRODUCING FORMATION MESA VERDE POOL BLANCO DEDICATED ACREAGE 319.85

(1914 PLAT)

Note: All distances must be from outer boundaries of section.

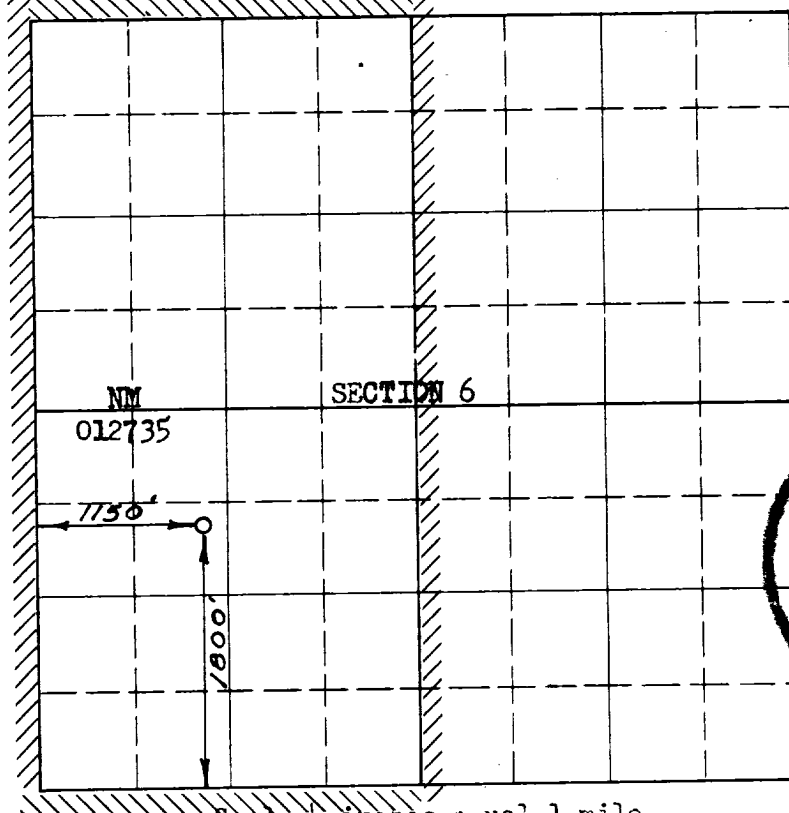

RECEIVED
MARCH 13 1956
OIL CON. COM.
DIST. 3

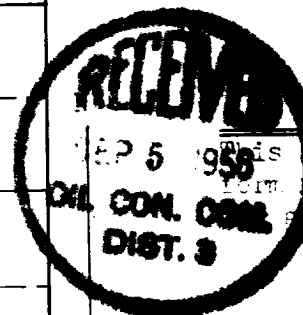

This is to certify that the above plat was prepared from field notes of actual surveys made by me or under my supervision and that the same are true and correct to the best of my knowledge and belief.

Date Surveyed MARCH 6, 1956

E. O. Walker
Registered Professional Engineer and/or
Land Surveyor

1. Is this well a Dual Comp.

Yes No X

2. If the answer to question 1 is yes, are there any other dually completed wells within the dedicated acreage.

Yes No Name Carl H. WalkerPosition Petroleum EngineerRepresenting

Address El Paso Natural Gas Co.
Box 997
Farmington, N.M.

(Seal)